

E.S.C. PHASE II CONSTRUCTION SEQUENCE:

1. THE SWPPP SHALL BE PROVIDED ON-SITE AND ALL REGULATIONS, INSPECTIONS, AND PROCEDURES FOLLOWED FOR THE ENTIRE DURATION OF THE PROJECT. SEE GENERAL PERMIT DETAILS FOR ADDITIONAL INFORMATION AND SWPPP FOR SITE SPECIFIC REQUIREMENTS AND INSPECTIONS.
 2. THE SILT FENCE SHALL BE MAINTAINED THROUGHOUT THE DURATION OF THE PROJECT.
 3. THE CONCRETE WASHOUT SHALL BE INSTALLED AND MADE FUNCTIONAL PRIOR TO ANY CONCRETE INSTALLATION ON-SITE.
 4. BUILDING CONSTRUCTION MAY BEGIN ONCE THE BUILDING PAD HAS REACHED SUBGRADE ELEVATION.
 5. PROPOSED STORM SEWER SHALL BE INSTALLED AT THIS TIME WITH INLET PROTECTION AS EACH SECTION BECOMES FUNCTIONAL. G.C. SHALL ENSURE SEDIMENT LADEN RUNOFF IS NOT CONVEYED THROUGH THE EXISTING OR PROPOSED STORM SEWER SYSTEM.
 6. ALL PROPOSED INLETS SHALL BE PROTECTED FROM SEDIMENT AS SOON AS INSTALLATION OF EACH STRUCTURE IS COMPLETE TO ENSURE SEDIMENT IS NOT TRANSPORTED THROUGH THE CONNECTED PIPE SYSTEMS.
 7. ALL REMAINING UTILITIES FOR THE SITE MAY BE INSTALLED AT THIS TIME AND AREAS TEMPORARILY OR PERMANENTLY SEEDED AFTER COMPLETION OF INSTALLATION.
 8. THE CONSTRUCTION ENTRANCE MAY BE REMOVED AND PAVEMENT, CURBING, LANDSCAPING, ETC. SHALL BE INSTALLED AT THIS TIME. THE CONCRETE WASHOUT SHALL BE UTILIZED AS DESCRIBED WITH THE REGULATIONS.
 9. SOG SHALL BE APPLIED TO ALL AREAS WITHIN 14 DAYS OF REACHING FINAL GRADE.
 10. AFTER FINAL SITE STABILIZATION AND CITY OF ROANOKE APPROVAL, SILT FENCE, CHECK DAM, AND INLET PROTECTION CAN BE REMOVED.
- *NOTE: CITY OF ROANOKE INSPECTION AND APPROVAL IS REQUIRED PRIOR TO THE REMOVAL OF EROSION AND SEDIMENT CONTROL MEASURES.
11. G.C. SHALL ENSURE THAT THE LIMITS OF DISTURBANCE ARE STRICTLY ADHERED TO DURING THE PROJECT.
 12. NO DEVIATIONS TO THE PLANS SHALL TAKE PLACE UNLESS PRIOR APPROVAL FROM THE OWNER, PROJECT ENGINEER, AND THE APPROPRIATE REVIEW AGENCIES.

E&SC MEASURES

3.02	TEMPORARY STONE CONSTRUCTION ENTRANCE	CE
3.05	SILT FENCE	SF
3.07	STORM DRAIN INLET PROTECTION	IP
3.20	ROCK CHECK DAM	CD
3.31	TEMPORARY SEEDING	TS
3.33	SODDING	SO
3.35	MULCHING	MU

City of Roanoke
Planning, Building, & Development
COMPREHENSIVE DEVELOPMENT PLAN
APPROVED
by Aaron Cypher 10/26/2023

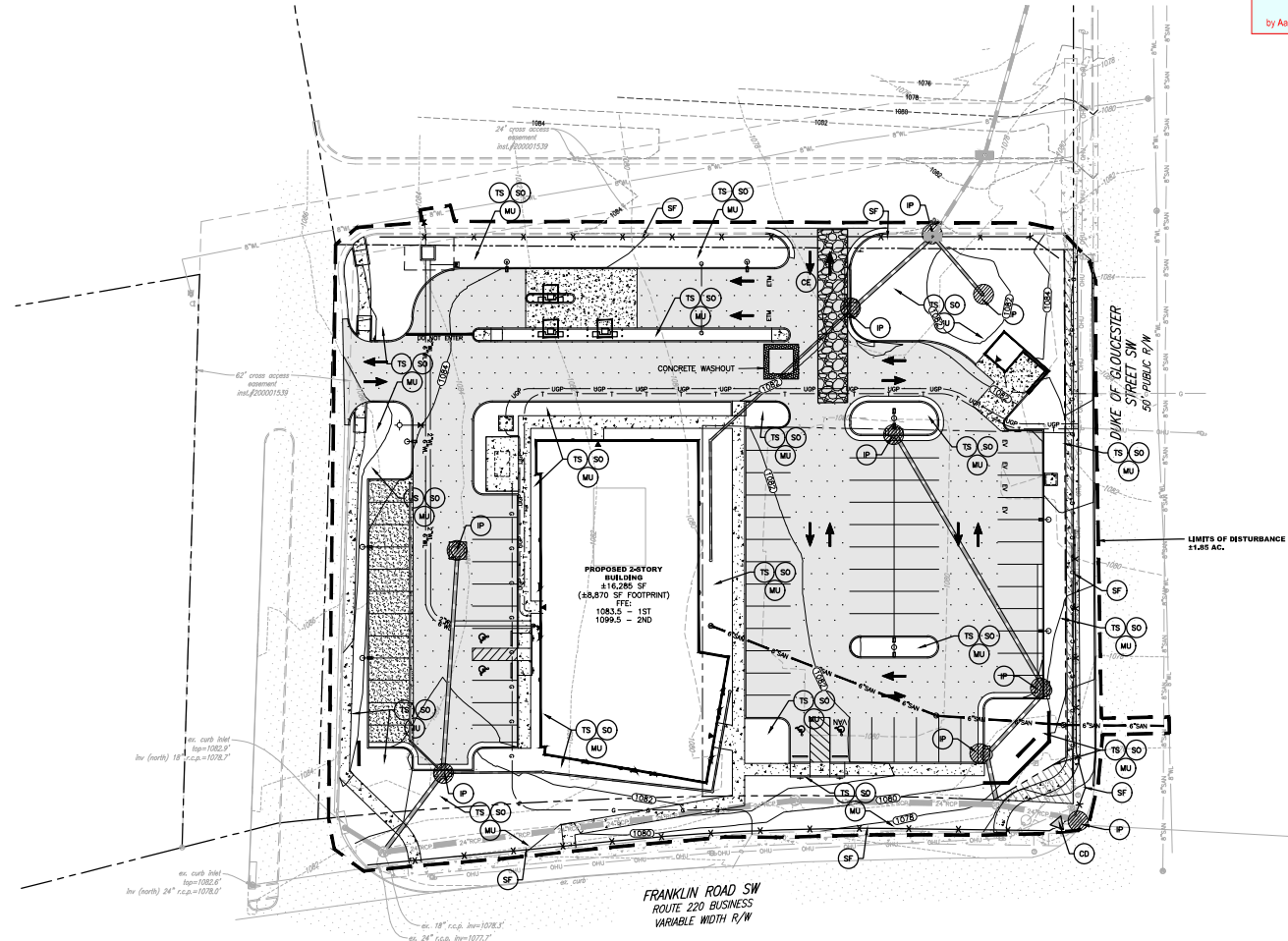

*WORK IN THE PUBLIC RIGHT OF WAY AREA SHALL *
BE PERFORMED PER THE CITY OF ROANOKE RIGHT OF
WAY EXCAVATION & RESTORATION STANDARDS. G.C.
SHALL OBTAIN A R.O.W. EXCAVATION PERMIT PRIOR TO
ANY WORK IN THE PUBLIC RIGHT OF WAY.

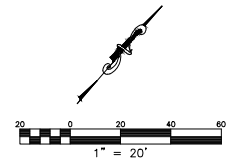

Roanoke / Richmond
New River Valley
Shenandoah Valley
www.balzer.cc
1338 Corporate Circle
Roanoke, VA 24018
540.712.2580



RIDGE VIEW BANK - REGIONAL HEADQUARTERS AND ROANOKE BRANCH

E.S.C. PLAN PHASE II

3029 FRANKLIN RD
CITY OF ROANOKE, VIRGINIA
DRAWN BY: KAM
DESIGNED BY: KAM
CHECKED BY: CPB
DATE: 7/25/2023
SCALE: 1" = 20'
REVISONS: 8/25/2023 ADDENDUM 2
10/16/2023

C7.2
PROJECT NO. 04220084.00