

PROPOSED STRUCTURE SCHEDULE

- 1 VDOT STD. ES-1
TOP=1187.50
INV IN=1185.50 (FROM 2)
- 2 48" CONCRETE RISER
TOP=1193.00
INV OUT=1188.00
- 3 VDOT STD. EW-1
TOP=1191.25
INV IN=1189.00 (FROM 4)
- 4 VDOT STD. DI-3B (L=10')
TOP=1198.00
INV OUT=1193.50
- 5 VDOT STD. EW-1
TOP=1192.17
INV IN=1189.00 (FROM 6)
- 6 VDOT STD. DI-7 (GRATE B)
TOP=1198.00
INV IN=1190.75 (FROM 12)
INV IN=1190.10 (FROM 7)
INV OUT=1190.00
- 7 VDOT STD. DI-3C (L=6')
TOP=1201.20
INV IN=1192.70 (FROM 8)
INV OUT=1192.60
- 8 48" MANHOLE (CONTROL)
TOP=1202.90
INV IN=1195.00 (FROM 9)
INV OUT=1194.10
- 9 48" MANHOLE
TOP=1202.60
INV IN=1195.00 (FROM 10)
INV IN=1195.00 (FROM 13)
INV OUT=1195.00
- 10 VDOT STD. DI-3C (L=12')
TOP=1202.50
INV IN=1197.10 (FROM 11)
INV OUT=1197.00
- 11 VDOT STD. DI-3C (L=6')
TOP=1202.50
INV OUT=1198.00
- 12 VDOT STD. DI-7 (GRATE B)
TOP=1200.90
INV OUT=1197.00
- 13 48" MANHOLE
TOP=1203.90
INV IN=1196.70 (FROM 17)
INV IN=1196.70 (FROM 14)
INV OUT=1196.60
- 14 2' x 2' NYLOPLAST INLET
TOP=1205.00
INV IN=1199.70 (FROM 15)
INV IN=1202.20 (FROM 20)
INV OUT=1199.60
- 15 2' x 2' NYLOPLAST INLET
TOP=1205.00
INV IN=1201.20 (FROM 16)
INV OUT=1201.10
- 16 2' x 2' NYLOPLAST INLET
TOP=1205.00
INV OUT=1202.00
- 17 2' x 2' NYLOPLAST INLET
TOP=1205.20
INV IN=1200.00 (FROM 18)
INV IN=1202.50 (FROM 21)
INV OUT=1199.90
- 18 2' x 2' NYLOPLAST INLET
TOP=1205.20
INV IN=1201.30 (FROM 19)
INV OUT=1201.20
- 19 2' x 2' NYLOPLAST INLET
TOP=1205.00
INV OUT=1202.00
- 20 CLEANOUT
TOP=1206.90
INV OUT=1204.50
- 21 CLEANOUT
TOP=1207.00
INV OUT=1204.50
- 22 PIPE OUTLET
TOP=1198.90
INV IN=1197.40 (FROM 23)
- 23 48" MANHOLE
TOP=1209.00
INV IN=1200.50 (FROM 24)
INV IN=1203.00 (FROM 27)
INV OUT=1200.40
- 24 VDOT STD. DI-3B (L=8')
TOP=1208.00
INV IN=1202.30 (FROM 25)
INV OUT=1202.20
- 25 VDOT STD. DI-7 (GRATE B)
TOP=1207.00
INV IN=1203.60 (FROM 26)
INV OUT=1203.50
- 26 VDOT STD. DI-7 (GRATE B)
TOP=1214.00
INV OUT=1208.00
- 27 VDOT STD. DI-7 (GRATE B)
TOP=1208.00
INV OUT=1205.00

PROPOSED PIPE SCHEDULE

- 1 - 2 120 LF OF 24" CL III RCP @ 2.08%
- 3 - 4 115 LF OF 15" N-12 HDPE @ 3.91%
- 5 - 6 38 LF OF 24" N-12 HDPE @ 2.61%
- 6 - 7 88 LF OF 24" N-12 HDPE @ 2.85%
- 6 - 12 187 LF OF 15" N-12 HDPE @ 3.35%
- 7 - 8 90 LF OF 24" N-12 HDPE @ 1.56%
- 8 - 9 UNDERGROUND DETENTION SYSTEM
- 9 - 10 33 LF OF 15" N-12 HDPE @ 6.09%
- 9 - 13 72 LF OF 15" N-12 HDPE @ 2.23%
- 10 - 11 70 LF OF 15" N-12 HDPE @ 1.29%
- 13 - 14 199 LF OF 15" N-12 HDPE @ 1.46%
- 13 - 17 145 LF OF 15" N-12 HDPE @ 2.21%
- 14 - 15 137 LF OF 15" N-12 HDPE @ 1.02%
- 14 - 20 86 LF OF 8" N-12 HDPE @ 2.68%
- 15 - 16 74 LF OF 15" N-12 HDPE @ 1.09%
- 17 - 18 121 LF OF 15" N-12 HDPE @ 1.00%
- 17 - 21 66 LF OF 8" N-12 HDPE @ 3.03%
- 18 - 19 66 LF OF 15" N-12 HDPE @ 1.06%
- 22 - 23 227 LF OF 18" N-12 HDPE @ 1.32%
- 23 - 24 162 LF OF 18" N-12 HDPE @ 1.05%
- 23 - 27 99 LF OF 15" N-12 HDPE @ 2.01%
- 24 - 25 114 LF OF 18" N-12 HDPE @ 1.05%
- 25 - 26 69 LF OF 18" N-12 HDPE @ 6.39%

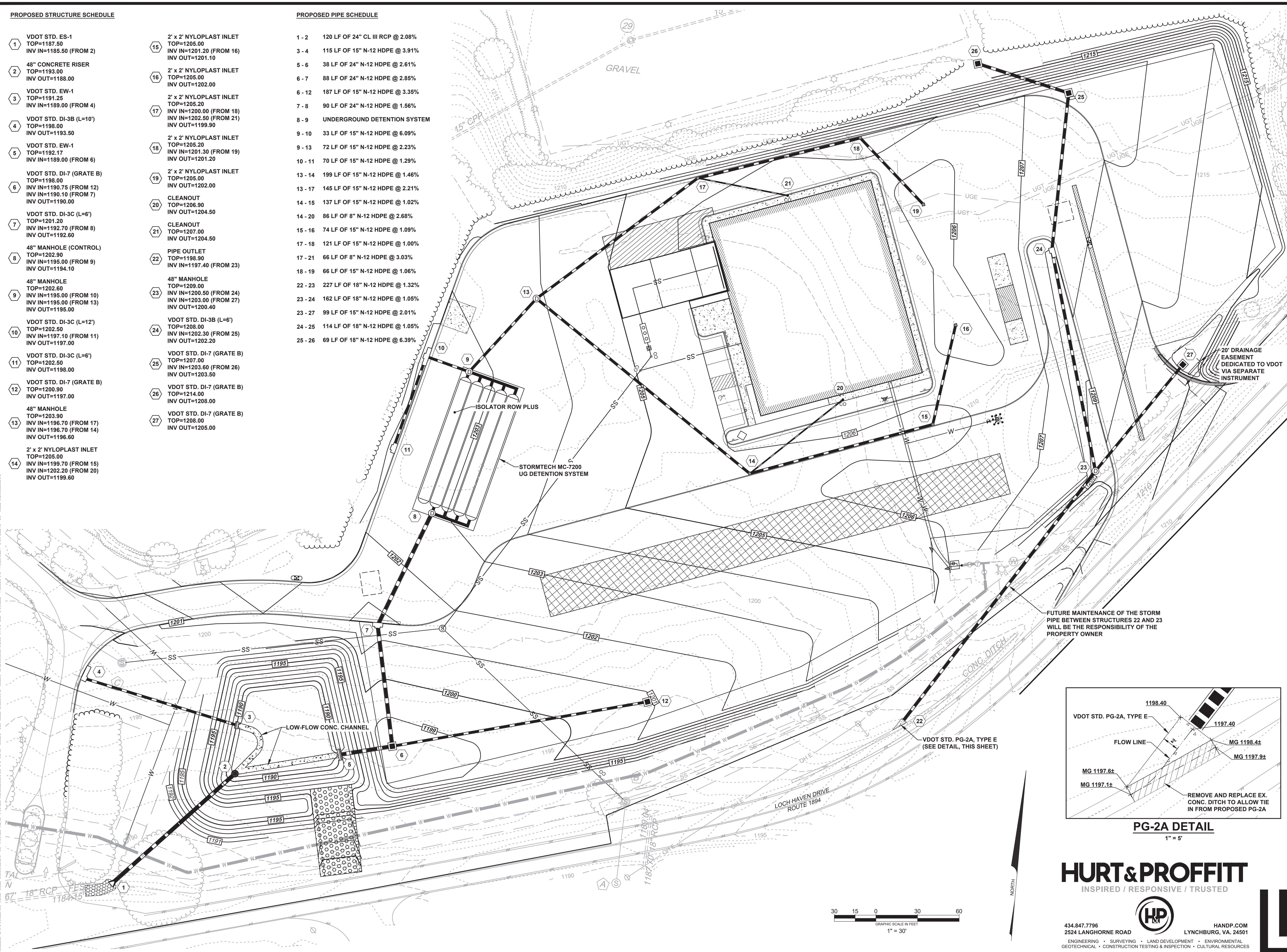

FUTURE MAINTENANCE OF THE STORM
PIPE BETWEEN STRUCTURES 22 AND 23
WILL BE THE RESPONSIBILITY OF THE
PROPERTY OWNER

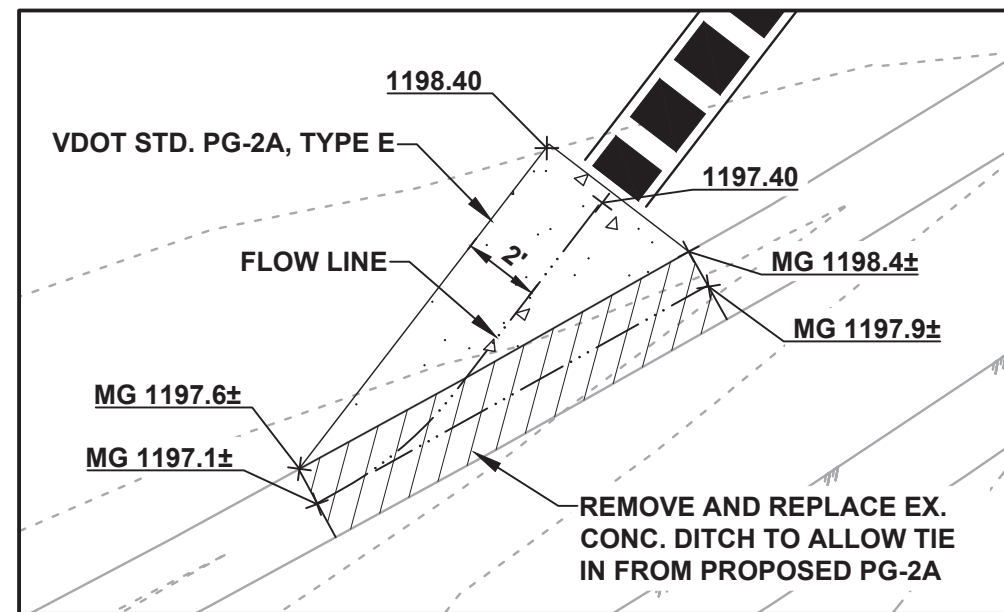

HURT & PROFFITT
INSPIRED / RESPONSIVE / TRUSTED

434.847.7796
2524 LANGHORNE ROAD
LYNCHBURG, VA. 24501
HANDP.COM
ENGINEERING • SURVEYING • LAND DEVELOPMENT • ENVIRONMENTAL
GEOTECHNICAL • CONSTRUCTION TESTING & INSPECTION • CULTURAL RESOURCES

REVISION	DATE	COMMENTS
1	1/17/22	ROANOKE COUNTY & VDOT COMMENTS
2	1/13/23	ROANOKE COUNTY & VDOT COMMENTS
3	1/13/23	ROANOKE COUNTY
4	2/28/23	VDOT COMMENTS

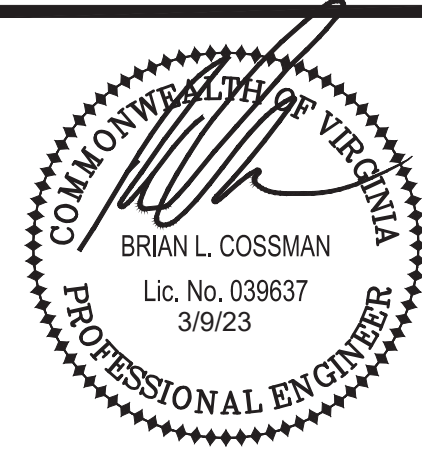

STORM
SEWER
LAYOUT

ROANOKE
TRANSMISSION
RDC
ROANOKE COUNTY, VIRGINIA

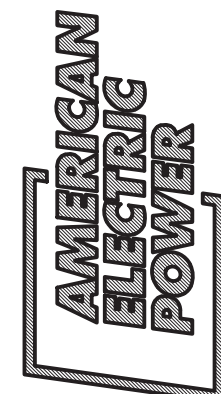

PROJECT ARCHITECT
RLJ JR
TECHNICIANS
DVJ
COMMISSION NUMBER
2902
DATE
25 MAY 2022

C-107

APPROVED, 3/14/2023