

THIS SHEET IS INTENDED TO BE REPRODUCED AT 25% OF ORIGINAL SIZE. ANY REPRODUCTION SHALL MAINTAIN THE SAME SCALE AND PROPORTIONS AS THE ORIGINAL. ANY REPRODUCTION SHALL BE MADE AT THE REPRODUCER'S RISK. THE ENGINEER AND/OR SURVEYOR TAKES NO RESPONSIBILITY FOR THE LOCATION OR ACCURACY OF THE UTILITIES AS SHOWN HEREON OR ANY UTILITIES WITHIN THE PROJECT THAT MAY NOT BE SHOWN HEREON. THE CONTRACTOR SHALL BE RESPONSIBLE FOR CONTACTING THE UTILITY COMPANIES TO SEE IF ANY UTILITIES EXIST WITHIN THE AREA OF THE PROJECT BEFORE ANY CONSTRUCTION BEGINS. ANY COST INCURRED BY DAMAGING ANY UTILITY WITHIN THE PROJECT SHALL BE AT THE EXPENSE OF THE CONTRACTOR.

48 WORKING HOURS PRIOR TO STARTING THE WORK, THE CONTRACTOR SHALL CALL MISS UTILITY AT PHONE NUMBER 611 AND ADVISE THE NATURE AND LOCATION OF THE WORK.

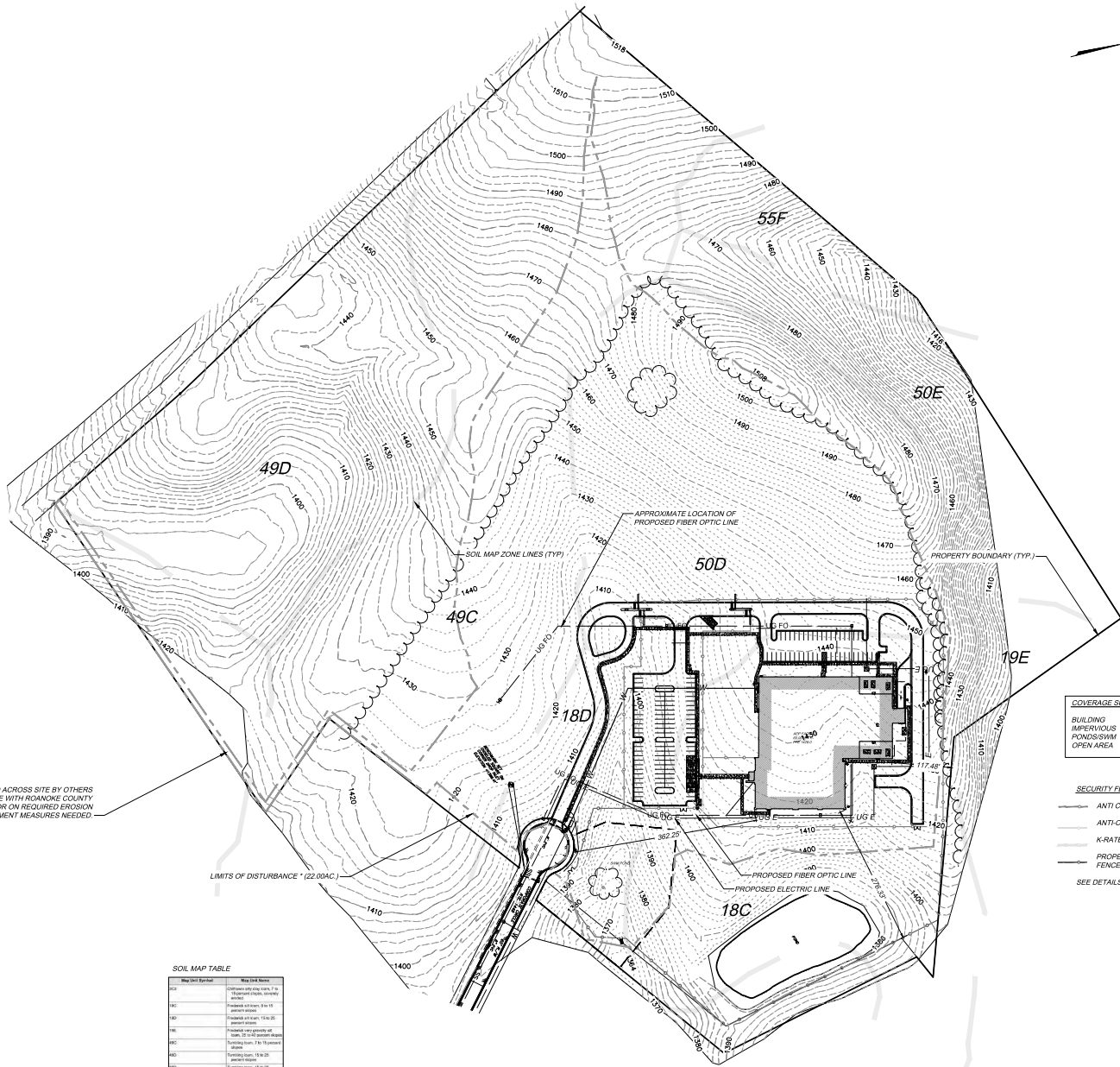

FIBER OPTIC LINE TO BE EXTENDED ACROSS SITE BY OTHERS  
CONTRACTOR SHALL COORDINATE WITH ROANOKE COUNTY  
EROSION AND SEDIMENT INSPECTOR ON REQUIRED EROSION  
AND SEDIMENT MEASURES NEEDED.

Map Sheet Number	Map Sheet Name
49D	CONTRACTOR SHALL COORDINATE WITH ROANOKE COUNTY EROSION AND SEDIMENT INSPECTOR ON REQUIRED EROSION AND SEDIMENT MEASURES NEEDED.
49C	CONTRACTOR SHALL COORDINATE WITH ROANOKE COUNTY EROSION AND SEDIMENT INSPECTOR ON REQUIRED EROSION AND SEDIMENT MEASURES NEEDED.
50D	CONTRACTOR SHALL COORDINATE WITH ROANOKE COUNTY EROSION AND SEDIMENT INSPECTOR ON REQUIRED EROSION AND SEDIMENT MEASURES NEEDED.
55F	CONTRACTOR SHALL COORDINATE WITH ROANOKE COUNTY EROSION AND SEDIMENT INSPECTOR ON REQUIRED EROSION AND SEDIMENT MEASURES NEEDED.
50E	CONTRACTOR SHALL COORDINATE WITH ROANOKE COUNTY EROSION AND SEDIMENT INSPECTOR ON REQUIRED EROSION AND SEDIMENT MEASURES NEEDED.
18D	CONTRACTOR SHALL COORDINATE WITH ROANOKE COUNTY EROSION AND SEDIMENT INSPECTOR ON REQUIRED EROSION AND SEDIMENT MEASURES NEEDED.
18C	CONTRACTOR SHALL COORDINATE WITH ROANOKE COUNTY EROSION AND SEDIMENT INSPECTOR ON REQUIRED EROSION AND SEDIMENT MEASURES NEEDED.
19E	CONTRACTOR SHALL COORDINATE WITH ROANOKE COUNTY EROSION AND SEDIMENT INSPECTOR ON REQUIRED EROSION AND SEDIMENT MEASURES NEEDED.

\* LIMITS OF DISTURBANCE: (22.00 AC.)  
0.70 AC. LINEAR UTILITY DISTURBANCE  
21.30 SITE DISTURBANCE

COVERAGE SUMMARY		
BUILDING	1.38AC	2%
IMPERVIOUS	2.33AC	4%
PONDS/SWIM	1.07AC	2%
OPEN AREA	48.18AC	92%

- SECURITY FENCE LEGEND**
- ANTI CLIMB PERIMETER FENCE WITH K-RATED RAIL
  - ANTI CLIMB PERIMETER FENCE, NO RAIL
  - K-RATED FENCE AND/OR BIG ROCKS
  - PROPERTY FENCE, NOT SECURITY FENCE, K-RATED FENCE OR BIT ROCKS
- SEE DETAILS SHEET C-04

**HURT & PROFFITT**  
INSPIRED / RESPONSIVE / TRUSTED

434.847.7796  
2524 LANCHORNE ROAD  
LYNCHBURG, VA 24501  
HURTP.COM

**OVERALL SITE LAYOUT  
FOR  
AEP PROJECT BROOK TROUT  
ROANOKE COUNTY, VIRGINIA**

PROJECT NO.	20190196
LAT.	37.267010°
LONG.	-80.171511°
DATE	08/20/2019
DRAWN BY:	ELC
CHECKED BY:	PSB

STATE OF VIRGINIA  
PROFESSIONAL ENGINEER  
E.L. CROOK  
LICENSE NO. 041901  
1/10/2020

SIGNATURE SET	
0 50 100 200 SCALE 1" = 100'	
HURT & PROFFITT	
SHEET NO. C-101	REV.

APPROVED, 1/17/2020