

1. G.C. TO CONFIRM THE LOCATION OF ALL EXISTING UTILITIES PRIOR TO ANY CONSTRUCTION OF PROPOSED IMPROVEMENTS.
2. NO CONSTRUCTION/FIELD CHANGES WITHOUT THE APPROVAL OF THE CONSULTING ENGINEER AND CITY OF ROANOKE PLANNING, BUILDING, AND DEVELOPMENT DEPARTMENT. G.C SHALL OBTAIN A RIGHT OF WAY PERMIT FROM THE CITY OF ROANOKE PRIOR TO ANY WORK WITHIN THE CITY OF ROANOKE R.O.W.
3. GENERAL CONTRACTOR TO FIELD VERIFY TIE IN LOCATIONS AND ELEVATIONS AND ENSURE POSITIVE DRAINAGE AS SHOWN WITHIN THE PLAN SET.
4. ANY PAVEMENT OR CONCRETE TO REMAIN THAT IS DISTURBED OR DESTROYED DURING THE CONSTRUCTION PROCESS SHALL BE REPAIRED/REPLACED AS NECESSARY TO PRE-CONSTRUCTION CONDITIONS AT NO COST TO THE OWNER.
5. ALL BUILDING DIMENSIONS SHALL BE COORDINATED WITH THE ARCHITECTURAL PLANS.
6. G.C. SHALL SUBMIT A TRAFFIC CONTROL PLAN TO THE CITY OF ROANOKE PRIOR TO ANY CONSTRUCTION WITHIN THE RIGHT-OF-WAY.
7. G.C. TO PROVIDE ALL REQUIRED CONDUIT FOR EXTERIOR LIGHTING, ELECTRICAL, TELEPHONE, AND COMMUNICATIONS.
8. G.C. SHALL COORDINATE CONCRETE FINISHING AROUND THE PROPOSED DOOR LOCATIONS WITH THE ARCHITECTURAL PLANS.
9. THE SITE CONTRACTOR MUST ARRANGE THE TIMING AND INSTALLATION OF ALL UTILITIES AND MAKE ALL NECESSARY SCHEDULE COORDINATIONS FOR TEMPORARY OR PERMANENT UTILITIES PER THE PROJECT SCHEDULE.
10. ALL ROOFTOP OR GROUND MOUNTED MECHANICAL EQUIPMENT SHALL BE SCREENED FROM VIEW PER CITY OF ROANOKE ZONING ORDINANCE. THE PERIMETER OF ALL GROUND-MOUNTED EQUIPMENT SHALL BE SCREENED FROM ANY STREET FRONTAGE OR ADJACENT PROPERTY BY A FENCE OR SOLID WALL WITH 60% OR GREATER OPACITY. THE PERIMETER OF ALL ROOFTOP EQUIPMENT THAT WOULD OTHERWISE BE VISIBLE FROM ANY STREET FRONTAGE SHALL BE SCREENED BY A FENCE OR SOLID WALL WITH 60% OR GREATER OPACITY AT LEAST 1/2 THE VERTICAL HEIGHT OF THE EQUIPMENT FROM THE ADJACENT STREET. TO BE VERIFIED BY SUBMISSION OF A FIELD REVISION TO THE DEVELOPMENT PLAN OR SEPARATE BUILDING PERMIT.
11. G.C. SHALL OBTAIN A SEPARATE SIGN PERMIT FOR ALL ON-SITE AND BUILDING SIGNAGE. IF A FLAGPOLE DISPLAY IS PROPOSED, NOTE THAT ONLY FLAGS TO BE DISPLAYED ARE NATIONAL, STATE, OR OTHER GOVERNMENTAL FLAGS AND INSIGNIAS.
12. THE REFUSE CONTAINER STORAGE AREA MUST MEET ALL REQUIREMENTS SET FORTH IN TABLE 647-1 AND ARTICLE 4. SUPPLEMENTAL REGULATION SECTION OF THE ZONING ORDINANCE. THE HEIGHT OF THE DUMPSTER SCREENING MUST BE AT LEAST 12" ABOVE THE TOP OF THE DUMPSTER AND THE OPACITY OF THE SCREENING A SOLID FENCE MATERIAL.
13. ANY EXTERIOR LIGHTING SHALL BE INSTALLED AND AIMED TO MEET ALL REQUIREMENTS SET FORTH IN SECTION 36.2 DIVISION 2 OUTDOOR LIGHTING.
14. NO OUTDOOR STORAGE IS PROPOSED AS PART OF THIS PROJECT AT THIS TIME.

1	G.C. SHALL COORDINATE THE EXACT SANITARY SEWER, WATER, AND STORM SEWER BUILDING TIE-IN LOCATIONS WITH THE ARCHITECTURAL PLANS.
2	ALL UTILITY SERVICE LATERALS OR LINES, INCLUDING ELECTRIC, SHALL BE INSTALLED UNDERGROUND PER SECTION 36-2.610. WATER AND SEWER CONNECTIONS SHALL CONFORM TO W.V.A. UTILITY STANDARDS AND INTERNATIONAL BUILDING CODE.
3	G.C. SHALL VERIFY THE EXACT DEPTH OF THE EXISTING S.S. MAIN VERTICAL ELEVATION PRIOR TO ANY BUILDING, SANITARY, OR STORM CONSTRUCTION.
4	THE G.C. SHALL COORDINATE TEMPORARY POWER FOR THE PROPOSED BUILDINGS.
5	THE G.C. IS RESPONSIBLE FOR PROVIDING AND INSTALLING ALL CONDUIT ASSOCIATED WITH REQUIRED UTILITIES FOR THE PROPOSED BUILDING AND ANY NECESSARY UTILITIES ON-SITE SUCH AS LIGHTING, ELECTRICAL, ETC.

1. INTERSECTION OF SPRING RD S.W./BRAMBLETON AVE. S.W.
AUTHORITY ID - 11015
94 PSI STATIC
79 PSI RESIDUAL
1,384 GPM
3,275 GPM @ 20 PSI

2. G.C. SHALL PROVIDE A SERIES 3200 KNOX BOX AT THE ENTRY DOOR OF THE BUILDING PER CITY OF ROANOKE STANDARDS IN REGARDS TO MOUNTING HEIGHT AND TYPE OF KNOX BOX. SEE CITY OF ROANOKE FIRE DEPT. BOX SPECIFIC LOCATION, CONTACT FIRE MARSHALL'S OFFICE FOR ORDERING INFORMATION.

1. ALL CONSTRUCTION METHODS AND MATERIALS SHALL CONFORM TO THE LATEST WYWA DESIGN AND CONSTRUCTION STANDARDS.
2. THE CONTRACTOR OR DEVELOPER IS REQUIRED TO NOTIFY THE WESTERN VIRGINIA WATER AUTHORITY IN WRITING AT LEAST THREE (3) DAYS PRIOR TO ANY CONSTRUCTION. PLEASE CONTACT MARK SINK AT (540) 537-3460.
3. ALL WORK SHALL BE SUBJECT TO INSPECTION BY THE WESTERN VIRGINIA WATER AUTHORITY.
4. FIELD CORRECTIONS SHALL BE APPROVED BY THE WESTERN VIRGINIA WATER AUTHORITY PRIOR TO ITS CONSTRUCTION.
5. THE CONTRACTOR SHALL MAINTAIN A MINIMUM OF 18" CLEARANCE VERTICALLY AND 2' MINIMUM HORIZONTALLY FROM OUTSIDE OF PIPE TO OUTSIDE OF PIPE AT ALL WATER, SANITARY SEWER CROSSINGS OF ANY OTHER UTILITIES. WHERE THIS CANNOT BE ACHIEVED ADDITIONAL MEASURES IN ACCORDANCE WITH W.V.M.A. STANDARDS SHALL BE ENFORCED.
6. IT IS THE CONTRACTOR'S RESPONSIBILITY TO HAVE ALL EXISTING UTILITIES LOCATED AND POTHOLED TO VERIFY LOCATIONS.
7. REFER TO PLAN SET AND WYWA DETAILS FOR SPECIFIC CONSTRUCTION STANDARDS.

1. ALL WATER CONNECTIONS TO EXISTING LINES SHALL BE COORDINATED WITH AND PERFORMED BY THE WESTERN VIRGINIA WATER AUTHORITY.
2. ALL WATER AND SANITARY SEWER FACILITIES ARE TO BE INSTALLED ACCORDING TO THE WESTERN VIRGINIA WATER AUTHORITY DESIGN AND CONSTRUCTION STANDARDS.
3. PROVIDE 5 DAYS NOTICE TO THE WVWA FOR ANY ANTICIPATED WATER OUTAGE TO ALLOW THE WVWA TIME TO SCHEDULE AND NOTIFY AFFECTED CUSTOMERS. (540) 537-3460

AVAILABILITY NUMBER: 17-300

1. ALL SANITARY SEWER CONNECTIONS TO EXISTING LINES SHALL BE COORDINATED WITH AND PERFORMED BY THE WESTERN VIRGINIA WATER AUTHORITY.
2. ALL WATER AND SANITARY SEWER FACILITIES ARE TO BE INSTALLED ACCORDING TO THE WESTERN VIRGINIA WATER AUTHORITY DESIGN AND CONSTRUCTION STANDARDS.

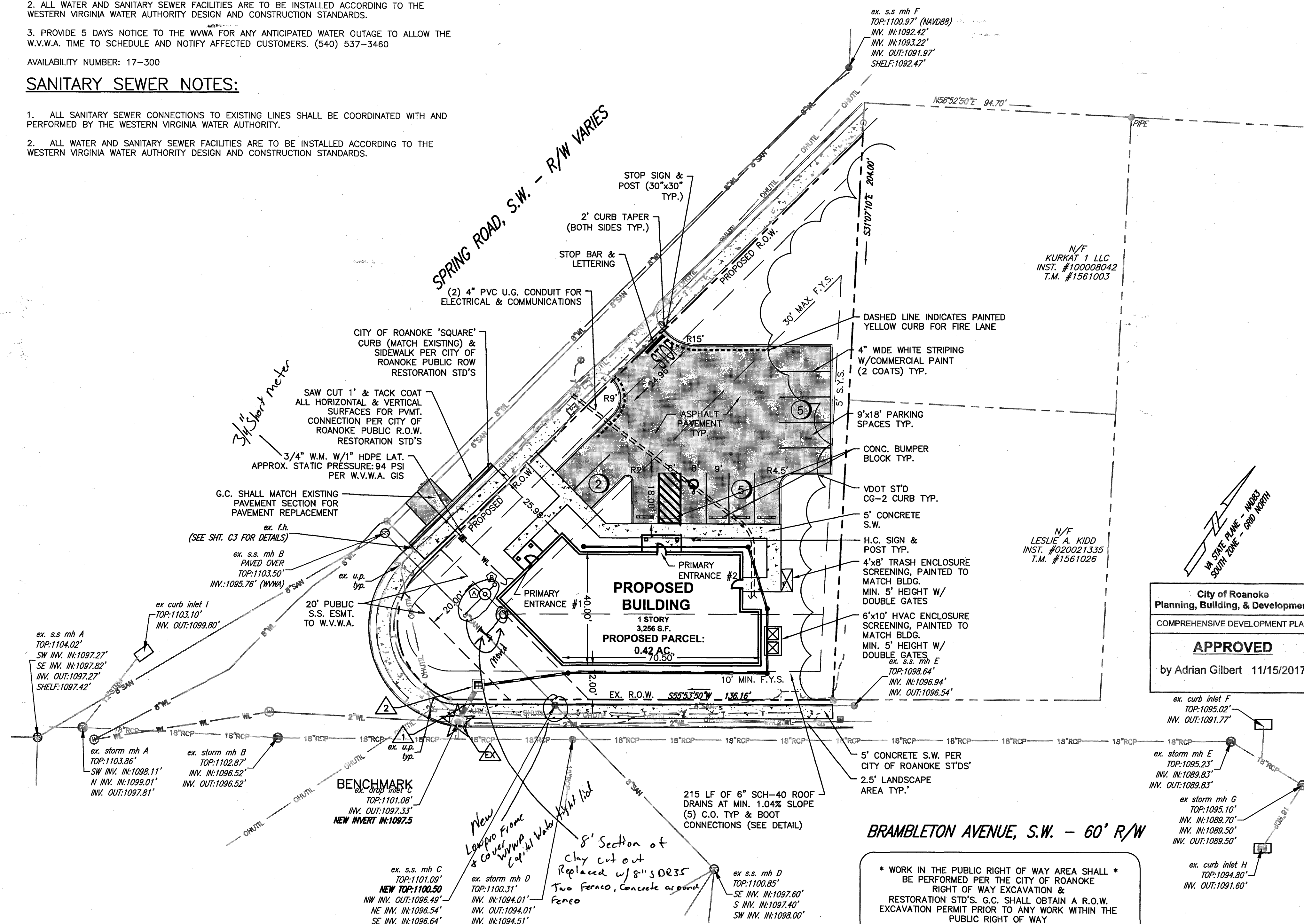

Water
5/8 x 3/4" AP Setter
1" Polyflex ADS - Service

Sewer
6" SDR 26 National Pipe - Lateral - 13'
8" SDR 35 National Pipe - 8' with saddle for 6" line
Manhole
CSI - 7' Depth

BRAMBLETON AVENUE, S.W. - 60' R/W

* WORK IN THE PUBLIC RIGHT OF WAY AREA SHALL *
BE PERFORMED PER THE CITY OF ROANOKE
RIGHT OF WAY EXCAVATION &
RESTORATION STD'S. G.C. SHALL OBTAIN A R.O.W.
EXCAVATION PERMIT PRIOR TO ANY WORK WITHIN THE
PUBLIC RIGHT OF WAY

COMMONWEALTH OF VIRGINIA
Chris Burns
 CHRISTOPHER P. BURNS
 Lic. No. 047338
 9/20/17
 PROFESSIONAL ENGINEER

CITY OF ROANOKE, VIRGINIA

C3