

10019comp01-06-dm02.plt  
w:\drawings\2010\10019\eng\10019comp01.dwg

LEGEND		
ITEM	EXISTING	PROPOSED
Pavement	---	---
Curb and Gutter	---	---
Curb	---	---
Storm Drain Line	---	---
Sanitary Sewer Manhole	---	---
Sanitary Sewer Line	---	---
Waterline	---	---
Hydrant	---	---
Gate Valve	---	---
Underground Electric Line	---	---
Overhead Electric Line	---	---
Underground Telephone Line	---	---
Underground Gas Line	---	---
Utility Pole	---	---
Fence	---	---
Contours	---	---
Spot Elevation	---	---
Treeline	---	---

ABBREVIATIONS	
D.E.	DRAINAGE EASEMENT
W.L.E.	WATER LINE EASEMENT
S.S.E.	SANITARY SEWER EASEMENT
P.U.E.	PUBLIC UTILITY EASEMENT
ESMT	EASEMENT
M.B.L.	MINIMUM BUILDING LINE
R/W	RIGHT OF WAY
VAR.	VARIABLE
EXIST.	EXISTING
D.B.	DEED BOOK
P.B.	PLAT BOOK
P.G.	PAGE
No.	NUMBER
TYP.	TYPICAL
STA.	STATION
L.T.	LEFT
R.T.	RIGHT
RCP	REINFORCED CONCRETE PIPE
SD	STORM DRAIN
SDMH	STORM DRAIN MANHOLE
SS	SANITARY SEWER
SSMH	SANITARY SEWER MANHOLE
W	WATER LINE
TC	TOP OF CURB
TP	TOP OF PAVEMENT
BW	BOTTOM OF WALL
TW	TOP OF WALL

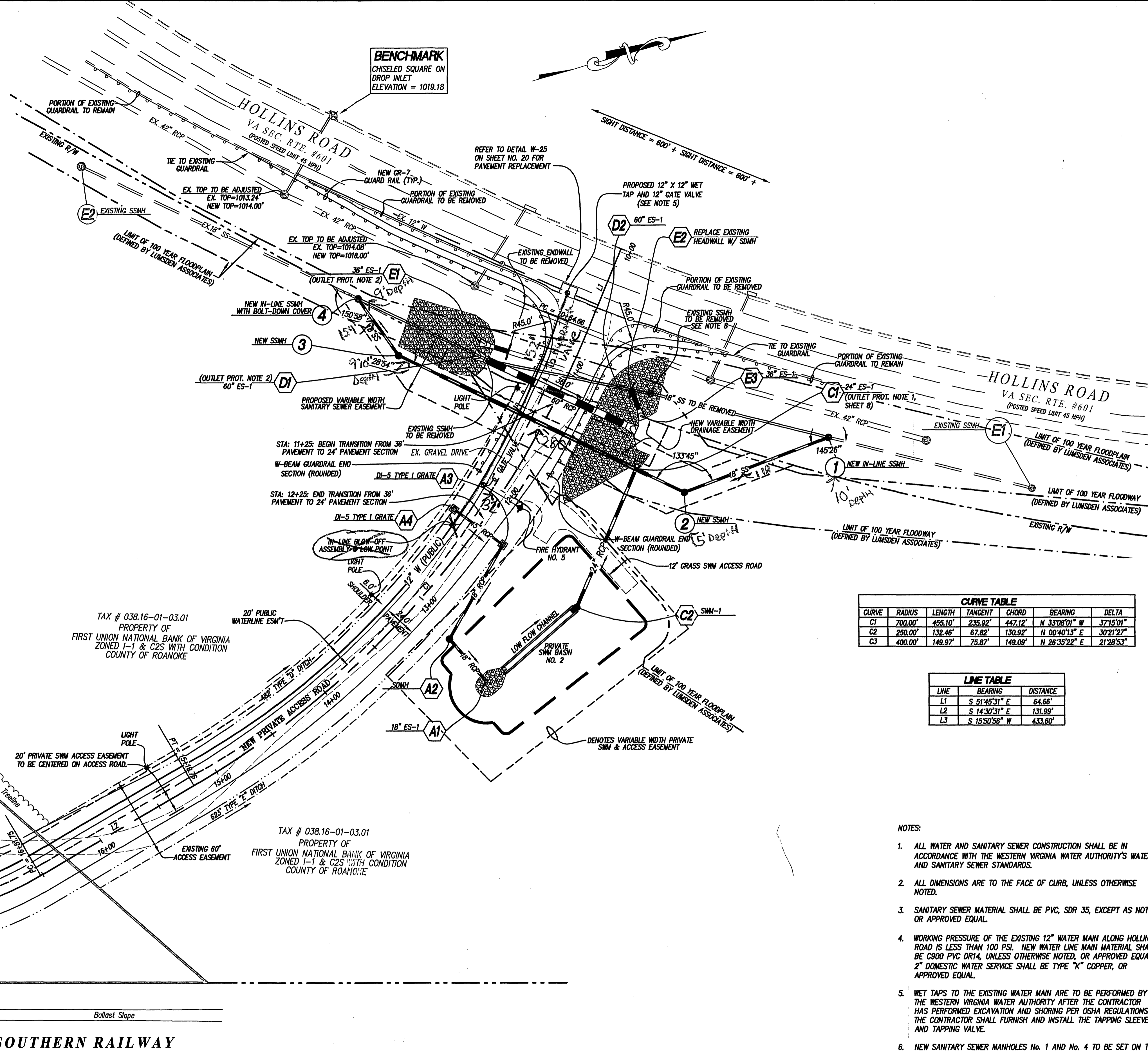

CURVE TABLE					
CURVE	RADIUS	LENGTH	TANGENT	CHORD	BEARING
C1	700.00'	455.10'	235.92'	447.12'	N 33°08'01" W
C2	250.00'	132.46'	67.82'	130.92'	N 00°40'13" E
C3	400.00'	149.97'	75.87'	149.09'	N 26°35'22" E

LINE TABLE		
LINE	BEARING	DISTANCE
L1	S 51°45'31" E	64.66'
L2	S 14°30'31" E	131.99'
L3	S 15°50'56" W	433.60'

- NOTES:
- ALL WATER AND SANITARY SEWER CONSTRUCTION SHALL BE IN ACCORDANCE WITH THE WESTERN VIRGINIA WATER AUTHORITY'S WATER AND SANITARY SEWER STANDARDS.
  - ALL DIMENSIONS ARE TO THE FACE OF CURB, UNLESS OTHERWISE NOTED.
  - SANITARY SEWER MATERIAL SHALL BE PVC, SDR 35, EXCEPT AS NOTED, OR APPROVED EQUAL.
  - WORKING PRESSURE OF THE EXISTING 12" WATER MAIN ALONG HOLLINS ROAD IS LESS THAN 100 PSI. NEW WATER LINE MAIN MATERIAL SHALL BE C900 PVC DR14, UNLESS OTHERWISE NOTED, OR APPROVED EQUAL. 2" DOMESTIC WATER SERVICE SHALL BE TYPE "K" COPPER, OR APPROVED EQUAL.
  - WET TAPS TO THE EXISTING WATER MAIN ARE TO BE PERFORMED BY THE WESTERN VIRGINIA WATER AUTHORITY AFTER THE CONTRACTOR HAS PERFORMED EXCAVATION AND SHORING PER OSHA REGULATIONS. THE CONTRACTOR SHALL FURNISH AND INSTALL THE TAPPING SLEEVE AND TAPPING VALVE.
  - NEW SANITARY SEWER MANHOLES No. 1 and No. 4 TO BE SET ON THE EXISTING SANITARY SEWER LINE WILL REQUIRE BYPASS PUMPING OF THE EXISTING SANITARY SEWER FLOWS PER THE CONDITIONS OF SECTION 3.5 OF SPECIFICATION 02731 OF THE WESTERN VIRGINIA WATER AUTHORITY'S WATER AND SANITARY SEWER STANDARDS. A DETAILED BYPASS PUMPING PLAN MUST BE SUBMITTED AND APPROVED BY WYMA BEFORE THE CONTRACTOR WILL BE ALLOWED TO CONNECT TO THE EXISTING SANITARY SEWER. A WESTERN VIRGINIA WATER AUTHORITY INSPECTOR MUST BE ON SITE DURING INSTALLATION OF THE NEW MANHOLES.
  - ABANDONMENT OF EXISTING SANITARY SEWER PIPE SHALL CONFORM TO THE STANDARDS AND SPECIFICATIONS OF THE WESTERN VIRGINIA WATER AUTHORITY.
  - THE CONTRACTOR IS RESPONSIBLE FOR ANY REPAIRS FOR DAMAGE TO EXISTING STRUCTURES AS A RESULT OF CONSTRUCTION IN ACCORDANCE WITH VDOT, WESTERN VIRGINIA WATER AUTHORITY, AND/OR ROANOKE CITY, ROANOKE COUNTY STANDARDS AND SPECIFICATIONS.

**LUMSDEN ASSOCIATES, P.C.**  
ENGINEERS-SURVEYORS-PLANNERS  
ROANOKE, VIRGINIA

4664 BRAMBLETON AVENUE  
P.O. BOX 20669  
ROANOKE, VIRGINIA 24018

PHONE: (540) 774-4411  
FAX: (540) 772-9445  
E-MAIL: MAIL@LUMSDENPC.COM

**B. LEE HENDERSON, JR.**  
Lic. No. 017591  
PROFESSIONAL ENGINEER

**COMMONWEALTH OF VIRGINIA**

**DEVELOPMENT PLAN FOR**  
**AMERICAN TIRE DISTRIBUTORS**  
**ROANOKE, VIRGINIA**  
**PREPARED FOR**  
**PINECREST DEVELOPMENT COMPANY**  
**ROANOKE CITY & COUNTY, VIRGINIA**

REVISIONS	DATE	DESCRIPTION
1	9/28/11	As-Built's
2		
3		
4		
5		

DATE: August 5, 2010

SCALE: 1" = 40'

COMMISSION NO: 2010-019

SHEET 6 OF 20