

NOTES:

ALL EXISTING UTILITIES SHOWN ARE FROM AS-BUILTS AND MAY VARY. CONTRACTOR TO CALL MISS UTILITY PRIOR TO BEGINNING CONSTRUCTION.

ALL PAVEMENT CROSSINGS TO BE JACK & BORE WITH 18" DIAMETER CASING UNLESS NOTED OTHERWISE.

ALL EXISTING DRIVEWAYS TO BE SAW CUT & REPAIRED AS NEAR TO AS ITS EXISTING CONDITION.

ALL DOUBLE & SINGLE WATER METERS TO BE INSTALLED PER ROANOKE COUNTY DETAIL SHEET.

DETAIL PAVEMENT RESTORATION

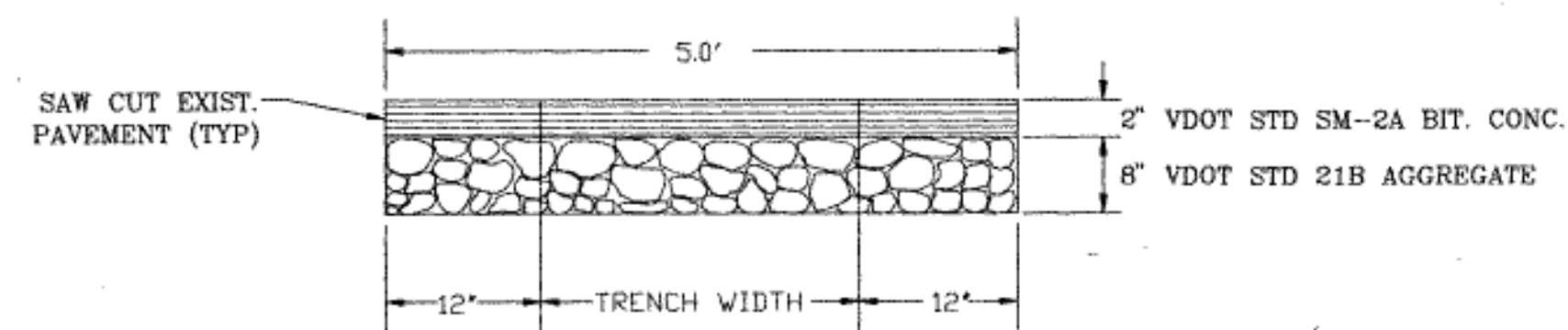

MAX. 12" LAYERS  
@ 95% DENSITY

PROPOSED WATER LINE

LEGEND

- EXIST WATER
- PRP WATER
- EXIST CURB
- EXIST PAVEMENT
- EXIST RIGHT-OF-WAY
- EXIST/PRP REDUCER
- EXIST/PRP GATE VALVE
- EXIST/PRP HYDRANT ASSEMBLY
- EXIST/PRP AIR RELIEF VALVE
- EXIST/PRP PRESS REDUCE VALVE
- EXIST/PRP BLOW-OFF
- EXIST/PRP WATER METER
- EXIST SANITARY SEWER
- EXIST DITCH CENTELINE
- EXIST GAS LINE
- EXIST POWER POLE

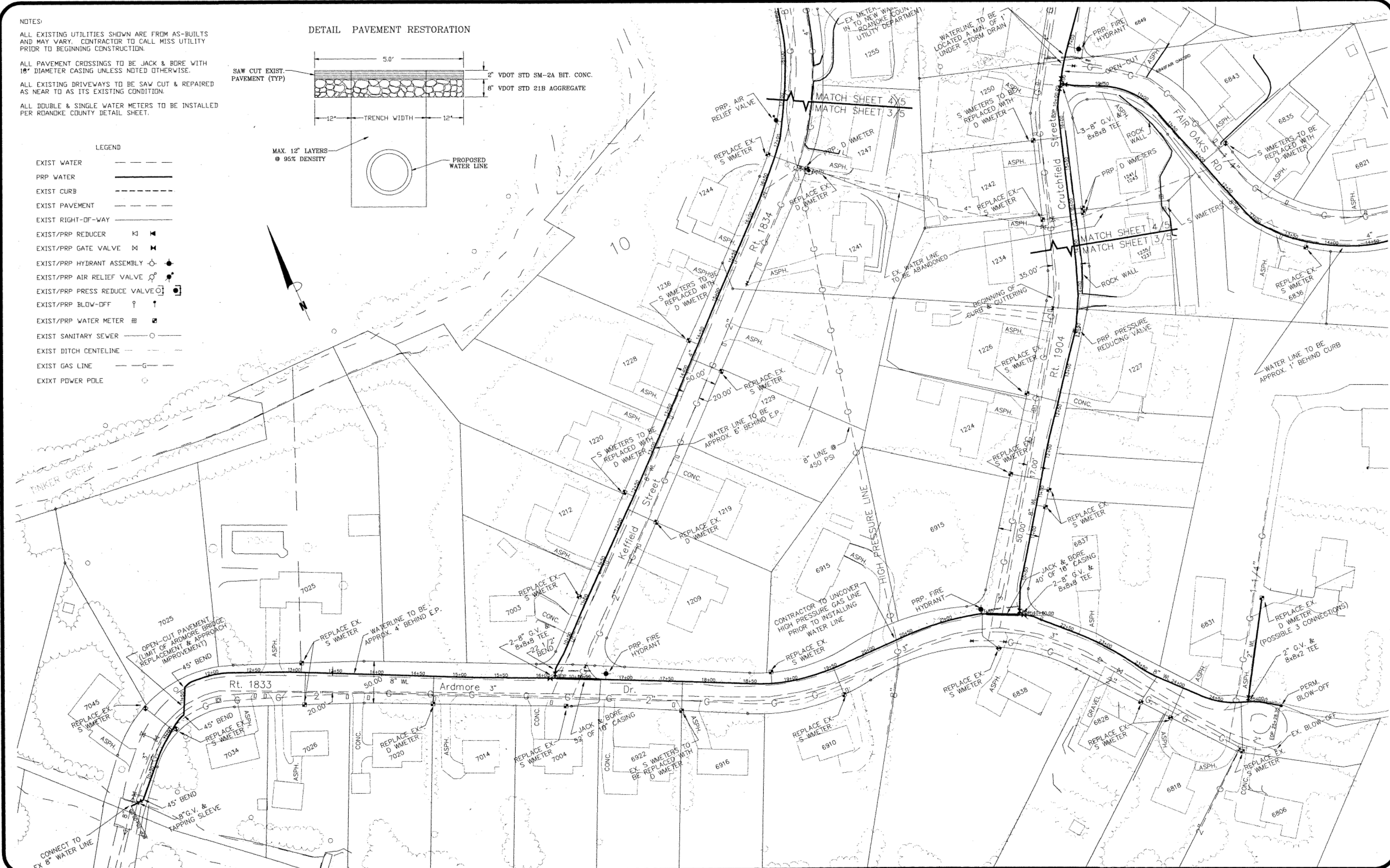

DEPARTMENT OF  
ENGINEERING  
AND INSPECTIONS

1	08/01/96
2	08/05/96
3	
4	
5	
6	
NO.	REVISIONS
	DATE

ARDMORE  
WATER LINE REPLACEMENT

DATE: 07/22/96  
SCALE: 1"=50'  
DRAWING BY: CLN  
DESIGNED BY: SRB  
APPROVED BY: GWS,III

WATER  
PLAN

SHEET  
3  
OF  
5