

GENERAL UTILITY NOTES:

1. THE LOCATION, DEPTH, AND ALIGNMENT OF EXISTING UNDERGROUND UTILITIES IS BASED UPON FIELD SURVEY, AVAILABLE RECORDS, OR AS LOCATED BY A UTILITY MARKING COMPANY AND SHOULD BE CONSIDERED APPROXIMATE. THERE MAY BE UTILITIES WHICH AFFECT THE PROPERTY NOT SHOWN HEREON. CONTRACTOR SHALL CALL "MISS UTILITY" TO VERIFY LOCATION OF ANY UNDERGROUND UTILITIES PRIOR TO ANY CONSTRUCTION.
2. CONSTRUCTION MATERIALS AND METHODS SHALL CONFORM TO CITY STANDARDS.
3. THE CONTRACTOR SHALL FIELD VERIFY THE LOCATION AND INVERTS OF ALL EXISTING MANHOLES AND UTILITY LINES PRIOR TO THE START OF CONSTRUCTION.
4. ALL NEW UTILITIES SHALL BE LOCATED UNDERGROUND PER 36.2-610.

SITE SANITARY SEWER NOTES:

- SS#1: NO NEW SERVICE IS PROPOSED.
- SS#2: THE LOCATION OF THE EXISTING SANITARY SEWER LATERAL BETWEEN THE BUILDING AND THE SANITARY SEWER MANHOLE IS UNKNOWN.
- SS#3: CONTRACTOR SHALL PROTECT THE EXISTING SANITARY SEWER LATERAL DURING CONSTRUCTION. CONTRACTOR SHALL REPAIR ANY DAMAGE INCURRED DURING CONSTRUCTION.

SITE WATERLINE NOTES:

- WL#1: UTILIZE EXISTING SERVICE.
- WL#2: THE LOCATION OF THE EXISTING DOMESTIC SERVICE BETWEEN THE BUILDING AND METER IS UNKNOWN.
- WL#3: CONTRACTOR SHALL PROTECT THE EXISTING DOMESTIC SERVICE LINE DURING CONSTRUCTION. CONTRACTOR SHALL REPAIR ANY DAMAGE INCURRED DURING CONSTRUCTION.
- WL#4: A NEW PRIVATE FIRE SERVICE LINE IS PROPOSED.
- WL#5: CONTRACTOR IS TO INSTALL WVWA APPROVED MATERIAL AND FOLLOW CONSTRUCTION METHODS DEFINED BY WESTERN VIRGINIA WATER AUTHORITY UNLESS OTHERWISE NOTED.
- WL#6: PRIVATE 8" WATER MAIN SHALL BE DUCTILE IRON.
- WL#7: MAINTAIN MINIMUM 3.0' COVER ON WATERLINE.
- WL#8: CONTRACTOR RESPONSIBLE FOR ALL CONSTRUCTION OF FIRE SERVICE SUBJECT TO WVWA INSPECTION WITH EXCEPTION OF THE ACTUAL TAP WHICH WILL BE PERFORMED BY WVWA.

SITE SPECIFIC FIRE MARSHALL NOTES:

- FM#1: THE USE GROUP CLASSIFICATION FOR THE EXISTING BUILDING WILL BE STORAGE GROUP S.
- FM#2: THERE IS AN EX. FIRE HYDRANT IN BERKLEY DRIVE WITH FLOWS REPORTED BY WVWA EQUAL TO:

WVWA HYDRANT ID 11141
STATIC: 176 PSI
RESIDUAL: 148 PSI AT 1838 GPM
GPM AT 20 PSI: 4105 GPM

- FM#3: A PROPOSED FIRE HYDRANT IS BEING PLACED ON SITE. THE EXPECTED FIRE FLOW FOR THIS HYDRANT IS ESTIMATED TO BE 3500 GPM AT 20 PSI.

STREET PERMIT REQUIRED

ALL WORK WITHIN THE RIGHT OF WAY SHALL BE PERFORMED PER THE CITY OF ROANOKE RIGHT OF WAY EXCAVATION AND RESTORATION STANDARDS.

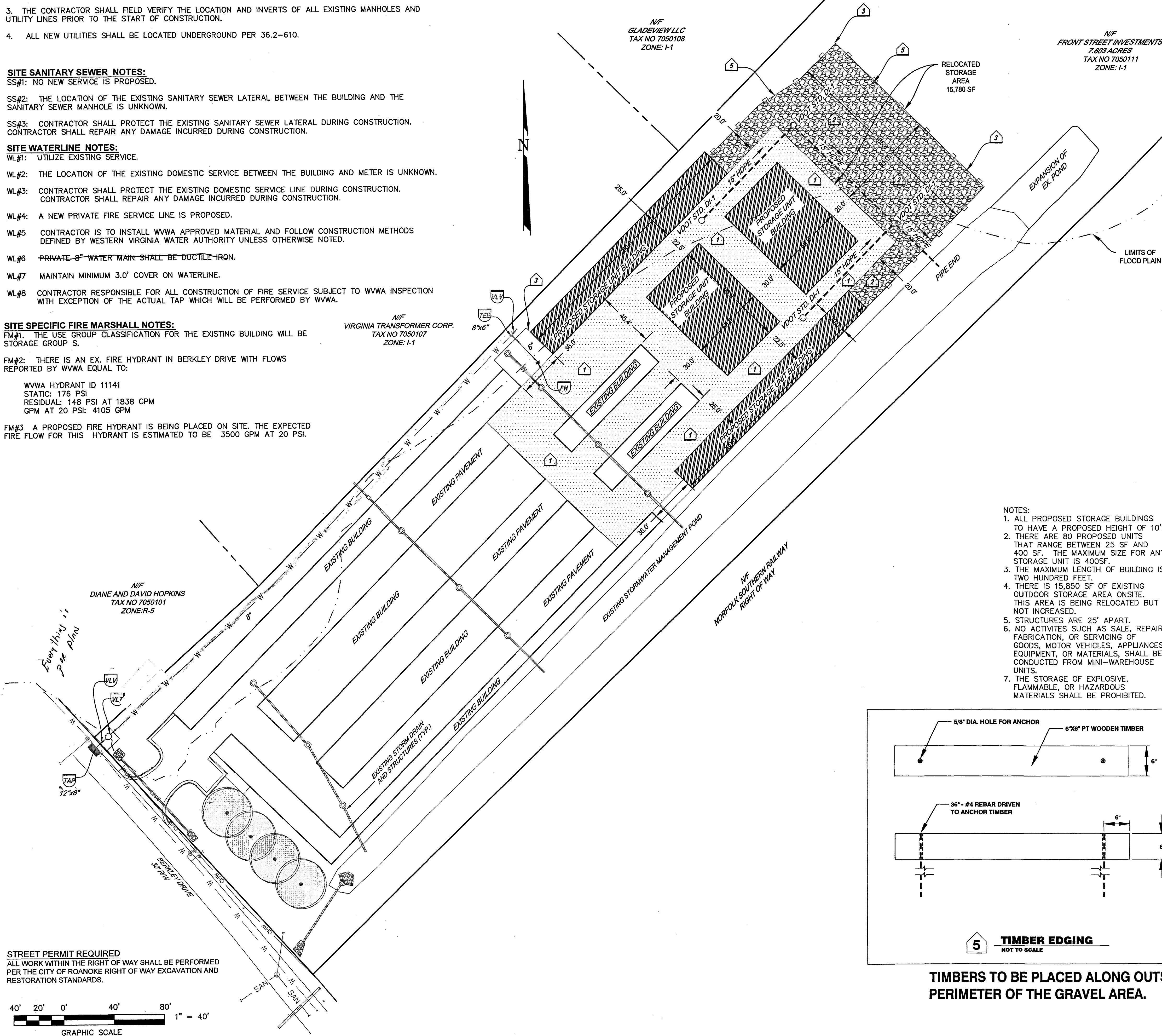
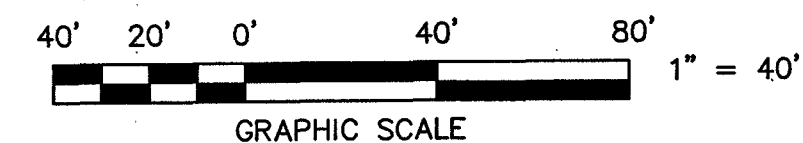

NOTES:

1. ALL PROPOSED STORAGE BUILDINGS TO HAVE A PROPOSED HEIGHT OF 10'.
2. THERE ARE 80 PROPOSED UNITS THAT RANGE BETWEEN 25 SF AND 400 SF. THE MAXIMUM SIZE FOR ANY STORAGE UNIT IS 400SF.
3. THE MAXIMUM LENGTH OF BUILDING IS TWO HUNDRED FEET.
4. THERE IS 15,850 SF OF EXISTING OUTDOOR STORAGE AREA ONSITE. THIS AREA IS BEING RELOCATED BUT NOT INCREASED.
5. STRUCTURES ARE 25' APART.
6. NO ACTIVITIES SUCH AS SALE, REPAIR, FABRICATION, OR SERVICING OF GOODS, MOTOR VEHICLES, APPLIANCES, EQUIPMENT, OR MATERIALS, SHALL BE CONDUCTED FROM MINI-WAREHOUSE UNITS.
7. THE STORAGE OF EXPLOSIVE, FLAMMABLE, OR HAZARDOUS MATERIALS SHALL BE PROHIBITED.

5 TIMBER EDGING

TIMBERS TO BE PLACED ALONG OUTSIDE PERIMETER OF THE GRAVEL AREA.

1 LIGHT DUTY PAVEMENT DETAIL

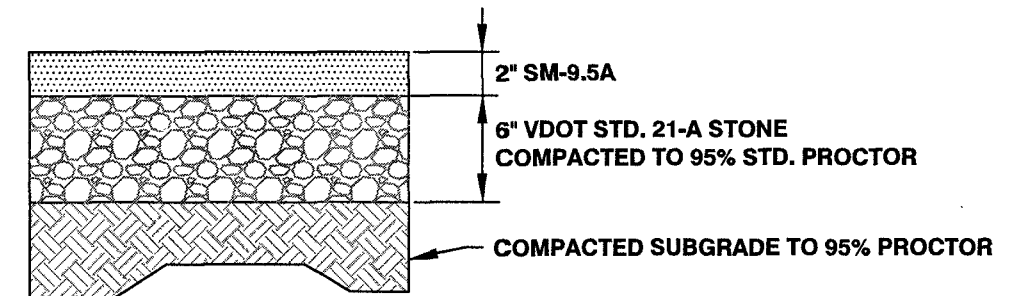

2 GRAVEL SECTION DETAIL

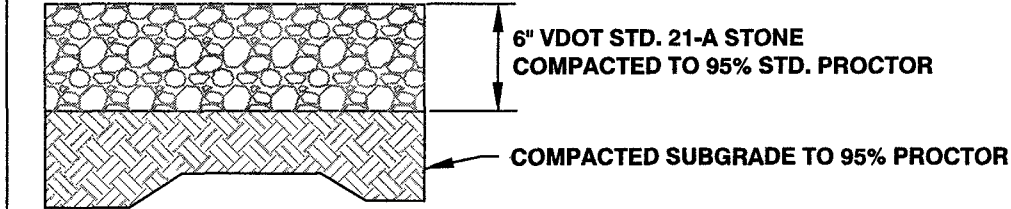

3 CHAIN LINK SECURITY FENCE TO BE SELECTED BY OWNER. GATE LOCATIONS SHALL BE DIRECTED BY OWNER. FENCE TO BE INSTALLED PER MANUFACTURED RECOMMENDATIONS.

4 BOLLARD DETAIL

