

SUBDIVISION & SITE CONSTRUCTION
PLAN GENERAL NOTES

ALL MATERIALS AND CONSTRUCTION WITHIN THE PUBLIC RIGHT-OF-WAY SHALL BE IN ACCORDANCE WITH CURRENT VIRGINIA DEPARTMENT OF TRANSPORTATION'S STANDARDS AND SPECIFICATIONS.

LAND USE PERMITS (CE-7P) MUST BE OBTAINED FROM THE VIRGINIA DEPARTMENT OF TRANSPORTATION PRIOR TO BEGINNING ANY CONSTRUCTION WITHIN THE EXISTING STATE MAINTAINED RIGHT-OF-WAY (INCLUDING ACCESS).
VDOT IS TO RECEIVE WRITTEN NOTIFICATION 48 HOURS PRIOR TO COMMENCING WITH INITIAL CONSTRUCTION ACTIVITIES WITHIN SAID RIGHT-OF-WAYS.

THE CONTRACTOR SHALL VERIFY THE ELEVATIONS OF ALL POINTS OF CONNECTION OR PROPOSED WORK TO EXISTING CURBS, SANITARY LINES, WATER LINES, ETC., PRIOR TO CONSTRUCTION.

UPON THE DISCOVERY OF SOILS THAT ARE UNSUITABLE FOR FOUNDATIONS, SUBGRADES, OR OTHER ROADWAY CONSTRUCTION PURPOSES, THE CONTRACTOR SHALL IMMEDIATELY CONTACT A GEOTECHNICAL ENGINEER AND VDOT. THESE AREAS SHALL BE EXCAVATED BELOW PLAN GRADE AS DIRECTED BY THE GEOTECHNICAL ENGINEER, BACKFILLED WITH SUITABLE MATERIAL AND COMPACTED IN ACCORDANCE WITH CURRENT VDOT SPECIFICATIONS.

ALL STORM SEWER DESIGN AND CONSTRUCTION TO BE IN ACCORDANCE WITH VDOT STANDARDS AND SPECIFICATIONS.

IF PRE-CAST DRAINAGE UNITS ARE TO BE USED, VDOT SHALL BE NOTIFIED AND THE MANUFACTURER SHALL SUBMIT DRAWING DETAILS FOR REVIEW. CERTIFICATION AND VDOT STAMP WILL BE REQUIRED ON ALL UNITS.

ALL CONCRETE SHALL BE CLASS A3-AE (AIR ENTRAINED 3,000 PSI).

ALL ENTRANCES ARE TO BE DESIGNED AND CONSTRUCTED IN ACCORDANCE WITH CURRENT VDOT STANDARDS. RESIDENTIAL LOT ACCESS SHALL BE PROVIDED PER THE FOLLOWING CRITERIA:

- a) ALL DRIVEWAY ENTRANCE CULVERTS ARE TO BE 15" DIAMETER X 20' LONG PIPE AND SHALL CONFORM TO PE-1 PRIVATE ENTRANCE STANDARDS UNLESS OTHERWISE DIRECTED BY THE RESIDENT ENGINEER. NO ENTRANCE CULVERTS ARE TO BE INSTALLED WITHIN FIVE (5) FEET OF A PROPERTY CORNER.
b) VDOT STANDARD C&G ENTRANCES SHALL BE INSTALLED IN CURB AND GUTTER NEIGHBORHOODS. THE SAWCUTTING REMOVAL OF THE STANDING CURB IS UNACCEPTABLE WHEN INSTALLING AN ENTRANCE ON EXISTING CURB AND GUTTER.

THE DEVELOPER IS RESPONSIBLE FOR FURNISHING AND INSTALLING STOP SIGNS AT STREET INTERSECTIONS.

CONTRACTOR SHALL VERIFY LOCATION AND ELEVATION OF ALL UNDERGROUND UTILITIES SHOWN ON PLANS IN AREAS OF CONSTRUCTION PRIOR TO STARTING WORK. CONTACT ENGINEER IMMEDIATELY IF LOCATION OR ELEVATION IS DIFFERENT FROM THAT SHOWN ON PLAN. IF THERE APPEARS TO BE A CONFLICT, AND/OR UPON DISCOVERY OF ANY UTILITY SHOWN ON THIS PLAN, CALL MISS UTILITY OF CENTRAL VIRGINIA AT 1-800-552-7001. THE DEVELOPER SHALL BE RESPONSIBLE FOR THE RELOCATION OF ANY UTILITY WITHIN EXISTING AND/OR PROPOSED RIGHT-OF-WAY REQUIRED BY THE DEVELOPMENT.

ALL STREETLIGHTS SHALL BE LOCATED A MINIMUM OF 9.5' FROM THE EDGE OF PAVEMENT ON CURB AND GUTTER STREETS AND/OR LOCATED A MINIMUM OF 5.5' BEHIND THE DITCH LINE ON OPEN DITCH STREETS.

CASING SLEEVES SHALL BE PLACED AT ALL ROAD CROSSINGS FOR GAS, POWER, TELEPHONE AND CABLE TV SERVICES TRUNK LINES.

THE INSTALLATION OF SEWER, WATER, AND GAS MAINS (INCLUDING SERVICES, LATERALS AND SLEEVES) SHALL BE COMPLETED PRIOR TO PLACEMENT OF AGGREGATE BASE COURSE. PERMITS ARE REQUIRED BY THE VIRGINIA DEPARTMENT OF TRANSPORTATION FOR ALL UTILITIES TO REMAIN IN-PLACE AFTER STREET ACCEPTANCE.

ALL ROADSIDE DITCHES SHOWN AS PAVED ON PLANS ARE TO BE PAVED IN ACCORDANCE WITH THE TYPICAL SECTION AS SHOWN ON THE PLANS. GENERALLY, ALL DITCHES WITH SLOPES EXCEEDING 5% OR LESS THAN 0.75% SHALL BE PAVED UNLESS OTHERWISE DIRECTED BY THE RESIDENT ENGINEER. ANY ADDITIONAL PAVING OF THE DITCHES, OTHER THAN THOSE SHOWN ON THE ROAD PLANS WILL BE DETERMINED PRIOR TO ACCEPTANCE OF THE ROADS INTO THE VDOT SECONDARY ROAD SYSTEM.

A PRIME COAT SEAL BETWEEN THE AGGREGATE BASE AND BITUMINOUS CONCRETE WILL BE REQUIRED AT A RATE OF 0.30 GALLONS PER SQUARE YARD (REC-250 PRIME COAT) PER VDOT STANDARDS AND SPECIFICATIONS.

THE SCHEDULING OF AGGREGATE BASE INSTALLATION AND SUBSEQUENT PAVING ACTIVITIES SHALL ACCOMMODATE FORECAST WEATHER CONDITIONS PER SECTION 315 OF THE ROAD AND BRIDGE SPECIFICATIONS.

ALL VEGETATION AND ORGANIC MATERIAL IS TO BE REMOVED FROM THE RIGHT-OF-WAY LIMITS PRIOR TO CONDITIONING OF THE SUBGRADE.

CERTIFICATION AND SOURCE OF MATERIALS ARE TO BE SUBMITTED TO VDOT FOR ALL MATERIALS AND BE IN ACCORDANCE WITH THE ROAD AND BRIDGE SPECIFICATIONS AND ROAD AND BRIDGE STANDARDS.

DRY GUTTER IS NOT ALLOWED IN VDOT RIGHT OF WAY.

THE NECESSITY AND LOCATIONS FOR ADDITIONAL VDOT STANDARD UNDERDRAINS TO BE DETERMINED AT TIME OF SUBGRADE INSPECTION.

VDOT SHALL BE PROVIDED DOCUMENTATION THAT ALL IN-PLACE PAVEMENTS MEET OR EXCEED THE APPROVED PAVEMENT DESIGN THICKNESS PRIOR TO STATE ACCEPTANCE.

ALL RETAINING WALLS OVER 4' IN HEIGHT WILL REQUIRE A SEPARATE BUILDING PERMIT FROM THE ROANOKE COUNTY BUILDING DEPARTMENT.

ENGINEERS NOTES

BALZER AND ASSOCIATES, INC. ASSUMES NO RESPONSIBILITY FOR ADEQUACY OF PLANS OR FOR INFORMATION ON PLANS UNTIL SUCH PLANS HAVE BEEN APPROVED BY THE REQUIRED PUBLIC AGENCIES.

ANY WORK COMMENCED ON A PROJECT PRIOR TO PLAN APPROVAL IS AT SOLE RISK OF THE DEVELOPER.

BALZER AND ASSOCIATES, INC. WILL NOT BE RESPONSIBLE FOR THE CONTRACTOR'S FAILURE TO CARRY OUT THE WORK IN ACCORDANCE WITH THE PLANS OR WILL NOT BE RESPONSIBLE FOR ACTS OR OMISSIONS OF THE CONTRACTOR, SUBCONTRACTORS, OR THEIR AGENTS OR EMPLOYEES, OR OF ANY OTHER PERSONS PERFORMING PORTIONS OF THE WORK.

SOURCE OF TOPOGRAPHIC INFORMATION IS FIELD SURVEY AND ROANOKE COUNTY AERIAL MAPPING, DATED 1992.

STANDARD VIRGINIA DEPARTMENT
OF TRANSPORTATION NOTES

QUALITY CONTROL

STREETS SHALL BE GRADED AND PAVED IN ACCORDANCE WITH THE MOST CURRENT VERSIONS OF THE VIRGINIA DEPARTMENT OF TRANSPORTATION'S ROAD AND BRIDGE SPECIFICATIONS AND ROAD AND BRIDGE STANDARDS. ALL STRUCTURAL COMPONENTS ERECTED WITHIN RIGHT-OF-WAY SHALL BE INSTALLED IN ACCORDANCE WITH THE MOST CURRENT VERSIONS OF THE VIRGINIA DEPARTMENT OF TRANSPORTATION'S ROAD AND BRIDGE SPECIFICATIONS AND ROAD AND BRIDGE STANDARDS. ALL MATERIALS USED WITHIN A PROPOSED VDOT RIGHT OF WAY SHALL BE TESTED IN ACCORDANCE WITH STANDARD POLICIES. THE DEVELOPER MUST CONTACT THE OFFICE OF THE RESIDENT ENGINEER, PRIOR TO BEGINNING ANY CONSTRUCTION TO OBTAIN THE INSPECTION AND TESTING PROCEDURES. THE DEVELOPER SHALL PROVIDE TEST REPORTS, AT THE DEVELOPER'S EXPENSE, FROM INDEPENDENT LABORATORIES. THE RESIDENT ENGINEER MUST APPROVE ALL INDEPENDENT LABORATORIES.

UTILITIES

ALL NECESSARY UTILITY LATERALS ALONG WITH PROVISIONS FOR CONDUIT (I.E. WATER, SEWER, STORM, GAS AND TELEPHONE) SHALL BE CONSTRUCTED PRIOR TO PLACEMENT OF THE BASE MATERIAL.

GAS OR PETROLEUM TRANSMISSION LINES WILL NOT BE PERMITTED WITHIN THE PAVEMENT (BACK OF CURB TO BACK OF CURB) OR THE SHOULDER ELEMENT. SERVICE LATERALS CROSSING THE PAVEMENT, AND PIPE LINES LOCATED OUTSIDE THE PAVEMENT BUT INSIDE THE RIGHT OF WAY SHALL BE CONSTRUCTED IN CONFORMITY WITH ASA B 31.8 SPECIFICATIONS AND SAFETY REGULATIONS. DISTRIBUTION LINES WITH PRESSURES LESS THAN 120 psi ARE UNAFFECTED BY THE ABOVE.

PERMITS ARE REQUIRED FOR ANY UTILITIES WITHIN THE PROPOSED STREET RIGHT OF WAY PRIOR TO ACCEPTANCE OF THE STREET INTO THE SECONDARY HIGHWAY SYSTEM. HOWEVER, ANY RIGHT, TITLE OR INTEREST GRANTED TO A UTILITY COMPANY FOR PLACEMENT OF UTILITIES (E.G. POWER, TELEPHONE, ETC) IN PROPOSED STREETS MUST BE RELEASED PRIOR TO ACCEPTANCE OF THE STREET INTO THE SECONDARY SYSTEM.

DRIVEWAYS

PERMITS SHALL BE REQUIRED FOR ALL PRIVATE ENTRANCES CONSTRUCTED ON THESE STREET RIGHT-OF-WAY AFTER ACCEPTANCE OF THESE STREETS INTO THE SECONDARY HIGHWAY SYSTEM.

ALL PRIVATE ENTRANCES WITHIN THE RIGHT-OF-WAY SHALL NOT EXCEED EIGHT PERCENT (8%) MAXIMUM GRADE.

PARKING REQUIREMENTS FOR THE LOTS CREATED HEREON SHALL CONFORM TO THE COUNTY OF ROANOKE ZONING ORDINANCE AS SPECIFIED IN SEC. 30-91-9. THIS SECTION STATES THAT FOR EACH SINGLE FAMILY DWELLING, TWO (2) OFF-STREET SPACES SHALL BE PROVIDED.

EROSION CONTROL AND LANDSCAPING

CARE SHALL BE TAKEN DURING CONSTRUCTION TO PREVENT EROSION, DUST AND MUD FROM DAMAGING ADJACENT PROPERTY, CLOGGING DITCHED, TRACKING PUBLIC STREETS AND OTHERWISE CREATING A PUBLIC NUISANCE TO SURROUNDING AREAS.

THE ENTIRE CONSTRUCTION AREA INCLUDING DITCHES, CHANNELS, BACK OF CURBS AND/OR PAVEMENT IS TO BE BACKFILLED AND SEEDED AT THE EARLIEST POSSIBLE TIME AFTER FINAL GRADING.

THE ROAD WILL BE REVIEWED DURING CONSTRUCTION FOR THE NEED OF PAVED DITCHES. IF EROSION IS ENCOUNTERED IN ANY DRAINAGE EASEMENT, IT WILL BE THE RESPONSIBILITY OF THE DEVELOPER TO SOD, RIP RAP, GROUT, PAVE OR AS DIRECTED BY THE RESIDENT ENGINEER TO CORRECT THE PROBLEM.

ALL VEGETATION AND OVERBURDEN SHALL BE REMOVED FROM SHOULDER TO SHOULDER PRIOR TO CONDITIONING (CUTTING AND/OR PREPARATION) OF THE SUB-GRADE.

CONNECTIONS TO STATE MAINTAINED ROADS

WHILE THESE PLANS HAVE BEEN APPROVED, SUCH APPROVAL DOES NOT EXEMPT CONNECTIONS WITH EXISTING STATE-MAINTAINED ROADS FROM CRITICAL REVIEW DURING THE LIFETIME OF THE PERMIT. FIELD REVISIONS TO THE PERMIT SHALL BE MADE AS NEEDED IN ORDER TO ACCOMMODATE THE PREVAILING CONDITIONS AND TO ACCOMMODATE SAFETY ACCOMPANIMENTS SUCH AS TURNING LANES.

INSPECTION

AN INSPECTOR WILL NOT BE FURNISHED BY THE VIRGINIA DEPARTMENT OF TRANSPORTATION EXCEPT FOR PERIODIC PROGRESS INSPECTIONS, THE ABOVE MENTIONED FIELD REVIEWS AND CHECKING FOR REQUIRED STONE DEPTHS. THE DEVELOPER WILL BE REQUIRED TO POST A SURETY TO GUARANTEE THE ROAD FREE OF DEFECTS FOR ONE YEAR AFTER ACCEPTANCE BY THE DEPARTMENT OF TRANSPORTATION.

STREET MAINTENANCE

THE STREETS MUST BE PROPERLY MAINTAINED UNTIL ACCEPTANCE. WHEN ALL REQUIREMENTS HAVE BEEN MET FOR ACCEPTANCE, A FINAL INSPECTION WILL BE MADE TO DETERMINE THAT THE STREET HAS BEEN PROPERLY MAINTAINED.

UNDERGROUND UTILITIES

THE CONTRACTOR SHALL VERIFY BY CONTACTING "MISS UTILITY", THE LOCATION AND ELEVATION OF ALL UNDERGROUND UTILITIES SHOWN ON THE PLANS IN AREAS OF CONSTRUCTION PRIOR TO STARTING WORK. CONTACT THE SITE ENGINEER IMMEDIATELY IF LOCATIONS OR ELEVATIONS IS DIFFERENT FROM THAT SHOWN ON THE PLANS. IF THERE APPEARS TO BE A CONFLICT, OR UPON DISCOVERY OF ANY UTILITY NOT SHOWN ON THE PLAN, CALL "MISS UTILITY".

REVISIONS OF SPECIFICATIONS AND STANDARDS

APPROVAL OF THESE PLANS IS BASED ON THE ROAD AND BRIDGE SPECIFICATIONS AND STANDARDS IN EFFECT AT THE TIME OF APPROVAL. HOWEVER, UNTIL COMPLETION OF THE ROADWAY AND ACCEPTANCE BY THE DEPARTMENT, THIS DEVELOPMENT IS SUBJECT TO ALL FUTURE REVISIONS OF THE ROAD AND BRIDGE SPECIFICATIONS AND STANDARDS.

TRAFFIC CONTROL DEVICES

THE DEVELOPER SHALL BE RESPONSIBLE FOR INSTALLATION OF ALL TRAFFIC CONTROL DEVICES, STOP SIGNS, YIELD SIGNS, SPEED LIMIT SIGNS, PAVEMENT STRIPING, ETC., REQUIRED BY THE LATEST EDITION OF THE MANUAL ON UNIFORM TRAFFIC CONTROL DEVICES (MUTCD). THE DEVELOPER SHALL BE RESPONSIBLE FOR REINSTALLING AND MAINTAINING ALL TRAFFIC CONTROL DEVICES REQUIRED AS PART OF THIS DEVELOPMENT UNTIL THE STREETS ARE TAKEN INTO THE SECONDARY SYSTEM. ALL TRAFFIC CONTROL DEVICES SHALL BE INSTALLED ACCORDING TO THE "MUTCD".

GUARDRAIL

STANDARD GUARDRAIL WITH SAFETY END SECTIONS MAY BE REQUIRED ON FILLS AS DEEMED NECESSARY BY THE STAFF ENGINEER. AFTER COMPLETION OF ROUGH GRADING OPERATIONS, THE OFFICE OF THE STAFF ENGINEER SHALL BE NOTIFIED SO THAT A FIELD REVIEW CAN BE MADE OF THE PROPOSED LOCATIONS. WHERE GUARDRAILS ARE TO BE INSTALLED THE SHOULDER WIDTH SHALL BE INCREASED IN ACCORDANCE WITH VDOT ROAD AND BRIDGE STANDARDS AND THE VDOT ROAD AND BRIDGE SPECIFICATIONS.

STORM DRAINAGE

INSTALLATION OF ALL STORM PIPES/CULVERTS LOCATED WITHIN VDOT RIGHT-OF-WAY AND EASEMENTS SHALL CONFORM TO THE 2001 VDOT ROAD AND BRIDGE STANDARDS. ALL STORM PIPE SHALL BE CLASS III REINFORCED CONCRETE (RCP) UNLESS OTHERWISE NOTED.

STEPS ARE REQUIRED IN STRUCTURES EXCEEDING 4.0' IN DEPTH (VDOT STD. 106.09) AND SAFETY SLABS ARE REQUIRED IN STRUCTURES EXCEEDING 12.0' IN DEPTH (VDOT STD. 106.14).

INLET SHAPING FOR THOSE STRUCTURES IDENTIFIED ON THE STORM DRAINAGE PROFILES MUST CONFORM TO VDOT STANDARD 106.08 IS-1, INLET SHAPING.

FIELD CHANGES

ALL CHANGES, FIELD OR OTHERWISE, TO THE APPROVED PLANS MUST BE APPROVED BY THE VIRGINIA DEPARTMENT OF TRANSPORTATION.

ANY DEVIATIONS BETWEEN THE APPROVED PROPOSED CONTOURS AND THE AS-BUILT CONDITIONS OR ANY TOPOGRAPHIC CHANGES FROM THE APPROVED PLANS MAY REQUIRE ADDITIONAL DRAINAGE STRUCTURES AND EASEMENTS.

GENERAL NOTES

PROVIDE NEW MATERIALS AND WORKMANSHIP IN CONFORMANCE WITH ALL APPLICABLE CODES, STATE AND FEDERAL LAWS, LOCAL ORDINANCES, INDUSTRY STANDARDS, AND OTHER CRITERIA WHICH WOULD NORMALLY APPLY TO WORK OF THIS NATURE. NOTIFY THE ENGINEER IMMEDIATELY UPON DISCOVERING A CONFLICT IN CODES, ORDINANCES, STANDARDS, OR OTHER CRITERIA. APPLICABLE CODES AND STANDARDS INCLUDE, BUT ARE NOT NECESSARILY LIMITED TO, THE FOLLOWING:

- a. BOCA - BASIC CODES
b. ROANOKE COUNTY
c. VDOT - VIRGINIA DEPARTMENT OF TRANSPORTATION, ROAD AND BRIDGE STANDARDS AND SPECIFICATIONS
d. VIRGINIA EROSION AND SEDIMENT CONTROL REGULATIONS AND HANDBOOK
e. OSHA - OCCUPATIONAL SAFETY AND HEALTH ADMINISTRATION
f. ASTM - AMERICAN SOCIETY FOR TESTING AND MATERIALS
g. WYWA - WESTERN VIRGINIA WATER AUTHORITY

MAINTAIN A SET OF APPROVED PLANS ON SITE AT ALL TIMES DURING CONSTRUCTION.

OBTAIN EACH REQUIRED PERMIT PRIOR TO COMMENCING THAT PART OF THE WORK. PAY REQUIRED FEES.

NOTIFY THE ENGINEER IMMEDIATELY UPON DISCOVERY OF CONDITIONS WHICH DIFFER FROM THOSE SHOWN ON THE PLANS.

COMPLY WITH LOCAL ORDINANCES FOR BURNING OF WASTE. TRANSPORT WASTE MATERIALS AND UNSUITABLE MATERIALS FROM OWNER'S PROPERTY.

COORDINATE BUILDING DIMENSIONS WITH ARCHITECTURAL PLANS.

A PRECONSTRUCTION MEETING MUST TAKE PLACE PRIOR TO COMMENCING WORK. AS A MINIMUM, THE CONTRACTOR, OWNER'S AGENT AND COUNTY'S AGENT MUST ATTEND.

VERIFY THE LOCATION AND ELEVATION OF EACH EXISTING UNDERGROUND UTILITY IN AREAS OF CONSTRUCTION PRIOR TO COMMENCEMENT OF WORK. CONTACT ENGINEER IMMEDIATELY IF THERE APPEARS TO BE A CONFLICT, UPON DISCOVERY OF A UTILITY WHICH IS NOT SHOWN, AND UPON DISCOVERY OF A LOCATION OR ELEVATION WHICH DIFFERS FROM THAT SHOWN. TO LOCATE UTILITIES, CALL "MISS UTILITY", 1-800-552-7001. UTILITY LOCATIONS SHOWN ARE THE RESULT OF A COMBINATION OF FIELD LOCATION AND EXISTING INFORMATION. LOCATIONS ARE APPROXIMATE.

REPAIR ALL DAMAGE TO ANY UTILITY, PUBLIC OR PRIVATE, CAUSED AS A RESULT OF CONSTRUCTION ACTIVITIES AT NO ADDITIONAL COST TO OWNER.

NOTIFY OWNERS OF UTILITIES IN AREAS OF CONSTRUCTION PRIOR TO COMMENCEMENT OF EXCAVATION.

SIGNAGE SHALL COMPLY WITH THE APPLICABLE REGULATIONS OF THE COUNTY. A SEPARATE PERMIT IS REQUIRED.

ANY SITE DEVELOPMENT OUTSIDE OF THE SCOPE OF THIS PLAN WILL REQUIRE SITE PLAN REVIEW AND APPROVAL.

ADDITIONAL DRAINAGE STRUCTURES AND EASEMENTS MAY BE REQUIRED BY THE VIRGINIA DEPARTMENT OF TRANSPORTATION DUE TO ANY DEVIATION BETWEEN THE APPROVED PROPOSED CONTOURS AND THE AS-BUILT CONDITIONS OR ANY OTHER TOPOGRAPHIC CHANGES.

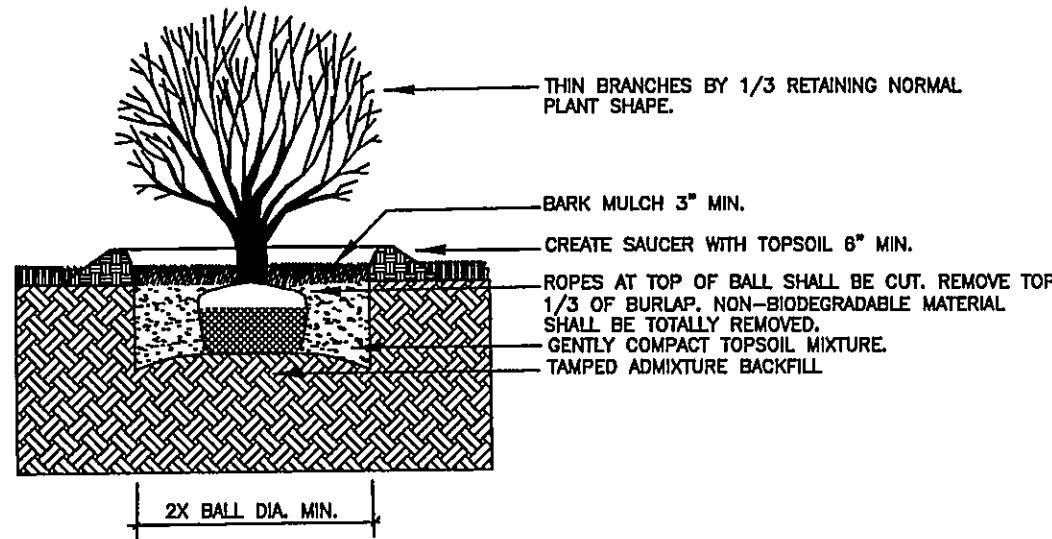
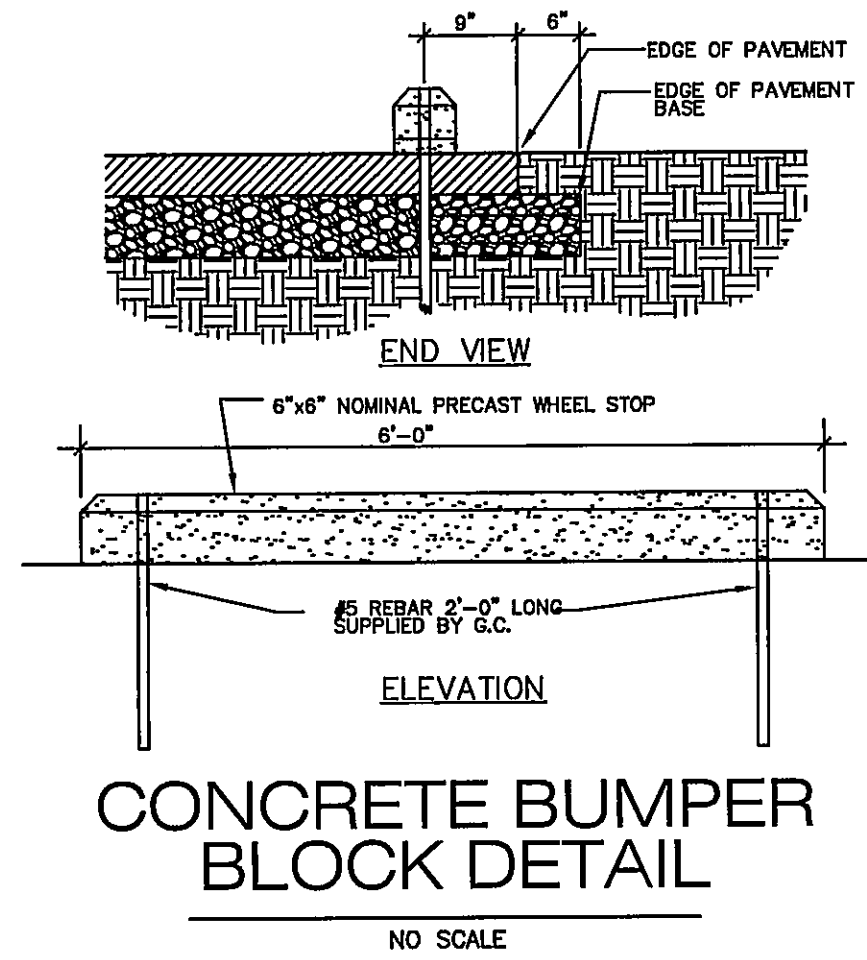

SHRUB PLANTING DETAIL

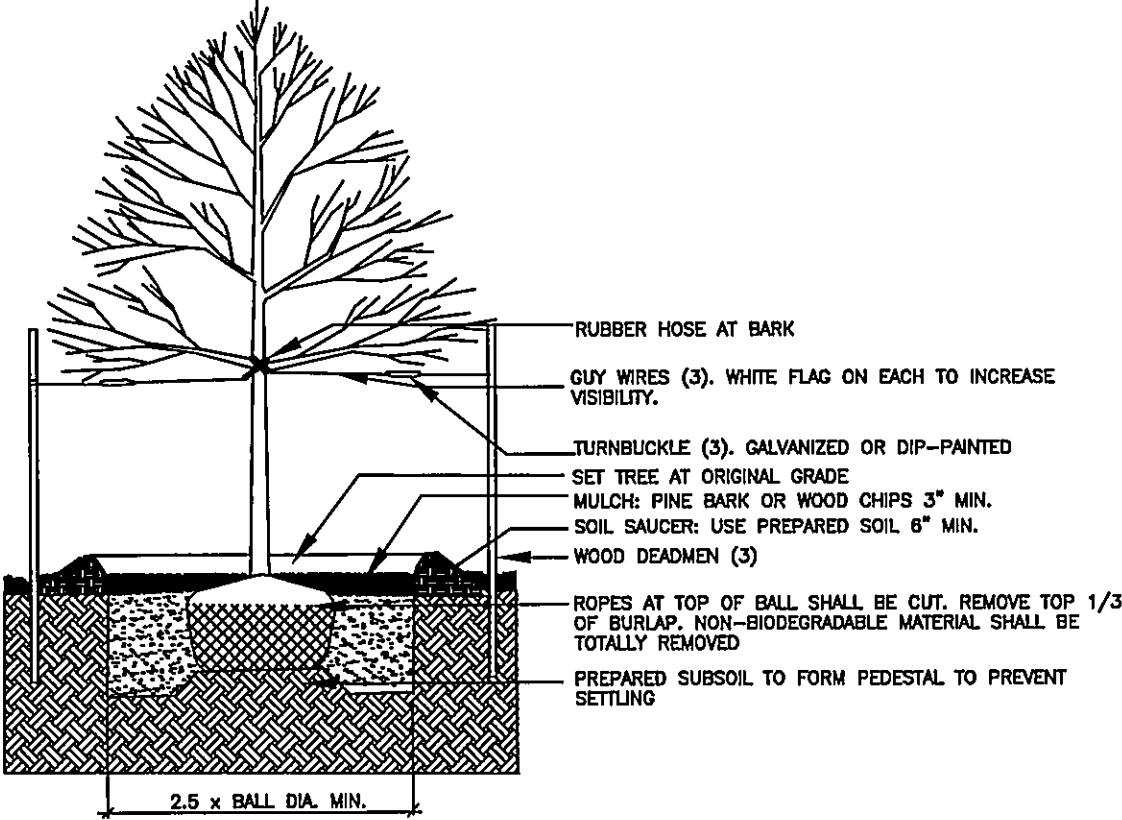

TREE PLANTING DETAIL

PAVEMENT LEGEND

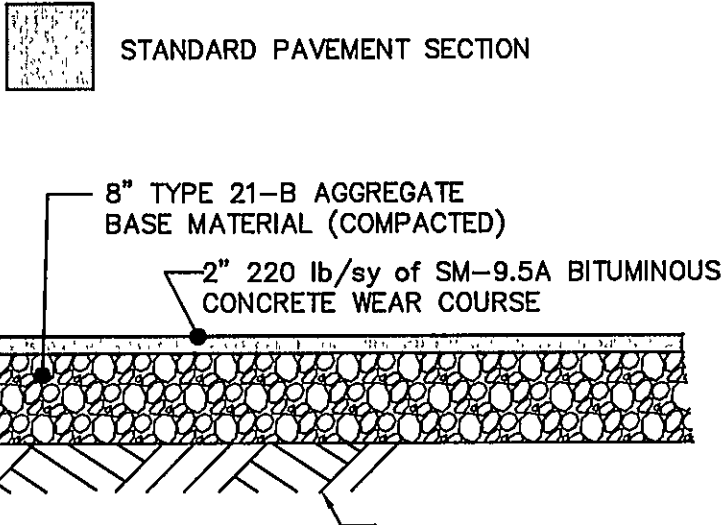

STANDARD PAVEMENT SECTION

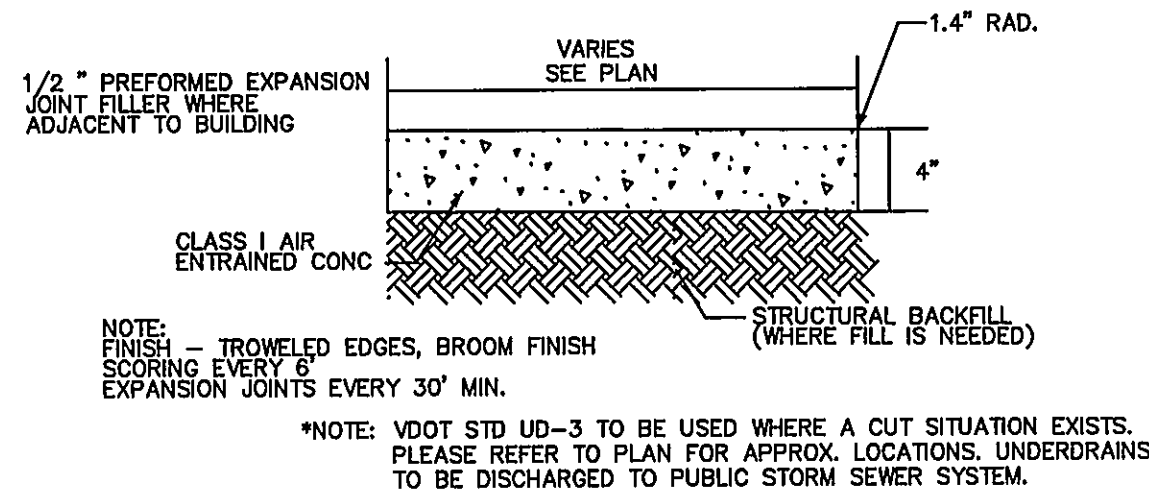

SIDEWALK DETAIL

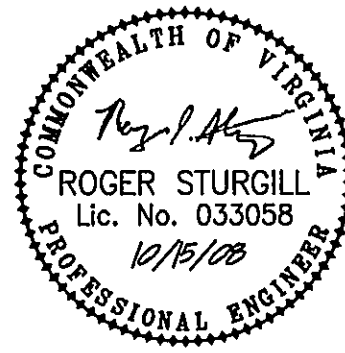

REFLECTING TOMORROW
www.balzer.cc
PLANNERS • ARCHITECTS
ENGINEERS • SURVEYORS

1208 Corporate Circle
Roanoke, Virginia 24018
Phone: 540/772-8580
FAX: 540/772-8050

15871 City View Drive
Suite 200
Midlothian, Virginia 23113
Phone: 804/784-0371
FAX: 804/784-2835

880 Technology Park Drive
Suite 200
Glen Allen, Virginia 23069
Phone: 804/693-0182
FAX: 804/693-0183

448 Peppers Ferry Road, NW
Christiansburg, Virginia 24073
Phone: 540/361-4250
FAX: 540/361-4291

1581 Commerce Road
Suite 401
Verona, Virginia 24482
Phone: 540/248-3220
FAX: 540/248-3221

BLUE RIDGE BEVERAGE

SITE DETAILS

ROANOKE COUNTY, VIRGINIA

DRAWN BY: BTC
DESIGNED BY: BTC
CHECKED BY: SMH
DATE: 7-2-08

REVISIONS:
8-13-08
9-10-08

SCALE: N/A
SHEET NO.
C-8
JOB NO.
R0800130.00