



(7L)	SSMH TERESA LANE RIM=87.94 8" INV. OUT=73.64	(37)	SSMH 37 RIM=85.59 8" INV. OUT=74.90 (@ 3.97%)
(112)	SSMH 112 RIM=77.51 8" INV. OUT=69.65	(38)	SSMH 38 RIM=108.87 8" INV. OUT=99.06
(111)	SSMH 111 RIM=54.81 (1184.10) 8" INV. OUT=49.90	(39)	SSMH 39 RIM=139.35 8" INV. IN=131.09 8" INV. OUT=129.59
(36)	SSMH 36 RIM=71.52 8" INV. OUT=63.41	(40)	SSMH 40 RIM=167.73 8" INV. OUT=161.88

SEE SEWER PROFILE SHEETS FOR NEW SANITARY SEWER STRUCTURES

WATER SYSTEM SHEET NOTES:

[WN1] FIELD VERIFY LOCATION OF EXIST. 10" DIP WATERLINE  
[WN2] MAIN ROAD STA 10+51.5 - PERFORM 8" WET TAP OF EXISTING 10"  
DUCTILE IRON WATERLINE; INSTALL NEW 8" GATE VALVE  
[WN3] MAIN ROAD STA 11+68.5 - INSTALL 2" POLY SERVICE LINE TO FUTURE  
BUSINESS PARCEL & TERMINATE WITH METER BOX ASSEMBLY. METER SIZE TO  
BE DETERMINED BY DEVELOPER AT TIME OF BUILDING CONSTRUCTION.  
[WN4] MAIN ROAD STATION 12+00 - INSTALL FIRE HYDRANT ASSEMBLY WITH  
GATE VALVES ON EACH SIDE. SEE DETAILS.  
[WN5] MAIN ROAD STA 13+43 - INSTALL 1" POLY SERVICE LINE ACROSS ROAD  
TO DOUBLE METER SET  
[WN6] MAIN ROAD STA 14+58.2 - INSTALL 1" POLY SERVICE LINE ACROSS  
ROAD TO DOUBLE METER SET  
[WN7] MAIN ROAD STATION 15+75 - 6" LINE EXTENSION ACROSS ROAD WITH  
8x6x8 TEE & THRUST BLOCKS WITH (2/8" GATE VALVES & (1) 6" GATE VALVE  
[WN8] MAIN ROAD STATION 17+27 - INSTALL FIRE HYDRANT ASSEMBLY WITH  
GATE VALVES ON EACH SIDE. SEE DETAILS.  
[WN9] MAIN ROAD STATION 17+48.5 - 6" LINE EXTENSION ACROSS ROAD WITH

6x6x6 TEE & THRUST BLOCKS WITH (1)8" GATE VALVE & (2) 6" GATE VALVES  
[WN10] MAIN ROAD STATION 17+97 - HIGH POINT IN LINE. INSTALL  
AIR/VACUUM RELEASE ASSEMBLY.  
[WN11] MAIN ROAD STA 18+72.5 - END OF LINE. INSTALL PERMANENT END  
OF LINE BLOW OFF ASSEMBLY. SEE DETAIL.  
[WN12] PRIVATE ROAD 1 STA 0+85 - INSTALL 1" POLY SERVICE LINE ACROSS  
ROAD TO DOUBLE METER SET  
[WN13] PRIVATE ROAD 1 STA 2+15 - INSTALL 1" POLY SERVICE LINE ACROSS  
ROAD TO DOUBLE METER SET  
[WN14] PRIVATE ROAD 1 STA 3+45 - INSTALL 1" POLY SERVICE LINE ACROSS  
ROAD TO DOUBLE METER SET  
[WN15] PRIVATE ROAD 1 STA 4+89 - INSTALL 1" POLY SERVICE LINE ACROSS  
ROAD TO DOUBLE METER SET  
[WN16] PRIVATE ROAD 1 STATION 5+28.9 - 6" LINE EXTENSION ACROSS ROAD  
WITH 6x6x6 TEE & THRUST BLOCKS WITH (3)6" GATE VALVES AS INDICATED  
[WN17] PRIVATE ROAD 1 STA 6+50 - INSTALL 1" POLY SERVICE LINE ACROSS  
ROAD TO DOUBLE METER SET  
[WN18] PRIVATE ROAD 1 STA 6+71.4 - INSTALL 3" POLY SERVICE LINE

**CROSS ROAD TO SINGLE METER SET**  
 [WN19] PRIVATE ROAD STA 7+40 – END OF LINE & HIGH POINT IN LINE. INSTALL AIR/VACUUM RELEASE ASSEMBLY FOLLOWED BY PERMANENT END OF LINE BLOW-OFF ASSEMBLY.  
 [WN20] PRIVATE ROAD STA 2 STA 0+37 – INSTALL FIRE HYDRANT ASSEMBLY WITH GATE VALVES ON EACH SIDE. SEE DETAILS.  
 [WN21] PRIVATE ROAD 2 STATION 1+97 – 6" LINE EXTENSION ACROSS ROAD WITH 6x6x6 TEE & THRUST BLOCKS WITH (3/6") GATE VALVES AS INDICATED  
 [WN22] PRIVATE ROAD 2 STA 2+07 – LOW POINT; INSTALL BLOWOFF ASSEMBLY. SEE DETAILS.  
 [WN23] PRIVATE ROAD 2 STA 2+95 – END OF LINE & HIGH POINT IN LINE. INSTALL AIR/VACUUM RELEASE ASSEMBLY FOLLOWED BY PERM. END OF LINE BLOW OFF ASSEMBLY.  
 [WN24] PRIVATE ROAD 3 STA 0+23 – 11.25" MJ BEND WITH RESTRAINED JOINT CONNECTION (SIGMA PVM SERIES PVM-C6 OR EQUAL)

## MATCHLINE

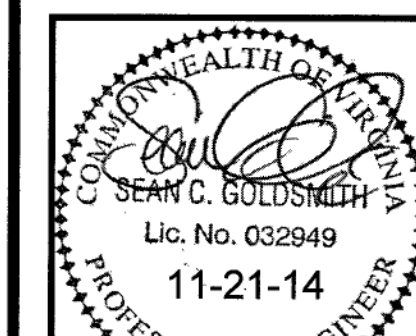
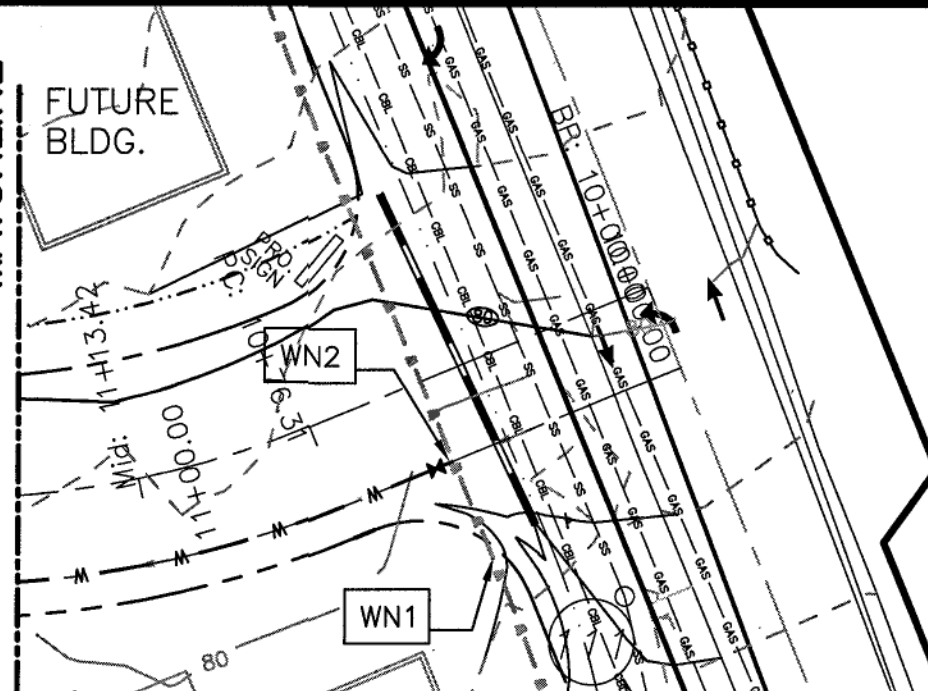

Revisions By	Date
1-ROAD GRADES/SWR	8/13/14
2-WTR; STRM BYPASS	9/19/14
3-SWR RVSNS	10/7/14
4-WTR RVSNS	10/22/14
5-ROAD NOTES; LOTS	11/21/14



**INTEGRITY  
ENGINEERING**

663 White Oak Drive  
Blue Ridge, VA 24064  
Ph: (540) 537-2390  
Email: integrityengpc@gmail.com

## UTILITIES PLAN

## PHASE 1

# COTTAGES OF STEEPLCHASE

BOTTETOURT COUNTY, VIRGINIA

Scale: 1"=40'

Date: 4-24-14

Design By: SCG

CAD By: SCG

Checked By:

Sheet No.

# C2

ROAD CONNECTION SHEET NOTES:

[RN1] END SIDEWALK, STA. 19+33.47.  
[RN2] END ROLLCURB, STA. 19+33.17. SEE STANDARD ROAD SECTIONS FOR ROLLCURB AND SHOULDER AND DITCH SECTION INFORMATION. TRANSITION END OF CURB TO SHOULDER AND DITCH BY SLOPING THE LAST 12" OF CURBING FROM STANDARD CURB HEIGHT TO A FLAT SECTION THAT WILL EXTEND TO ROADSIDE DITCH. EXTEND ROADSIDE DITCHES AND CONNECT TO EXISTING AROUND PERIMETER OF CUL-DE-SAC.  
[RN3] SAWCUT & REMOVE 6" OF ASPHALT PAVEMENT AT INTERSECTION OF NEW ROAD. APPLY TACKIFIER TO EXPOSED ASPHALT EDGES IMMEDIATELY PRIOR TO PAVING AND NEW ROAD PAVEMENT SECTION TO INTERSECT WITH EXISTING CUL-DE-SAC.  
[RN4] SAWCUT ALONG EDGES OF ROADWAY AND REMOVE EXCESS PAVEMENT & GRAVEL FROM CUL-DE-SAC IN PHASE 2 WHEN TERESA LANE IS EXTENDED THROUGH TO CONNECT WITH RTE 654. REVISED GRADING AROUND TERESA LANE CUL-DE-SAC AND DRAINAGE DETAILS SHALL BE PROVIDED WITH PHASE 2 PLANS.