

ENHANCED EXTENDED DETENTION POND
DISCHARGE STRUCTURE & SCHEMATIC SECTION
NOT TO SCALE

ENHANCED EXTENDED DETENTION POND SHEET NOTES

- SN1** LINE FOREBAY AREAS WITH 18" CLASS 1 RIP RAP ON MIRAFI 140N FILTER FABRIC; d50=1.1" RIP RAP LINING SHALL EXTEND SEAMLESSLY FROM DRAINAGE CHANNELS FLOWING INTO POND.
- SN2** LINE OVERFLOW CHANNELS WITH 18" CLASS A1 RIP RAP ON MIRAFI 140N FILTER FABRIC; d50=0.75"
- SN3** ALL SHALLOW MARSH AREAS (ELEV. 52.0-56.0) SHALL BE HAVE WATER LOVING PLANT SPECIES SUCH AS THOSE LISTED IN SECTION 3.05 OF THE 1999 VIRGINIA STORMWATER MANAGEMENT HANDBOOK PLANTED THROUGHOUT THE AREA (INCLUDING FRINGES OF POND AREA). SHALLOW WATER AREAS (EL.54.5-56.0) SHALL BE PLANTED WITH A MIXTURE OF COMMON THREE-SQUARE, SOFT-STEM BULRUSH, PICKERELWEED, ARROW ARRUM, AND/OR SEDGES. DEEP WATER AREAS (EL. 50.0-54.5) SHALL BE PLANTED WITH A MIXTURE OF PONDWEED, COONTAIL, WILD CELERY, AND DUCKWEED. RIPARIAN FRINGE AREA (EL. 56.0-60.75) SHALL BE PLANTED WITH A VARIETY OF TREES AND SHRUBS INCLUDING RIVER BIRCH, GREEN ASH, AND RED CHOKEBERRY. TREES AND SHRUBS SHALL NOT BE PLANTED ALONG EMBANKMENT. THE FLOODPLAIN TERRACE AREA (EL.60.75-66.0) SHALL BE PLANTED WITH NATIVE GRASSES.
- SN4** STORMFILTER WATER QUALITY STRUCTURE SHALL BE INSTALLED UPON STABILIZATION OF DEVELOPMENT AREA SIMULTANEOUS WITH SEDIMENT BASIN TO ENHANCED EXTENDED DETENTION POND CONVERSION.
- SN5** PRECAST CONCRETE RISER AND DISCHARGE STRUCTURE FOR DETENTION POND. SEE SCHEMATIC SECTION FOR MORE INFORMATION.
- SN6** CONCRETE RISER AND DISCHARGE STRUCTURE FOR STREAM BYPASS. SEE SCHEMATIC SECTION FOR MORE INFORMATION.
- SN7** STREAM BYPASS CHANNEL WITH LINING. SEE SCHEMATIC SECTIONS FOR MORE INFORMATION.
- SN8** COMBINE EMERGENCY SPILLWAY DISCHARGES FROM STREAM BYPASS & DETENTION POND. SEE DISCHARGE SECTIONS FOR ELEVATIONS & LINING INFORMATION.

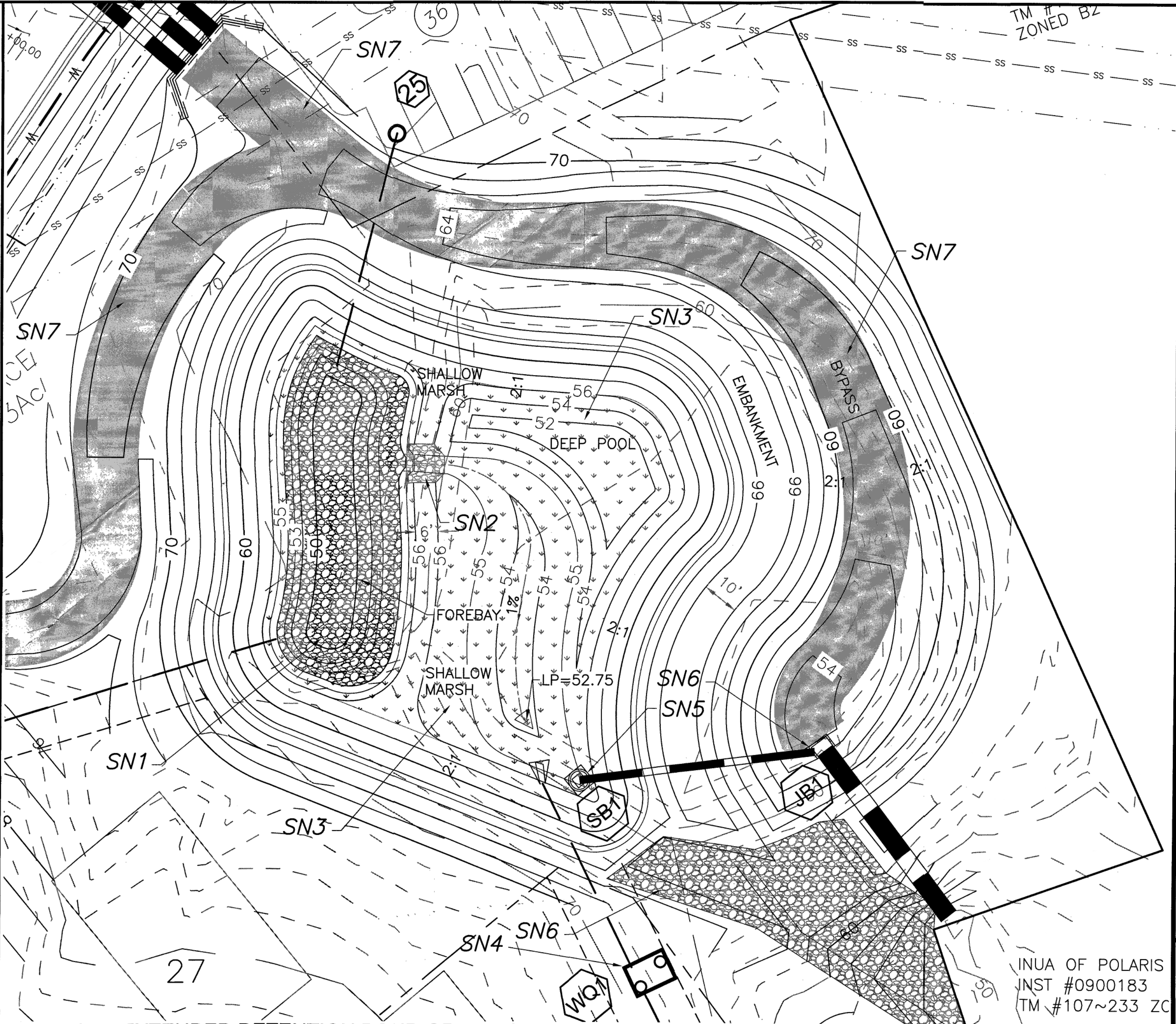

ENHANCED EXTENDED DETENTION POND GRADING
SCALE: 1"=20'

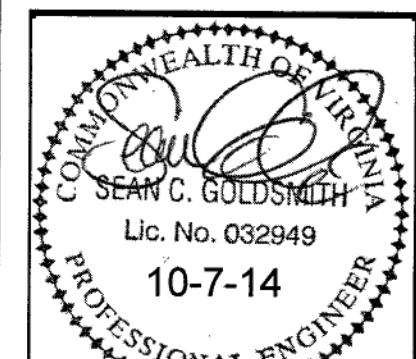

Revisions By	Date
1-SED. BASIN/BYPASS	9/19/14
2-STRM& SWR RVSN	10/7/14



STORMWATER MANAGEMENT DETAILS

PHASE 1
COTTAGES OF STEEPLECHASE
BOTETOURT COUNTY, VIRGINIA

Scale:	AS SHOWN
Date:	4-24-14
Design By:	SCG
CAD By:	SCG
Checked By:	
Project No.:	12052

Sheet No.
C7A