

Drawing name: U:\VUL\VS\113001048-Roanoke-Towers\AU\UT\UTS\_LWS\_1.dwg User: J. AUG 11, 2005 1:49pm D:\UTS\BOSTIC





#### DEMOLITION NOTES

- SAW CUT AND REMOVE ALL ASPHALT AND CONCRETE TO LIMITS REQUIRED FOR NEW WORK.
- REMOVE VEGETATION, GRASS, & ROOTMAT IN AREAS TO RECEIVE NEW ASPHALT AND CONCRETE PAVEMENTS.
- ALL PRIMARY UTILITIES DISCOVERED DURING DEMOLITION OPERATIONS THAT SERVE ACTIVITIES OTHER THAN THE CVS/ PHARMACY SITE SHALL BE PROPERLY PRESERVED AND PROTECTED.
- THE CONTRACTOR SHALL IMMEDIATELY REPORT TO THE OWNER ANY UNFORESEEN OR ADVERSE CONDITIONS DISCOVERED DURING DEMOLITION OPERATIONS.

#### NOTES

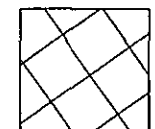
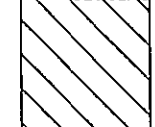
- CONTRACTOR SHALL PROTECT EXISTING PLANT MATERIAL NOT DESIGNATED FOR REMOVAL OR RELOCATION FROM DAMAGE DURING CONSTRUCTION.
- CONTRACTOR SHALL KEEP ALL SURROUNDING PUBLIC ROADWAYS AND DRAINAGE SYSTEMS FREE FROM DIRT, MUD, AND CONSTRUCTION DEBRIS AT ALL TIMES.
- CONTRACTOR STAGING AREAS SHALL BE LIMITED TO THE PROPERTY BOUNDARY.
- LIMITS OF DEMOLITION INDICATED ON PLAN ARE MINIMUM. CONTRACTOR SHALL REMOVE ASPHALT PAVEMENT, CONCRETE AND MISCELLANEOUS ITEMS AS NECESSARY TO FACILITATE CONSTRUCTION IN ACCORDANCE WITH STATE AND LOCAL REGULATIONS.
- CONTRACTOR SHALL BE RESPONSIBLE FOR THE REPAIR OF ANY ITEMS DAMAGED DURING THE CONSTRUCTION.
- CONTRACTOR SHALL COORDINATE WITH FRANCHISE & PUBLIC UTILITY COMPANIES IN ORDER TO DISCONNECT & TERMINATE ABOVE & BELOW GROUND UTILITIES BEFORE EXECUTING THE WORK.
- UPON THE REMOVAL OF ALL CONSTRUCTION & FILL DEBRIS ASSOCIATED WITH THE BUILDING DEMOLITION, CONTRACTOR IS TO PROVIDE LETTER OF CONFIRMATION TO CVS.

#### DEMOLITION LEGEND

- |   |  |
|---|--|
|  | DEMOLISH & REMOVE EXISTING MISCELLANEOUS CONCRETE ITEMS  |
|  | DEMOLISH & REMOVE EXISTING ASPHALT, CONCRETE, AND GRAVEL |
|  | UTILITIES TO BE REMOVED                                  |
|  | MANHOLES AND OTHER UTILITY STRUCTURES TO BE REMOVED      |
|  | TREES & SHRUBS TO BE REMOVED                             |

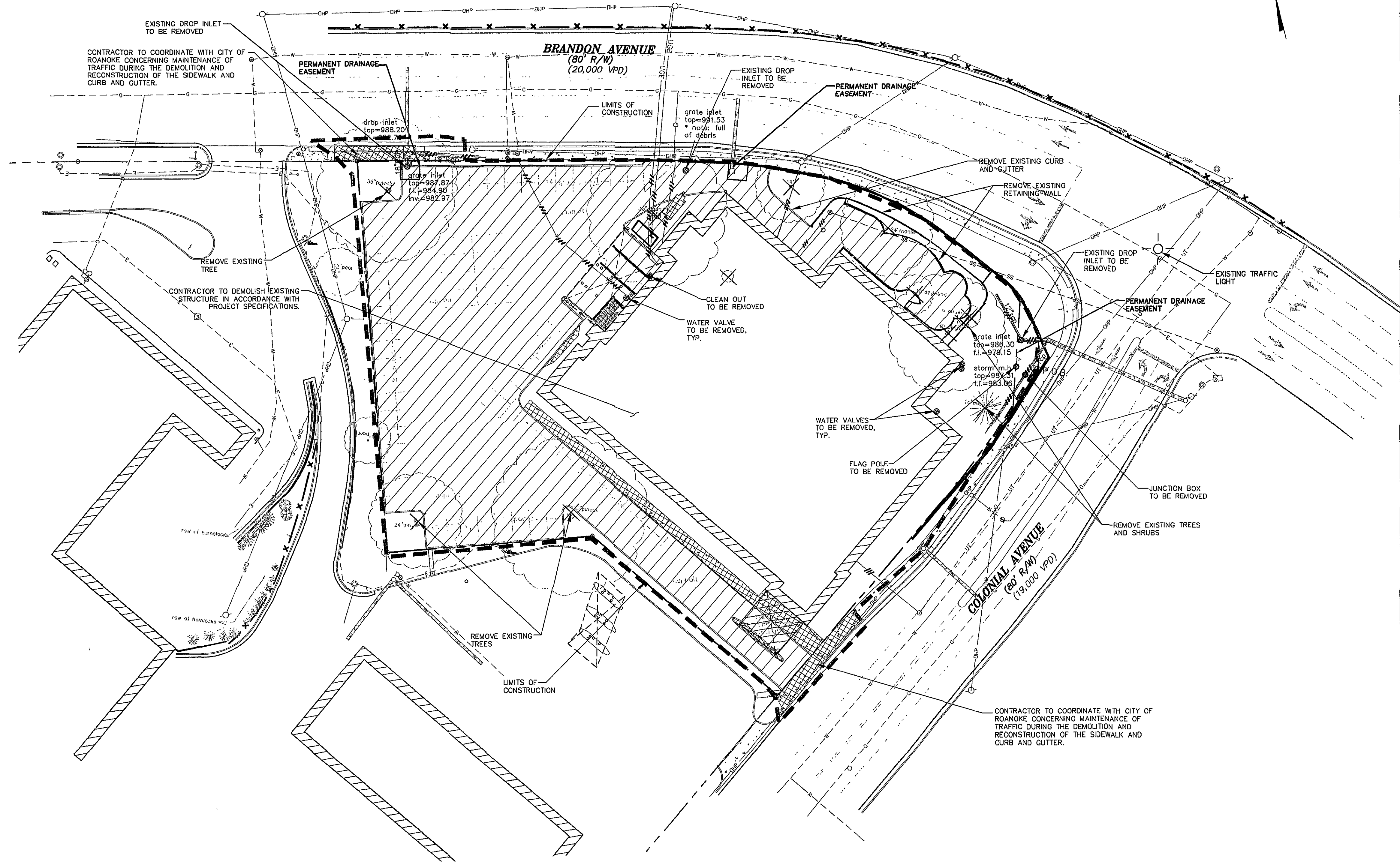

ROANOKE, VA  
CVS STORE 3949

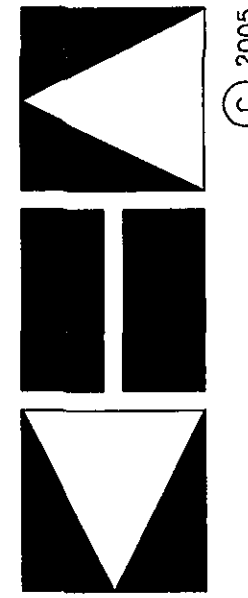
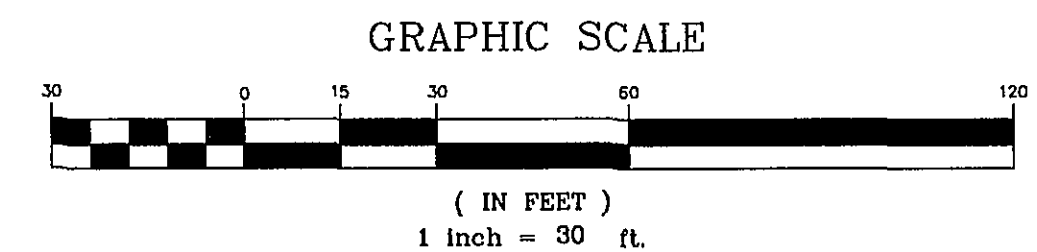

Kimley-Horn  
and Associates, Inc.  
1500 FOREST AVENUE, SUITE 115  
RICHMOND, VIRGINIA 23229

#### CONSULTANT:

KIMLEY-HORN AND ASSOC.  
1500 FOREST AVENUE  
TEL (804) 673-3882  
FAX (804) 673-3980

#### SEAL:

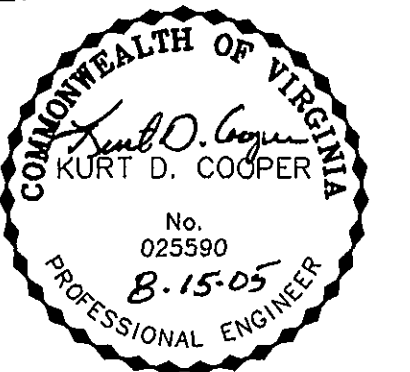

**CVS/**  
pharmacy

13,013 S.F. PROTOTYPE  
STORE NUMBER: #3949

INTERSECTION OF  
BRANDON AVE & COLONIAL AVE.  
ROANOKE, VIRGINIA

#### OWNER/DEVELOPER:

THE REBKEE COMPANY  
1020 OLD BON AIR ROAD  
RICHMOND, VA 23235  
PHONE: (804) 560-0500  
FAX: (804) 560-0778

#### REVISIONS:

|               |            |
|---------------|------------|
| LAYOUT COORD: | COB        |
| PLANNING MGR. | COB        |
| DRAWING BY:   | DHL        |
| DATE:         | 05/09/05   |
| JOB NUMBER:   | 113001048  |
| TITLE:        | DEMOLITION |

#### SHEET NUMBER:

C3

#### COMMENTS: