

CANTERBURY PARK SEWER LIFT STATION REMOVAL PROJECT

**SITUATED IN
CAVE SPRING MAGISTERIAL DISTRICT
ROANOKE COUNTY, VIRGINIA**

DATE: September 29, 2006

PREPARED FOR
WESTERN VIRGINIA WATER AUTHORITY

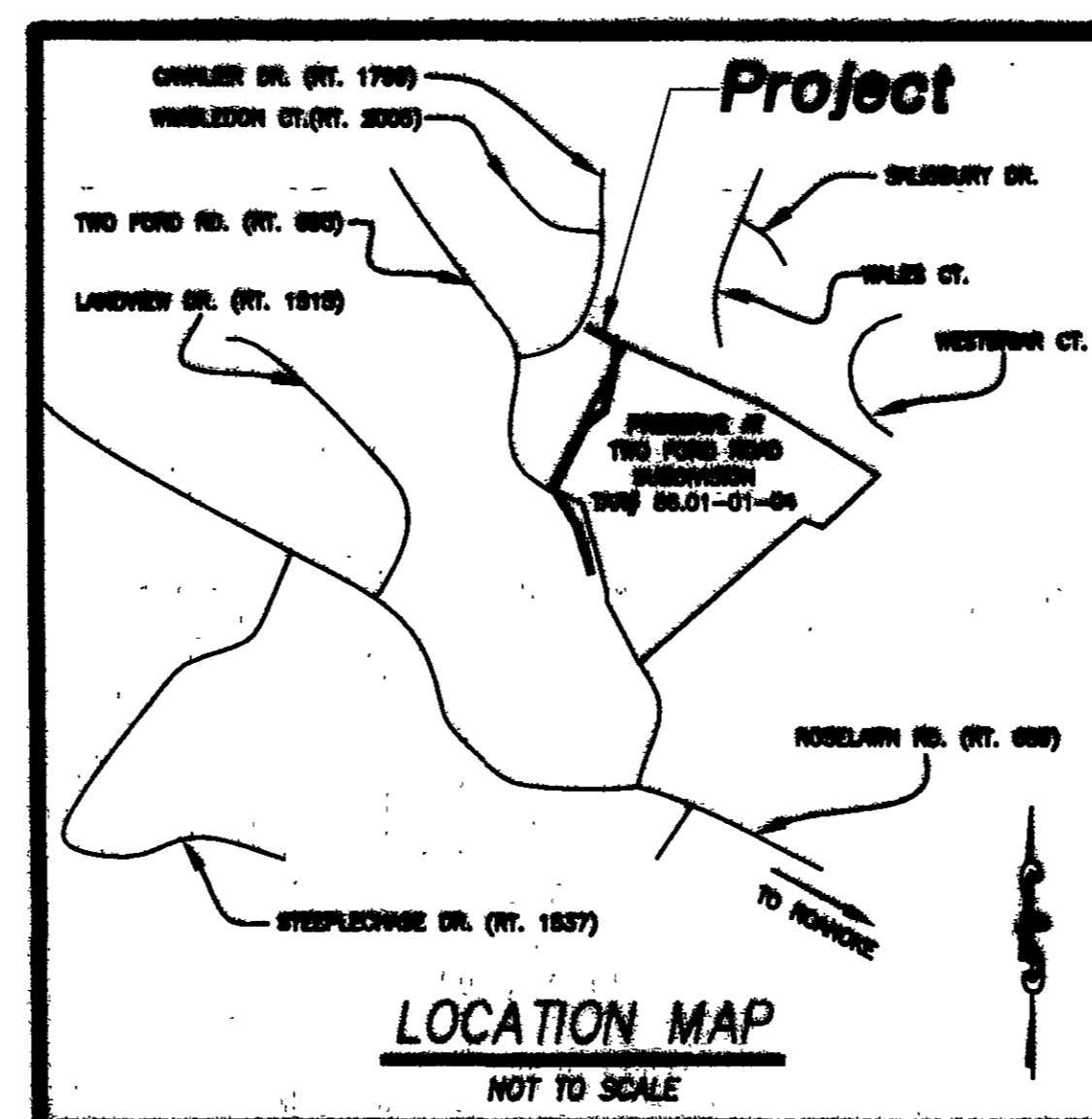

--INDEX OF DRAWINGS--

SHEET No.	DESCRIPTION
------------------	--------------------

1. LUMSDEN ASSOCIATES COVER SHEET
2. ROANOKE COUNTY COVER SHEET
3. NOTES AND DETAILS
4. PLAN, NOTES, AND DETAILS
5. PROFILE AND DETAILS
6. EROSION AND SEDIMENT CONTROL DETAILS

I AM CERTIFIED BY THE STATE OF VIRGINIA AS A "RESPONSIBLE LAND DISTURBER". I SHALL BE RESPONSIBLE FOR THE IMPLEMENTATION OF THE EROSION AND SEDIMENT CONTROL PLAN AS SHOWN.

SIGNATURE:
PRINTED NAME:
CERTIFICATE No.:
EXPIRATION DATE:
TELEPHONE No.:
ADDRESS:



LUMSDEN ASSOCIATES, P.C.
ENGINEERS-SURVEYORS-PLANNERS

4664 BRAMBLETON AVENUE, SW
P.O. BOX 20669
ROANOKE, VIRGINIA 24018

PHONE: (540) 774-4411
FAX: (540) 772-9445
E-MAIL: MAIL@LUMSDENPC.COM

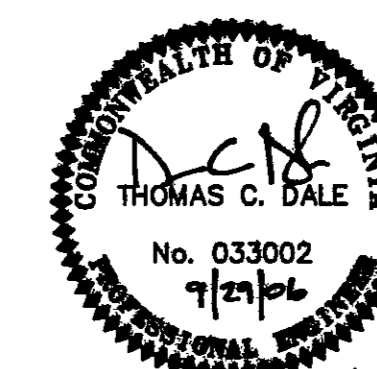

11/25/08

— "AS-BUILT" —

1. ~~DIFFERENCES BETWEEN~~ "INFORMATION TAKEN FROM PLANS
FURNISHED BY THE DESIGNER."

2. "AS-BUILT" DIMENSIONS ARE SHOWN IN BRACKETS.

REVISIONS	
DATE	SHEETS
10/31/04	4, 5
1/21/05	4, 5
COMMISSION NO. 2005-203	
SHEET 1 OF 6	