

Filename: \\NA-AECOM\NET\COMMON\FS\MER\ROANOKE\USRN\1\DCS\PROJECTS\BDBL\60609975\9000_CAD_GIS\910_CAD\15-SHEET\SC\60609975_C-106.DWG

MATCHLINE SEE SHEET C-105

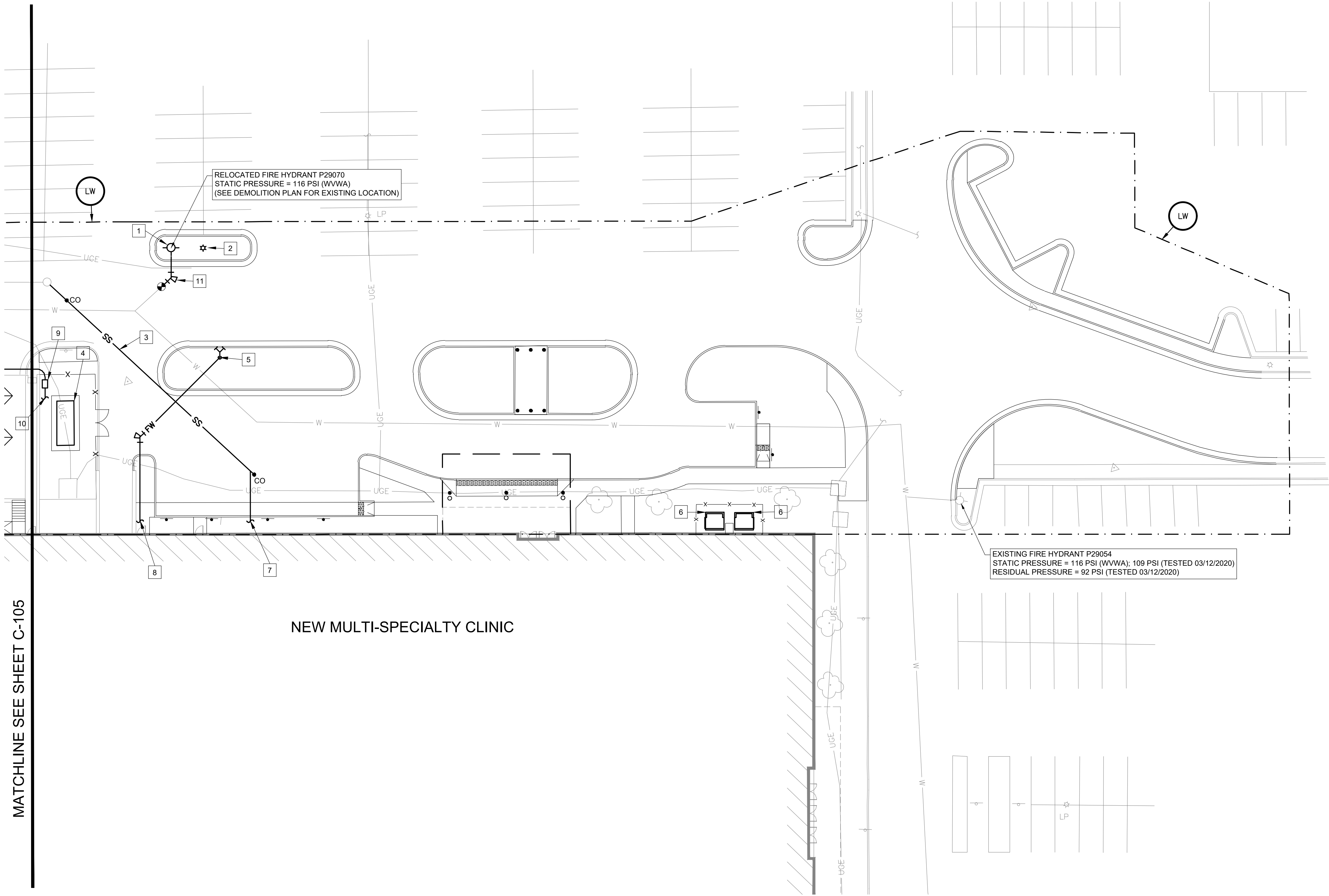

NEW MULTI-SPECIALTY CLINIC

GENERAL NOTES THIS SHEET

- A. APPROVAL OF SITE PLAN DOES NOT INCLUDE THE DESIGN OF THE FIRE SPRINKLER SYSTEM UNDERGROUND PIPING PRIOR TO INSTALLATION. SHOP DRAWINGS AND SEPARATE PERMIT APPLICATION MUST BE SUBMITTED THROUGH THE ROANOKE COUNTY DEPARTMENT OF BUILDING INSPECTIONS FOR REVIEW AND APPROVAL.
- B. GAS METER AND SERVICE BY ROANOKE GAS. COORDINATE LOCATION, SIZE, AND CAPACITY WITH ROANOKE GAS.

SHEET KEYNOTES:

- RELOCATED FIRE HYDRANT.
- RELOCATED LIGHT POLE.
- PROVIDE 8" SANITARY SEWER LATERAL FROM BUILDING TO EXISTING SANITARY MANHOLE. 1.0% MIN SLOPE. CORE DRILL EXISTING MANHOLE PER WWVA STANDARDS. PROVIDE SANITARY SEWER CLEANOUTS (CO) WHERE SHOWN.
- PROVIDE CONCRETE EQUIPMENT PAD FOR EMERGENCY ELECTRICAL POWER GENERATOR. FURNISHED BY OWNER AND INSTALLED BY CONTRACTOR. SEE ELECTRICAL. SEE STRUCTURAL FOR EXTERIOR EQUIPMENT PAD DETAIL.
- PROVIDE 4" FIRE DEPARTMENT CONNECTION WITH "KNOX" LOCKING CAPS.
- PROVIDE CONCRETE EQUIPMENT PADS FOR UPGRADED ELECTRICAL TRANSFORMERS. SEE ELECTRICAL FOR TRANSFORMERS. SEE STRUCTURAL FOR EXTERIOR EQUIPMENT PAD DETAIL.
- SEE PLUMBING FOR CONTINUATION.
- SEE FIRE PROTECTION FOR CONTINUATION.
- GAS METER BY ROANOKE GAS FOR GENERATOR GAS SUPPLY.
- CONNECT GAS LINE TO EMERGENCY GENERATOR.
- PROVIDE THRUST BLOCK (TYPICAL). SEE WWVA DETAIL W-18, SHEET C-502.

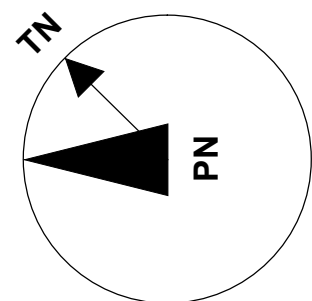

GRAPHIC SCALES

AECOM

PROJECT

**CARILION
TANGLEWOOD
MULTI-SPECIALTY
CLINIC**

TANGLEWOOD MALL
4444 ELECTRIC ROAD
ROANOKE, VIRGINIA 24018

CLIENT



CONSULTANT

AECOM
10 South Jefferson Street, Suite 1600
Roanoke, Virginia 24011
540.857.3100 tel 540.857.3180 fax
www.aecom.com

REGISTRATION



ISSUE/REVISION

I/R	DATE	DESCRIPTION
1	09/23/2020	COUNTY SITE DEV PLAN [2]
1	06/19/2020	COUNTY SITE DEV PLAN
1	05/04/2020	DESIGN DEVELOPMENT

PROJECT NUMBER

60609975

SHEET TITLE

**SITE UTILITY PLAN -
EAST**

SHEET NUMBER

C-106