

Filename: \\NA-AECOM\NET\COM\FS\AMER\ROANOKE\USRN\1\DCS\PROJECT\SB\DL\6060997\5\900_CAD_GIS\910_CAD\15-SHEET\SC\6060997_5_C-08.DWG

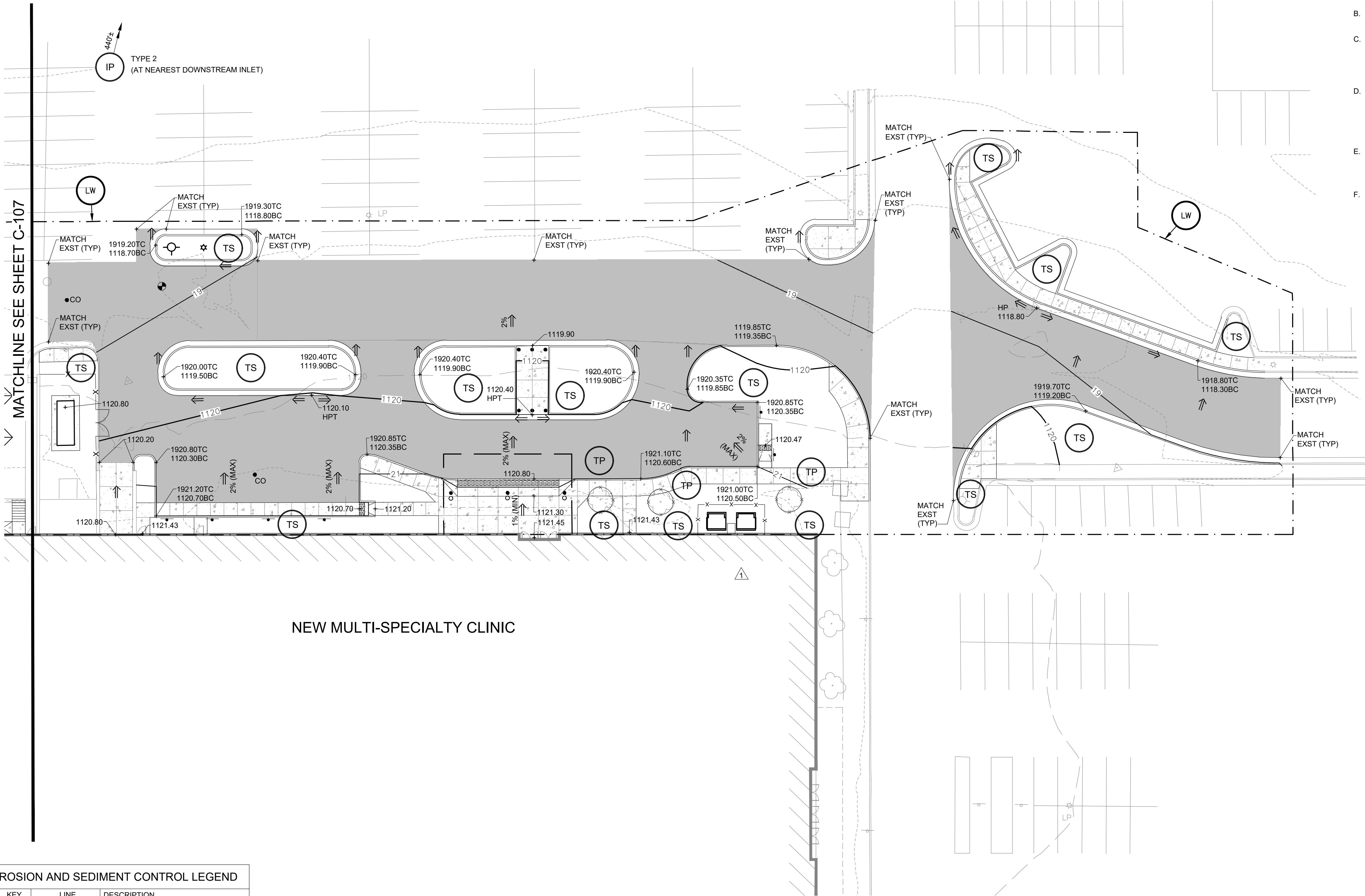

NEW MULTI-SPECIALTY CLINIC

EROSION AND SEDIMENT CONTROL LEGEND

| SECT. | KEY | LINE | DESCRIPTION |
|-------|------|--------|----------------------------------|
| 3.01 | (SF) | —X— | SAFETY FENCE |
| 3.07 | (IP) | (IP) | STORM DRAIN INLET PROTECTION |
| 3.30 | (TO) | ←(TO)→ | TOPSOILING (SEE NOTE 2) |
| 3.31 | (TS) | ←(TS)→ | TEMPORARY SEEDING (SEE NOTE 2) |
| 3.32 | (PS) | ←(PS)→ | PERMANENT SEEDING (SEE NOTE 2) |
| 3.35 | (MU) | ←(MU)→ | MULCHING (SEE NOTE 2) |
| 3.38 | (TP) | ←(TP)→ | TREE PRESERVATION AND PROTECTION |

- NOTES:
- "SECT" REFERS TO THE VIRGINIA EROSION & SEDIMENT CONTROL HANDBOOK (VESCH) NUMERICAL SPECIFICATION SECTION DESIGNATION.
 - TYPICAL AREAS SHOWN TO RECEIVE TEMPORARY SEEDING (TS) SHALL ALSO RECEIVE TOPSOILING (TO), PERMANENT STABILIZATION (PS), AND MULCHING (MU) MEASURES.

| EROSION AND SEDIMENT CONTROL COST ESTIMATE | | | | | |
|--|----------|------|------------|----------|----------|
| ITEM | QUANTITY | UNIT | UNIT PRICE | COST | BONDABLE |
| INLET PROTECTION | 2 | EA | \$ 150 | \$ 300 | \$ 300 |
| TEMPORARY SEEDING | 12,215 | SF | \$ 0.04 | \$ 489 | \$ 489 |
| TOPSOIL, 3" | 125 | LCY | \$ 12.50 | \$ 1,563 | \$ 1,563 |
| PERMANENT SEEDING | 12,215 | SF | \$ 0.05 | \$ 611 | \$ 611 |
| MULCHING | 12,215 | SF | \$ 0.04 | \$ 489 | \$ 489 |
| TREE PROTECTION | 3 | EA | \$ 100 | \$ 300 | \$ 300 |
| SUBTOTAL | | | | \$ 3,752 | \$ 3,752 |
| 10% CONTINGENCY | | | | \$ 375 | \$ 375 |
| ESTIMATED TOTAL | | | | \$ 4,127 | |
| ESTIMATED BONDABLE TOTAL | | | | | \$ 4,127 |

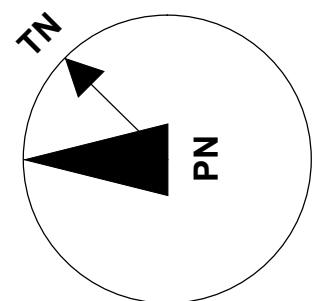

GRAPHIC SCALES

GENERAL NOTES THIS SHEET

- CROSS SLOPES FOR SIDEWALKS AND PEDESTRIAN CROSSINGS SHALL NOT EXCEED 2%.
- SLOPES IN ACCESSIBLE PARKING AREAS SHALL NOT EXCEED 2% IN ANY DIRECTION.
- PROVIDE REVERSE GUTTER SLOPE WHERE FINISH GRADE DRAINS AWAY FROM CURBING. REVERSE GUTTER SLOPES SHALL MATCH ADJACENT PAVEMENT GRADES. PROVIDE TRANSITIONS BETWEEN NORMAL AND REVERSE GUTTER SLOPES.
- ALL AREAS THAT ARE DISTURBED AND WILL NOT RECEIVE PAVEMENT OR STRUCTURES SHALL RECEIVE VEGETATIVE STABILIZATION. TYPICAL AREAS SHOWN TO RECEIVE TEMPORARY SEEDING (TS) SHALL ALSO RECEIVE TOPSOILING (TO), PERMANENT STABILIZATION (PS), AND MULCHING (MU) MEASURES.
- PROVIDE TEMPORARY CONSTRUCTION SAFETY FENCING (SAF) AROUND WORK. PHASE CONSTRUCTION FENCING SUCH THAT ACCESS TO OTHER TENANTS IS MAINTAINED THROUGHOUT CONSTRUCTION.
- PROVIDE POSITIVE DRAINAGE - STANDING WATER NOT PERMITTED.



PROJECT

CARILION
TANGLEWOOD
MULTI-SPECIALTY
CLINIC

TANGLEWOOD MALL
4444 ELECTRIC ROAD
ROANOKE, VIRGINIA 24018

CLIENT



CONSULTANT

AECOM

10 South Jefferson Street, Suite 1600
Roanoke, Virginia 24011
540.857.3100 tel 540.857.3180 fax
www.aecom.com

REGISTRATION



ISSUE/REVISION

| I/R | DATE | DESCRIPTION |
|-----|------------|--------------------------|
| 2 | 09/23/2020 | COUNTY SITE DEV PLAN [2] |
| 1 | 08/07/2020 | SI-03: ADD GRADING SPOTS |
| 1 | 06/19/2020 | COUNTY SITE DEV PLAN |
| 1 | 05/04/2020 | DESIGN DEVELOPMENT |

PROJECT NUMBER

60609975

SHEET TITLE

SITE GRADING PLAN -
EAST

SHEET NUMBER

C-108