

- GENERAL NOTES:**
1. THE LOCATION OF EXISTING UTILITIES IS APPROXIMATE BASED UPON FIELD LOCATIONS OF VISIBLE ITEMS. THE CONTRACTOR SHALL ANTICIPATE ENCOUNTERING UNDERGROUND ELECTRIC, TELEPHONE, CABLE LINES, EXISTING WATERLINES, AND EXISTING DRAINAGE LINES. THE CONTRACTOR SHALL CONTACT "MISS UTILITY" PRIOR TO ANY EXCAVATION.
  2. REFERENCE IS DIRECTED TO SHEET C2 FOR DESCRIPTION OF "S-#" AND HOW IT CORRESPONDS TO THE WESTERN VIRGINIA WATER AUTHORITY DETAIL "DD-##".
  3. THE CONTRACTOR SHALL RECONSTRUCT THE EXISTING CONCRETE DITCH IN THE AREA BETWEEN MANHOLE 111 AND 112. THE CONTRACTOR SHALL MATCH EXISTING GRADES, SLOPES, AND THICKNESS OF THE EXISTING CONCRETE DITCH.
  4. REFERENCE IS DIRECTED TO THE SANITARY SEWER STUB LINES FROM EACH MANHOLE FOR FUTURE SANITARY SEWER EXTENSION.
  5. REFERENCE IS DIRECTED TO THE EXISTING DOGHOUSE AND FENCE AREA TO BE REMOVED. THE CONTRACTOR SHALL WASTE ALL MATERIALS OFF SITE. THE REMOVAL OF THE DOGHOUSE AND FENCE AREA WAS INCLUDED WITH THE EASEMENT AGREEMENT, REFERENCE IS DIRECTED TO LEGAL REFERENCE ON SHEET C2.
  6. REFERENCE IS DIRECTED TO THE BENCHMARKS SHOWN ON THE PLAN. THESE BENCHMARKS ARE BASED ON A PROJECT DATUM TO MATCH ROANOKE COUNTY AERIAL TOPOGRAPHY. AN ACTUAL FIELD SURVEY WAS PERFORMED TO LOCATE EXISTING FEATURES AND GRADES WITHIN THE SANITARY SEWER ALIGNMENT. CONTOURS SHOWN WITHIN THE SANITARY SEWER ALIGNMENT ARE BASED ON ACTUAL FIELD SURVEYS.
  7. REFERENCE IS DIRECTED TO THE ASSOCIATED PROFILE SHOWING ADDITIONAL CONSTRUCTION ITEMS.
  8. REFERENCE IS DIRECTED TO THE REQUIRED EROSION CONTROL MEASURES FOR THE SANITARY SEWER INSTALLATION. REFERENCE IS DIRECTED TO THE "EROSION CONTROL NARRATIVE & DETAILS" FOR ADDITIONAL INFORMATION AND QUANTITIES.
  9. REFERENCE IS DIRECTED TO THE SANITARY SEWER MANHOLE DETAILS FOR CONSTRUCTION ANGLES AND LINES ENTERING AND LEAVING THE MANHOLE.
  10. THE CONTRACTOR SHALL COORDINATE WITH THE LAND OWNERS AND/OR RESIDENTS OF HOMES WHEN WORKING WITHIN EACH PROPERTY.
  11. THE CONTRACTOR SHALL DIRECTIONAL DRILL FROM MANHOLE 113 TO 114. THE SANITARY SEWER LINE IN THIS AREA SHALL NOT BE CONSTRUCTED BY OPEN CUT OF THE SOIL MATERIAL.

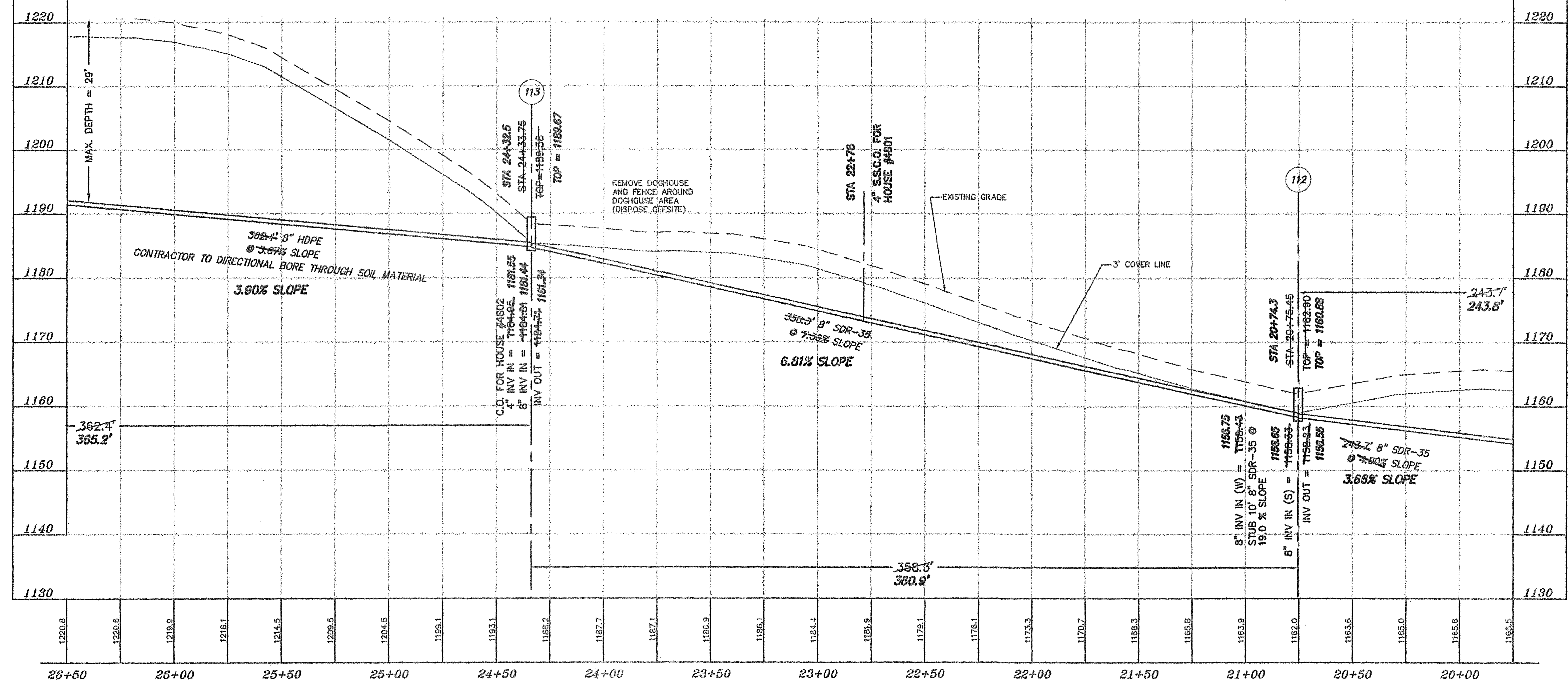
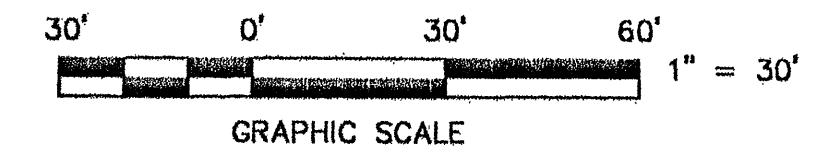

SANITARY SEWER PROFILE. SCALE: HORIZ: 1" = 30'. VERT: 1" = 10'

REVISED DEC. 9, 2005: AS-BUILT SURVEY OF SANITARY SEWER MANHOLES

DESIGNED BY: P.J. BROWN  
 DRAWN BY: P.J.B.  
 CHECKED BY: P.J.B.  
 W.O. #: 04-0071  
 N.B.: JR-248  
 TAX NO.: 054.04-05-01

**SANITARY SEWER PLAN - STA 19+75 THRU 26+25**  
 OF  
**PUBLIC SANITARY SEWER EXTENSION**  
**FROM WEST MAIN STREET TO PROPERTY**  
**OWNED BY TOWNSIDE CONSTRUCTION CO., INC.**  
 CATAWBA MAGISTERIAL DISTRICT  
 ROANOKE COUNTY, VIRGINIA

REVISED: 03 DECEMBER 2004 SCALE: 1" = 30'

**T. P. PARKER & SON**  
 618 Boulevard  
 Post Office Box 39  
 Salem, Virginia 24153  
 Telephone: 540-387-1153  
 FAX: 540-389-5787  
 04-0071-05SL-ASBL.DWG