

PROPERTY OF
TANGLEWOOD VENTURE LLC
ROANOKE COUNTY TAX PARCEL
077.16-01-02.00-0000
CURRENTLY ZONED C-2 COMMERCIAL

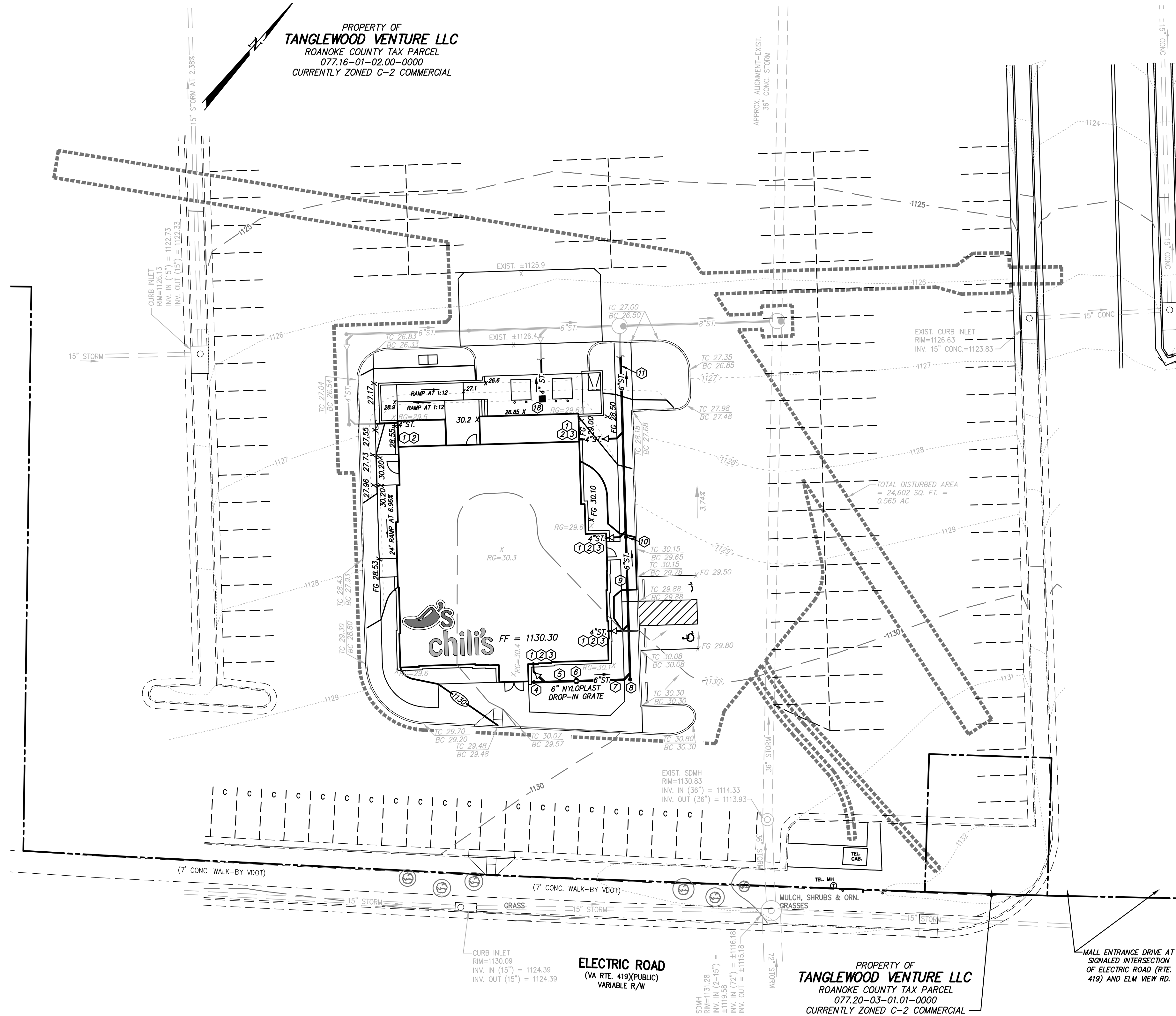

EXISTING GRADE AT TIME OF TENANT'S CONTRACTOR'S WORK

AS SHOWN ON PRECEDING SHEETS FOR LANDLORD WORK, THE LANDLORD'S CONTRACTOR HAS GRADED INSIDE CURB LINE IS TO GENERALLY PROVIDE A NORTH-SOUTH RIDGELINE INSIDE THE BUILDING PAD, WITH TOP OF RIDGE SET AT FINISH FLOOR. GRADES AT OUTER EDGES OF PAD ARE TO BE 8 INCHES BELOW FINISH FLOOR. THESE OUTER EDGES OF 'PAD' ARE LOCATED 3' BEYOND THE ACTUAL OUTER EDGE OF THE NEW BUILDING. SHADED SPOT ELEVATIONS IDENTIFIED HEREON AS 'RG' ARE ROUGH GRADE ELEVATIONS FOR THE LANDLORD'S WORK, AND REPRESENT EXISTING GRADE FOR THE TENANT'S CONTRACTOR.

ALL EARTHWORK SHALL BE PERFORMED IN ACCORDANCE WITH THE GEOTECHNICAL ENGINEERING REPORT PREPARED BY TERRACON CONSULTANTS INC. OF GREENSBORO, NC, DATED MAY 28, 2021 (REF: TERRACON PROJECT NO. 75215061). TENANT'S CONTRACTOR IS RESPONSIBLE FOR BACKFILLING ALL EXCAVATIONS WITH SUITABLE MATERIALS COMPACTED IN ACCORDANCE WITH ABOVE-REFERENCED REPORT, FOR THOSE AREAS WITHIN THE PERIMETER CURB LINE, AND FOR THE SERVICE AREA CONCRETE APRON.

STORM DRAIN CONSIDERATIONS

IN ORDER TO REDUCE THE POTENTIAL OF ICING DUE TO ROOF DRAIN RUNOFF CROSSING WALKWAYS, WE WILL BE TYING ALL ROOF DRAINS INTO A CLOSED SYSTEM OF 4" AND 6" SDR-35 PVC PIPE, WITH CLEANOUTS AND FITTINGS. WE WILL ALSO NEED TO INSTALL A SMALL NYLOPLAST IN-LINE GRATE INLET AT THE SOUTHEASTERN CORNER OF THE BUILDING, TO COLLECT A SMALL AREA OF WATER THAT CANNOT BE DRAINED OVERLAND.

THE NEW COLLECTION SYSTEMS SHALL BE TIED INTO THE STORM DRAIN STUB-OUTS SHOWN.

ALL NEW STORM DRAIN IS PRIVATE.

STORM DRAIN SCHEDULE - TENANT WORK

ALL NEW STORM DRAIN SHALL BE SDR-35 UNPLASTICIZED PVC PIPE. INSTALL IN ACCORDANCE WITH REQUIREMENTS FOR SANITARY SEWER PIPING (DISINFECTION & PRESSURE-TEST NOT REQUIRED).

ALL CLEANOUTS SHALL BE INSTALLED WITH TRAFFIC-BEARING FRAMES AND COVERS, WITH TOPS OF COVERS FLUSH WITH FINISH GRADE.

ALL LATERAL TO TRUNK CONNECTIONS SHALL BE MADE WITH WYE FITTINGS, NO TEES SHALL BE PERMITTED.

1. NEW ROOF DRAIN, SEE BUILDING PLANS. PROVIDE TRANSITION ADAPTERS AS REQUIRED TO CONNECT TO 4" SDR-35 PVC SITE COLLECTORS. MINIMUM INVERT AT FACE OF BUILDING = 2.0' BELOW BUILDING FINISH FLOOR.
2. PROVIDE 4" SDR-35 PVC AT 2.08% MIN.
3. PROVIDE 4"x6" ECCENTRIC ENLARGER. PROVIDE 6" PIPE AT MIN 1.04% AND WYE TO INTERCONNECT WITH TRUNK LINES.
4. PROVIDE 6" CLEANOUT ASS'Y., INV.=1128.00
5. PROVIDE 13'-6" AT 1.04%
6. PROVIDE 6" NYLOPLAST INLINE DRAIN. TOP GRATE=1129.3, INV.=1127.86
7. PROVIDE 17'-6" AT 1.04%
8. PROVIDE 6" CLEANOUT ASS'Y., INV.=1127.68
9. PROVIDE 46'-6" AT 5.32%
10. PROVIDE 6" CLEANOUT ASS'Y., INV.=1125.23
11. PROVIDE 69'-6" AT 5.32%, INV. OUT=1121.56

18. PROVIDE NEW AREA DRAIN AT DUMPSTERS, SEE PLUMBING SHEETS FOR DETAILS. THE STRUCTURE IS A 24"x24"x32" CATCH BASIN, WITH A "FILTREXX STORMEXX CATCH BASIN FILTER". INSTALL COMPLETE WITH CUSTOM FRAME, LARGE CARTRIDGE, TRASH SCREEN AND BUCKET.

REVISED TO CORRECT SHEET TITLE FROM
'LANDLORD WORK' TO 'TENANT WORK'

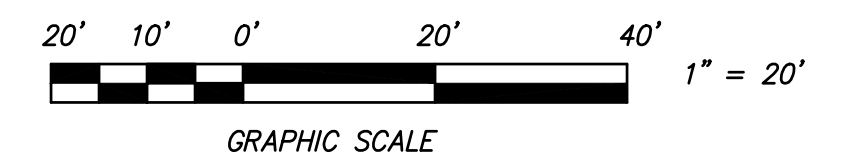

	TENANT WORK - GRADING AND STORM DRAIN PLAN FOR PROPOSED CHILI'S RESTAURANT TO BE CONSTRUCTED AT TANGLEWOOD MALL PREPARED FOR BRINKER INTERNATIONAL LLC & TANGLEWOOD VENTURE LLC SITUATE ELECTRIC ROAD (VA ROUTE 419) CAVE SPRING MAGISTERIAL DISTRICT COUNTY OF ROANOKE, VIRGINIA
	 CALDWELL WHITE ASSOCIATES ENGINEERS / SURVEYORS / PLANNERS 4203 MELROSE AVENUE P.O. BOX 6260 ROANOKE, VIRGINIA 24017-0260 (540) 366-3400 FAX: (540) 366-8702
Designed: C.L. White Drawn: C.L. White Checked: C.L. White Date: October 27, 2021 Scale: 1" = 20' Tax Parcel: 077.16-01-02.00-0000 Field Book: CH-22 W.O. No.: 21-0043/0084/0123	

REVISED DECEMBER 13, 2021 PER FIRST MUNICIPAL REVIEW - C.L. White