

PROJECT MANAGER: *Craig Moore, P.E., Salem District*  
 SURVEYED BY: *Dele Straker, Salem Survey Party (Party 60)*  
 DESIGN SUPERVISED BY: *Johnson, Mirmiran & Thompson (R04) 323-9900*  
 DESIGNED BY: *Johnson, Mirmiran & Thompson (R04) 323-9900*

**Rte. 688**  
 Curve 688-4  
 PI - 112-05.81  
 DELTA - 29° 35' 42.61" (RT)  
 D - 5' 32' 28"  
 T - 273.15'  
 L - 534.10'  
 R - 1034.00'  
 PC - 109-32.67  
 PT - 114-66.76  
 Lr - 59'  
 E - 3.0%  
 V - 35 MPH

**Rte. 688**  
 Curve 688-5  
 PI - 118-98.93  
 DELTA - 31° 11' 25.40" (RT)  
 D - 10' 08' 27"  
 T - 157.70'  
 L - 307.57'  
 R - 565.00'  
 PC - 117-41.23  
 PCC - 120-48.80  
 Lr - 74'  
 E - 3.8%  
 V - 35 MPH

**Rte. 1255 East**  
 Curve 1255-1  
 PI - 11-63.57  
 DELTA - 27° 29' 00.27" (RT)  
 D - 12' 43' 57"  
 T - 110.05'  
 L - 215.85'  
 R - 450.00'  
 PC - 10-53.52  
 PT - 12-69.38  
 E - Match Existing  
 V - 30 MPH

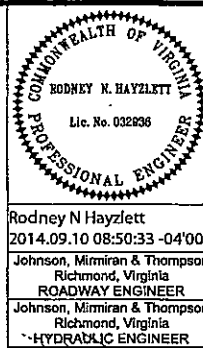

REVISED	STATE	ROUTE	PROJECT	SHEET NO.
12/02/13 04/09/14 06/24/14 07/02/14 08/07/14	VA.	688	0688-080-301, RW-201, C-501	5

DESIGN FEATURES RELATING TO CONSTRUCTION OR TO REGULATION AND CONTROL OF TRAFFIC MAY BE SUBJECT TO CHANGE AS REQUIRED NECESSARY BY THE DEPARTMENT OF TRANSPORTATION.

Rodney N Hayzlett  
 2014.09.10 08:50:33 -04'00'  
 Johnson, Mirmiran & Thompson  
 Richmond, Virginia  
 ROADWAY ENGINEER  
 Johnson, Mirmiran & Thompson  
 Richmond, Virginia  
 HYDRAULIC ENGINEER

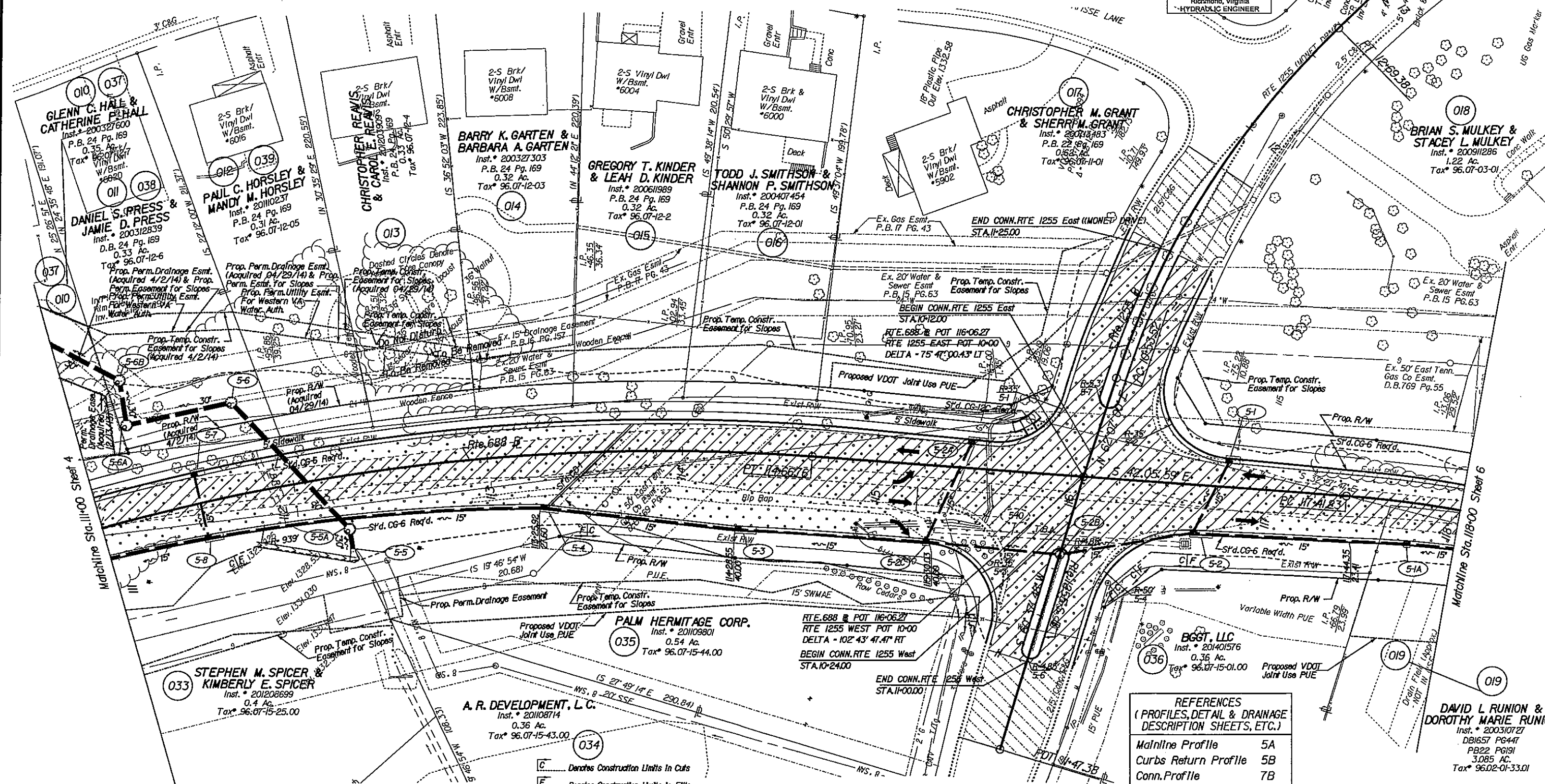

- C Denotes Construction Limits In Cuts
- F Denotes Construction Limits In Fills
- Denotes area of proposed pavement
- Denotes resurfacing and build-up of existing pavement
- Denotes area of demolition of pavement

Note: Dot-dashed lines denote Permanent Utility Easements.  
 Note: Dot-dashed lines denote Permanent Easements.  
 Note: Dot-dot-dashed lines denote Temporary Easements.

**REFERENCES**  
 (PROFILES, DETAIL & DRAINAGE DESCRIPTION SHEETS, ETC.)

Mainline Profile	5A
Curbs Return Profile	5B
Conn. Profile	7B
Drainage Descr.	9-9(1)
Utility Owners	3
Right-of-Way	5RW

