

SANITARY SEWER MAIN BEARINGS AND DISTANCES (MH CENTERS)		
LINE	BEARING	DISTANCE
1 TO 2	S 61° 10' 30" E	63.39'
2 TO 2A	S 07° 22' 08" E	175.00'
2A TO 2B	S 39° 17' 48" W	21.76'
2B TO 3	S 04° 43' 49" E	103.79'
3 TO 4	S 03° 15' 21" E	387.83'
4 TO 4A	S 26° 42' 34" E	22.20'
4A TO 4B	S 02° 28' 48" E	84.31'
4B TO 5	S 31° 24' 09" W	27.25'
5 TO 6	S 08° 55' 40" E	113.01'
6 TO 7	S 22° 35' 57" W	113.08'
8 TO 3	N 86° 44' 38" E	18.88'
9 TO 10	S 83° 28' 14" E	97.26'
10 TO 11	S 71° 56' 29" E	170.94'
11 TO 12	S 71° 56' 29" E	135.98'
12 TO 13	S 26° 56' 29" E	34.62'
13 TO 14	S 71° 56' 29" E	44.11'
14 TO 5	S 71° 56' 29" E	68.93'
15 TO 11	S 18° 03' 31" W	14.55'
16 TO 14	N 34° 43' 25" E	22.02'

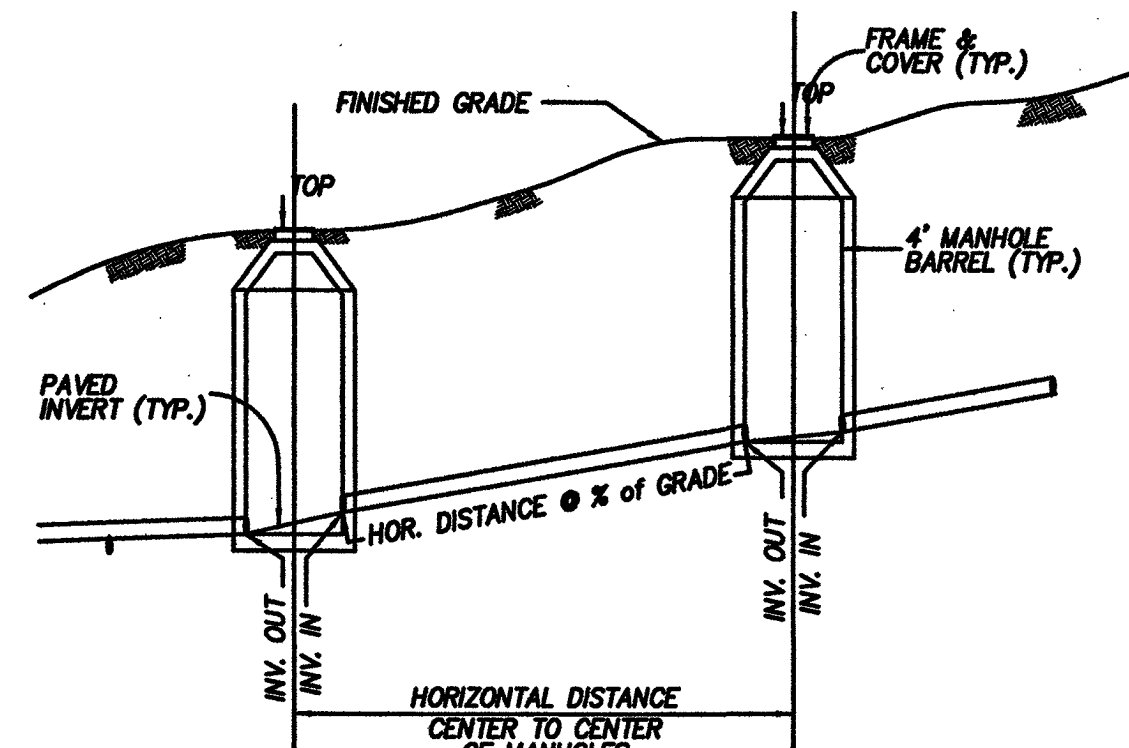

**SANITARY SEWER
HORIZONTAL AND SLOPE DISTANCE DETAIL**

NO SCALE

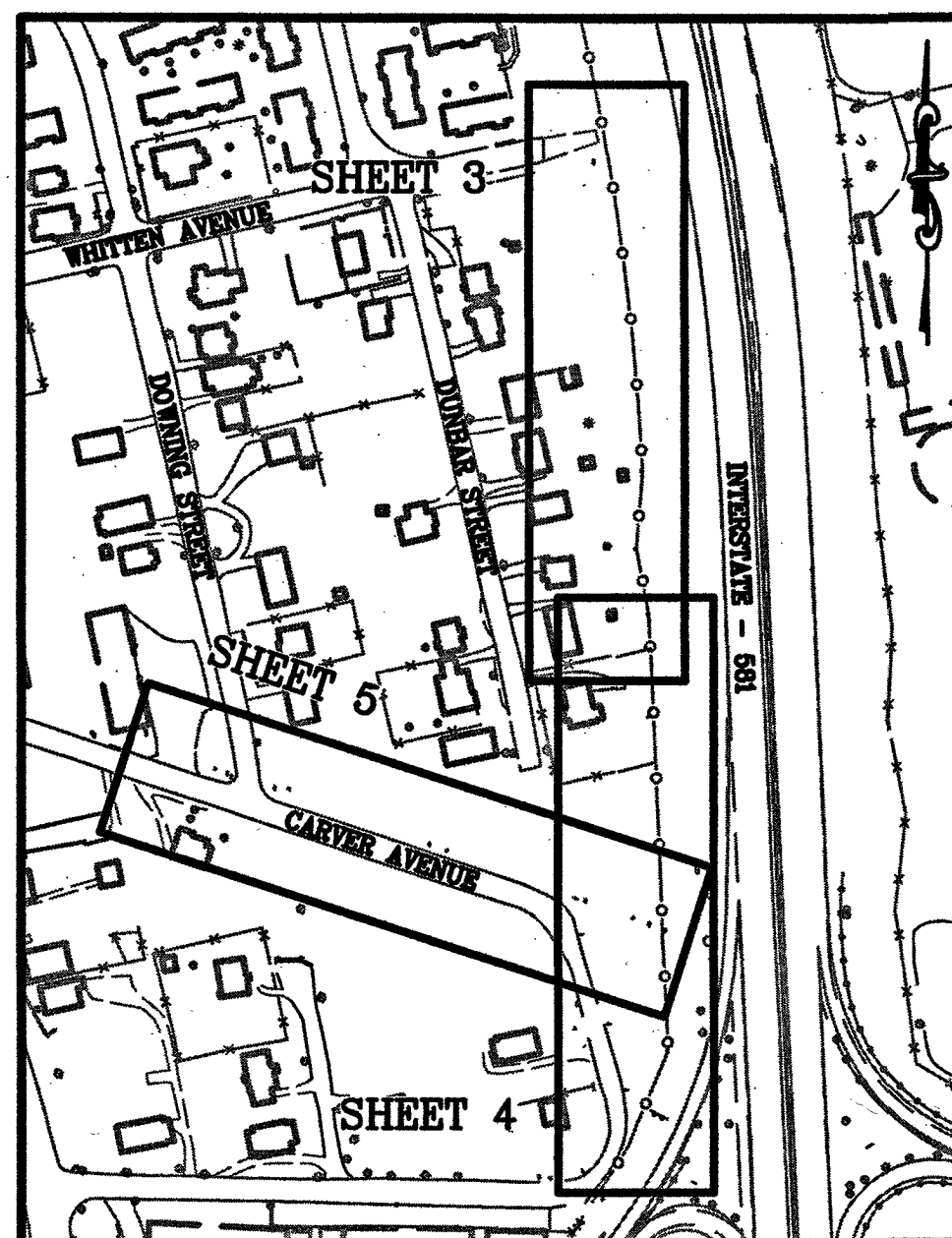

SHEET LAYOUT
1" = 200'

LEGEND		
ITEM	EXISTING	PROPOSED
Pavement	----	----
Curb and Gutter	=====	=====
Curb	-----	-----
Storm Drain Line	15" RCP	15" RCP
Sanitary Sewer Manhole	⊙	⊙
Sanitary Sewer Line	8" SS	8" SS
Waterline	8" W/L	8" W/L
Hydrant	⊙	⊙
Gate Valve	⊙	⊙
Underground Electric Line	---UE---	---UE---
Overhead Electric Line	---OHE---	---OHE---
Underground Telephone Line	---UGT---	---UGT---
Underground Gas Line	---G/L---	---G/L---
Utility Pole	⊙	⊙
Fence	--X--X--	--X--X--
Contours	---4216---	---4216---
Spot Elevation	1214.8 X	1214.8 X
Tie Line	~~~~~	~~~~~

ABBREVIATIONS	
D.E.	DRAINAGE EASEMENT
W.L.E.	WATER LINE EASEMENT
S.S.E.	SANITARY SEWER EASEMENT
P.U.E.	PUBLIC UTILITY EASEMENT
ESMT.	EASEMENT
M.B.L.	MINIMUM BUILDING LINE
R/W	RIGHT OF WAY
VAR.	VARIABLE
EX.	EXISTING
D.B.	DEED BOOK
P.B.	PLAT BOOK
PG.	PAGE
No.	NUMBER
TYP.	TYPICAL
STA.	STATION
L.T.	LEFT
R.T.	RIGHT
RCP	REINFORCED CONCRETE PIPE
CMP	CORRUGATED METAL PIPE
CPP	CORRUGATED PLASTIC PIPE
PVC	POLYVINYL CHLORIDE
DIP	DUCTILE IRON PIPE
SD	STORM DRAIN
SDMH	STORM DRAIN MANHOLE
SS	SANITARY SEWER
SSMH	SANITARY SEWER MANHOLE
W	WATER LINE

GENERAL UTILITY NOTES

- ALL CONSTRUCTION METHODS AND MATERIALS SHALL CONFORM TO THE LATEST EDITION OF THE WESTERN VIRGINIA REGIONAL DESIGN AND CONSTRUCTION STANDARDS AVAILABLE AT WWW.WESTERNVAVATER.ORG OR BY CONTACTING THE AUTHORITY AT 540-853-5700. THE PROJECT SHALL ALSO COMPLY WITH THE GOVERNING JURISDICTION'S STANDARDS AND OTHER AGENCY STANDARDS (E.G., VDOT, DEQ, DCR, VDM, ETC.) WHERE APPLICABLE.
- THE AUTHORITY WILL INSTALL ALL NEW WATER METERS AND REMOVE ALL EXISTING WATER METERS. THE CONTRACTOR SHALL INSTALL COMPLETE NEW WATER SERVICES INCLUDING THE METER SETTER AND BOX. FOLLOWING METER REPLACEMENT BY THE AUTHORITY, THE CONTRACTOR SHALL DEMOLISH THE EXISTING METER SETTER AND BOX. THE CONTRACTOR SHALL COORDINATE EXISTING METER REMOVAL AND NEW METER INSTALLATION DIRECTLY WITH THE AUTHORITY. THE CONTRACTOR SHALL PROVIDE AT LEAST THREE (3) BUSINESS DAYS ADVANCE NOTICE TO THE AUTHORITY PRIOR TO NEEDING METER INSTALLATIONS. THE CONTRACTOR SHALL SEQUENCE CONSTRUCTION ACTIVITY TO PROVIDE A SERIES OF AT LEAST TEN (10) SERVICES THAT ARE READY TO RECEIVE NEW METERS BEFORE CONTACTING THE AUTHORITY FOR WATER METER REPLACEMENT.
- ALL CONNECTIONS TO EXISTING WATERLINES SHALL BE PERFORMED BY THE AUTHORITY. THE CONTRACTOR SHALL PROVIDE FULL STAINLESS STEEL TAPPING SLEEVE(S) AND VALVE(S). THE CONTRACTOR SHALL EXCAVATE TO THE EXISTING WATERLINE, SHORE THE TRENCH PER OSHA REQUIREMENTS, CLEAN THE EXISTING WATERLINE, AND INSTALL THE TAPPING SLEEVE AND VALVE PRIOR TO THE AUTHORITY PERFORMING THE TAP. THE CONTRACTOR SHALL NOTIFY THE AUTHORITY'S UTILITY LINE SERVICES DIVISION AT 540-853-2792 AT LEAST SEVENTY-TWO (72) HOURS PRIOR TO REQUIRING THE CONNECTION.
- ALL CONNECTIONS TO EXISTING SANITARY SEWERLINES SHALL BE PERFORMED BY THE AUTHORITY. THE CONTRACTOR SHALL EXCAVATE TO THE EXISTING SEWERLINE, SHORE THE TRENCH PER OSHA REQUIREMENTS, AND CLEAN THE EXISTING SEWERLINE PRIOR TO THE AUTHORITY PERFORMING THE TAP. THE CONTRACTOR SHALL NOTIFY THE AUTHORITY'S UTILITY LINE SERVICES DIVISION AT 540-853-2792 AT LEAST SEVENTY-TWO (72) HOURS PRIOR TO REQUIRING THE CONNECTION.
- THE CONTRACTOR SHALL PERFORM ALL MANHOLE CONNECTIONS. THE CORING AND BOOT INSTALLATION SHALL BE INSPECTED AND APPROVED BY AN AUTHORITY CONSTRUCTION INSPECTOR PRIOR TO ACTIVATING SEWER SERVICE. THE CONTRACTOR SHALL CONTACT THE AUTHORITY'S CONSTRUCTION INSPECTOR RESPONSIBLE FOR THE PROJECT AT LEAST ONE (1) DAY PRIOR TO INITIATING THE MANHOLE CONNECTION.
- PRIOR TO CONSTRUCTION IN THE RIGHT-OF-WAY, ALL APPLICABLE PERMIT(S) FROM THE GOVERNING JURISDICTION AND/OR AGENCY MUST BE OBTAINED AND A COPY KEPT ON THE PROJECT SITE.
- FOR PROJECTS REQUIRING TRAFFIC CONTROL IN THE CITY OF ROANOKE, NOTIFY MANAGER OF TRANSPORTATION, MARK JAMISON, AT 540-853-5471 AT LEAST TWO WEEKS IN ADVANCE OF REQUIRING TRAFFIC CONTROL. FOR A LANE CLOSURE PERMIT IN THE CITY OF ROANOKE, CONTACT THE TRAFFIC ENGINEER, HONG LUU, AT 540-853-2886. IN ROANOKE OR FRANKLIN COUNTIES, TRAFFIC CONTROL REQUIREMENTS SHALL BE DETERMINED ONCE THE VDOT AND USE PERMIT HAS BEEN ISSUED. PLEASE CONTACT THE LOCAL VDOT OFFICE. TRAFFIC CONTROL SHALL BE PROVIDED IN ACCORDANCE WITH THE MOST RECENT MUTCD MANUAL AND THE VDOT WORK AREA PROTECTION MANUAL UNLESS OTHERWISE SPECIFIED.
- THE CONTRACTOR SHALL NOTIFY THE AUTHORITY'S ENGINEERING COORDINATOR, MARK SINK, AT 540-537-3460 AT LEAST THREE (3) DAYS PRIOR TO CONSTRUCTION.
- A PRE-CONSTRUCTION CONFERENCE SHALL BE SCHEDULED AT LEAST ONE (1) DAY PRIOR TO ANY CONSTRUCTION.
- THE CONTRACTOR SHALL HAVE A VALID MISS UTILITY TICKET PRIOR TO EXCAVATION. CONTACT MISS UTILITY AT 1-800-552-7001.
- ALL EXISTING UTILITIES MAY NOT BE SHOWN OR MAY NOT BE SHOWN IN THEIR EXACT LOCATION. CONTRACTOR SHALL LOCATE ALL UTILITIES AND DETERMINE ALL INVERTS PRIOR TO CONSTRUCTION TO ALLOW FOR ADJUSTMENTS DUE TO CONFLICTS WITH OTHER UTILITIES. THE CONTRACTOR SHALL COMPLY WITH THE VIRGINIA STATE WATER WORKS REGULATIONS, SECTION 12VACS-590-1150, AND THE VIRGINIA STATE SEWAGE COLLECTION AND TREATMENT REGULATIONS WHERE LINES CROSS.
- AN APPROVED SET OF PLANS AND PERMITS MUST BE AVAILABLE AT THE CONSTRUCTION SITE AT ALL TIMES.
- CONSTRUCTION DEBRIS SHALL BE CONTAINERIZED IN ACCORDANCE WITH THE VIRGINIA LITTER CONTROL ACT.
- PRIOR TO COMMENCING WORK, THE CONTRACTOR'S CERTIFIED RESPONSIBLE LAND DISTURBER SHALL OBTAIN AN EROSION AND SEDIMENT CONTROL PERMIT FOR THE PROJECT FROM THE LOCAL GOVERNING JURISDICTION AND DEQ (IF REQUIRED). ALL EROSION AND SEDIMENT CONTROL MEASURES MUST BE IN ACCORDANCE WITH THE LATEST EDITION OF THE VIRGINIA EROSION AND SEDIMENT CONTROL HANDBOOK AND SHALL BE INSTALLED PRIOR TO CONSTRUCTION.
- THE CONTRACTOR SHALL PROVIDE ADEQUATE MEANS OF CLEANING ALL VEHICLES AND EQUIPMENT PRIOR TO ENTERING PUBLIC STREETS. IT IS THE CONTRACTOR'S RESPONSIBILITY TO ENSURE THAT THE STREETS ARE KEPT IN A CLEAN, MUD- AND DUST-FREE CONDITION AT ALL TIMES.
- FIELD CHANGES SHALL BE APPROVED BY THE AUTHORITY'S ENGINEERING DIVISION PRIOR TO SUCH CONSTRUCTION.
- THE CONTRACTOR SHALL MAKE PROMSIONS TO PROVIDE ACCESS TO ALL PROPERTIES DURING CONSTRUCTION AND SHALL MAINTAIN SAFE ACCESSIBILITY TO FIRE HYDRANTS AT ALL TIMES.
- THE CONTRACTOR SHALL BE RESPONSIBLE FOR LOCATING AND UNCOVERING ALL MANHOLES AFTER PAVING. MANHOLE RIMS SHALL BE INSTALLED TO GRADE AND FLUSH WITH THE FINAL PAVEMENT.
- UNREPAIRED ROADWAYS OPENED TO TRAFFIC SHALL HAVE, AT A MINIMUM, COMPACTED AGGREGATE MATERIAL VDOT 21A OR 21B FLUSH WITH THE ADJACENT ROADWAY SURFACE AND SHALL BE INSPECTED AND REPAIRED ON A DAILY BASIS. SOME AREAS WILL REQUIRE A TEMPORARY PATCH UNTIL FINAL PAVING CAN BE COMPLETED.
- THE CONTRACTOR SHALL NOT EXCAVATE MORE TRENCH LENGTH THAN CAN BE RESTORED WITHIN THE SAME WORK DAY. ALL TRENCHES SHALL BE BACKFILLED OR PLATED AT THE END OF EACH WORK DAY OR WHEN THE CONTRACTOR IS NOT ON SITE.
- THE CONTRACTOR SHALL SUPPLY THE AUTHORITY WITH CORRECT AS-BUILT PLANS BEFORE SUBSTANTIAL COMPLETION WILL BE GRANTED.

SANITARY SEWER NOTES

- INSTALL SANITARY SEWER IN ACCORDANCE WITH THE DETAILS SHOWN ON THESE DRAWINGS AND ALL OTHER AUTHORITY REGULATIONS.
- A TYPICAL MINIMUM COVER OF THREE (3) FEET IS REQUIRED OVER PROPOSED SANITARY SEWER LINES UNLESS OTHERWISE INDICATED ON PLANS.
- ALL SANITARY SEWER PIPE INSTALLED ON THIS PROJECT SHALL CONFORM TO THE TYPE, CLASSIFICATION, AND SIZES AS SHOWN ON THESE PLANS AND AS DESCRIBED IN THE SPECIFICATIONS.
- UNLESS OTHERWISE NOTED, ALL SANITARY SEWER MANHOLES SHALL HAVE AUTHORITY STANDARD WATERTIGHT FRAMES AND COVERS.
- ALL SANITARY SEWER SHALL BE INSTALLED ACCORDING TO THE PROFILES INCLUDED WITH THESE PLANS.
- PRIOR TO ORDERING MATERIAL OR BEGINNING INSTALLATION OF SANITARY SEWER CONTRACTOR SHALL DIG TEST HOLES AT ALL CONNECTION POINTS BETWEEN EXISTING MANHOLES TO VERIFY HORIZONTAL AND VERTICAL POSITIONS ALONG WITH PIPE SIZE AND MATERIAL TYPE. CONTRACTOR SHALL ALSO VERIFY ELEVATIONS FOR CONNECTIONS AT EXISTING MANHOLES.
- ALL WATERLINES SHALL CROSS OVER SANITARY SEWER LINES IN ACCORDANCE WITH VIRGINIA WATERWORKS REGULATIONS SECTION 12VACS-590-1150.
- WHERE SANITARY SEWER LINE MUST CROSS UNDER STORM DRAINS, PIPES SHALL HAVE A MINIMUM OF 18" OF SEPARATION, OR THE STORM PIPE SHALL BE SUPPORTED IN ACCORDANCE WITH THE AUTHORITY'S DETAIL.
- ALL SANITARY SEWER LINES AND MANHOLES SHALL BE SUBJECTED TO ACCEPTANCE TESTS. SANITARY SEWER LINES SHALL BE AIR PRESSURE TESTED, AND MANHOLES SHALL BE VACUUM TESTED. TESTING PROCEDURE AND ALLOWABLE PRESSURE/VACUUM DROP SHALL BE ACCORDING TO AUTHORITY STANDARDS.
- ANY PUMPS USED FOR BYPASS FLOW DURING SANITARY SEWER INSTALLATION SHALL HAVE A FLOW CAPACITY AS DETERMINED BY THE AUTHORITY. A WORKING DUPLICATE PUMP OF EQUAL CAPACITY SHALL BE ON-SITE AND READY FOR SUBSTITUTION IN THE EVENT OF PUMP FAILURE. BYPASS PROCEDURES SHALL BE IN ACCORDANCE WITH AUTHORITY STANDARDS.
- A BYPASS PUMPING PLAN, INCLUDING A SPECIFIC, DETAILED DESCRIPTION OF THE PROPOSED PUMPING SYSTEM, SHALL BE SUBMITTED FOR APPROVAL PRIOR TO BEGINNING THE WORK.
- CONTRACTOR SHALL TAKE PRECAUTIONS DURING DEMOLITION, ESPECIALLY AT EXISTING MANHOLE BEING REPLACED BY STRUCTURE #7, THAT DEBRIS DOES NOT ENTER INTO THE SEWER SYSTEM.

SITE AND ZONING TABULATIONS

CURRENT ZONING: THE PROJECT IS CONTAINED IN AN AREA ZONED RM-1
PROPOSED USE: SAME RESIDENTIAL USE WITH SANITARY SEWER REPLACEMENT
SITE ACREAGE: PROJECT CONSTRUCTION AREA IS APPROXIMATELY 0.9 ACRES
PROPOSED NUMBER OF LOTS: NO CHANGE IN NUMBER OF LOTS

GENERAL NOTES

- OWNER/DEVELOPER: WESTERN VIRGINIA WATER AUTHORITY
(ATTN: EARL SMITH, P.E.)
THIRD FLOOR, SUITE 300
601 SOUTH JEFFERSON STREET
ROANOKE, VA 24011 (540) 853-5792
- NO PORTION OF THIS PROJECT IS LOCATED WITHIN THE LIMITS OF A 100 YEAR FLOOD BOUNDARY AS DESIGNATED BY FEMA. THIS OPINION IS BASED ON AN INSPECTION OF THE FLOOD INSURANCE RATE MAP #51161C0162G, DATED SEPTEMBER 28, 2007.
- THE PROPERTY LINES AND RIGHT OF WAY SHOWN ARE THE RESULT OF REPRODUCING RECORDED SUBDIVISION PLATS FOR THE ADJACENT PROPERTIES AND JUSTIFYING THESE WITH PROPERTY CORNERS AS LOCATED BY FIELD SURVEY PERFORMED BY LUMSDEN ASSOCIATES, P.C. IN 2011.
- TOPOGRAPHIC DATA BASED ON ROANOKE CITY GIS MAPPING. DATA IS SUPPLEMENTED BY A FIELD SURVEY OF THE PROJECT CONSTRUCTION AREA PERFORMED BY LUMSDEN ASSOCIATES, P.C. IN 2011. THE LOCATION OF OBJECTS IN CLOSE PROXIMITY TO NEW SANITARY SEWER, AND PROFILE ELEVATIONS, ARE TAKEN DIRECTLY FROM THE FIELD SURVEY.
- A TITLE REPORT WAS NOT FURNISHED FOR THESE PROPERTIES.
- THE PROPERTIES SHOWN ON THESE PLANS ARE CURRENTLY SERVED BY WESTERN VIRGINIA WATER AUTHORITY WATER AND SANITARY SEWER.
- THE PROPERTIES SHOWN ON THESE PLANS ARE ACCESSED BY PUBLIC ROADS.
- AN APPROVED SET OF PLANS SHALL BE KEPT ON SITE AT ALL TIMES.
- NO CONSTRUCTION/FIELD REVISIONS ARE ALLOWED WITHOUT THE APPROVAL OF THE WESTERN VIRGINIA WATER AUTHORITY AND THE CONSULTING ENGINEER.
- IT SHALL BE THE RESPONSIBILITY OF THE CONTRACTOR TO CLEAN OUT THE EXISTING STORM SEWER SYSTEM WITHIN EXISTING DEVELOPMENTS SHOULD THESE SYSTEMS BECOME SILENT OR BLOCKED IN ANY WAY DUE TO THE CONSTRUCTION OF THIS PROPOSED PROJECT.

CONSTRUCTION NOTES

- ALL CONSTRUCTION SHALL CONFORM TO THE CURRENT STANDARDS AND SPECIFICATIONS OF THE WESTERN VIRGINIA WATER AUTHORITY, AND THE CITY OF ROANOKE.
- ALL WORK SHALL BE SUBJECT TO INSPECTION BY THE WESTERN VIRGINIA WATER AUTHORITY, AND THE CITY OF ROANOKE.
- THE CONTRACTOR SHALL ADHERE TO CURRENT OCCUPATIONAL SAFETY AND HEALTH ADMINISTRATION REGULATIONS, AND MAINTAIN THE CONSTRUCTION AREA IN A SAFE AND ACCEPTABLE MANNER AND SHALL BE RESPONSIBLE FOR ANY DAMAGES RESULTING FROM HIS FAILURE TO DO SO.
- THE CONTRACTOR SHALL BE RESPONSIBLE FOR OBTAINING ALL REQUIRED PERMITS FROM ANY AGENCY AS NECESSARY FOR CONSTRUCTION OF THIS PROJECT.
- THE CONTRACTOR SHALL BE RESPONSIBLE FOR NOTIFYING THE OWNER AND THE ENGINEER OF ANY CHANGES OR CONDITIONS ATTACHED TO PERMITS OBTAINED FROM ANY AUTHORITY ISSUING PERMITS.
- COPIES OF COMPLETE ASBUILT PLANS SHALL BE PROVIDED TO THE WESTERN VIRGINIA WATER AUTHORITY, AND THE CITY OF ROANOKE AS NEEDED.
- THE CONTRACTOR SHALL VISIT THE SITE AND VERIFY EXISTING CONDITIONS PRIOR TO STARTING CONSTRUCTION.
- THE CONTRACTOR SHALL VERIFY THE LOCATIONS OF ALL EXISTING UTILITIES PRIOR TO STARTING CONSTRUCTION. THE LOCATIONS OF ALL EXISTING SEWER, WATER, GAS LINES, CONDUITS, CABLES AND OTHER UTILITY LINES AND STRUCTURES ARE NOT NECESSARILY SHOWN ON THESE PLANS, AND IF SHOWN, ARE ONLY AN APPROXIMATION OF ACTUAL LOCATION. CALL MISS UTILITY AT 1-800-552-7001 AT LEAST THREE WORKING DAYS BEFORE EXCAVATING.
- THE CONTRACTOR SHALL BE LIABLE FOR ANY AND ALL DAMAGE TO EXISTING FACILITIES DUE TO HIS NEGLIGENCE OR LACK OF DILIGENCE IN AVOIDING IMPACTS TO EXISTING FACILITIES.
- THE CONTRACTOR SHALL MAINTAIN UTILITY SERVICES TO EXISTING RESIDENCES AND BUSINESSES DURING CONSTRUCTION.
- THE CONTRACTOR SHALL PROVIDE A STORAGE CONTAINER FOR TEMPORARY STORAGE AND DISPOSAL OF LAND CLEARANCE DEBRIS AND BUILDING MATERIALS. ON-SITE BURIAL OF MATERIAL SHALL NOT BE PERMITTED. DEBRIS (E.G., TREES, STUMPS, ETC.) TO BE DISPOSED OF IN AN APPROVED LANDFILL.

GRADING NOTES

- AREAS TO BE DISTURBED SHALL BE CLEARED OF ALL VEGETATION, STRUCTURES, AND OTHER PHYSICAL FEATURES IN PREPARATION OF CONSTRUCTION.
- TOPSOIL SHALL BE REMOVED FROM THE CLEARED AREA AND STOCKPILED FOR FUTURE USE.
- FILL MATERIAL SHALL BE FREE FROM ORGANIC MATTER AND ROCKS LARGER THEN 6 INCHES IN DIAMETER. THE EXISTING SURFACE SHALL BE SCARIFIED PRIOR TO PLACING FILL.
- FILL MATERIAL SHALL BE PLACED AND COMPACTED IN EIGHT (8) INCH LOOSE LIFTS AND COMPACTED TO AT LEAST NINETY-FIVE (95) PERCENT OF THE MATERIAL'S MAXIMUM DRY DENSITY AS DETERMINED BY ASTM D698, STANDARD PROCTOR. MAINTAIN MOISTURE CONTENT OF FILL MATERIAL WITHIN THREE (3) PERCENT OF OPTIMUM TO ATTAIN REQUIRED COMPACTION DENSITY.
- WHERE NEW FILL IS PLACED ON AN EXISTING GROUND SURFACE THAT SLOPES MORE THAN 4:1, HORIZONTAL BENCHES SHALL BE CUT INTO THE EXISTING SURFACE PRIOR TO FILL PLACEMENT TO PROMOTE BINDING OF NEW FILL TO EXISTING GROUND.
- NO SUBSURFACE SOILS INFORMATION HAS BEEN FURNISHED TO THE DESIGNING ENGINEER (LUMSDEN ASSOCIATES, PC). A QUALIFIED GEOTECHNICAL ENGINEER, LICENSED IN THE STATE OF VIRGINIA, SHALL BE CONSULTED CONCERNING SOIL STABILITY, SLOPE STABILIZATION, SOIL COMPACTION, TESTING, AND OTHER SOIL CHARACTERISTICS. LUMSDEN ASSOCIATES ASSUMES NO RESPONSIBILITY OR LIABILITY RELATING TO FAILURES RESULTING FROM SAME.
- FINISHED GRADES SHALL CONFORM AS NEAR AS POSSIBLE TO THE PRECONSTRUCTION SLOPES, SHAPES, AND ELEVATIONS, UNLESS OTHERWISE DIRECTED BY THE WESTERN VIRGINIA WATER AUTHORITY REPRESENTATIVE AND/OR THE CITY OF ROANOKE.
- THE CONTRACTOR SHALL MAINTAIN A CLEAR FLOW PATH FOR SURFACE WATER TO STORM WATER DRAINAGE FACILITIES AT ALL TIMES.
- OVERNIGHT STOCKPILES SHALL NOT BE LOCATED IN ROADWAYS, SIDEWALKS, RESIDENTIAL YARDS OR DRIVEWAYS AND SHALL BE REMOVED AT THE END OF THE WORK DAY.

LUMSDEN ASSOCIATES, P.C.
ENGINEERS-SURVEYORS-PLANNERS
ROANOKE, VIRGINIA

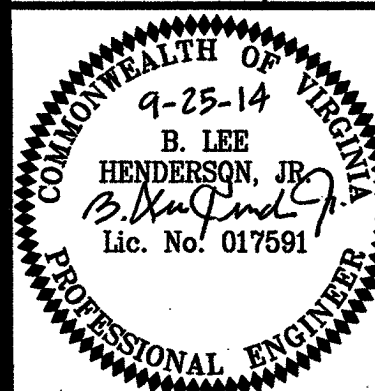

NOTES AND DETAILS

**DUNBAR STREET & CARVER AVENUE
SANITARY SEWER REPLACEMENTS**
PREPARED FOR
WESTERN VIRGINIA WATER AUTHORITY
CITY OF ROANOKE, VIRGINIA

REVISIONS		DESCRIPTION	DATE	BY	CHKD
1					
2					
3					
4					
5					

DATE: SEPTEMBER 25, 2014

SCALE: AS SHOWN

COMMISSION NO. 11-039

SHEET 2 OF 8