

3.02	TEMPORARY STONE CONSTRUCTION ENTRANCE	CE
3.05	SILT FENCE	SF
3.31	TEMPORARY SEEDING	TS
3.32	PERMANENT SEEDING	PS
3.35	MULCHING	MU
3.07	STORM DRAIN INLET PROTECTION	IP
3.09	TEMPORARY DIVERSION DIKE	DD

NOTE: SEE SOILS INFORMATION BASED ON THE "SOIL SURVEY OF ROANOKE COUNTY AND THE CITIES OF ROANOKE AND SALEM, VIRGINIA" AS PREPARED BY THE UNITED STATES DEPARTMENT OF AGRICULTURE, (SEE SHEET C07 FOR DETAILS)

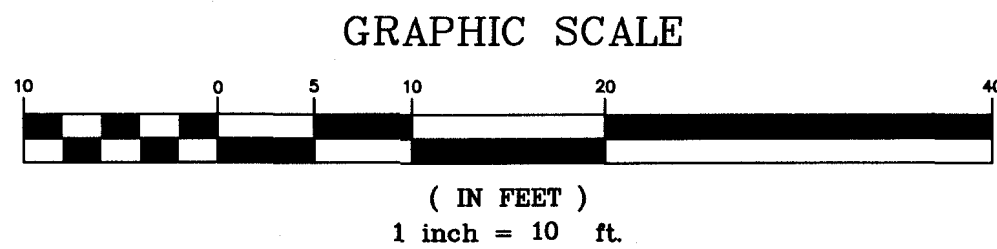
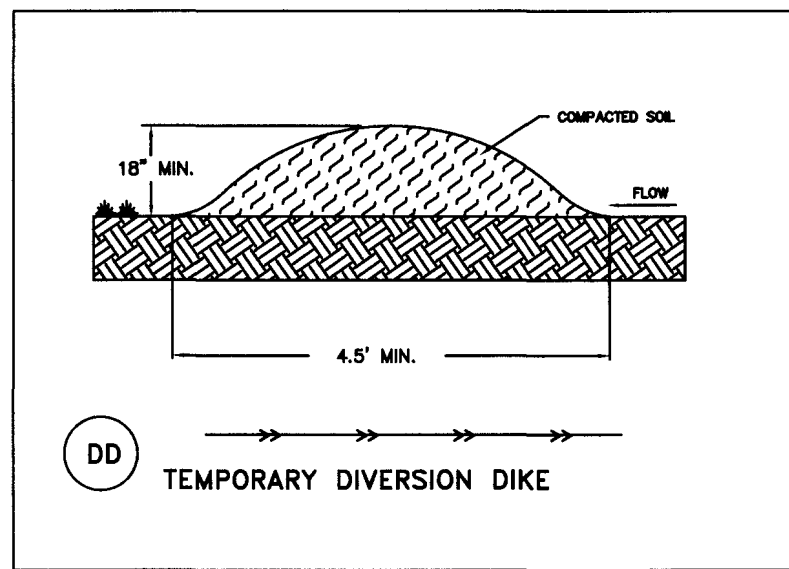

CONSTRUCTION SEQUENCING NOTES:

1. THE PHASE 1 CONSTRUCTION ENTRANCE SHALL BE INSTALLED AS A FIRST STEP. SPECIAL ATTENTION SHALL BE PROVIDED TO ENSURE NO 'MUD TRACKING' OR SEDIMENT IS TRANSPORTED ONTO THE RIGHT OF WAY OF WILLIAMSON ROAD.
2. SILT FENCE TO BE INSTALLED AS SHOWN ON THE E.S.C. PLAN.
3. MAJOR GRADING OPERATIONS SHALL TAKE PLACE AT THIS TIME.
4. TEMPORARY SEEDING SHALL BE APPLIED TO ANY AREA TO REMAIN DORMANT FOR LONGER THAN 14 DAYS.
5. ONCE THE BUILDING CONSTRUCTION HAS BEGUN AND THE SLAB IS IN PLACE, THE 50 LF OF SILT FENCE SHALL BE REMOVED DIRECTLY ADJACENT TO THE PROPOSED BUILDING.
6. ALL UTILITIES AND CONDUIT SHALL BE INSTALLED AT THIS TIME. INLET PROTECTION SHALL BE PROVIDED FOR THE PROPOSED INLET TO ENSURE NO SEDIMENT IS TRANSPORTED INTO THE PROPOSED OR EXISTING PIPE SYSTEM ALONG WILLIAMSON ROAD.
7. THE DIVERSION DIKE SHALL BE INSTALLED AT THIS TIME ONCE THE UNDERGROUND STORM SEWER SYSTEM IS OPERABLE.
8. NO DEVIATIONS TO THE PLANS SHALL TAKE PLACE UNLESS PRIOR APPROVAL FROM THE OWNER, PROJECT ENGINEER, AND THE APPROPRIATE REVIEW AGENCIES.
9. CURBING, PAVEMENT, ETC. SHALL BE INSTALLED AT THIS TIME. DIVERSION DIKE CAN BE REMOVED FROM THE SITE UPON INSTALLATION OF CONCRETE CURBING.
10. TOPSOIL AND SEEDING SHALL BE APPLIED TO LANDSCAPE AREAS.
11. AFTER FINAL SITE STABILIZATION AND ROANOKE COUNTY APPROVAL, INLET PROTECTION, SILT FENCE, AND THE CONSTRUCTION ENTRANCE CAN BE REMOVED.

*NOTE: ROANOKE COUNTY INSPECTION AND APPROVAL IS REQUIRED PRIOR TO THE REMOVAL OF EROSION AND SEDIMENT CONTROL MEASURES.

EROSION & SEDIMENT CONTROL COST ESTIMATE				
*NOTE: ALL COSTS GIVEN ARE COMPLETE IN PLACE. *NOTE: THIS COST ESTIMATE TABLE IS PROVIDED FOR BIDDING PURPOSES ONLY. VERIFICATION OF ALL QUANTITIES AND PRICES FOR BIDDING PURPOSES SHALL BE THE RESPONSIBILITY OF THE BIDDER.*				
DESCRIPTION	UNIT	QUANTITY	UNIT COST	TOTAL COST
CONSTRUCTION ENTRANCE	EA	1	\$ 1,000	\$ 1,000
SILT FENCE	LF	350	3.00	1,050
INLET PROTECTION	EA	1	100.00	100
PERMANENT SEEDING	1000 SF	5	20.00	100
TEMP. SEEDING	1000 SF	5	15.00	75
TEMP. DIVERSION DIKE	LF	45	3.00	135
SUB-TOTAL				\$ 2,460.00
10% CONTINGENCY				\$ 246.00
TOTAL PROJECT COST				\$ 2,706.00

GENERAL EROSION AND SEDIMENT CONTROL NOTES

1. ALL SOIL EROSION & SEDIMENT CONTROL MEASURES SHALL BE ACCOMPLISHED IN STRICT ACCORDANCE WITH THE STANDARDS AND SPECIFICATIONS CONTAINED IN THE VIRGINIA EROSION AND SEDIMENT CONTROL HANDBOOK, LATEST EDITION.
2. THE APPROVING AUTHORITY MAY ADD TO, DELETE, RELOCATE, CHANGE, OR OTHERWISE MODIFY CERTAIN EROSION AND SEDIMENT CONTROL MEASURES WHERE FIELD CONDITIONS ARE ENCOUNTERED THAT WARRANT SUCH MODIFICATIONS.
3. ALL SOIL EROSION AND SEDIMENT CONTROL MEASURES AS SHOWN ON THE PLAN SHALL BE PLACED IN ADVANCE OF THE WORK BEING PERFORMED, AS FAR AS PRACTICAL.
4. IN NO CASE DURING CONSTRUCTION SHALL WATER RUNOFF BE DIVERTED OR ALLOWED TO FLOW TO LOCATIONS WHERE ADEQUATE PROTECTION HAS NOT BEEN PROVIDED.
5. IT SHALL BE THE CONTRACTOR'S RESPONSIBILITY TO LEAVE THE SITE ADEQUATELY PROTECTED AGAINST EROSION, SEDIMENTATION, OR ANY DAMAGE TO ANY ADJACENT PROPERTY AT THE END OF EACH DAY'S WORK.
6. FOR THE EROSION CONTROL KEY SYMBOLS SHOWN ON THE PLANS, REFER TO THE VIRGINIA UNIFORM CODING SYSTEM FOR EROSION AND SEDIMENT CONTROL PRACTICES CONTAINED IN THE VIRGINIA EROSION AND SEDIMENT CONTROL HANDBOOK, LATEST EDITION. THESE SYMBOLS AND KEYS ARE TO BE UTILIZED ON ALL EROSION CONTROL PLANS SUBMITTED TO ROANOKE COUNTY.
7. THE LOCATION OF ALL OFF-SITE FILL OR BORROW AREAS ASSOCIATED WITH THE CONSTRUCTION PROJECT WILL BE PROVIDED TO ROANOKE COUNTY DEPARTMENT OF COMMUNITY DEVELOPMENT. AN EROSION CONTROL PLAN OR MEASURES MAY BE REQUIRED FOR THIS AREA.
8. THIS SHEET MAY NOT BE MODIFIED EXCEPT FOR TABLES

TOTAL DISTURBED AREA = 0.31 AC. = 13,447 SQ. FT.

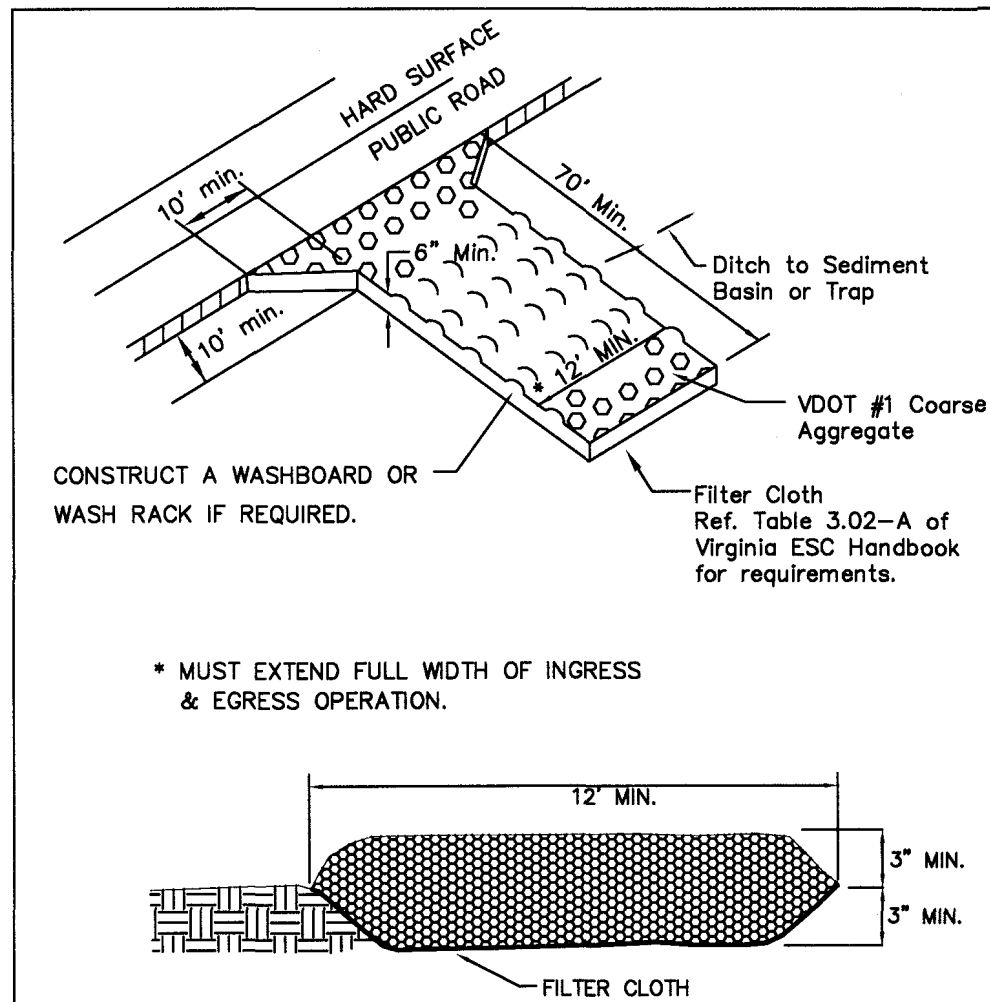

CE TEMPORARY GRAVEL CONSTRUCTION ENTRANCE

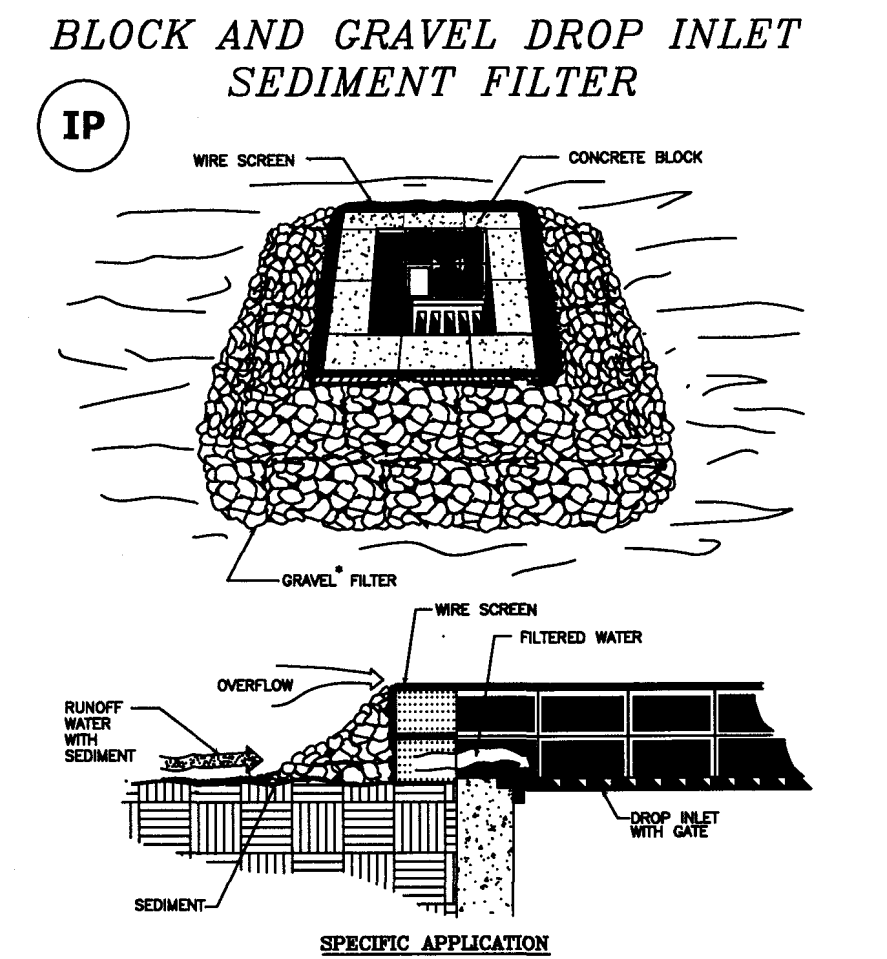

THIS METHOD OF INLET PROTECTION IS APPLICABLE WHERE HEAVY FLOWS ARE EXPECTED AND WHERE AN OVERFLOW CAPACITY IS NECESSARY TO PREVENT EXCESSIVE PONDING AROUND THE STRUCTURE.

* GRAVEL SHALL BE VDOT #3, #567 OR #6 COARSE AGGREGATE.

SOURCE: VA. DSWC

PLATE: 3.07-3

DEFINITION - THE ESTABLISHMENT OF A TEMPORARY VEGETATIVE COVER ON DISTURBED AREAS BY SEEDING WITH APPROPRIATE RAPIDLY GROWING ANNUAL PLANTS.

LIMING REQUIREMENTS FOR TEMPORARY SITES

RECOMMENDED APPLICATION
PH TEST OF AGRICULTURAL LIMESTONE
BELOW 4.2 3 TONS PER ACRE
4.2 TO 5.2 2 TONS PER ACRE
5.2 TO 6 1 TON PER ACRE

ACCEPTABLE TEMPORARY SEEDING PLANT MATERIAL
"QUICK REFERENCE FOR ALL REGIONS"

PLANTING DATES	SPECIES	RATE (LBS/ACRE)
SEPT. 1 - FEB. 15	50/50 MIX OF ANNUAL RYEGRASS & WINTER RYE	50 - 100
FEB. 16 - APR. 30	ANNUAL RYEGRASS	60 - 100
MAY 1 - AUG. 31	GERMAN MILLET	50

TS TEMPORARY SEEDING

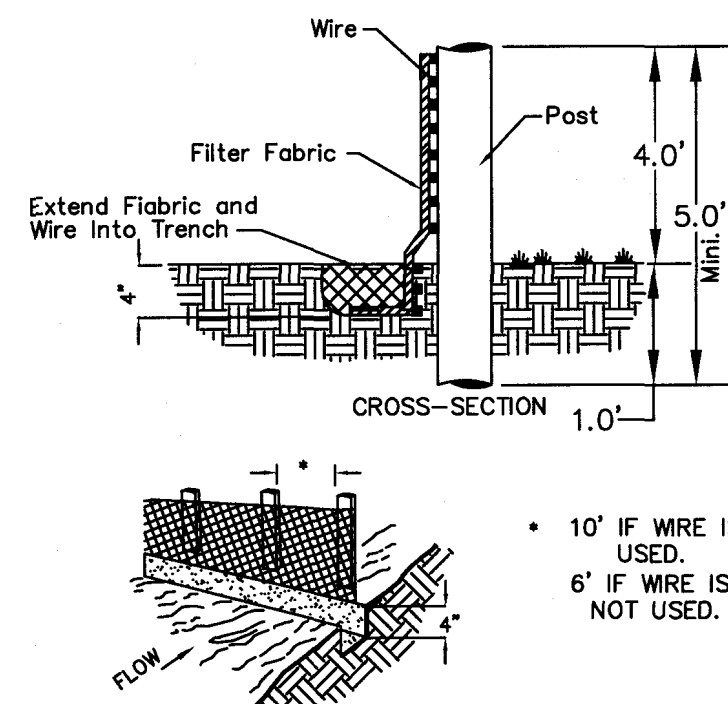

SF CONSTRUCTION OF A SILT FENCE

TYPE A
15 OCTOBER TO 1 FEBRUARY
K-31 RESIDUE @ 5 LB / 1000 SF
BASIC WINTER RYE @ 1/2 LB / 1000 SF
RED TOP @ 1/2 LB / 1000 SF
1 FEBRUARY TO 1 JUNE
K-31 RESIDUE @ 5 LB / 1000 SF
ANNUAL RYE @ 1/2 LB / 1000 SF
1 JUNE TO 1 SEPTEMBER
K-31 RESIDUE @ 5 LB / 1000 SF
GERMAN MILLET @ 1/2 LB / 1000 SF
1 SEPTEMBER TO 15 OCTOBER
K-31 RESIDUE @ 5 LB / 1000 SF
ANNUAL RYE @ 1/2 LB / 1000 SF

TYPE B (GRADES 31 OR STEEPER)
15 MARCH TO 1 MAY
CROWN VETCH @ 1/2 LB / 1000 SF
PERENNIAL RYEGRASS @ 1/2 LB / 1000 SF
RED TOP @ 1/2 LB / 1000 SF
15 MAY TO 1 OCTOBER
CROWN VETCH @ 1/2 LB / 1000 SF
PERENNIAL RYEGRASS @ 1/2 LB / 1000 SF
RED TOP @ 1/2 LB / 1000 SF

LIME: 140 LB / 1000 SF PLASTERED AGRICULTURAL LIMESTONE
36-0-0 @ 7 LB / 1000 SF
FERTILIZER: IF REQUIRED, SHALL BE USED OVER ALL SEEDING AREAS AND SHALL BE APPLIED IN ACCORDANCE WITH SECTION 1.7.5 OF THE VIRGINIA EROSION AND SEDIMENT CONTROL HANDBOOK, LATEST EDITION.

SOIL CONDITIONS: INCORPORATION OF LIME AND FERTILIZER, SELECTION OF CERTIFIED SEED, SELECTION OF NEW SEEDLINGS, AND SEEDING SHALL BE IN ACCORDANCE WITH SPECIFICATIONS CONTAINED WITHIN THE VIRGINIA EROSION AND SEDIMENT CONTROL HANDBOOK, LATEST EDITION. ADDITIONAL SEEDING TO BE PERFORMED AS REQUIRED BY THE INSPECTOR.

SEED APPLICATION: APPLY SEED UNIFORMLY WITH A CYCLONE SEEDER. DRILL CULTIVATOR SEEDING OR HYDROSEEDER ON A PINK PINKLE SEEDER. MAXIMUM SEEDING DEPTH SHALL BE 1/4 INCH.

PS PERMANENT SEEDING

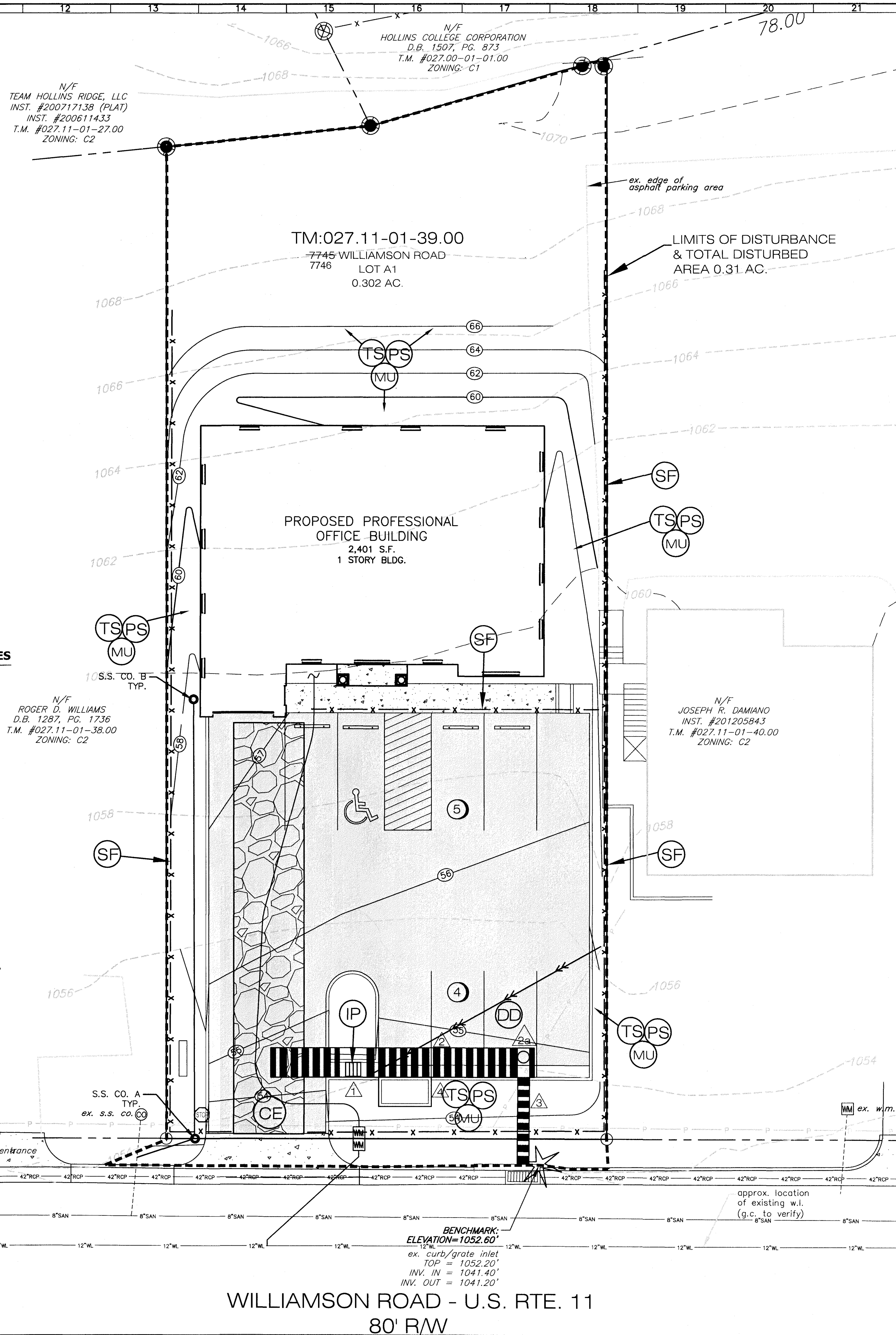

BALZER AND ASSOCIATES INC.
REFLECTING TOMORROW
www.balzer.cc

New River Valley
Richmond
Roanoke
Shenandoah Valley

RESIDENTIAL LAND DEVELOPMENT ENGINEERING
SITE DEVELOPMENT ENGINEERING
LAND USE PLANNING & ZONING
LANDSCAPE ARCHITECTURE
LAND SURVEYING
ARCHITECTURE
STRUCTURAL ENGINEERING
TRANSPORTATION ENGINEERING
ENVIRONMENTAL & SOIL SCIENCE
WETLAND DELINEATIONS & STREAM EVALUATIONS

Balzer and Associates, Inc.
1208 Corporate Circle
Roanoke, VA 24018
540-772-9580
FAX 540-772-8050

COMMONWEALTH OF VIRGINIA
Christopher P. Burns
Lic. No. 047338
5/1/2013
PROFESSIONAL ENGINEER

EDWARD JONES OFFICE #34972
E.S.C. PLAN
HOLLINS DISTRICT
ROANOKE COUNTY, VIRGINIA

DRAWN BY BTC
DESIGNED BY BTC
CHECKED BY CPB
DATE 4/5/2013
SCALE 1"=10'
REVISIONS:
5/1/2013

SHEET NO. **C06**
JOB NO. R1200160.00