

- ALL RAKE, FACIA, & CORNICE WORK TO BE ALUMINUM COVERED, WOOD SHALL BE PRIME COATED PRIOR TO ALUM. COVERING
- FIN. CEILING: 5/8" MOISTURE RESISTANT GYPSUM BOARD TAPED, FINISHED, & PAINTED
 - PRESSURE TREATED (2) 2x8 BOLTED W/ 5/8" @ "J" ANCHOR BOLTS @ 48" O.C. (EMBEDDED IN BOND BEAM GROUT.)
 - FILL BLOCK VOIDS WITH INSULATION
 - MTL - WIRE REINFORCEMENT CONTIN. (COURSES 16" O.C.)
 - GROUT REBAR FILLED COURSE (ONLY)
 - 6X6 - W1.4 x W1.4
 - 4" STONE FILL
 - COMPACTED, LEVELED SUB-GRADE
 - NOT USED
 - (1) 4'x7' INSULATED STEEL DOOR W/METAL FRAME, THRESHOLD & HARDWARE (DEADBOLTS REQ'D.) SIMILAR TO JEN-WELD GLADIATOR STEEL ENTRANCE DOOR 6 PANEL DOOR W/ GLASS INSERT
 - (1) 10'x10' INSULATED METAL O.H. DOOR W/METAL FRAME, THRESHOLD & HARDWARE. (TOP & BOTTOM BOLTS & DEADBOLTS REQ'D.) SIMILAR TO OVERHEAD DOOR CO. BANNER 313/319 SERIES W/ MOTORIZED DOOR OPERATOR
 - AWNING TYPE VINYL WINDOW W/ 3/4" INSULATED GLASS SIMILAR TO JEN-WELD 48" X 30" AWNING WINDOW

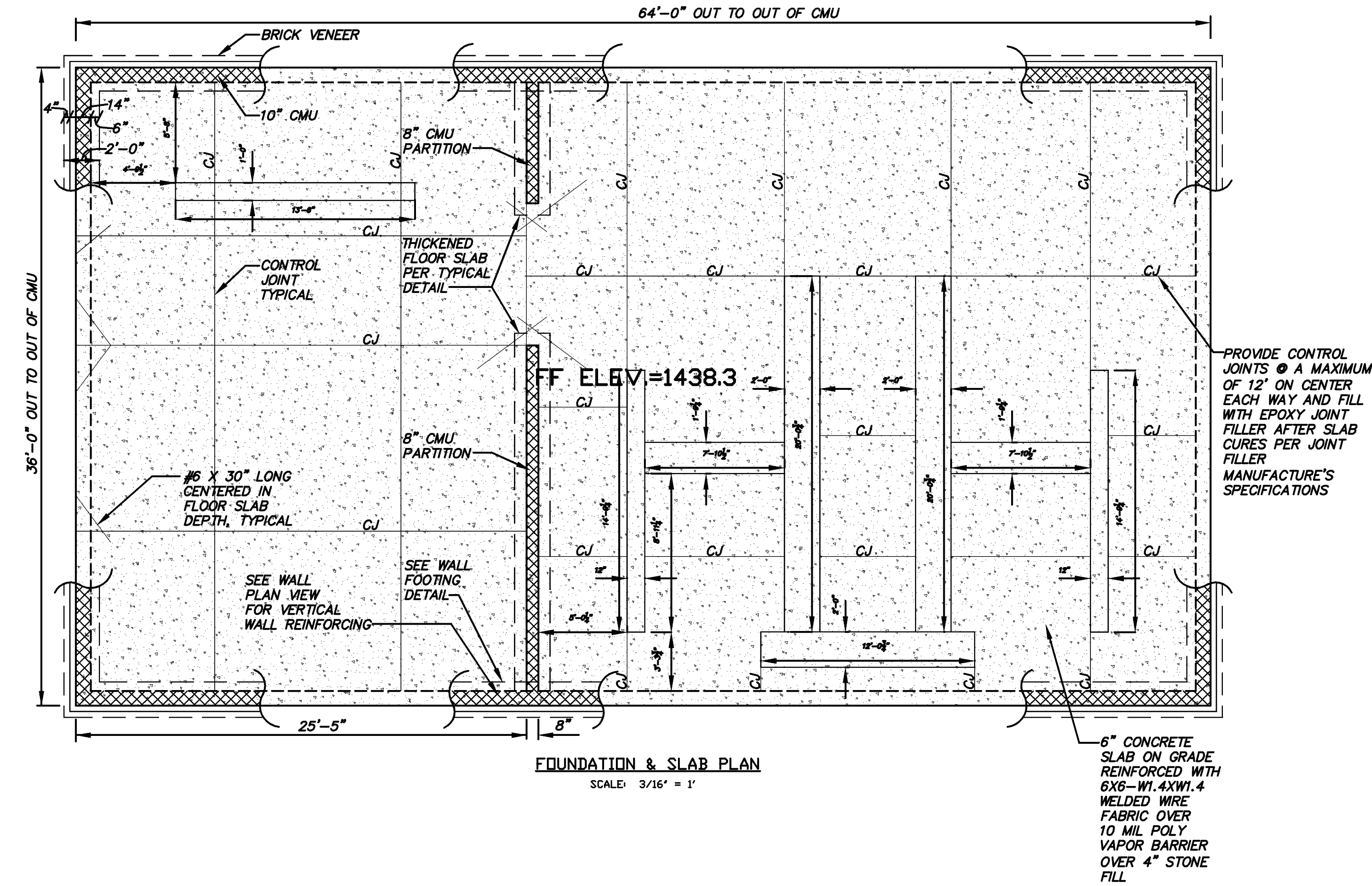
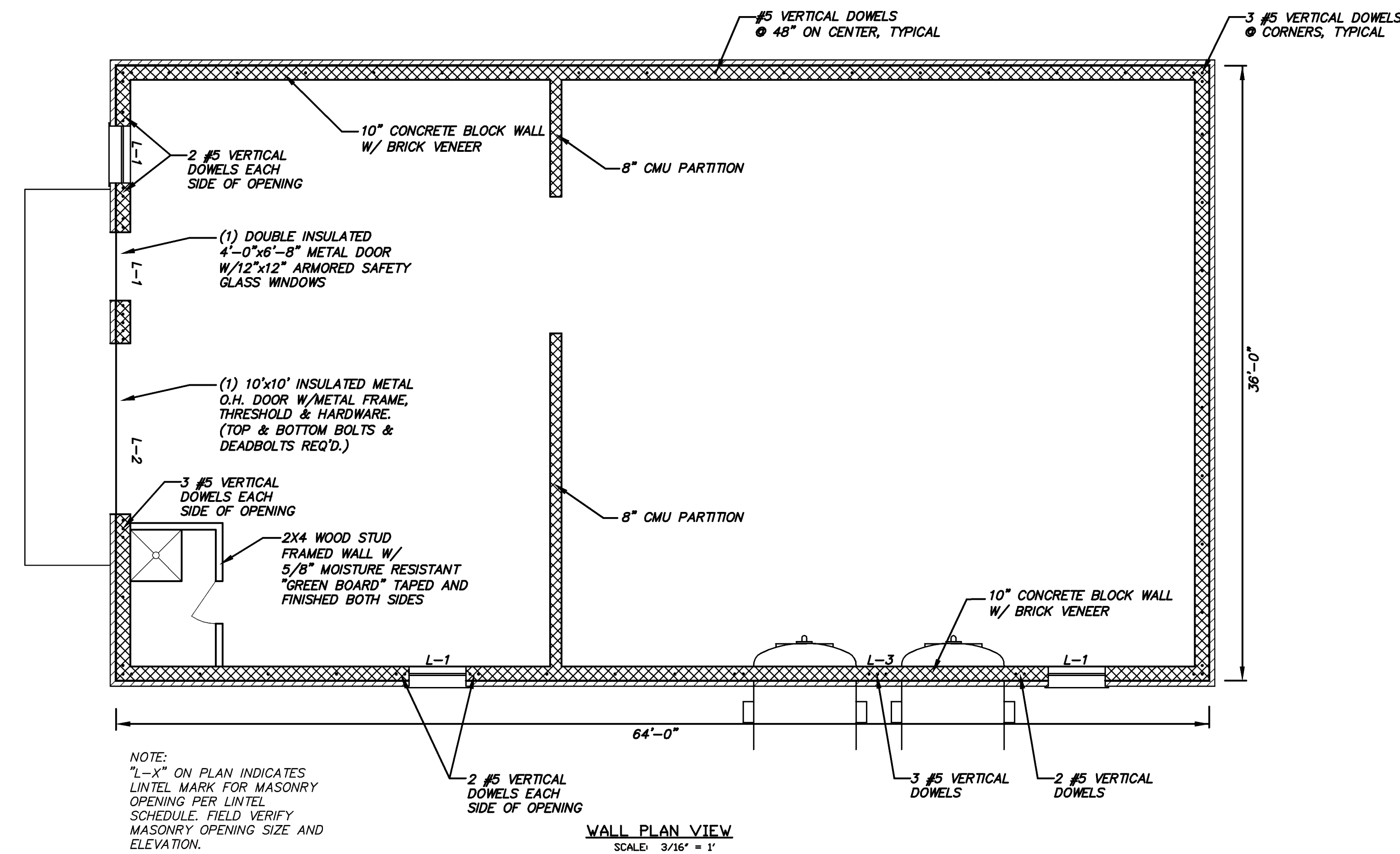

*ENGINEERING >> SURVEYING > PLANNING

HURT & PROFFITT

INCORPORATED

2524 LANGHORNE ROAD
LYNCHBURG VA 24501
800.242.4906 TOLL FREE
434.847.7796 MAIN
434.847.0047 FAX

WATER TREATMENT DETAILS-ASBUILT

FOR

TOWN OF BOONES MILL WATER SYSTEM REPLACEMENT, VOLUME 2

TOWN OF BOONES MILL, BOONE DISTRICT, FRANKLIN COUNTY, VA

PROJECT NO. 20080815

G.L. NO. 297-03-A3.9

FILE NO. G-12675

DATE: 7/31/09

DRAWN BY: ASK

CHECKED BY: BLC

HURT & PROFFITT

SHEET NO. C1.5

1	8/28/09	VDH/OWNER COMMENTS
2	9/3/09	VDH/OWNER COMMENTS
4	11/17/09	FRANKLIN COUNTY COMMENTS
5	3/14/12	ASBUILTS

Mar 14, 2012 - 4:09pm V:\LandProjects\20080815\dwg\Asbults-WTP\ASBUILT-SITE-TANK.dwg