

WATER SYSTEM PLANS
FOR
SECTION No. 3
"BoxwoodGreen"

SITUATED IN
GILLS CREEK MAGISTERIAL DISTRICT
FRANKLIN COUNTY, VIRGINIA

DATE: 29 DECEMBER 1994

PROPERTY OF
ALOUF CONSTRUCTION AND DEVELOPMENT CO.

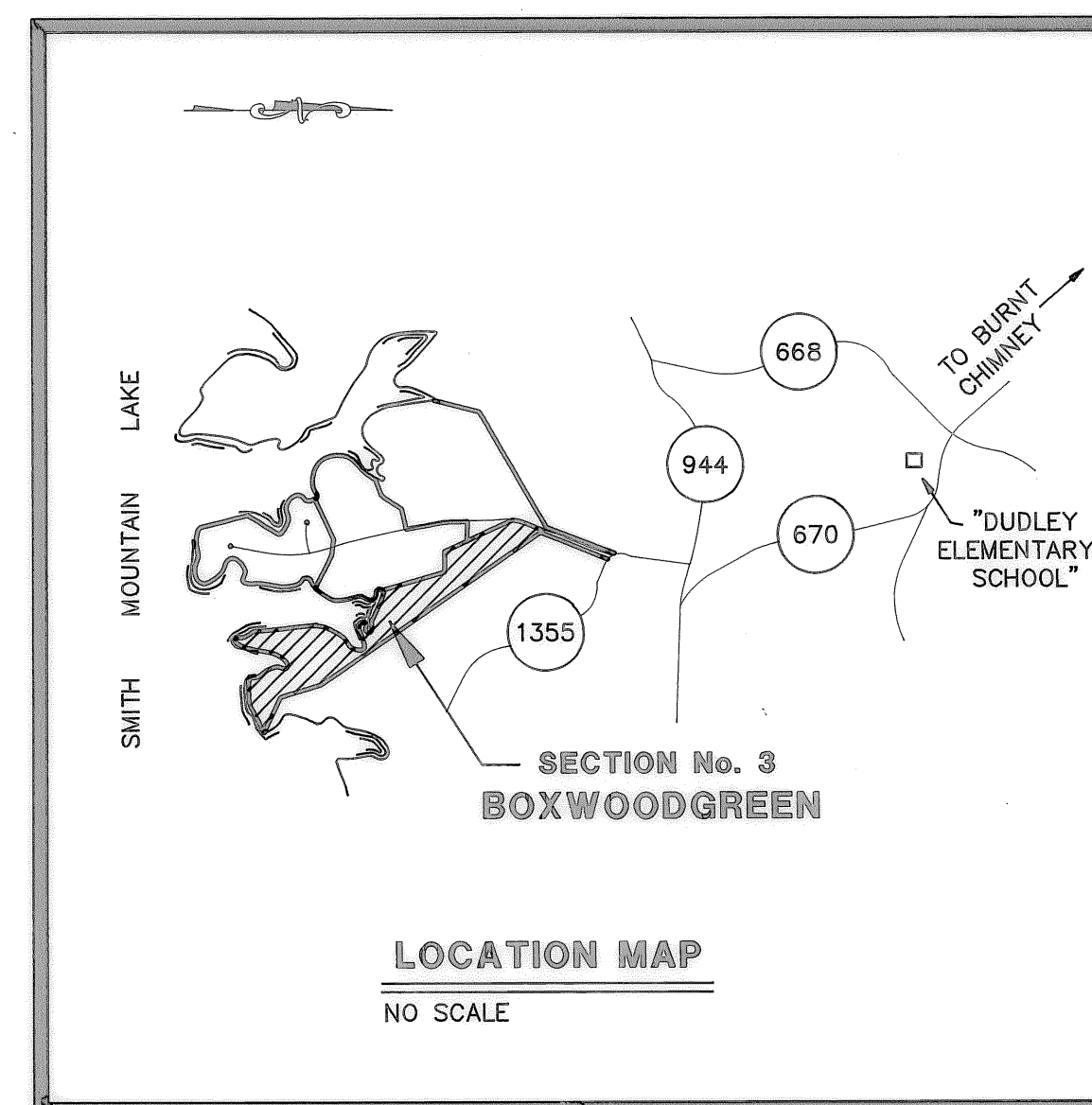

INDEX OF DRAWINGS

SHEET No. DESCRIPTION

1. LUMSDEN ASSOCIATES COVER SHEET
2. WATER SPECIFICATIONS
3. PLAN
4. PROFILE
5. WATER DETAILS

LUMSDEN ASSOCIATES, P.C.
ENGINEERS—SURVEYORS—PLANNERS
ROANOKE, VIRGINIA