

- PROJECT NOTES:**
- CONTRACTOR SHALL BE RESPONSIBLE FOR MAINTENANCE AND UPKEEP OF ALL EROSION AND SEDIMENT CONTROL MEASURES. SILT FENCE BARRIERS WILL BE USED AS TEMPORARY E&S CONTROL UNTIL PERMANENT MEASURES ARE IN PLACE. CULVERT INLET PROTECTION SHALL BE INSTALLED TO PROTECT EXISTING INLETS FROM SEDIMENT RUNOFF. ALL DISTURBED AREAS SHALL BE SEEDED, MULCHED, AND RETURNED TO CONDITIONS BETTER THAN OR EQUAL TO CONDITIONS PRIOR TO CONSTRUCTION.
 - ALL WATER SERVICES CROSSING THE ROAD SHALL BE BORED UNDER THE PAVEMENT.
 - CONTRACTOR SHALL COORDINATE CLEARING OF SITE WITH OWNER. NO TREES SHALL BE REMOVED WITHOUT PERMISSION OF OWNER.
 - UPON SITE INSPECTION, ADDITIONAL EROSION AND SEDIMENT CONTROL MEASURES MAYBE REQUIRED BY FRANKLIN COUNTY PERSONNEL IF INSTALLED MEASURES ARE DEEMED INADEQUATE.

MARKER	OWNER	ADDRESS	METER SIZE	COMMENT
△	HODGES RANDALL V & SUE M		5/8"	
△	JONES CALVIN CURTIS (LE) & SCOTT REGINA J	10730 BOOKER T WASHINGTON HWY	5/8"	

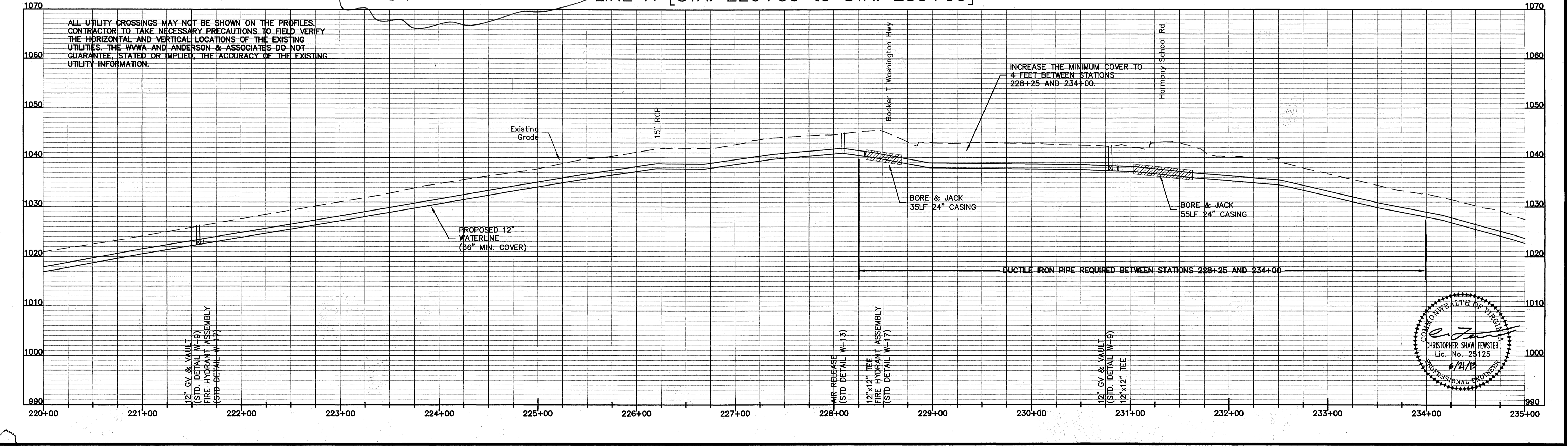

ANDERSON & ASSOCIATES, INC.
 Professional Design Services
 www.andassoc.com
 100 Ardmore St.
 Blacksburg, Va. 24060
 540-552-5592

DATE : 07 JUN 13
 DESIGNED: CSF
 DRAWN : SEC
 CHECKED: MGG
 QA / QC : CSF

REV. # : 1
 COMMENTS : ADDENDUM #1
 DATE : 21 JUN 13

FRANKLIN COUNTY / WESTERN VIRGINIA WATER AUTHORITY
 BURNT CHIMNEY WATER EXTENSION
 FRANKLIN COUNTY, VIRGINIA

Line A - Sta 220+00 to 235+00
PLAN AND PROFILE

DOCUMENT NO.
30337-002
 SHEET
22 OF **44**

