

- PROJECT NOTES:
1. CONTRACTOR SHALL BE RESPONSIBLE FOR MAINTENANCE AND UPKEEP OF ALL EROSION AND SEDIMENT CONTROL MEASURES. SILT FENCE BARRIERS WILL BE USED AS TEMPORARY E&S CONTROL UNTIL PERMANT MEASURES ARE IN PLACE. CULVERT INLET PROTECTION SHALL BE INSTALLED TO PROTECT EXISTING INLETS FROM SEDIMENT RUNOFF. ALL DISTURBED AREAS SHALL BE SEEDED, MULCHED, AND RETURNED TO CONDITIONS BETTER THAN OR EQUAL TO CONDITIONS PRIOR TO CONSTRUCTION.
 2. ALL WATER SERVICES CROSSING THE ROAD SHALL BE BORED UNDER THE PAVEMENT.
 3. CONTRACTOR SHALL COORDINATE CLEARING OF SITE WITH OWNER. NO TREES SHALL BE REMOVED WITHOUT PERMISSION OF OWNER.
 4. UPON SITE INSPECTION, ADDITIONAL EROSION AND SEDIMENT CONTROL MEASURES MAYBE REQUIRED BY FRANKLIN COUNTY PERSONEL IF INSTALLED MEASURES ARE DEEMED INADEQUATE.

MARKER	OWNER	ADDRESS	METER SIZE	COMMENT
△	ROSE CHARLES E & PEGGY ANN		5/8"	

LINE C [STA. 9+75 to STA. 17+00]

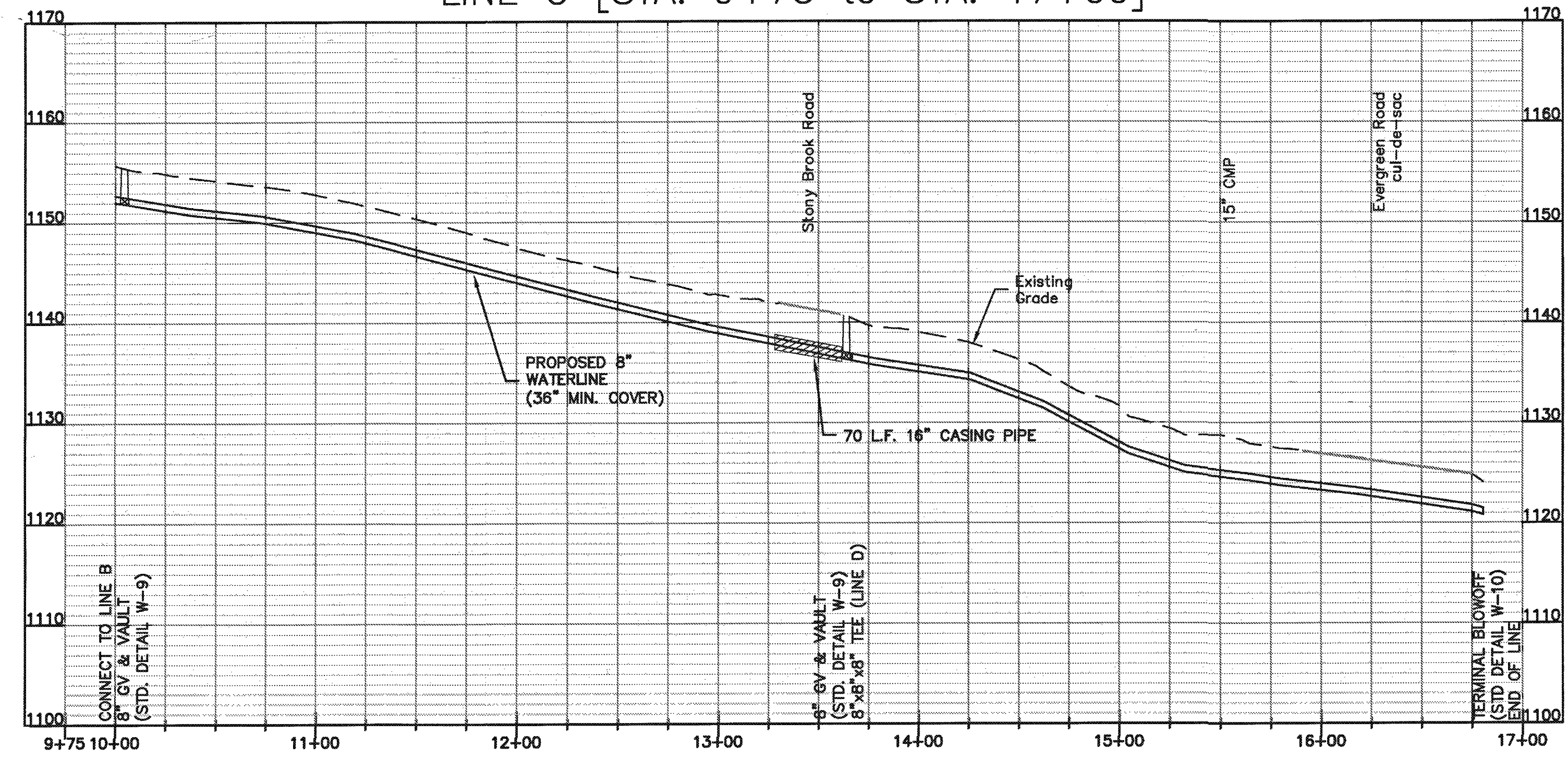

As-Built 12.10.13 Wells Construction