

FRANKLIN COUNTY HEALTH DEPARTMENT DATE

VIRGINIA DEPARTMENT OF TRANSPORTATION DATE

FRANKLIN COUNTY SUBDIVISION AGENT DATE

LAKE WATCH, L.L.C.  
6720 THIRLANE ROAD, NW  
ROANOKE, VA 24019  
PHONE: 540-537-5603

64 R-1 LOTS  
D.B. 839 PG. 809

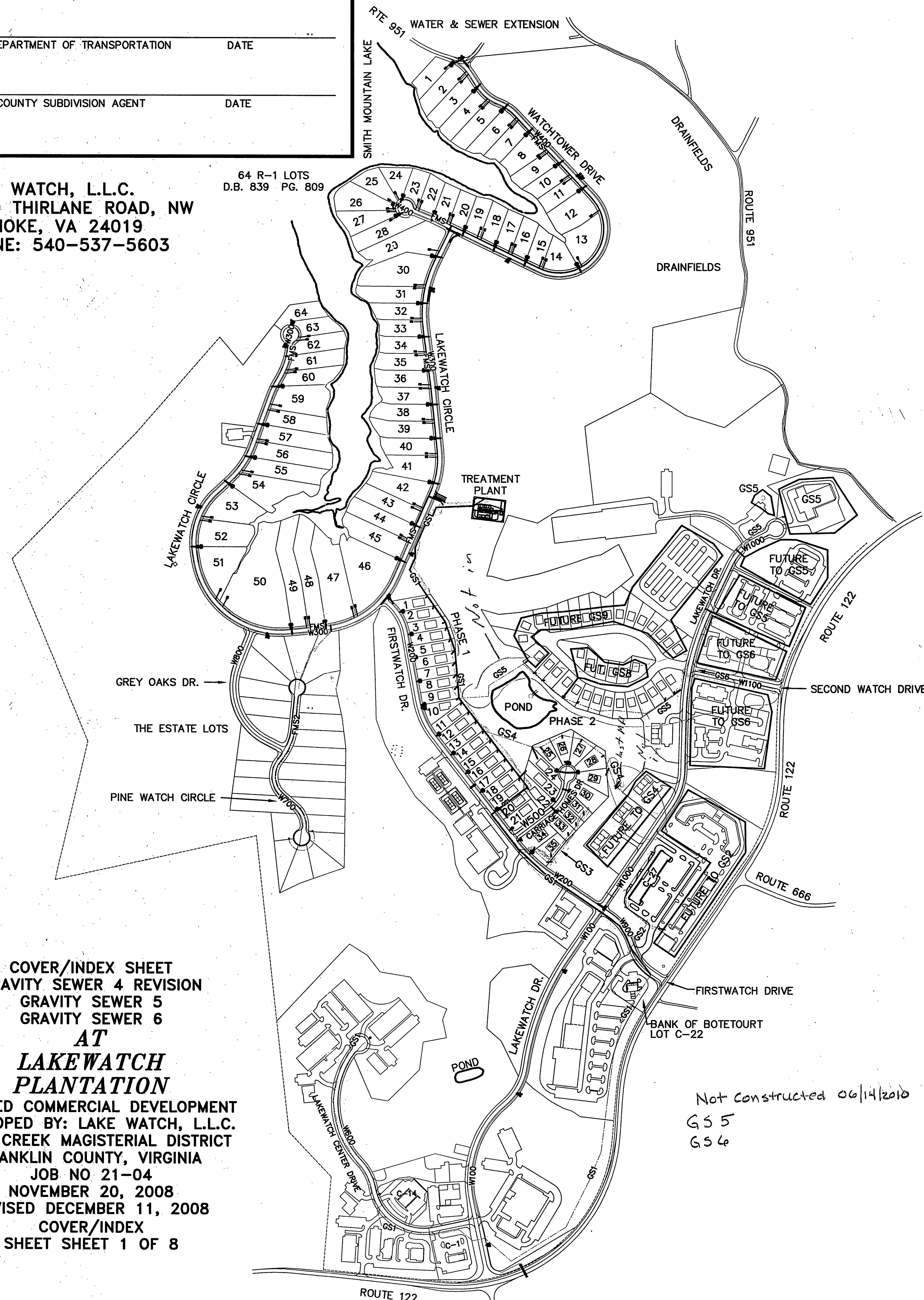

COVER/INDEX SHEET  
GRAVITY SEWER 4 REVISION  
GRAVITY SEWER 5  
GRAVITY SEWER 6  
AT  
**LAKEWATCH  
PLANTATION**  
PLANNED COMMERCIAL DEVELOPMENT  
DEVELOPED BY: LAKE WATCH, L.L.C.  
GILLS CREEK MAGISTERIAL DISTRICT  
FRANKLIN COUNTY, VIRGINIA  
JOB NO 21-04  
NOVEMBER 20, 2008  
REVISED DECEMBER 11, 2008  
COVER/INDEX  
SHEET SHEET 1 OF 8

NOT TO SCALE

PHILIP W. NESTER, P.O. BOX 827, ROCKY MOUNT, VIRGINIA 24151, PHONE: 540-483-3582 21-04

SHEET 1: COVER/INDEX  
SHEET 2: GENERAL NOTES  
SHEET 3: GRAVITY SEWER 4  
SHEET 4: GRAVITY SEWER 5 *Not Constructed*  
SHEET 5: GRAVITY SEWER 5 *Not Constructed*  
SHEET 6: GRAVITY SEWER 6 *Not Constructed*  
SHEET 7: SPECIFICATIONS  
SHEET 8: INSTALLATION DETAILS

REVISED 12-11-08  
REVISED 12-11-08  
REVISED 12-11-08  
REVISED 12-11-08  
REVISED 12-11-08  
REVISED 12-11-08

VICINITY MAP

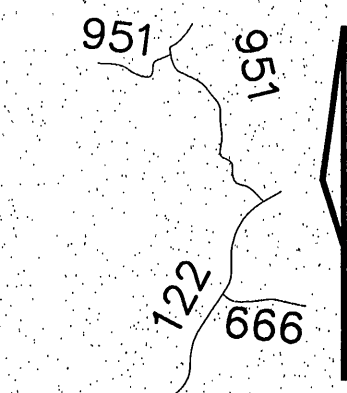

ROADS LAKEWATCH DRIVE FIRSTWATCH DRIVE LAKEWATCH CIRCLE WATCHTOWER DRIVE CARRIAGE HOMES DRIVE LAKEWATCH CENTER DRIVE FIRSTWATCH DRIVE (EXTENSION) GREY OAKS DRIVE PINE WATCH CIRCLE LAKEWATCH DRIVE (EXT.) SECOND WATCH DRIVE	PLAN DATE NOVEMBER 27, 2004 NOVEMBER 27, 2004 NOVEMBER 27, 2004 NOVEMBER 27, 2004 JULY 19, 2006 SEPTEMBER 12, 2006 SEPTEMBER 12, 2006 APRIL 30, 2007 APRIL 30, 2007 MAY 16, 2007 MAY 16, 2007	APPROVAL DATE JANUARY 14, 2005 JANUARY 14, 2005 JANUARY 14, 2005 JANUARY 14, 2005 AUGUST 29, 2006 SEPTEMBER 18, 2006 SEPTEMBER 18, 2006 JUNE 15, 2007 JUNE 15, 2007 AUGUST 6, 2007 AUGUST 6, 2007	
SUBDIVISIONS 64 R-1 LOTS PHASE 1 CARRIAGE HOMES PHASE 2 CARRIAGE HOMES COMMERCIAL LOT 1 (C-1) COMMERCIAL LOT 14 (C-14) THE ESTATE LOTS COMMERCIAL LOT 22 (C-22) COMMERCIAL LOT 27 (C-27) LAKEWATCH DRIVE (EXT.) SECOND WATCH DRIVE	PLAT DATE DECEMBER 20, 2004 JULY 24, 2006 AUGUST 26, 2006 MAY 11, 2006 AUGUST 28, 2006 SEPTEMBER 12, 2006 MARCH 15, 2007 MAY 16, 2007 MAY 16, 2007 MAY 16, 2007	APPROVAL DATE JANUARY 3, 2005 JULY 24, 2006 AUGUST 29, 2006 JUNE 9, 2006 SEPTEMBER 18, 2006 JUNE 15, 2007 JUNE 4, 2007 AUGUST 9, 2007 AUGUST 9, 2007 AUGUST 9, 2007	DEED BOOK PAGE 839 809 892 2473 892 2474 887 27 894 192 915 628 914 1278 939 2344 939 2344 939 2344
SYMBOL DESCRIPTION W100 WATERLINE 100 W200 WATERLINE 200 W300 WATERLINE 300 W400 WATERLINE 400 FMS FORCE MAIN SEWER TP TREATMENT PLANT GS1 GRAVITY SEWER 1 W500 WATERLINE 500 GS3 GRAVITY SEWER 3 GS4 GRAVITY SEWER 4 W600 WATERLINE 600 WATER/SEWER EXTENSION SOIL & EROSION PLAN W700 WATERLINE 700 W800 WATERLINE 800 FMS2 FORCE MAIN SEWER 2 W900 WATERLINE 900 W1000 WATERLINE 1000 W1100 WATERLINE 1100 GS2 GRAVITY SEWER 2	PLAN DATE JUNE 15, 2005 JUNE 15, 2005 JUNE 15, 2005 JUNE 15, 2005 JANUARY 26, 2006 JANUARY 26, 2006 MAY 24, 2006 JULY 19, 2006 JULY 19, 2006 JULY 19, 2006 SEPTEMBER 12, 2006 SEPTEMBER 08, 2006 MARCH 09, 2007 APRIL 30, 2007 APRIL 30, 2007 APRIL 30, 2007 MAY 16, 2007 MAY 16, 2007 MAY 16, 2007 MAY 16, 2007	APPROVAL DATE JULY 15, 2005 JULY 15, 2005 JULY 15, 2005 JULY 15, 2005 FEBRUARY 17, 2006 FEBRUARY 17, 2006 JUNE 6, 2006 AUGUST 29, 2006 AUGUST 29, 2006 AUGUST 29, 2006 SEPTEMBER 18, 2006 SEPTEMBER 29, 2006 MARCH 22, 2007 JUNE 15, 2007 JUNE 15, 2007 JUNE 15, 2007 AUGUST 9, 2007 AUGUST 9, 2007 AUGUST 9, 2007 AUGUST 9, 2007	