

w:\drawings\2012\12014\eng\12014comp.dwg

TAX #30-52
55.721 ACRES (TOTAL)
REMAINING PROPERTY OF WILLARD
CONSTRUCTION OF SMITH MOUNTAIN LAKE, LLC
D.B. 667, PG. 387, D.B. 689, PG. 160
(WESTLAKE TOWNE CENTER)
ZONED: SM

- NOTES:**
1. WESTERN VIRGINIA WATER AUTHORITY
AVAILABILITY #: 12-261.
 2. REFER TO SHEET 3 OF 10 OF THE APPROVED PLAN
SET FOR ADDITIONAL INFORMATION AND FOR WESTERN
VIRGINIA WATER AUTHORITY DETAIL *W-5, COMMERCIAL
WATER SERVICE METER SIZES 5/8" TO 2"*.
 3. FLOOR DRAINS IN HANGER ARE INCLUDED IN THE
ARCHITECTURAL PLANS, AND ARE SHOWN HEREON
FOR REFERENCE ONLY. SITE CONTRACTOR SHALL
PROVIDE 6" PVC DRAIN TO WITHIN 5' OF HANGER.

COMMONWEALTH OF VIRGINIA

HOWARD P.
BOGGESS, II

Lic. No. 000920

LANDSCAPE ARCHITECT

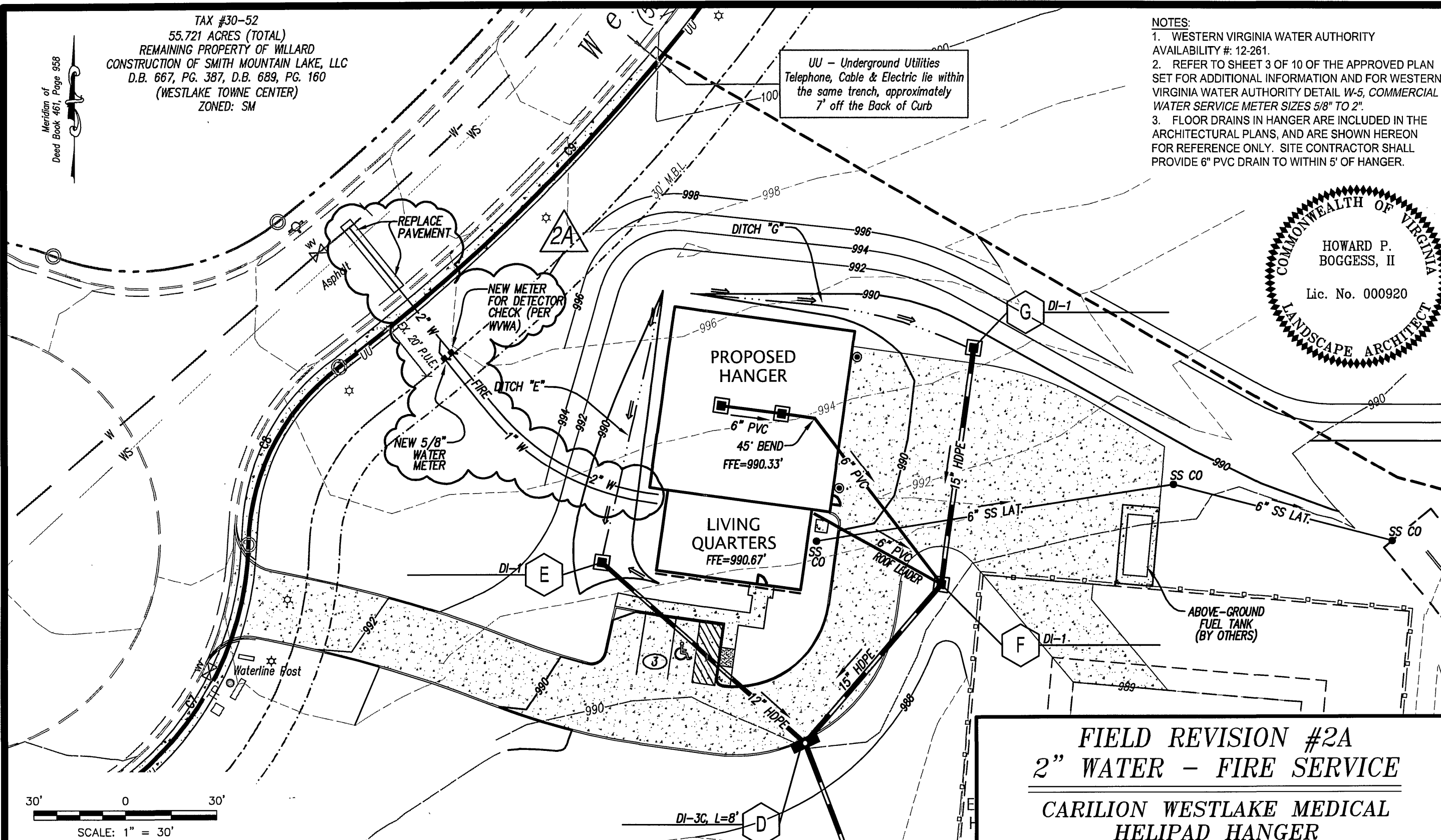

FIELD REVISION #2A
2" WATER - FIRE SERVICE

CARILION WESTLAKE MEDICAL
HELIPAD HANGER



LUMSDEN ASSOCIATES, P.C.
ENGINEERS-SURVEYORS-PLANNERS
ROANOKE, VIRGINIA

4664 BRAMBLETON AVENUE
P.O. BOX 20669
ROANOKE, VIRGINIA 24018

As-Built
12/03/2012

PHONE: (540) 774-4411
FAX: (540) 772-9445
MAIL@LUMSDENPC.COM

DATE:	September 27, 2012
COMM. NO.:	12-014
SCALE:	1"=30'

SHEET 1 OF 1