

MATCHLINE SHEET C1.15

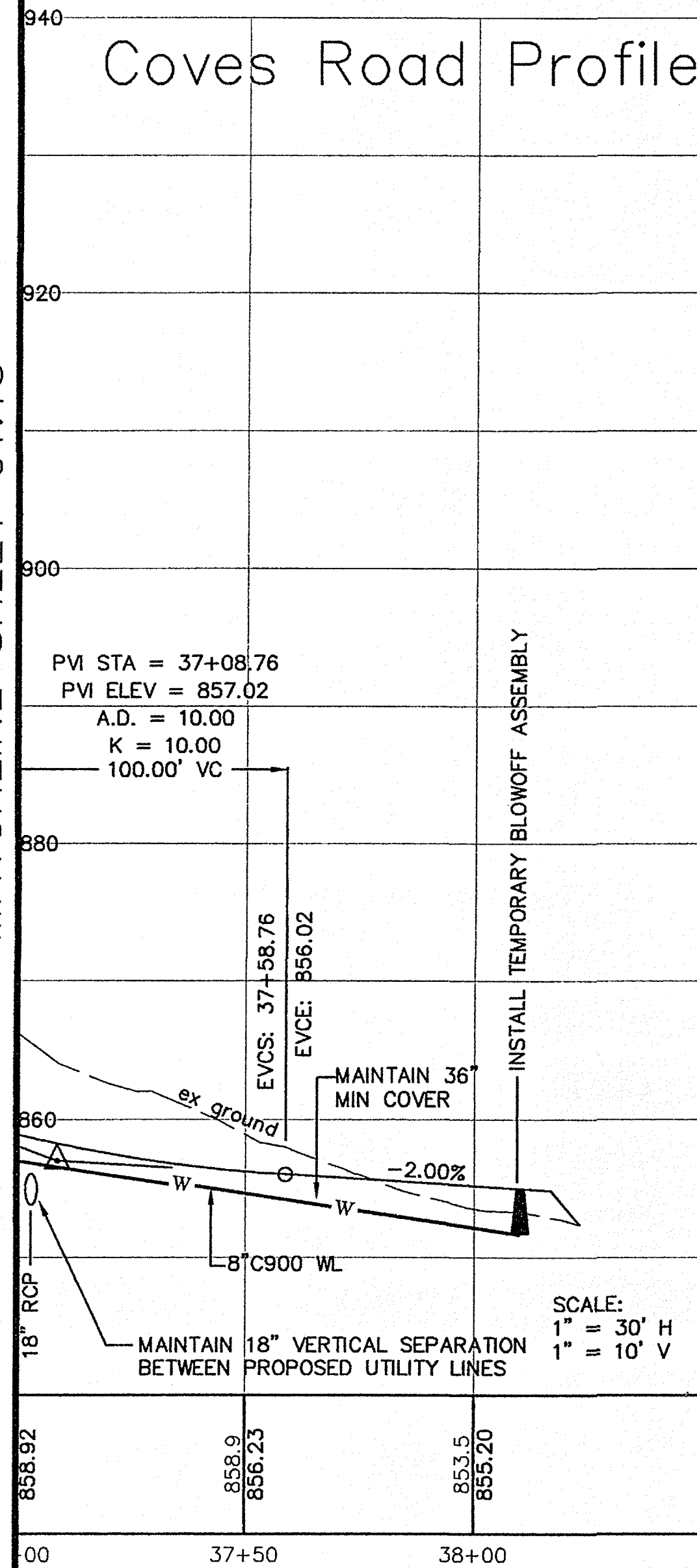

NOTE:
THE UTILITY PROFILE INDICATED HEREON FOR THE WATERLINE SHALL BE REPRESENTATIVE OF THE PROPOSED COMMON LOW PRESSURE FORCEMAIN PROPOSED FOR INSTALLATION ON THIS ROAD. THE SEWER FORCEMAIN SHALL BE INSTALLED IN THE EXACT SAME CONFIGURATION AS THE WATERLINE INCLUDING ALL AIR RELEASE ASSEMBLIES. REFER TO THE SITE PLAN FOR HORIZONTAL LOCATION OF THE SEWER FORCEMAIN.

MATCHLINE SHEET C1.18

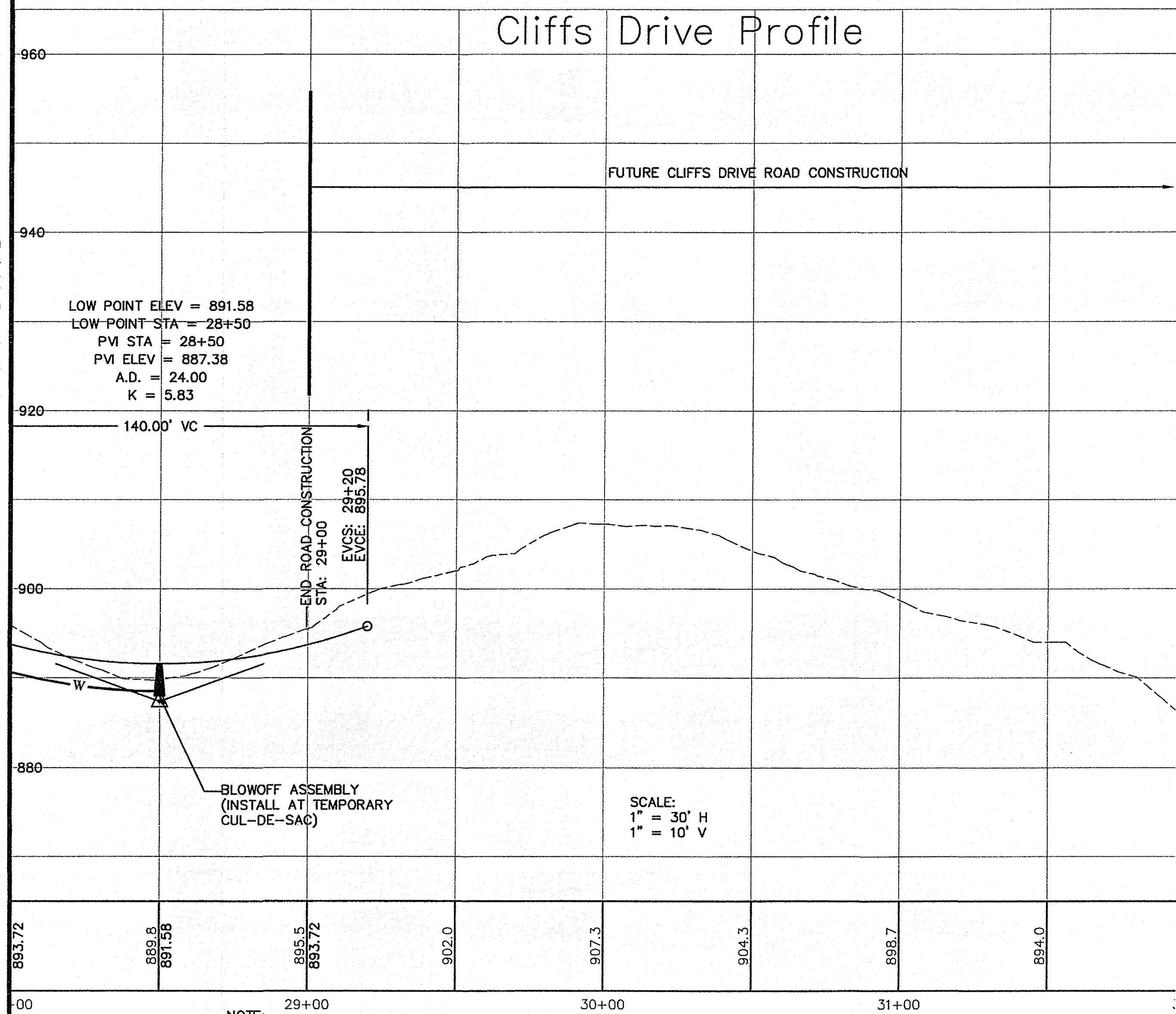

NOTE:
THE UTILITY PROFILE INDICATED HEREON FOR THE WATERLINE SHALL BE REPRESENTATIVE OF THE PROPOSED COMMON LOW PRESSURE FORCEMAIN PROPOSED FOR INSTALLATION ON THIS ROAD. THE SEWER FORCEMAIN SHALL BE INSTALLED IN THE EXACT SAME CONFIGURATION AS THE WATERLINE INCLUDING ALL AIR RELEASE ASSEMBLIES. REFER TO THE SITE PLAN FOR HORIZONTAL LOCATION OF THE SEWER FORCEMAIN.

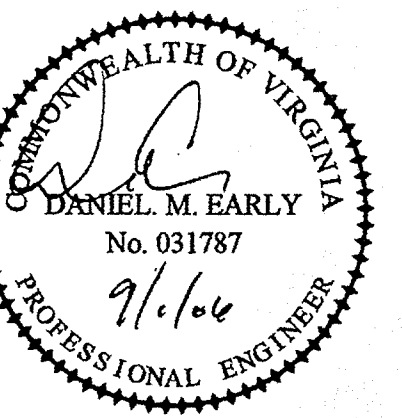

ACS DESIGN

ENGINEERING • SURVEYING
LANDSCAPE ARCHITECTURE
CONSTRUCTION MANAGEMENT

2203 PETERS CREEK ROAD
ROANOKE, VIRGINIA 24017
P 540.582.2345 F 582.2344
INFO@ACSDSIGNLLC.COM
WWW.ACSDSIGNLLC.COM

The Coves at Smith Mountain Lake
Optima Properties-Smith Mountain Lake, LLC
Franklin County, Virginia

DRAWN BY: dme
DESIGNED BY: dme
CHECKED BY:
DATE: 15 May 2006
JOB NUMBER: 05271

REVISIONS:
No. 1 8/18/06
per VDOT/ACS
No. 2 08/28/2006
No. 3 5/1/07
FINAL FOR CONSTRUCTION
No. 4

SHEET NO:
C1.16

COVES ROAD
ROAD & UTILITY
PROFILE