

CONTINUATION OF GARDEN CITY BLVD WATER MAIN REPLACEMENT PHASE 1  
NEW WATER MAIN FROM 12" GV EAST OF DAVENPORT AVE TO 2946 GARDEN CITY BLVD

GARDEN CITY BLVD WATER MAIN REPLACEMENT - PHASE 1  
- REPLACEMENT OF 12" MAIN FROM JIVWOOD AVE. TOWARDS HARTSOOK BLVD.  
10/26/2015 AS-BUILT Western Virginia Water Authority  
CHARLES CRUSH INSPECTOR

\* NEW LINE IS LAID IN DITCHLINE ALONG GARDEN CITY BLVD, THEN CROSSES ROAD AND TIES INTO EXISTING 12" LINE ON OPPOSITE SIDE OF ROAD.

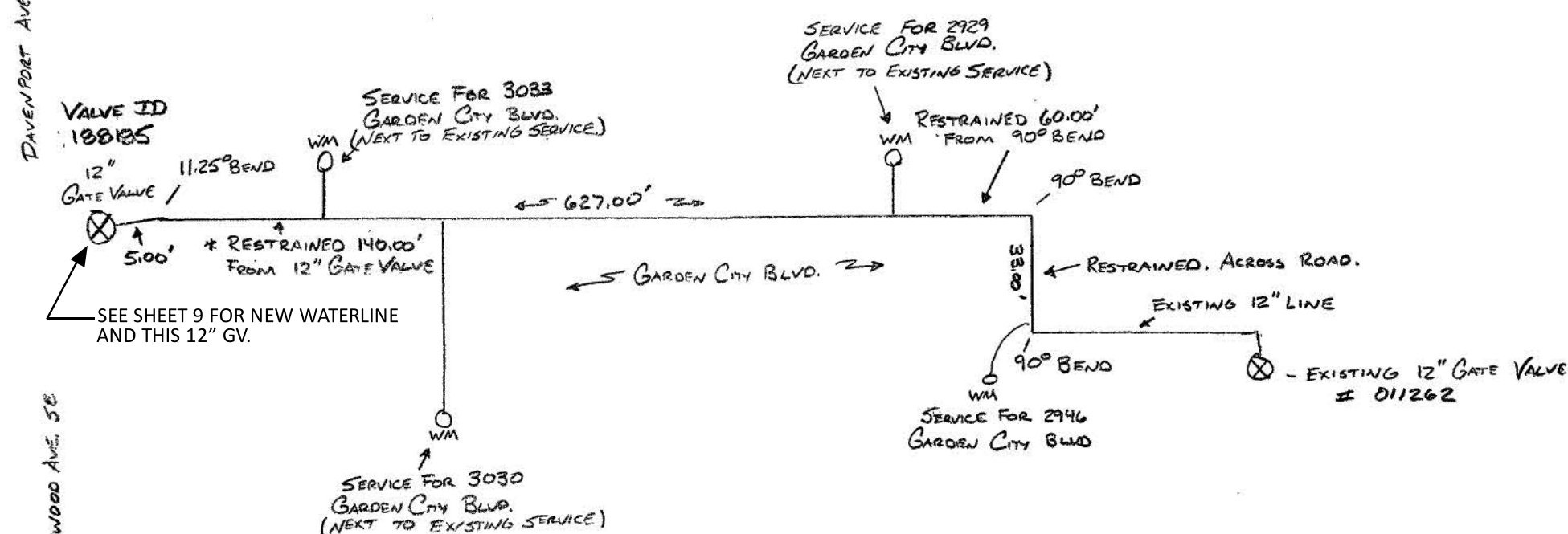

\* MATERIALS USED

- WATER MAIN: 12" NATIONAL C900 DR14 PVC  
- WATER SERVICES: 1" ENDOT C906 DR9 HDPE  
- WATER VALVE: 12" KENNEDY GATE VALVE

\* WATER MAIN HYDROSTATIC LEAKAGE TEST

10-06-2015 / 12" MAIN / 632' LONG / TEST PRESSURE 200 PSI  
0.20 GAL. OF LEAKAGE - LINE PASSED.

\* BACTERIOLOGICAL TEST DATES AND LOCATION

10-07-15 TEMP. BLOW-OFF @ 1:05 PM. C<sub>12</sub>: 1.20  
10-08-15 TEMP. BLOW-OFF @ 2:00 PM. C<sub>12</sub>: 1.71

**WR&A**  
**WHITMAN, REQUARDT AND ASSOCIATES, LLP**  
Engineers, Architects and Planners  
1700 Kraft Drive, Suite 1200  
BLACKSBURG, VIRGINIA  
(540) 951-3727

FAX: (540)-951-3741  
www.wraltip.com

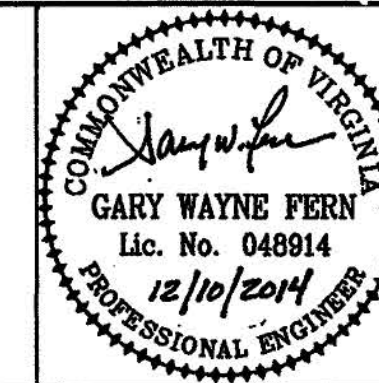

SCALE:  
HORIZ: 1"=20'  
VERT: 1"=5'  
DATE: DECEMBER 2014  
DESIGNED: P.J.M.  
DRAWN: L.W.C.  
CHECKED: G.W.F.  
PROJECT NO.: 46807-000

**Western Virginia Water Authority**  
601 South Jefferson Street, Suite 300 Roanoke, Va. 24011  
GARDEN CITY BOULEVARD WATER MAIN REPLACEMENT  
Phase 1  
PROFILE-IMLAY AVE., MABRY AVE. AND LEWIS ROAD

**SHEET**  
10  
OF  
12