

- PROJECT NOTES:
1. ALL DISTURBED AREAS SHALL BE SEEDED, MULCHED, AND RETURNED TO CONDITIONS GREATER THAN OR EQUAL TO CONDITIONS PRIOR TO CONSTRUCTION.
  2. ALL WATER SERVICES CROSSING THE ROAD SHALL BE BORED UNDER THE PAVEMENT.
  3. CONNECTIONS TO EXISTING SYSTEM SHALL BE MADE "DRY" WHEN POSSIBLE. CONTRACTOR TO COORDINATE WITH WESTERN VIRGINIA WATER AUTHORITY INSPECTOR TO SHUT OFF WATER.
  4. PAVEMENT RESTORATION SHALL INCLUDE REPLACEMENT TO THE EXISTING EDGE OF PAVEMENT, REGARDLESS OF THE TRENCH WIDTH AND LOCATION, UP TO ONE-HALF OF THE LANE WIDTH. A SAW CUT IS REQUIRED FOR ALL PAVEMENT DISTURBANCES PRIOR TO TRENCH EXCAVATION. A TACK COAT MUST BE APPLIED TO THE VERTICAL SURFACES OF THE EXISTING PAVEMENT STRUCTURE PRIOR TO PLACING NEW PAVEMENT STRUCTURE. THE PAVEMENT SECTION SHALL BE A MINIMUM OF 6"-VDOT 21B AGGREGATE, 3"-BM25.0d BASE, AND 1-1/2" -VDOT SM9.5A SURFACE.
  5. CONTRACTOR TO ENSURE PAVEMENT SEAM BETWEEN THE NEW PATCH AND/OR OVERLAY AND THE EXISTING PAVEMENT IS NOT LOCATED IN A STORMWATER RUNOFF CONVEYANCE AREA AND/OR DITCH.
  6. AS PORTIONS OF THE EXISTING WATERLINE ARE ABANDONED, ASSOCIATED VALVE VAULTS ARE TO BE ABANDONED IN PLACE BY REMOVING THE FRAME & COVER AND FILLING THE VAULT WITH COMPACTED 21A STONE. PROJECT INSPECTOR WILL NOTIFY CONTRACTOR WHEN VAULTS CAN BE ABANDONED.

FOR ADDITIONAL REQUIRED ESC MEASURES FOR THE INSTALLATION OF THE WATER LINE SEE TYPICAL ESC DETAILS ON SHEET 1G.

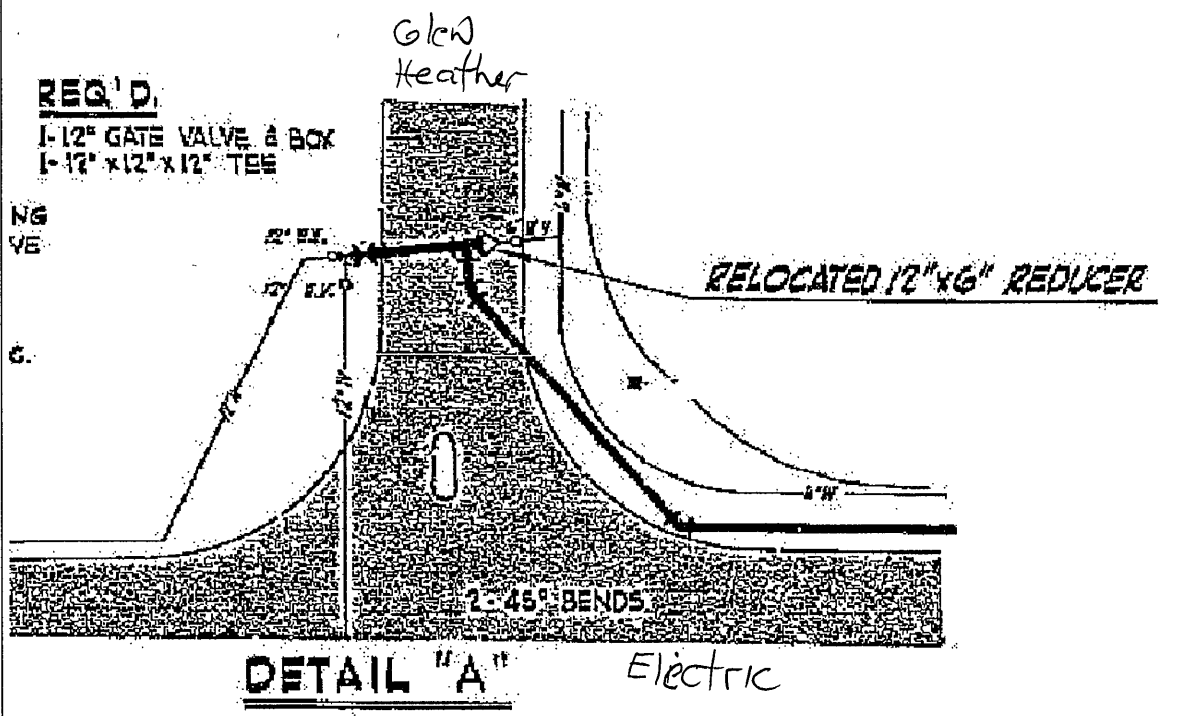
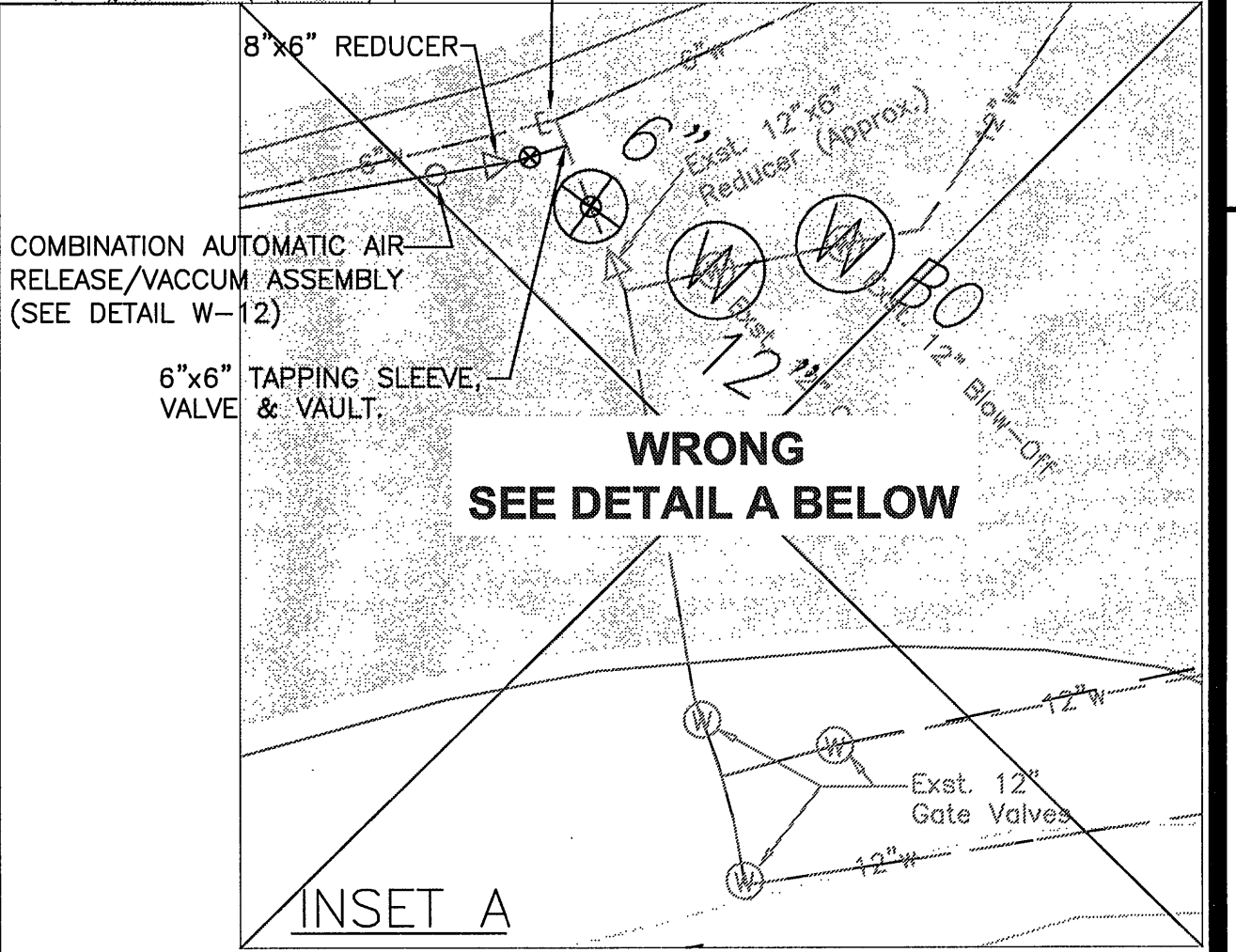
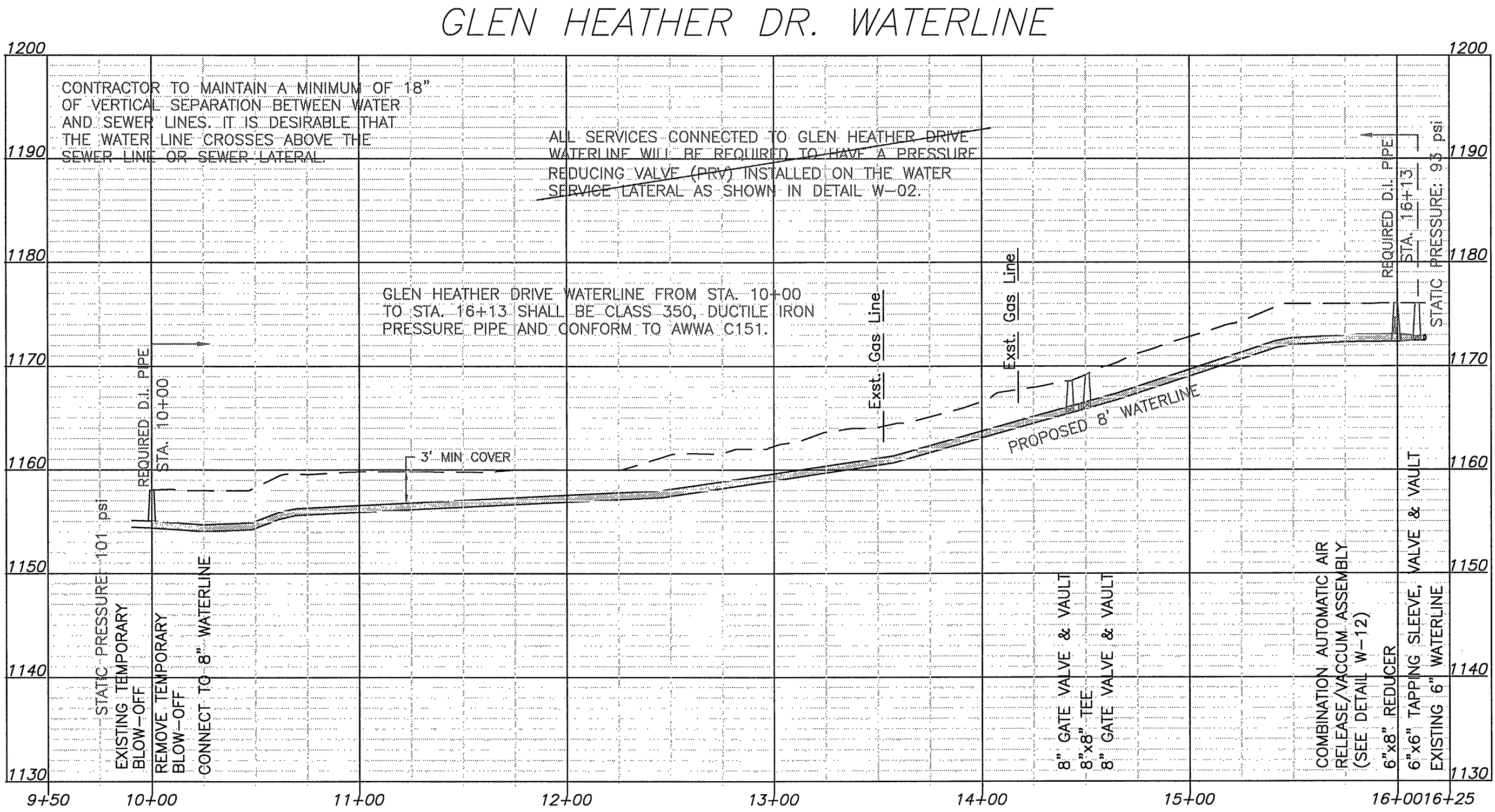
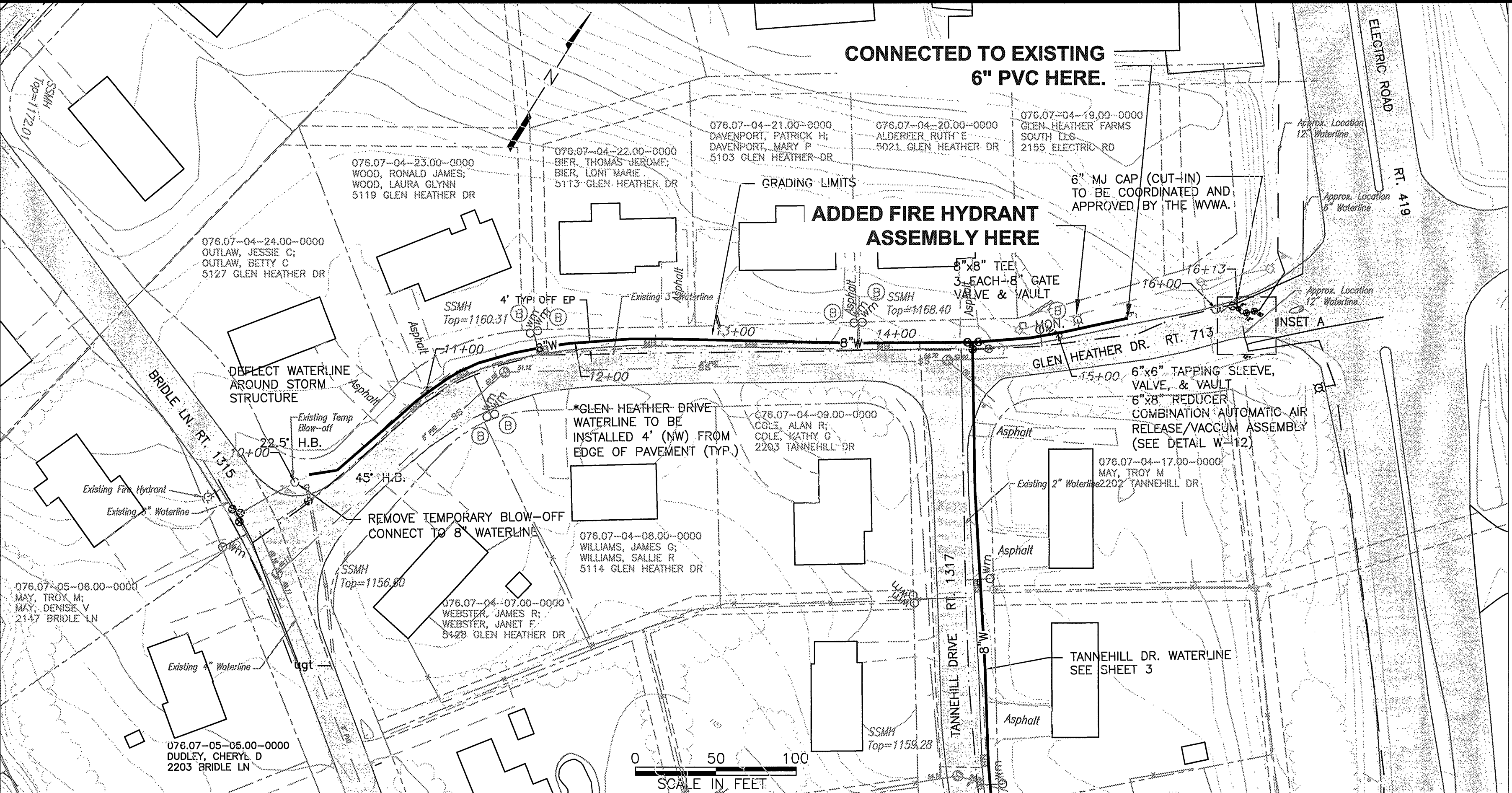

**ANDERSON & ASSOCIATES, INC.**  
Professional Design Services  
www.andassoc.com  
VA - NC - TN - WV

**WATERLINE PLAN & PROFILE III**  
**GLEN HEATHER FARMS AREA**  
**WATER LINE REPLACEMENTS**  
**PHASE I**  
**AS-BUILT BY WWA**

Designed By: TFB  
Drawn By: CBD/LTB  
Checked By: JKD  
Date: 13 JAN 2010  
Revised: 01 FEB 2010  
09 APR 2010  
22 JUN 2010  
09 JUL 2010  
Scale: HORZ: 1" = 50'  
VERT: 1" = 10'  
Plan #: 27379-002  
Sheet: 4 OF 10