

DEMOLITION NOTES:

DEMOLITION SHALL INCLUDE, UNLESS OTHERWISE NOTED ON DRAWINGS, REMOVAL OF EXISTING OBJECTS OR IMPROVEMENTS, WHETHER INDICATED ON THE DRAWINGS OR NOT, THAT WOULD IN THE OPINION OF THE OWNER, PREVENT OR INTERFERE WITH THE PROGRESS OR COMPLETION OF THE PROPOSED WORK.

PERMITS, FEES AND LICENSES SHALL BE SECURED AND PAID FOR BY THE CONTRACTOR, INCLUDING DISPOSAL CHARGES AS REQUIRED.

WORK SHALL COMPLY WITH THE REQUIREMENTS OF THE GOVERNING AUTHORITIES IN DEMOLITION OF EXISTING PAVEMENT, CURBS AND GUTTERS, DRAINAGE STRUCTURES AND UTILITIES AS MAY BE REQUIRED.

CONTRACTOR SHALL SAW-CUT ALL JOINTS WHERE EXISTING CURBING, PAVEMENT AND SIDEWALK IS TO BE DEMOLISHED AND NEW CONSTRUCTION JOINS THE EXISTING.

CONTRACTOR SHALL COMPLETELY FILL BELOW GRADE AREAS AND VOIDS FROM DEMOLITION OR REMOVAL OF STRUCTURES (UNDERGROUND FUEL STORAGE TANK, BASEMENTS, WELLS, ETC.) USING APPROVED SELECT FILL MATERIAL.

ALL EXISTING CURBING, CONCRETE SIDEWALK, ENTRANCES, BUILDING FOUNDATIONS AND TREES AND BRUSH THAT ARE DEMOLISHED SHALL BE REMOVED FROM THE SITE AND DISPOSED OF BY THE CONTRACTOR, BUILDING DEBRIS, ETC. SHALL NOT BE USED AS FILL MATERIAL ON THE SITE.

CONTRACTOR SHALL PROVIDE THE FOLLOWINGS PROTECTIONS AT THE JOB SITE:

MAKE ARRANGEMENTS, BEFORE INITIATING DEMOLITION, FOR RELOCATING, DISCONNECTION, REROUTING, ABANDONING, OR SIMILAR ACTION AS MAY BE REQUIRED RELATIVE TO UTILITIES AND OTHER UNDERGROUND PIPING, TO PERMIT WORK TO PROCEED WITHOUT DELAY. ARRANGEMENTS SHALL BE MADE IN ACCORDANCE WITH REGULATIONS OF AUTHORITIES OF UTILITIES MENTIONED, SUCH AS OVERHEAD AND UNDERGROUND POWER AND TELEPHONE LINES AND EQUIPMENT, GAS PIPING, STORM SEWERS, SANITARY SEWERS, OR WATER PIPING. CONTRACTOR SHALL NOT USE WATER WHEN IT MAY CREATE HAZARDOUS OR OBJECTIONABLE CONDITIONS, SUCH AS ICE, FLOODING AND/OR POLLUTION.

ENSURE SAFE PASSAGE OF PERSONS AROUND ALL AREAS OF DEMOLITION.

CONDUCT OPERATIONS TO PREVENT DAMAGE TO ADJACENT BUILDINGS, STRUCTURES, OTHER FACILITIES, OR INJURY TO PERSONS.

PROMPTLY REPAIR DAMAGES CAUSED TO ADJACENT FACILITIES BY DEMOLITION OPERATIONS AT NO COST TO THE OWNER.

MAINTAIN EXISTING UTILITIES INDICATED TO REMAIN, KEEP IN SERVICE, AND PROTECT AGAINST DAMAGE DURING DEMOLITION OPERATIONS. PREVENT INTERRUPTION OF EXISTING UTILITIES SERVING OCCUPIED OR USED FACILITIES, EXCEPT WHEN AUTHORIZED IN WRITING BY AUTHORITIES HAVING JURISDICTION. PROVIDE TEMPORARY SERVICES DURING INTERRUPTIONS TO EXISTING UTILITIES AS ACCEPTABLE TO GOVERNING AUTHORITIES.

USE WATER SPRINKLING AND OTHER SUITABLE METHODS TO LIMIT DUST AND DIRT RISING AND SCATTERING IN AIR TO LOWEST PRACTICAL LEVEL.

COMPLY WITH GOVERNING REGULATIONS PERTAINING TO ENVIRONMENTAL PROTECTION.

- EXIST. STORM STR. SCHEDULE:

 - A - ex. curb inlet a di-3b (8' throat) TOP=922.98 INV. OUT=919.98
 - B - ex. curb inlet b di-3b (10' throat) TOP=923.07 NOT ACCESSIBLE
 - C - ex. curb inlet c di-3b (6' throat) TOP=921.48 INV. OUT=916.66
 - D - ex. storm mh d TOP=921.68 NOT ACCESSIBLE
 - E - ex. curb inlet e di-3b (10' throat) TOP=921.92 INV=910.42
 - F - ex. storm mh f storm mono box TOP=922.96 ELLIPTICAL INV. IN=911.01 ELLIPTICAL INV. OUT=911.01
 - G - ex. grate inlet g TOP=920.83 REVISED TOP=921.3 INV. OUT=918.46
 - H - ex. storm manhole h TOP=920.11 INV. IN=918.03 INV. OUT=917.93
 - I - ex. storm manhole i TOP=919.26 INV. IN=916.86 INV. OUT=916.78
 - J - ex. storm manhole j TOP=918.79
 - K - ex. trench drain & grate inlet k TOP=926.16 INV. IN=924.84 FROM DRAIN INV. OUT=924.26
 - L - ex. storm manhole l TOP=926.47 12" RCP INV. IN=923.54 15" RCP INV. IN=921.28 ELLIPTICAL INV. IN=913.12 ELLIPTICAL INV. OUT=912.97
 - M - ex. storm mh m TOP=927.33 15" INV. IN=923.89 FROM GRATE INLET INV. IN=923.13 INV. IN=923.25 15" RCP INV. OUT=923.11
 - N - ex. grate inlet n TOP=926.90 INV. OUT=924.34
- EXIST. SANITARY SEWER STR. SCHEDULE:

 - EX-1 - SANITARY SEWER MANHOLE TOP=922.12 INV. IN=917.02 (8" LATERAL- as provided by the w.v.w.a) INV. OF MH=915.42 (g.c. to verify exact-location prior to any sanitary sewer construction)

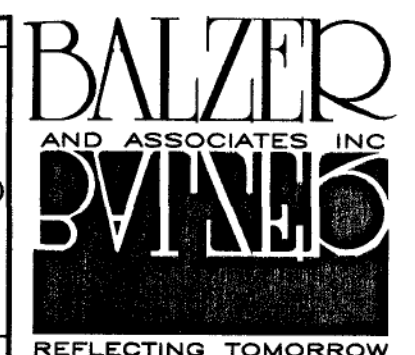
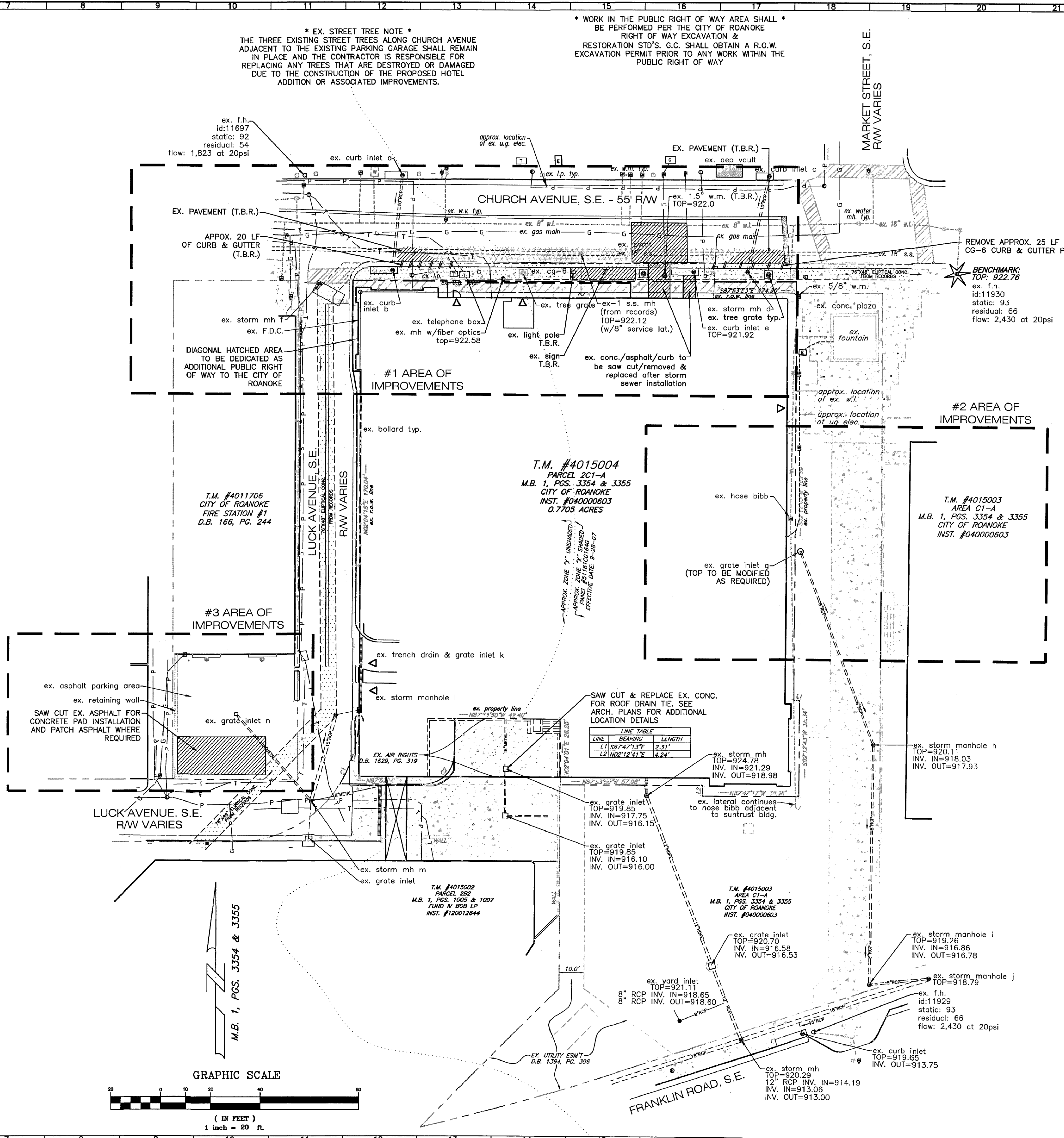

Balzer and Associates, Inc.

New River Valley
Richmond
Roanoke
Shenandoah Valley

RESIDENTIAL LAND DEVELOPMENT ENGINEERING
SITE DEVELOPMENT ENGINEERING
LAND USE PLANNING & ZONING
LANDSCAPE ARCHITECTURE
LAND SURVEYING
ARCHITECTURE
STRUCTURAL ENGINEERING
TRANSPORTATION ENGINEERING
ENVIRONMENTAL & SOIL SCIENCE
WETLAND DELINEATIONS & STREAM EVALUATIONS

1208 Corporate Circle
Roanoke, VA 24018
540-772-9580
FAX 540-772-8050

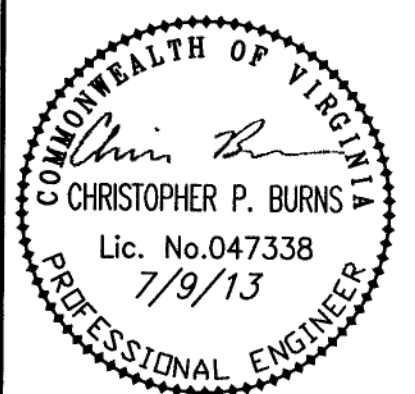

HAMPTON INN & SUITES - DOWNTOWN

EXISTING CONDITIONS & DEMO. PLAN

CITY OF ROANOKE, VIRGINIA

DRAWN BY BTC
DESIGNED BY BTC
CHECKED BY CPB
DATE 5-31-2013
SCALE 1"=20'

REVISIONS:
6-27-2013
7-9-2013