

DEVELOPMENT PLAN

FOR

THE HILLS AT CASTLE ROCK

SITUATED IN

WINDSOR HILLS MAGISTERIAL DISTRICT
ROANOKE COUNTY, VIRGINIA

DATE: JUNE 14, 2004

PREPARED FOR

PARK PLACE DEVELOPERS, INC.

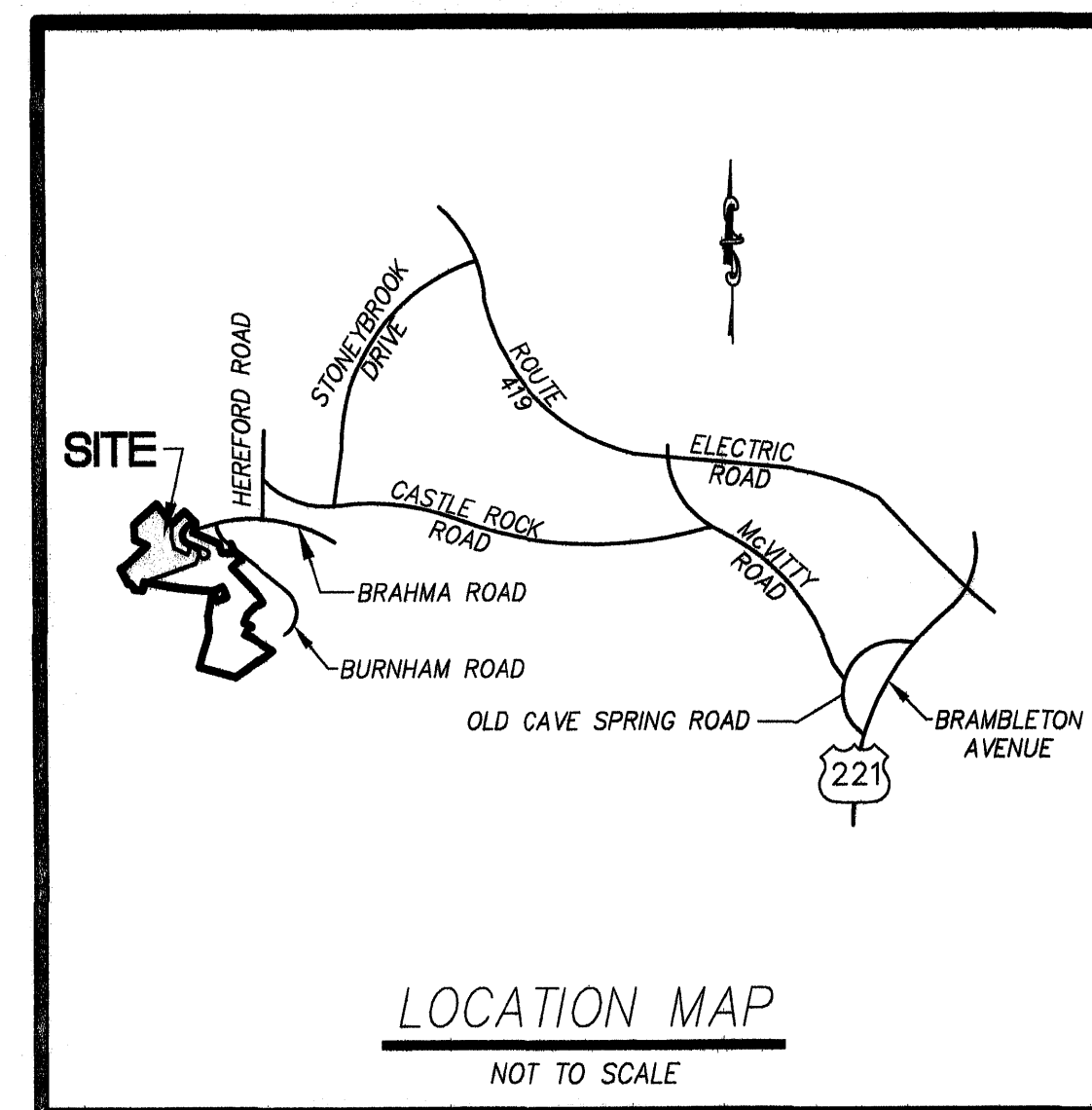

--INDEX OF DRAWINGS--

SHEET No.	DESCRIPTION
1	LUMSDEN ASSOCIATES COVER SHEET
2	ROANOKE COUNTY STANDARD COVER SHEET
3	RECORD PLAT
4	NOTES AND DETAILS
5	DIMENSIONAL LAYOUT
6	GRADING PLAN
7	PROFILES
8	EROSION AND SEDIMENT CONTROL PLAN
9	EROSION AND SEDIMENT CONTROL NOTES AND DETAILS
10	WATER AND SANITARY SEWER DETAILS
11	WATER AND SANITARY SEWER DETAILS

"As-Built"

1. Water and sewer "As-Built" information taken from plans furnished by J. P. Turner and Sons, Inc., contractor.
2. "As- Built dimensions are shown in brackets.

I AM CERTIFIED BY THE STATE OF VIRGINIA AS A "RESPONSIBLE LAND DISTURBER". I SHALL BE RESPONSIBLE FOR THE IMPLEMENTATION OF THE EROSION AND SEDIMENT CONTROL PLAN AS SHOWN.

SIGNATURE: _____
 PRINTED NAME: _____
 CERTIFICATE No.: _____
 EXPIRATION DATE: _____
 TELEPHONE No.: _____
 ADDRESS: _____



LUMSDEN ASSOCIATES, P.C.
ENGINEERS-SURVEYORS-PLANNERS

4664 BRAMBLETON AVENUE, SW
 P.O. BOX 20669
 ROANOKE, VIRGINIA 24018

PHONE: (540) 774-4411
 FAX: (540) 772-9445
 E-MAIL: MAIL@LUMSDENPC.COM

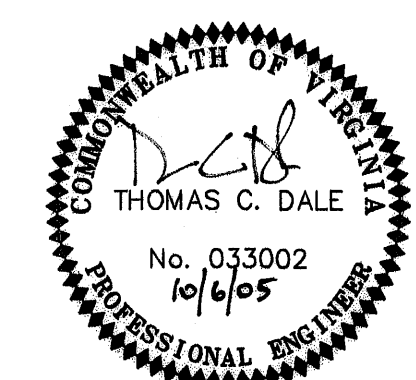

REVISIONS	
DATE	SHEETS
5/31/05	1, 3, 5, 6, & 8
7/18/05	1 THRU 11
10/8/05	5, 6, 7 & 8
10/13/06	WATER & SEWER AS-BUILT
COMMISSION NO. 2002-312	
SHEET 1 OF 11	