

PROPERTY OWNER: ROANOKE REDEVELOPMENT AND HOUSING AUTHORITY
1641 SALEM AVE. S.W.
ROANOKE, VA 24017

ENGINEER: LMW PROFESSIONAL CORPORATION
102 ALBEMARLE AVE., S.E.
ROANOKE, VIRGINIA 24013
(540) 345-0675

OFFICIAL TAX #'s OF PROPERTY: 1210634

ZONING CLASSIFICATION: RM-2 (MULTI-FAMILY RESIDENTIAL)
TOTAL ACREAGE OF LAND TO BE DEVELOPED: 8.2 ACRES
TOTAL ACREAGE OF LAND TO BE DISTURBED: 8.2 ACRES
LEGAL REFERENCE: ACREAGE & PT ALLEY HURT PARK SITE PROJECT
PROPOSED USE OF SITE: DEMOLITION OF BUILDINGS

FLOOD STATEMENT:
THIS PROPERTY DOES NOT LIE WITHIN THE LIMITS OF A 500-YEAR FLOODPLAIN AS DESIGNATED BY CURRENT FEMA MAPS. THE PROPERTY IS LOCATED IN ZONE X, (OUTSIDE 500 YEAR FLOOD PLAIN) ON PANEL 42 OF 90, MAP NUMBER 51161C0042F, DATED FEBRUARY 04, 2005.

NOTICE: ALL LANDOWNERS, DEVELOPERS AND CONTRACTORS

FAILURE TO COMPLY WITH THE CONSTRUCTION REQUIREMENTS LISTED BELOW MAY RESULT IN THE COSTLY REMOVAL OF STRUCTURES, TIME DELAYS OR THE ISSUANCE OF A STOP WORK ORDER.

RIGHT-OF-WAY EXCAVATION PERMIT - PRIOR TO THE COMMENCEMENT OF ANY DIGGING, ALTERATION, OR CONSTRUCTION WITHIN THE PUBLIC RIGHT-OF-WAY (STREETS, ALLEYS, PUBLIC EASEMENTS), A RIGHT-OF-WAY EXCAVATION PERMIT SHALL BE APPLIED FOR AND OBTAINED BY THE CONTRACTOR FROM THE CITY OF ROANOKE.

LAND DISTURBING PERMIT - AN APPROVED EROSION SEDIMENT CONTROL PLAN FOR ANY FILL/BORROW SITES ASSOCIATED WITH THIS PROJECT MUST BE SUBMITTED PRIOR TO THE ISSUANCE OF A LAND DISTURBING PERMIT

PLANS AND PERMITS - A COPY OF THE PLANS APPROVED BY THE CITY (SIGNED BY THE PROPER CITY OFFICIALS) AND ALL PERMITS ISSUED BY THE CITY SHALL BE AVAILABLE AT THE CONSTRUCTION SITE AT ALL TIMES OF ONGOING CONSTRUCTION.

LOCATION OF UTILITIES - THE CONTRACTOR SHALL VERIFY THE LOCATION OF ALL EXISTING UTILITIES PRIOR TO THE COMMENCEMENT OF ANY CONSTRUCTION.

CONSTRUCTION ENTRANCE - THE CONTRACTOR SHALL INSTALL AN ADEQUATE CONSTRUCTION ENTRANCE FOR ALL CONSTRUCTION RELATED EGRESS FROM THE SITE. SIZE AND COMPOSITION OF CONSTRUCTION ENTRANCE SHALL BE AS SHOWN ON PLANS.

STREETS TO REMAIN CLEAN - IT SHALL BE THE RESPONSIBILITY OF THE CONTRACTOR TO INSURE THAT THE PUBLIC STREET ADJACENT TO THE CONSTRUCTION ENTRANCE REMAINS FREE OF MUD, DIRT, DUST AND/OR ANY TYPE OF CONSTRUCTION MATERIALS OR LITTER AT ALL TIMES.

BARRICADES/DITCHES - THE CONTRACTOR SHALL MAINTAIN THE INTEGRITY OF ALL EXCAVATED DITCHES AND SHALL FURNISH AND ENSURE THAT ALL BARRICADES PROPER AND NECESSARY FOR THE SAFETY OF THE PUBLIC ARE IN PLACE.

SEWER AND PAVEMENT REPLACEMENT - CONSTRUCTION OF SANITARY SEWERS AND THE REPLACEMENT OF PAVEMENT SHALL BE IN ACCORDANCE WITH APPROVED STANDARDS AND SPECIFICATIONS OF THE CITY OF ROANOKE AND THE WESTERN VIRGINIA WATER AUTHORITY.

APPROVED PLANS/CONSTRUCTION CHANGES - ANY CHANGE OR VARIATION FROM CONSTRUCTION DESIGN AS SHOWN ON THE OFFICIALLY APPROVED PLANS SHALL BE APPROVED BY THE EROSION AND SEDIMENT CONTROL AGENT PRIOR TO SAID CHANGES OR VARIATION IN CONSTRUCTION BEING MADE.

FINAL ACCEPTANCE/CITY - THE DEVELOPER OR CONTRACTOR SHALL FURNISH THE CITY OF ROANOKE'S PLANNING BUILDING AND DEVELOPMENT DEPARTMENT WITH A FINAL CORRECT SET OF AS-BUILT PLANS PRIOR TO FINAL ACCEPTANCE BY THE CITY.

ROANOKE REDEVELOPMENT AND HOUSING AUTHORITY ASBESTOS & LEAD BASED PAINT ABATEMENT AND BUILDING DEMOLITION HURT PARK, VA-11-3 PROJECT # 060901

CITY OF ROANOKE, VIRGINIA
RRHA CAPITAL IMPROVEMENTS OFFICE
2624 SALEM TURNPIKE, N.W.
ROANOKE, VIRGINIA 24017

CONTACT PERSON: RICHARD C. WHITE P.E.

LMW P.C.

ENGINEERING - ARCHITECTURE - SURVEYING - LANDSCAPE DESIGN

102 ALBEMARLE AVE., S.E.

ROANOKE, VA 24013

PHONE: (540) 345-0675

FAX: (540) 342-4456

E-MAIL: lmweng@lmw.roacoxmail.com

INDEX OF DRAWINGS

1. COVER
2. ABBREVIATIONS, LEGEND, & GENERAL NOTES
3. EROSION & SEDIMENT CONTROL
4. DEMOLITION PLAN
5. GRADING PLAN

DEVELOPMENT PLAN APPROVED	
Agent, Planning Commission	<i>[Signature]</i> Date 12-07
Development Engineer	<i>[Signature]</i> 6-12-07
Zoning Administrator	<i>[Signature]</i> 6/12/07
Any changes to this approved plan must be coordinated with the Agent to the Planning Commission and reviewed prior to construction.	

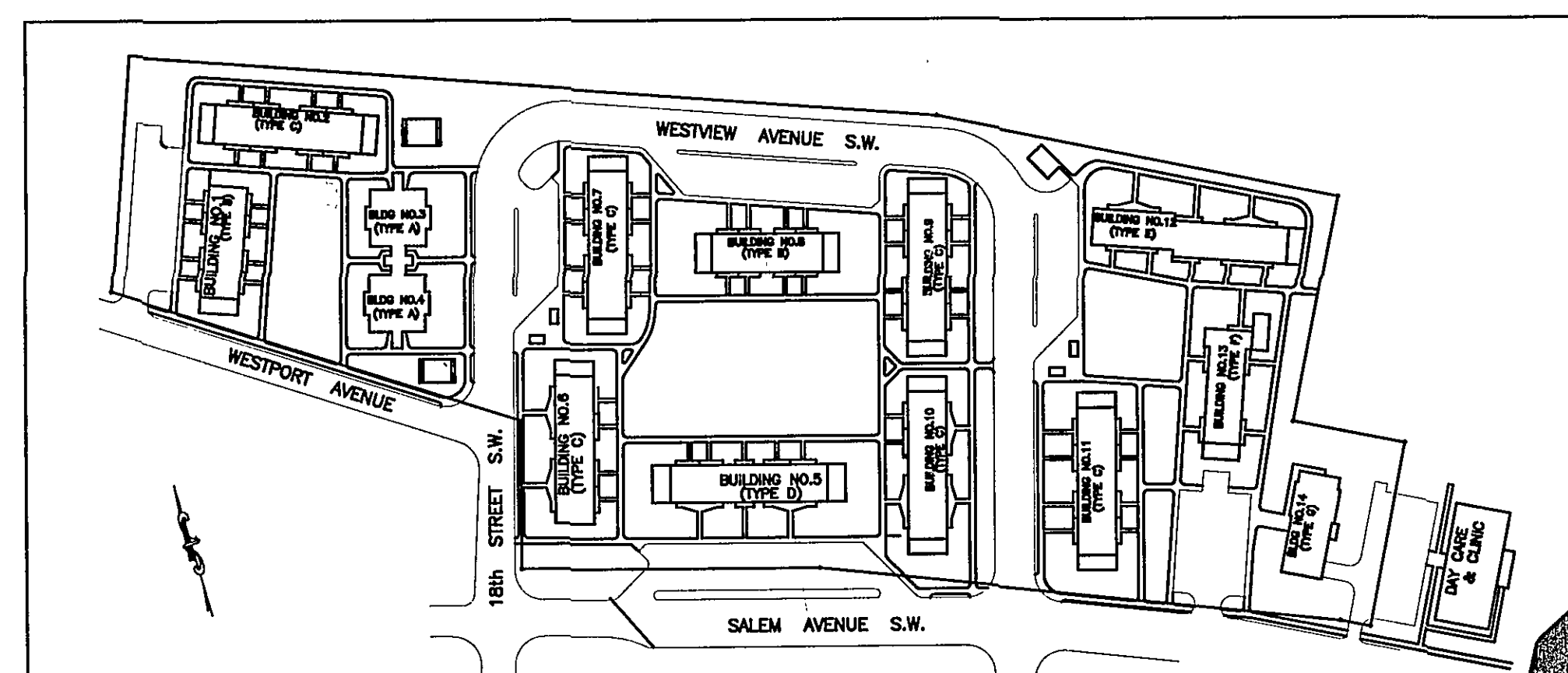

VICINITY MAP

NO SCALE

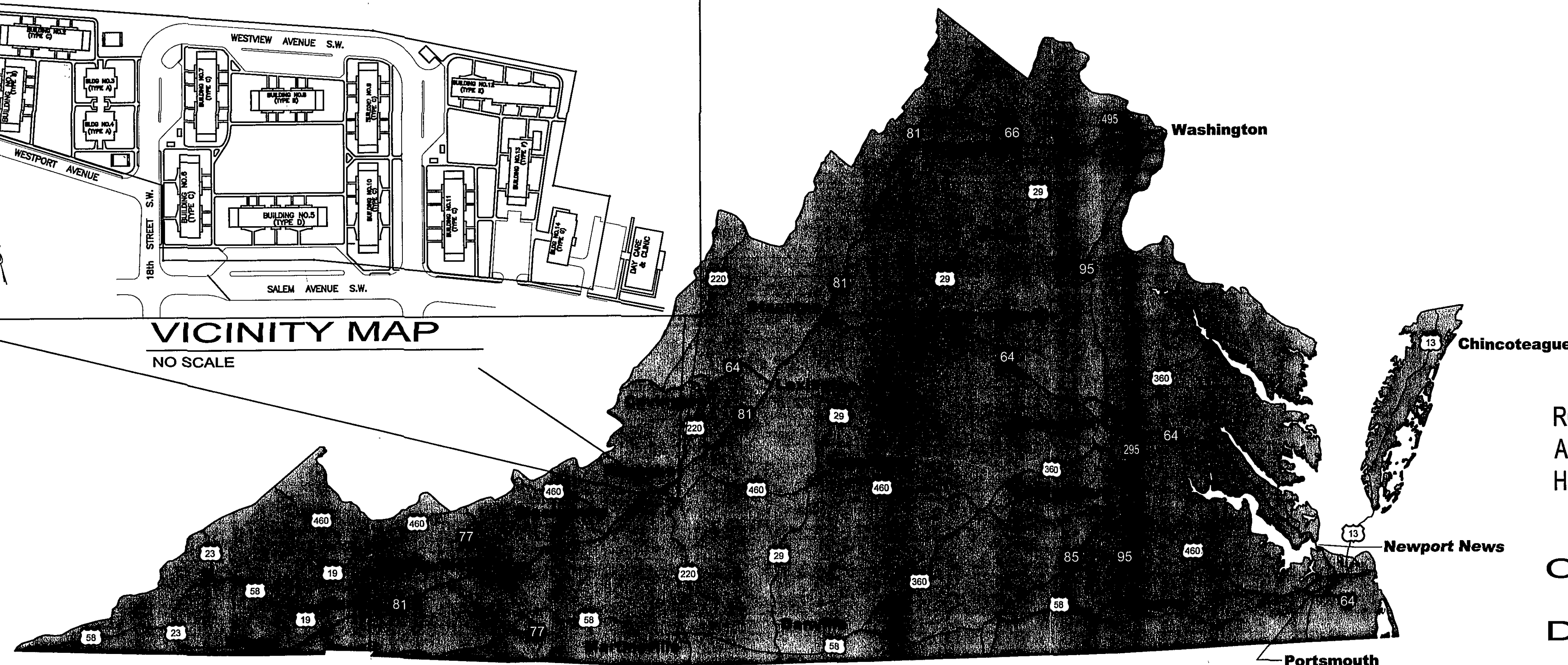

LOCATION MAP

NO SCALE

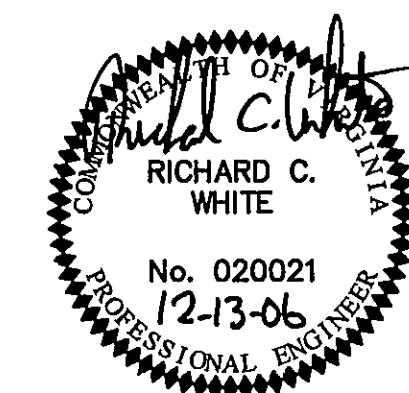

LMW P.C.

Engineering
Architecture
Surveying
Landscape Design

102 Albemarle Ave
Roanoke, Virginia 24013

www.lmwpc.com

ph: 540.345.0675
fax: 540.342.4456

lmweng@lmw.roacoxmail.com

ROANOKE REDEVELOPMENT AND HOUSING AUTHORITY
ASBESTOS & LEAD BASED PAINT ABATEMENT AND BUILDING DEMOLITION
HURT PARK, VA-11-3 PROJECT # 060901

COMM. NO. 3260A

DATE: 08/28/06

SET NO.

Received
WVWA - Engineering

JUN 14 2007

By

RECEIVED

DEC 14 2005

CITY OF ROANOKE
PLANNING BUILDING AND DEVELOPMENT

Part of the HURT PARK project - WVWA ID # 7-21-03H (only the plans are approved)