

# JOURNEY CHURCH READ MOUNTAIN ROAD UTILITY CONNECTION BOTETOURT COUNTY, VIRGINIA

LOCATION MAP

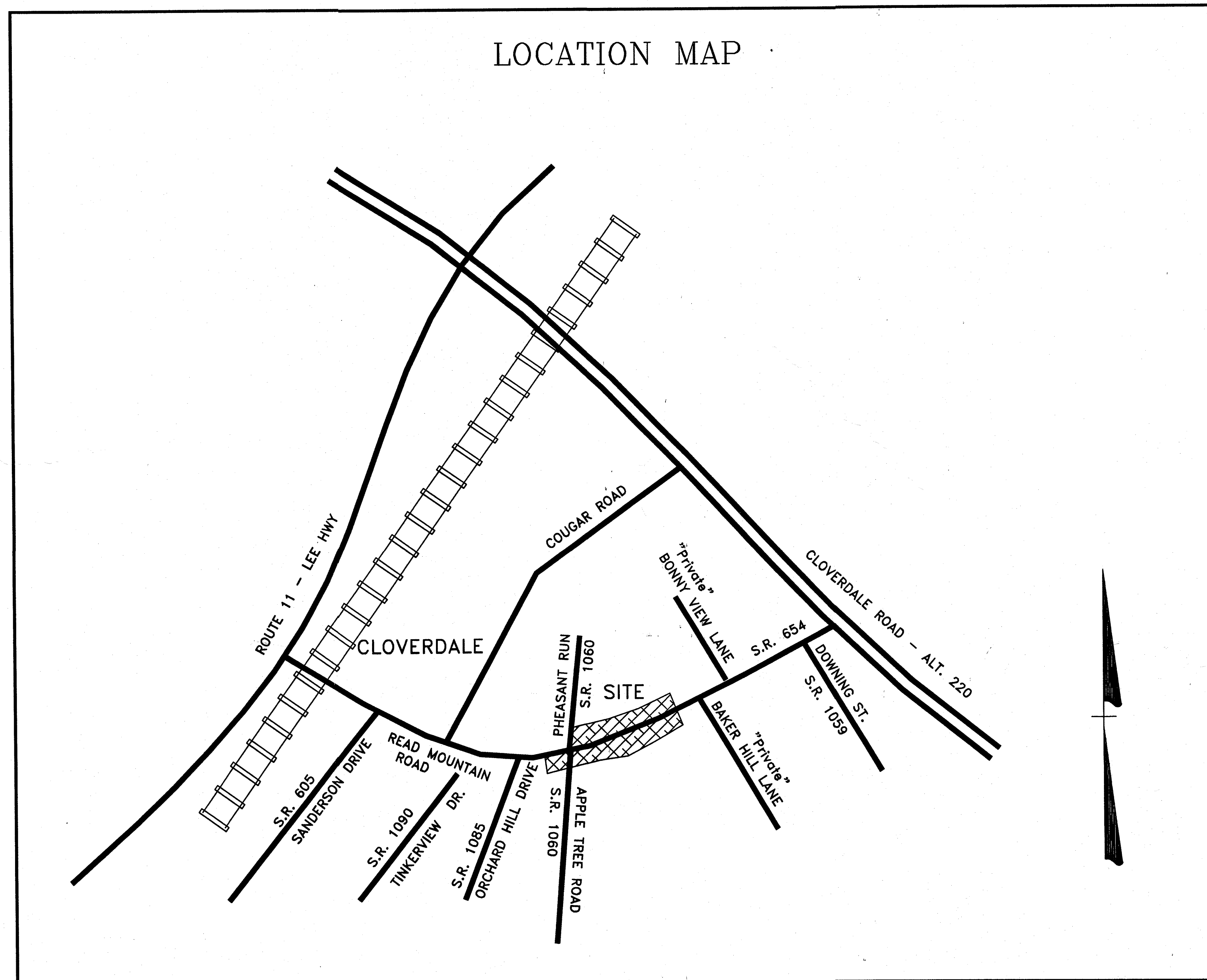

Construction Drawings  
March 14, 2016

DEVELOPER:  
JOURNEY CHURCH  
3574 READ MOUNTAIN ROAD  
ROANOKE, VA 24019

GENERAL CONTRACTOR:  
RL PRICE  
ATTN: JAY CECIL  
2166 SALEM INDUSTRIAL DRIVE  
SALEM, VIRGINIA 24153  
540.375.3200  
540.375.2113 FAX

ENGINEER:  
PIERSON ENGINEERING & SURVEYING  
RODERICK F. PIERSON, LLS, PE  
P.O. BOX 311  
DALEVILLE, VA 24083  
540.966.3027  
540.966.5906 fax

## SHEET INDEX

- C1. COVER SHEET
- C2. PLAN SHEET
- C3. PROFILE SHEET
- C4. E & S SHEET
- C5. E & S DETAIL SHEET
- C6. WATER DETAILS
- C7. SEWER DETAILS
- C8. VDOT TRAFFIC CONTROL SHEET
- C9. VDOT TRAFFIC CONTROL SHEET

## DATES:

NOVEMBER 15, 2012  
FEBRUARY 3, 2014  
JULY 15, 2014  
AUGUST 25, 2014

CHARLES C. BULLS  
As-BUILTS 02-01-19

