

<u>SYMBOL</u>	<u>DESCRIPTION</u>
---------------	--------------------

SPECIAL NOTES:

1. THE SITE ELECTRICAL CONTRACTOR SHALL VERIFY VOLTAGE DROP BASED ON ACTUAL FIELD MEASUREMENTS.

COORDINATE TELEPHONE SERVICE REQUIREMENTS AND ROUTING WITH TELEPHONE COMPANY'S FIELD REPRESENTATIVE. CONDUIT AND TELEPHONE CABINET SIZE SHALL BE AS DICTATED BY THE TELEPHONE COMPANY. THE SITE CONTRACTOR SHALL BE RESPONSIBLE FOR ALL TELEPHONE ENTRANCE CONDUITS.

UTILITY DISCLAIMER

UTILITIES MAY EXIST WHICH ARE NOT SHOWN ON THE PLANS. THE CONTRACTOR SHALL BE RESPONSIBLE FOR CONTACTING ALL UTILITY COMPANIES HAVING UTILITIES WITHIN OR ADJACENT TO THE WORK AREA. THE CONTRACTOR SHALL HAVE THE UTILITIES FIELD LOCATED AND COORDINATE WITH UTILITY COMPANIES TO HAVE THEM RELOCATED WHEN NECESSARY OR ADAPTED FOR TIE-INS.

GENERAL NOTES - SITE

1. REFER TO CIVIL PLANS FOR NAMES/ADDRESSES OF OWNER AND UTILITIES. REFER TO CIVIL PLANS FOR TYPES OF PAVING.
2. PROVIDE FUSE HOLDER IN HANDHOLE OF POLE. SECURE HANDHOLE COVER. FUSEHOLDER SHALL BE BUSSMAN "TRON" No. HEB-JK RYC WITH WEATHERPROOF BOOT AND 20 AMP "KTK" FUSE FOR EACH UNGROUNDED CONDUCTOR. SECURELY TAPE OVER COMPLETE HOLDER TO INSULATE FROM METAL PARTS.
3. PROVIDE #12 AWG INSULATED WIRING FROM FUSEHOLDER TO FIXTURE. PROVIDE #12 GROUND FROM POLE BASE GROUND LUG TO FIXTURE HOUSING AND GROUND METAL PARTS.
4. PERMANENT WEATHERPROOF LABELS SHALL IDENTIFY ALL ELECTRICAL EQUIPMENT FURNISHED BY THIS CONTRACTOR.
5. TRENCHING AND/OR DUCT WORK SHOWN TO BE BY THIS CONTRACTOR SHALL NOT EXTEND BEYOND PROPERTY LINES EXCEPT FOR UTILITY CONNECTIONS.
6. TRANSFORMER PADS SHALL BE IN ACCORDANCE WITH UTILITY COMPANY REQUIREMENTS AND SHALL BE LOCATED TO MEET UTILITY COMPANY CLEARANCES.
7. BALANCE LIGHTING LOADS ON CIRCUITS ACCORDING TO QUANTITIES AND FEEDER DISTANCES. ALTERNATE ON PHASES THROUGHOUT THE RUN FOR EACH BRANCH CIRCUIT.
8. ALL WIRE AND CABLE SHALL BE COPPER. UNDERGROUND CONDUIT FOR LIGHTING CIRCUITRY SHALL BE SCH.40 PVC AT 30" BELOW GRADE WITH EQUIPMENT GROUND CONDUCTOR EXCEPT AS SPECIFICALLY NOTED OTHERWISE. OVERSIZE WIRING WHERE INDICATED, IS UTILIZED FOR VOLTAGE DROP PURPOSES.
9. REFER TO BUILDING ELECTRICAL PLANS FOR SOURCE PANELS, CIRCUITS AND CONTROLS RELATING TO SITE LIGHTING AND PYLON POWER.
10. COORDINATE THE WORK SHOWN ON THIS PLAN WITH UTILITIES AND OTHER TRADES TO AVOID INTERFERENCES AND TO ASSURE A SUITABLE INSTALLATION. ADDITIONAL COST TO THE OWNER WILL NOT BE ALLOWED FOR FAILURE TO COORDINATE.
11. ALL OPEN CONDUIT ENDS SHALL BE SEALED UNTIL USED. PROVIDE PULL CORD IN EMPTY CONDUIT.
12. PROVIDE FLUSH WEATHERPROOF PVC PULL BOXES FOR TERMINATION OF SITE LIGHTING CIRCUITRY FIVE FEET FROM THE BUILDING AS NOTED AND AS REQUIRED. SITE LIGHTING CIRCUITRY SHALL NOT BE ROUTED WITHIN THE KROGER BUILDING FOOTPRINT. CONTINUATION OF SITE LIGHTING CIRCUITRY TO SOURCE PANELS SHALL BE BY THE KROGER BUILDING CONTRACTOR.

Luminaire Schedule										
Project: Kroger Store R-391										
Label	Qty	Symbol	Arrangement	Lumens	LDD	LLD	BF	LLF	Description	
HP1	1		SINGLE	99000	0.9	1	1	0.900	McGraw Edison GSM-AM-750HPS-480-3V-FG-BZ-LL/MA1008BZ/MA1061/RTS9A39SF-M1	
HP2	3		BACK-BACK	99000	0.9	1	1	0.900	McGraw Edison GSM-AM-750HPS-480-AS-FG-BZ-LL/MA1008BZ/RTS9A39SF-M2	
HP3	8		3 @ 120 DEGREE	99000	0.9	1	1	0.900	McGraw Edison GSM-AM-750HPS-480-AS-FG-BZ-LL/MA1007BZ/RTS9A39SF-M3	
HP4	0		TWIN	99000	0.9	1	1	0.900	McGraw Edison GSM-AM-750HPS-480-3V-FG-BZ-LL/MA1008BZ/MA1061/RTS9A39SF-M2	
FL	6		SINGLE	79000	0.9	1	1	0.900	Lumark MHNK-S-76-1000-480-BZ	

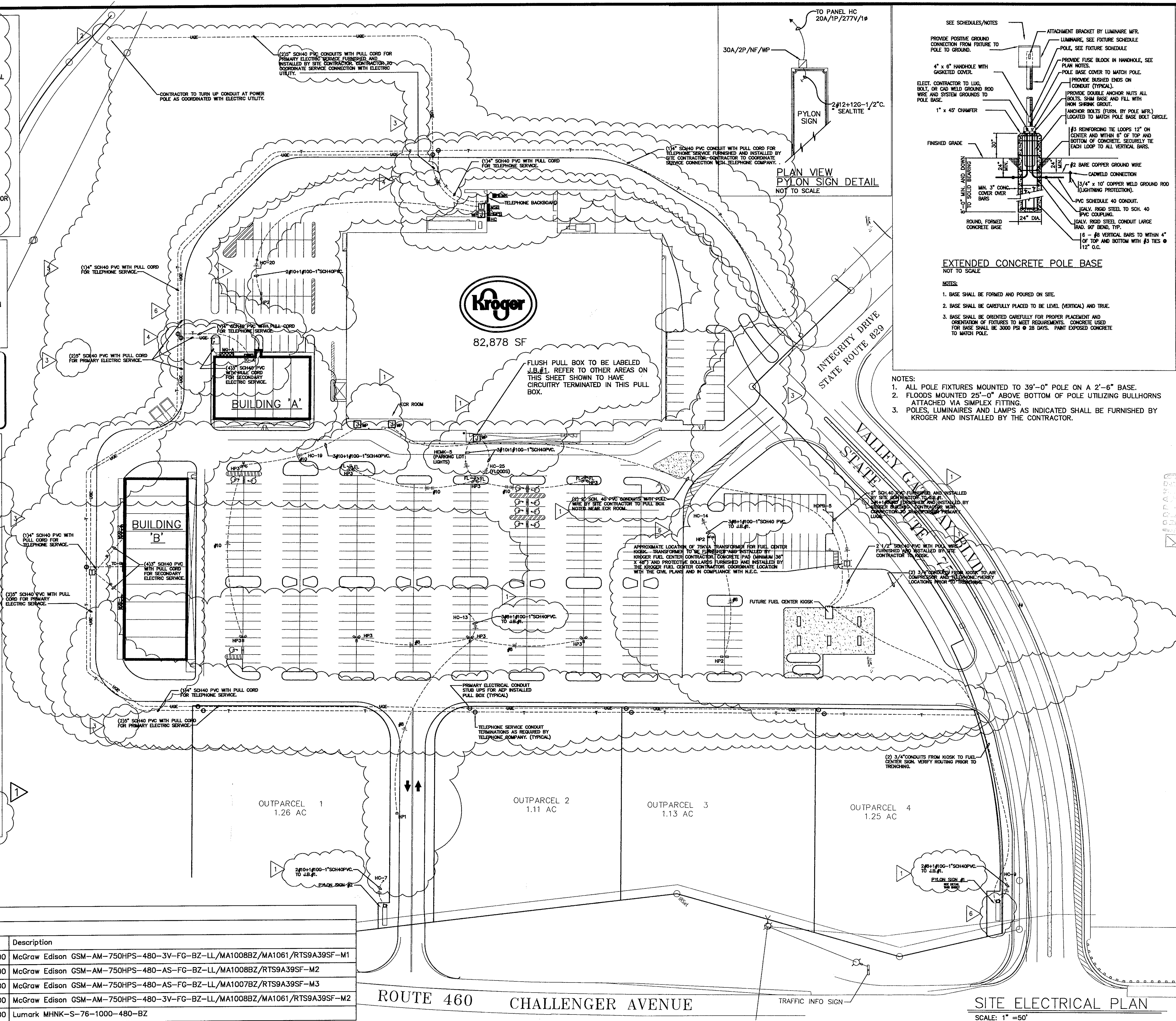

EXTENDED CONCRETE POLE BASE
NOT TO SCALE

- NOTES:**
1. BASE SHALL BE FORMED AND POURED ON SITE.
 2. BASE SHALL BE CAREFULLY PLACED TO BE LEVEL (VERTICAL) AND TRUE.
 3. BASE SHALL BE ORIENTED CAREFULLY FOR PROPER PLACEMENT AND ORIENTATION OF FIXTURES TO MEET REQUIREMENTS. CONCRETE USED FOR BASE SHALL BE 3000 PSI @ 28 DAYS. PAINT EXPOSED CONCRETE TO MATCH POLE.

NOTES:

1. ALL POLE FIXTURES MOUNTED TO 39'-0" POLE ON A 2'-6" BASE.
2. FLOODS MOUNTED 25'-0" ABOVE BOTTOM OF POLE UTILIZING BULLHORNS ATTACHED VIA SIMPLEX FITTING.
3. POLES, LUMINAIRES AND LAMPS AS INDICATED SHALL BE FURNISHED BY KROGER AND INSTALLED BY THE CONTRACTOR.

Robertson Loia Roof
ARCHITECTS & ENGINEERS

KROGER R-391
CHALLENGER AVE.
ROANOKE, VA
FOR:
THE KROGER COMPANY
3631 PETERS CREEK RD.
ROANOKE VA 24019

REVISION

- | | |
|---|---|
| 1 | 02-21-07
BID CLARIFICATIONS
ADDED. |
| 2 | 3-28-07
ADDED SHOPS & OUT
PARCEL REQUIREMENTS |
| 3 | 04-06-07
REVISED LIGHT POLE
LAYOUT & PRI. POWER |
| 4 | 05-18-07
REVISED LIGHT POLE
LAYOUT & PRI. POWER |
| 5 | 06-20-07
REVISED TRANSF. LOCATIONS |
| 6 | 07-10-07
REVISE KROGER DOCK
AND RING A. |

SHEET TITLE
ELECTRICAL
SITE PLAN

DATE 02-09-07

PROJECT NUMBER
07-140

SHEET NUMBER

12 OF 22