

GRADING LEGEND	
---	EXISTING CONTOURS
---	PROPOSED CONTOURS
X 21.25	EXISTING SPOT GRADE
X 21.25	PROPOSED SPOT GRADE
X TC	PROPOSED TOP OF CURB
X BC	PROPOSED BOTTOM OF CURB
X SWK	PROPOSED EDGE OF SIDEWALK
X PAD	PROPOSED BOTTOM OF SWALE
X HP	PROPOSED EDGE OF CONC. PAD
X HP	PROPOSED HIGH POINT OF SWALE

STORM SEWER SCHEDULE

NOTES:

- PIPES ARE MEASURED FROM CENTER TO CENTER OF STRUCTURES.
- ALL STRUCTURES OVER 4' DEEP REQUIRE VDOT STD. ST-1 STEPS.
- ALL STRUCTURES SHALL HAVE IS-1 INLET SHAPING.
- INLET SHAPING IS NOT REQUIRED WHERE YARD INLET/BASINS ARE USED.
- ALL STRUCTURES GREATER THAN 3' IN DEPTH SHALL BE A MINIMUM OF 4' IN DIAMETER.

- | | |
|-----|---|
| 1 | 15" Basin with Standard Grate
TOP = 1124.85, H = 1.85' |
| 2 | 52.86 L.F. 10" HDPE Pipe @ 1.00%
INV. IN = 1123, INV. OUT = 1122.47 |
| 3 | MH-1, TOP = 1127.4, H = 5.4' |
| 4 | 48.76 L.F. 15" HDPE Pipe @ 0.50%
INV. IN = 1122, INV. OUT = 1121.76 |
| 5 | DI-1, TOP = 1124.88, H = 3.22' |
| 6 | 87.16 L.F. 15" HDPE Pipe @ 0.50%
INV. IN = 1121.66, INV. OUT = 1121.22 |
| 7 | DI-1, TOP = 1124.50, H = 3.34' |
| 8 | 137.75 L.F. 15" HDPE Pipe @ 6.03%
INV. IN = 1121.12, INV. OUT = 1112.82 |
| 9 | DI-1, TOP = 1118.10, H = 5.38' |
| 9B | 17.08 L.F. 15" HDPE Pipe @ 1.00%
INV. IN = 1112.72, INV. OUT = 1112.55 |
| 10 | DI-3A, TOP = 1121, H = 4' |
| 11 | 38.67 L.F. 15" HDPE Pipe @ 0.50%
INV. IN = 1117, INV. OUT = 1116.81 |
| 12 | MH-1, TOP = 1119.60, H = 9.49'
(REMOVE EXISTING GRATE TOP
AND INSTALL MANHOLE TOP, USE
FLAT TOP IF NEEDED) |
| RC1 | 34.93 L.F. 10" PVC Pipe @ 1.00% (MIN.)
INV. IN = 1121.95, INV. OUT = 1121.60 |
| RC2 | MH-1, TOP = 1125.66, H = 4.16' |
| RC3 | 85.21 L.F. 8" PVC Pipe @ 1.00% (MIN.)
INV. IN = 1122.45, INV. OUT = 1121.60 |
| RC4 | 15" Basin with Solid Top
TOP = 1125.40, H = 2.95' |
| RC5 | 52.83 L.F. 6" PVC Pipe @ 1.00% (MIN.)
INV. IN = 1123.08, INV. OUT = 1122.55 |

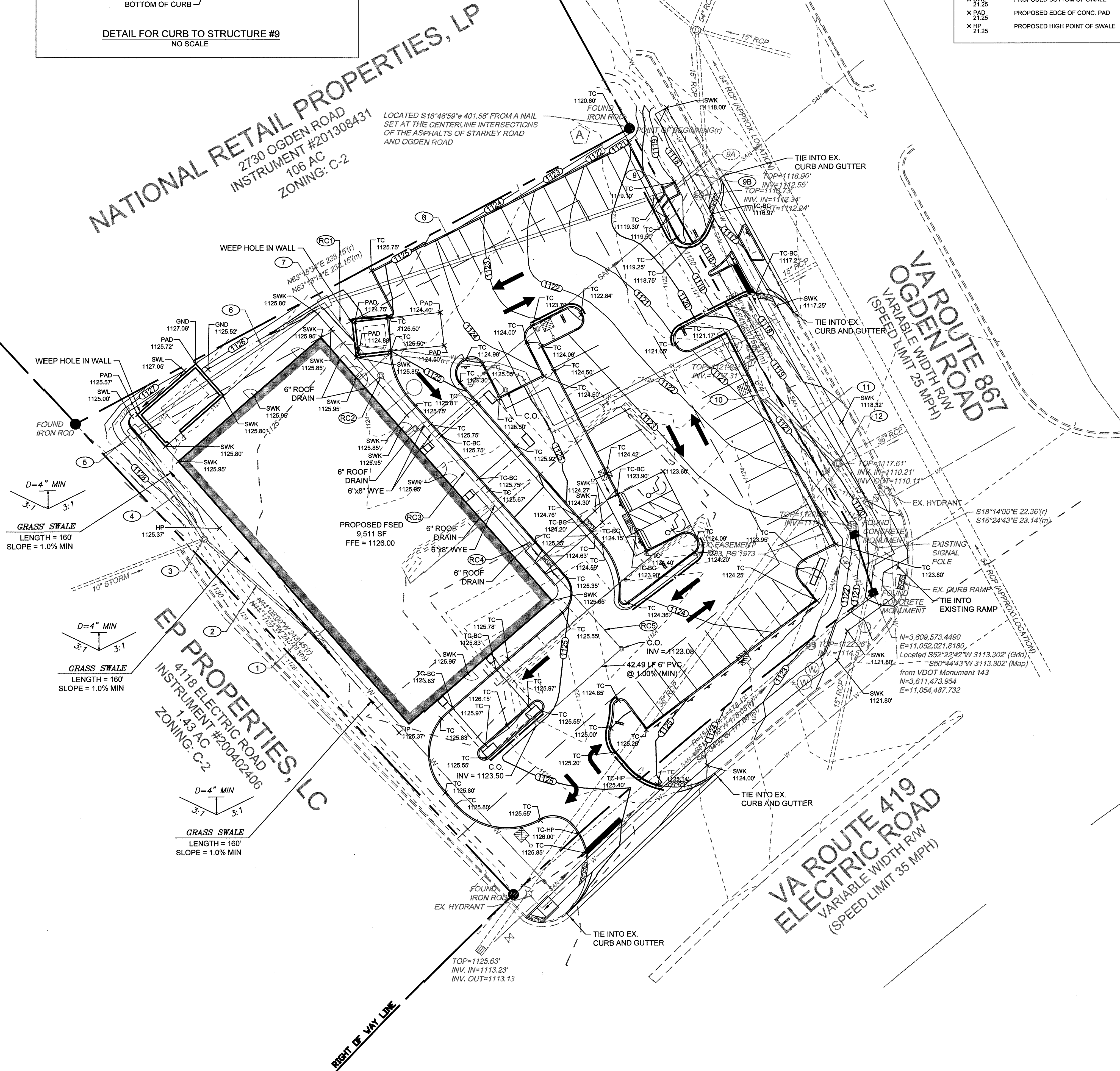

SCALE 1"=20'

APPROVED

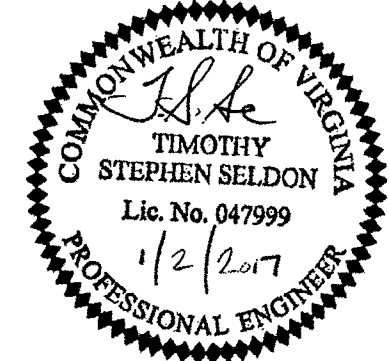

THIS DRAWING PREPARED AT THE
TIMMONS GROUP OFFICE
4701 Owens Way, Suite 900 | Prince George, VA 23875
TEL 804-458-8685 FAX 804-458-1511 www.timmons.com

YOUR VISION ACHIEVED THROUGH OURS.

DATE
9/28/2016
11/11/2016
1/2/2017

REVISION DESCRIPTION
REVISED PER COUNTY AND VDOT COMMENTS
REVISED PER COUNTY AND VDOT COMMENTS
SIGNATURE SETS

DATE
8-23-2016

DRAWN BY
T. SELDON

DESIGNED BY
T. SELDON

CHECKED BY
T. SELDON

SCALE
1" = 20'

TIMMONS GROUP

LEWISGALE EMERGENCY CENTER
CAVE SPRING DISTRICT - ROANOKE COUNTY - VIRGINIA
GRADING AND DRAINAGE PLAN

JOB NO.
38321
SHEET NO.
C5.0