

PHASE II SEQUENCE OF CONSTRUCTION

- BEGIN ON-SITE GRADING OPERATIONS AND INSTALL STORM SEWER SYSTEM. AS GRADING OPERATIONS BEGIN EROSION CONTROL MEASURES IN PHASE I EROSION CONTROL WILL NEED TO BE MAINTAINED.
- GRADE DRIVE AISLES AND PARKING STALLS TO SUBGRADE ELEVATIONS AND INSTALL CONSTRUCTION ROAD STABILIZATION. CONSTRUCTION ROAD STABILIZATION STONE SHALL BE TOP-DRESSED AND REGRADED AS NEEDED BEFORE INSTALLING ASPHALT PAVEMENT LAYERS.
- CONTINUE GRADING OPERATIONS, BUILDING CONSTRUCTION, AND STORM SEWER INSTALLATION. INSTALL INLET PROTECTION ON ALL INLETS AS SHOWN ON PLANS. ALL DISTURBED AREAS MUST DRAIN TO APPROVED SEDIMENT CONTROL MEASURES AT ALL TIMES DURING LAND DISTURBING ACTIVITIES AND DURING SITE DEVELOPMENT UNTIL FINAL STABILIZATION IS ACHIEVED.
- BEGIN UTILITY AND CURB AND GUTTER INSTALLATION, PAVEMENT OPERATIONS AND REMAINING CONSTRUCTION ACTIVITIES.
- ALL AREAS THAT ARE TO BE LEFT UNDISTURBED FOR LONGER THAN 14 DAYS SHALL BE TEMPORARILY SEEDED WITHIN 7 DAYS PER SPECIFICATION 3.31 OF THE VESCH.
- PERMANENTLY SEED ALL AREAS TO REMAIN DENUDE FOR MORE THAN ONE YEAR.
- STABILIZE SITE WITH PERMANENT SEEDING, SOODING, AND LANDSCAPING AS SHOWN ON THE LANDSCAPE PLANS.
- MAINTAIN POSITIVE DRAINAGE TO EROSION CONTROL DEVICES AT ALL TIMES AND ADJUST MEASURES IF NECESSARY TO INTERCEPT SEDIMENT AND PREVENT EROSION. THE CONTRACTOR SHALL INSPECT ALL EROSION CONTROL MEASURES PERIODICALLY AND AFTER EACH RUNOFF PRODUCING RAINFALL EVENT. ANY NECESSARY REPAIRS OR CLEANUP TO MAINTAIN THE EFFECTIVENESS OF THE EROSION CONTROL DEVICES SHALL BE MADE IMMEDIATELY.
- THE CONTRACTOR IS RESPONSIBLE FOR THE INSTALLATION OF ANY ADDITIONAL EROSION CONTROL MEASURES NECESSARY TO PREVENT EROSION AND SEDIMENTATION AS DETERMINED BY THE ENVIRONMENTAL ENGINEERING DEPARTMENT.
- A MONTHLY EROSION AND SEDIMENT CONTROL REPORT FROM THE CRLD MUST BE SUBMITTED TO ENVIRONMENTAL ENGINEERING BY THE FIRST OF EACH MONTH.
- ADEQUATE DUST CONTROL MEASURES ARE TO BE APPLIED TO ALL EXPOSED SOIL SURFACES DURING CONSTRUCTION OPERATIONS TO REDUCE THE MIGRATION OF AIRBORNE SUBSTANCES RESULTING FROM CONSTRUCTION OPERATIONS. DUST CONTROL MEASURES ARE TO CONFORM TO VESCH STD AND SPEC 3.39. REFER TO DETAIL ON SHEET C1.5.

NATIONAL RETAIL PROPERTIES, LP
2730 OGDEN ROAD
INSTRUMENT #201308431
106 AC
ZONING: C-2

LOCATED S18°46'59"E 401.56' FROM A NAIL
SET AT THE CENTERLINE INTERSECTIONS
OF THE ASPHALTS OF STARKEY ROAD
AND OGDEN ROAD

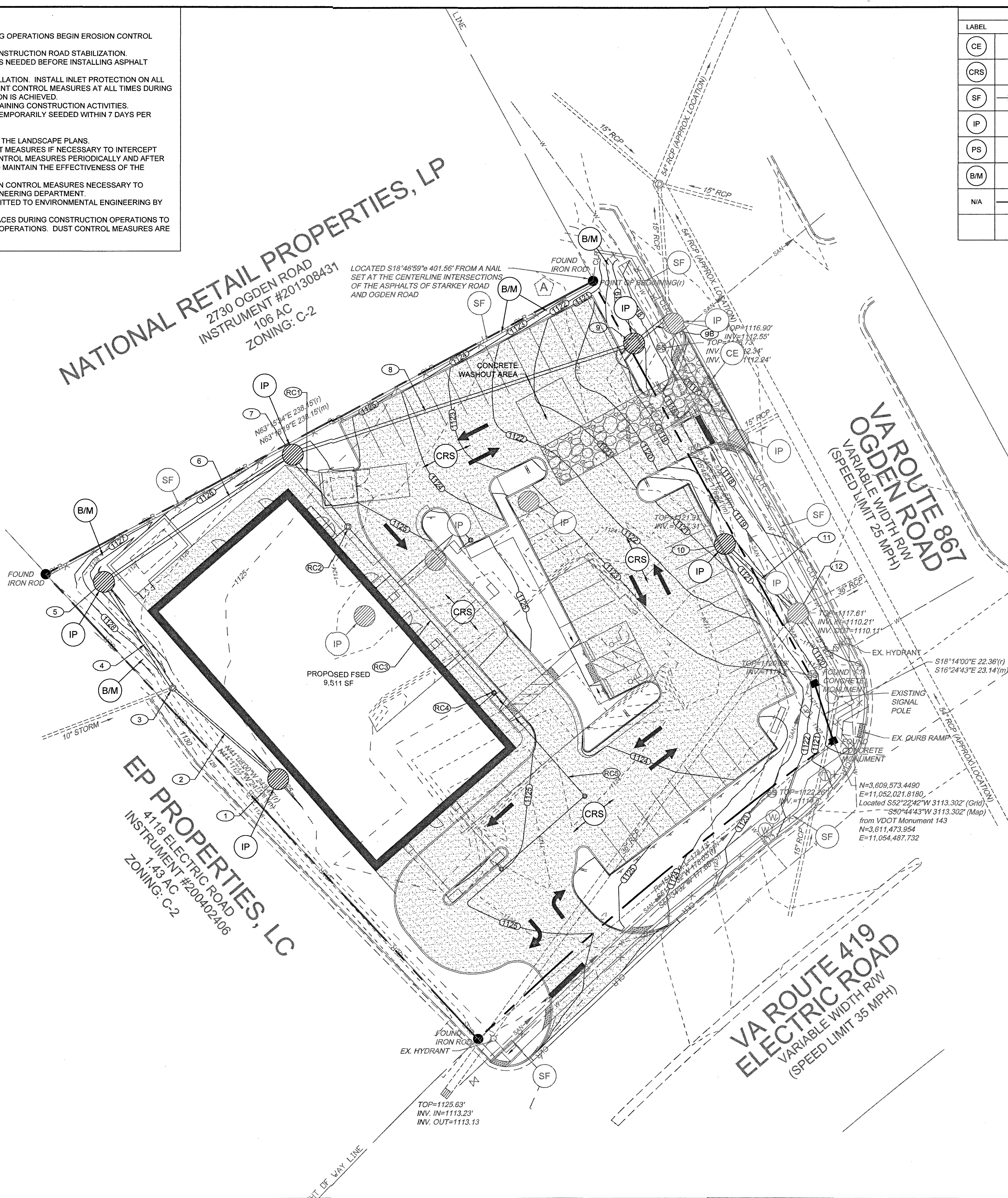

EROSION CONTROL LEGEND

LABEL	SYMBOL	STD. NAME	SPEC.#
CE		CONSTRUCTION ENTRANCE	3.02
CRS		CONSTRUCTION ROAD STABILIZATION	3.03
SF		SILT FENCE	3.05
IP		INLET PROTECTION	3.08
PS		PERMANENT SEEDING	3.32
B/M		TEMPORARY SOIL STABILIZATION BLANKETS AND MATTING	3.36
N/A		LIMITS OF DISTURBANCE	N/A
		CONCRETE WASHOUT AREA	

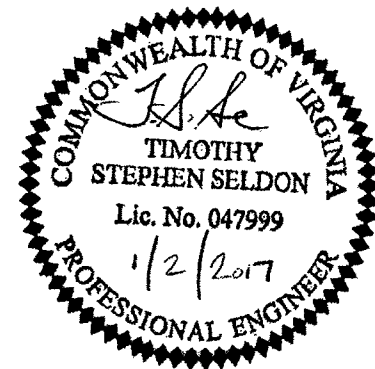

THIS DRAWING PREPARED AT THE
TRI-CITIES OFFICE
4701 Owens Way, Suite 900 | Prince George, VA 23875
TEL 804-458-8685 FAX 804-458-1511 www.timmons.com

YOUR VISION ACHIEVED THROUGH OURS.

DATE	REVISION DESCRIPTION
9/28/2016	REVISED PER COUNTY AND VDOT COMMENTS
11/17/2016	REVISED PER COUNTY AND VDOT COMMENTS
1/2/2017	SIGNATURE SETS

8-23-2016
DRAWN BY
T. SELDON
DESIGNED BY
T. SELDON
CHECKED BY
T. SELDON
SCALE
1" = 20'

LEWISGALE EMERGENCY CENTER
CAVE SPRING DISTRICT - ROANOKE COUNTY - VIRGINIA
PHASE II E&S CONTROL PLAN

JOB NO.
38321
SHEET NO.
C7.0

SCALE 1"=20'

APPROVED