

J:\WORKBOOK\ROAD\04 LITTLE CAESARS - ORANGE AVENUE CONCEPTS\CA\04180041.DWG: 00 BASE.dwg PLOTTED: 01/10/2021 1:32:29 PM

#### E&SC MEASURES

3.02	TEMPORARY STONE CONSTRUCTION ENTRANCE	CE
3.05	SILT FENCE	SF
3.07	STORM DRAIN INLET PROTECTION	IP
3.31	TEMPORARY SEEDING	TS
3.32	PERMANENT SEEDING	PS
3.35	MULCHING	MU
3.36	SOIL STABILIZATION BLANKETS & MATTING	B/M

#### E.S.C. CONSTRUCTION SEQUENCE:

1. THE CONSTRUCTION ENTRANCE SHALL BE INSTALLED AS A FIRST STEP OF CONSTRUCTION. THE CONSTRUCTION ENTRANCE SHALL BE MAINTAINED THROUGHOUT THE DURATION OF THE PROJECT. G.C. SHALL PAY SPECIAL ATTENTION TO ENSURE SEDIMENT LADEN RUNOFF IS NOT DIRECTED TOWARDS THE ADJACENT PUBLIC RIGHT OF WAY AND THERE SHALL BE NO MUD 'TRACKING' FROM THE SITE INTO THE PUBLIC RIGHT OF WAY.
2. SILT FENCE TO BE INSTALLED AS SHOWN PRIOR TO ANY LAND DISTURBANCE. THE SILT FENCE SHALL BE MAINTAINED THROUGHOUT THE DURATION OF THE PROJECT AND SHALL BE CHECKED AFTER EACH MEASURABLE RAIN EVENT AS REQUIRED BY THE EROSION AND SEDIMENT CONTROL HANDBOOK.  
  
THE R.L.D. ASSIGNED TO THE PROJECT SHALL ENSURE ALL REGULATIONS ARE FOLLOWED AND DOCUMENTED THROUGHOUT THE ENTIRE PROJECT TO PREVENT THE EXCESSIVE BUILD-UP OF SEDIMENT. ALL BUILT UP SEDIMENT SHALL BE REMOVED AND PROPERLY DISPOSED OFF.
3. DEMOLITION OPERATIONS SHALL OCCUR AT THIS TIME FOR THE EXISTING PAVEMENT AND OTHER FEATURES THAT ARE TO BE REMOVED.
4. MAJOR GRADING OPERATIONS SHALL COMMENCE ONCE THE SILT FENCE HAS BEEN INSTALLED. TOPSOIL IS TO BE STOCKPILED AND SILT FENCE SHALL BE INSTALLED ON THE LOW SIDE OF THE STOCKPILE.
5. PROPOSED STORM SEWER SHALL BE INSTALLED AT THIS TIME WITH INLET PROTECTION AS EACH INLET BECOMES FUNCTIONAL.
6. ALL PROPOSED INLETS SHALL BE PROTECTED FROM SEDIMENT AS SOON AS INSTALLATION OF EACH STRUCTURE IS COMPLETE TO ENSURE SEDIMENT IS NOT TRANSPORTED THROUGH THE CONNECTED PIPE SYSTEMS.

7. ALL OTHER UTILITIES FOR THE SITE SHALL BE INSTALLED AT THIS TIME AND AREAS TEMPORARILY OR PERMANENTLY SEEDER AFTER COMPLETION OF INSTALLATION.
8. CURBING IS TO BE INSTALLED AT THIS TIME. THE CONCRETE WASHOUT SHALL BE UTILIZED IN ACCORDANCE WITH D.E.Q. REGULATIONS.
9. PAVEMENT, SIDEWALK, LANDSCAPING ETC. SHALL BE INSTALLED AT THIS TIME.
10. CONSTRUCTION ENTRANCE TO BE REMOVED UPON COMPLETION OF PAVING OPERATIONS.
11. PERMANENT SEEDING AND MULCHING SHALL BE APPLIED AT THIS TIME TO ALL AREAS AT FINAL GRADE.
12. CONTRACTOR SHALL CONTACT CITY OF ROANOKE FOR A FINAL SITE INSPECTION AT THIS TIME.
13. AFTER CITY OF ROANOKE APPROVAL, SILT FENCE AND INLET PROTECTION CAN BE REMOVED.
14. G.C. SHALL ENSURE THAT THE LIMITS OF DISTURBANCE ARE STRICTLY ADHERED TO DURING THE PROJECT.
15. NO DEVIATIONS TO THE PLANS SHALL TAKE PLACE UNLESS PRIOR APPROVAL FROM THE OWNER, PROJECT ENGINEER, AND THE APPROPRIATE REVIEW AGENCIES.

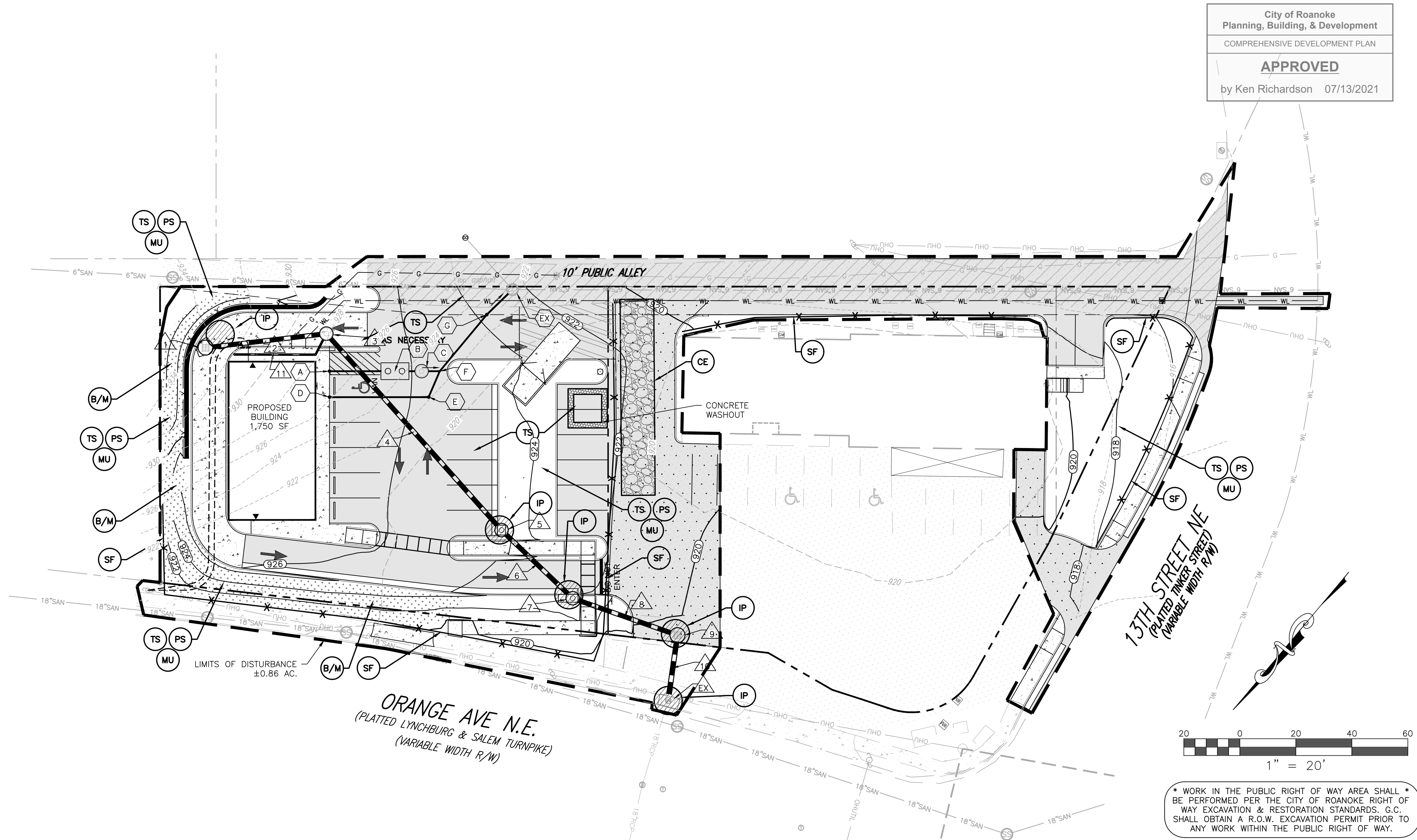

**BALZER  
& ASSOCIATES**  
PLANNERS / ARCHITECTS  
ENGINEERS / SURVEYORS

Roanoke / Richmond  
New River Valley / Staunton  
Harrisonburg / Lynchburg  
[www.balzer.cc](http://www.balzer.cc)

1208 Corporate Circle  
Roanoke, VA 24018  
540.772.9580

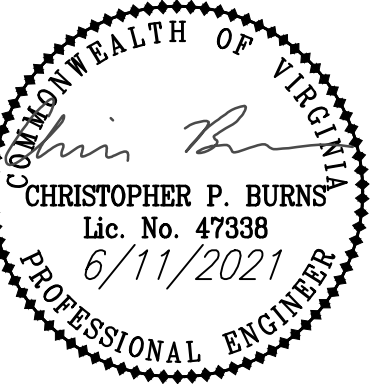

LITTLE CAESARS ORANGE AVENUE

E.S.C. PLAN

DRAWN BY KAM  
DESIGNED BY BTC  
CHECKED BY BTC  
DATE 6/11/2021  
SCALE 1"=20'  
REVISIONS

**C6**  
PROJECT NO. 04180041.00