

- ▲ STD. D1-38, L=10'  
TOP=1018.94  
INV. OUT=1014.30
- ▲ 54'-15" STORM DRAIN REQD.
- ▲ STD. D1-38, L=6'  
TOP=1018.48  
INV. IN=1013.84  
INV. OUT=1013.74
- ▲ 262'-15" STORM DRAIN REQD.
- ▲ STD. D1-38, L=6'  
TOP=1018.10  
INV. IN=1010.46  
INV. OUT=1010.36
- ▲ 15' -15" STORM DRAIN REQD.
- ▲ STD. MH-2  
TOP=1014.23  
INV. IN (36")=1007.90  
INV. IN (15")=1009.65  
INV. OUT (36")=1007.80
- ▲ 50'-15" STORM DRAIN REQD.
- ▲ STD. D1-30, L=8'  
TOP=1015.52  
INV. IN=1010.95  
INV. OUT=1010.88
- ▲ 92'-36" STORM DRAIN REQD.  
INV. IN (MH-2)=1009.0  
INV. OUT=1007.90
- ▲ 38'-36" STORM DRAIN REQD.  
INV. IN (MH-2)=1007.80  
INV. OUT=1007.34
- ▲ 12 90'-DBL. 48" PIPE REQD.  
INV. IN=997.12  
INV. OUT=996.67
- ▲ 13 85'-54" PIPE REQD.  
INV. IN=998.25  
INV. OUT=997.60
- ▲ 14 45'-15" PIPE REQD.  
INV. OUT=1007.46
- ▲ 15 STD. D1-1 TOP=1011.00 INV. OUT=1008.36
- ▲ 16 12'-18" C.M. PIPE EXT'N. REQ'D 1-STD. EW-1 REQ'D.
- ▲ 17 135'-18" CONC. PIPE REQ'D STD. ES-1 FLARED END SECTION REQD. LT. & RT. INV. IN=1010.95 INV. OUT=1010.00

SEE SHEET 5 OF 7 FOR PROFILE OF STORM DRAIN.

**BENCH MARK:**  
BRONZE METAL DISC LOCATED ON CONCRETE HEADWALL.  
ELEV. = 1000.30 (U.S.G.S. DATUM)

VERIDICAL OF MAP MADE FOR SALEM FARM, INC. & BILLY H. LUMSDEN BY BRADFORD L. S. DATED JUNE 3, 1977.

**NOTES:**

1. FOR SOIL EROSION CONTROL SYMBOLS SHOWN ON THIS PLAN, REFER TO THE VIRGINIA UNIFORM CODING SYSTEM CONTAINED IN THE VIRGINIA SOIL EROSION & SEDIMENT CONTROL HANDBOOK, SECOND EDITION, DATED 1981. SEE SHEET 7 OF 7 FOR DETAILS AND GENERAL NOTES FOR EROSION CONTROL.
2. DUCTILE IRON PIPE FOR 12" DIAMETER WATER LINE ONLY. WILL BE PROVIDED BY THE CITY OF ROANOKE. INSTALLATION BY SITE CONTRACTOR. CONTRACTOR SHALL GIVE THE CITY OF ROANOKE TWO (2) WEEKS NOTICE FOR DELIVERY OF PIPE.
3. SEE DIMENSIONAL LAYOUT PLAN, SHEET 3 OF 7, FOR PROPERTY LINE DATA AND CONSTRUCTION BASELINE DATA.

12" GATE VALVE & 12" X 12" X 6" TEE TO BE PROVIDED BY THE CITY OF ROANOKE. INSTALLATION BY SITE CONTRACTOR. CONTRACTOR TO PROVIDE AND INSTALL VALVE VAULT FOR 12" GATE VALVE AND 8" GATE VALVE.

6"-8" S.S. STUBOUT @ 1.30% FOR FUTURE CONNECTION. PLUG.

**SANITARY SEWER SUMMARY**

M.H. No.	TOP	INVERT ELEVATIONS	CONNECTING SEWER	GRADE
STUB		IN	OUT	
1	1003.5	991.87	991.87	0.65%
2	1006.5	994.67	994.57	0.65%
3	1013.3	1002.09	1001.99	3.00%
4	1015.00	1005.74	1005.47	1.38%
5	1017.55	1008.02	1007.92	1.10%
6	1018.88	1010.47	1010.35	2.16%
7	1018.24	1011.65	1011.55	0.50%
8	1017.82		1012.75	0.50%

SEE SHEET 5 OF 7 FOR PROFILE OF SANITARY SEWER.

**APPROVED:**

*Richard B. Bunn* DATE: 11 Feb 82  
CITY ENGINEER, ROANOKE, VIRGINIA

*Carl B. Reynolds Jr.* DATE: 11 Feb 82  
AGENT FOR CITY OF ROANOKE PLANNING COMMISSION

DENOTES RIP-RAP STONE (SEE SECTION 6 OF SPECS)

NOTE: PROPERTY LINES ON THE NW AND SW SIDES OF SHOPPING CENTER HAVE BEEN REVISED TO RUN GENERALLY ALONG CENTERLINE OF DRAINAGE CHANNEL. SEE MAP OF STATESMAN PLAZA, M.B.1, PG.308, FOR REVISED METES AND BOUNDS.

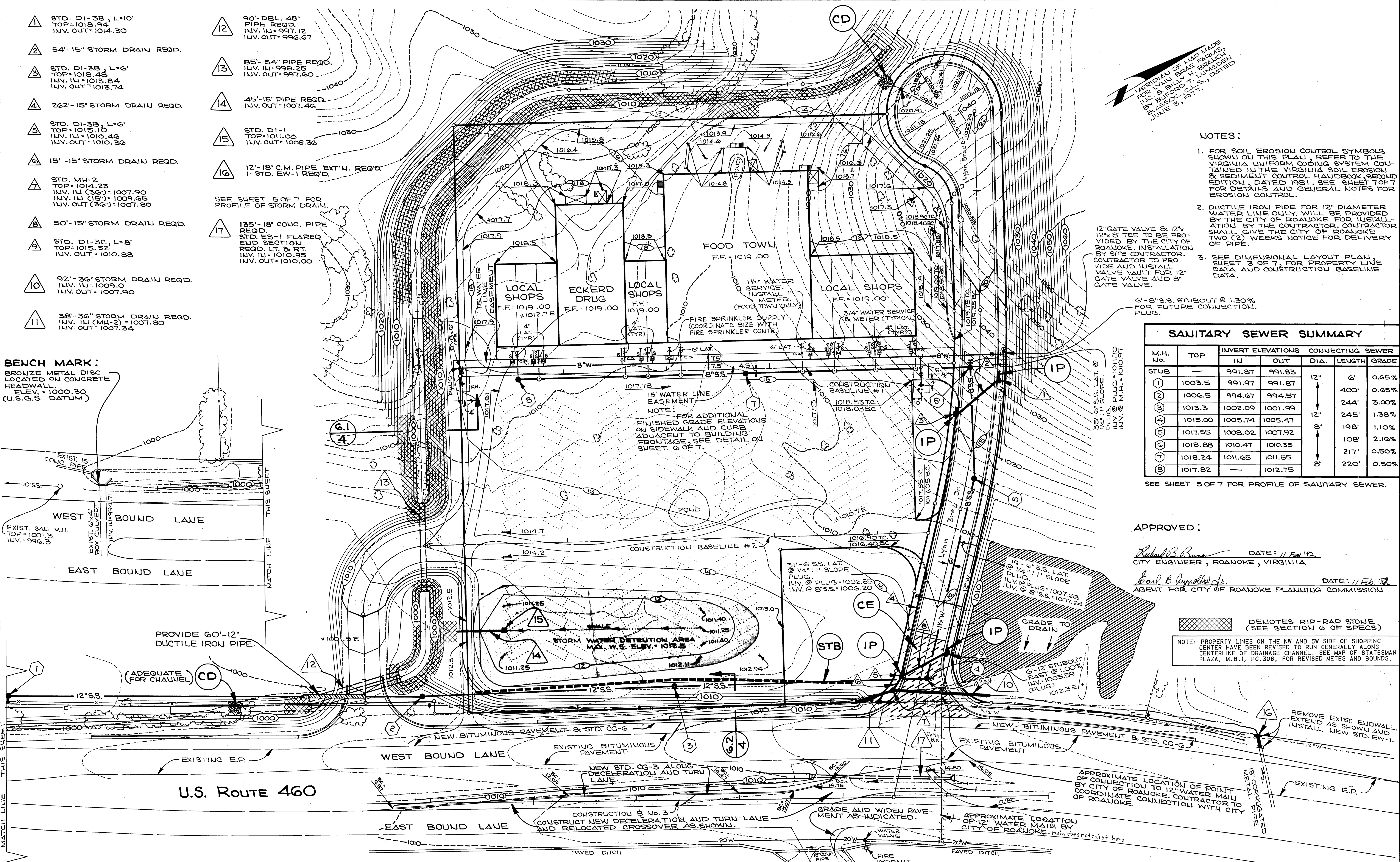

DATE	REVISIONS	BY
10-8-81	ROAD GRADE, SITE GRADING, BUILDING ELEV. & SAN. SEWER & WATER LINES	ELJ
12-17-81	CROSSOVER & TURN LANE	ELJ
1-27-82	SANITARY SEWER, GRADING AT BACK FRO TOWN STORM DRAIN AT MARKET SQUARE DRIVE	ELJ

DATE	REVISIONS	BY
3-15-82	FIRE SPRINKLER NOTE REVISED (FOODTOWN) WATER DEPT. PLAN NO. ADDED	ELJ

**T. P. PARKER & SON**  
engineers & surveyors, ltd.  
TELEPHONE (703) 387-1153  
P.O. BOX 367, SALEM, VIRGINIA 24153

**MARKET SQUARE EAST**  
DEVELOPED BY  
**AREA CORPORATION**  
CITY OF ROANOKE, VIRGINIA

**GRADING, UTILITIES AND SOIL EROSION & SEDIMENT CONTROL PLAN**  
DATE: SEPTEMBER 18, 1981  
SCALE: 1"=40'  
SHEET 4 OF 8  
Water As-Built 06/29/1982 WATER DEPT. PLAN NO. 8201