

*EXISTING IMPERVIOUS CALCULATIONS:		
BUILDING:	0.069 ac.	10.0 %
PAVEMENT:	0.609 ac.	88.4 %
OPEN SPACE:	0.011 ac.	1.6 %
TOTAL:	0.689 ac.	100%
TOTAL IMPERVIOUS:	0.678 ac.	- 98.4%

*PROPOSED IMPERVIOUS CALCULATIONS:		
BUILDING:	0.094 ac.	13.6 %
PAVEMENT:	0.473 ac.	68.7 %
OPEN SPACE:	0.122 ac.	17.7 %
TOTAL:	0.689 ac.	100%
TOTAL IMPERVIOUS:	0.567 ac.	- 82.3%

VICINITY MAP
(SCALE 1 : 2000)

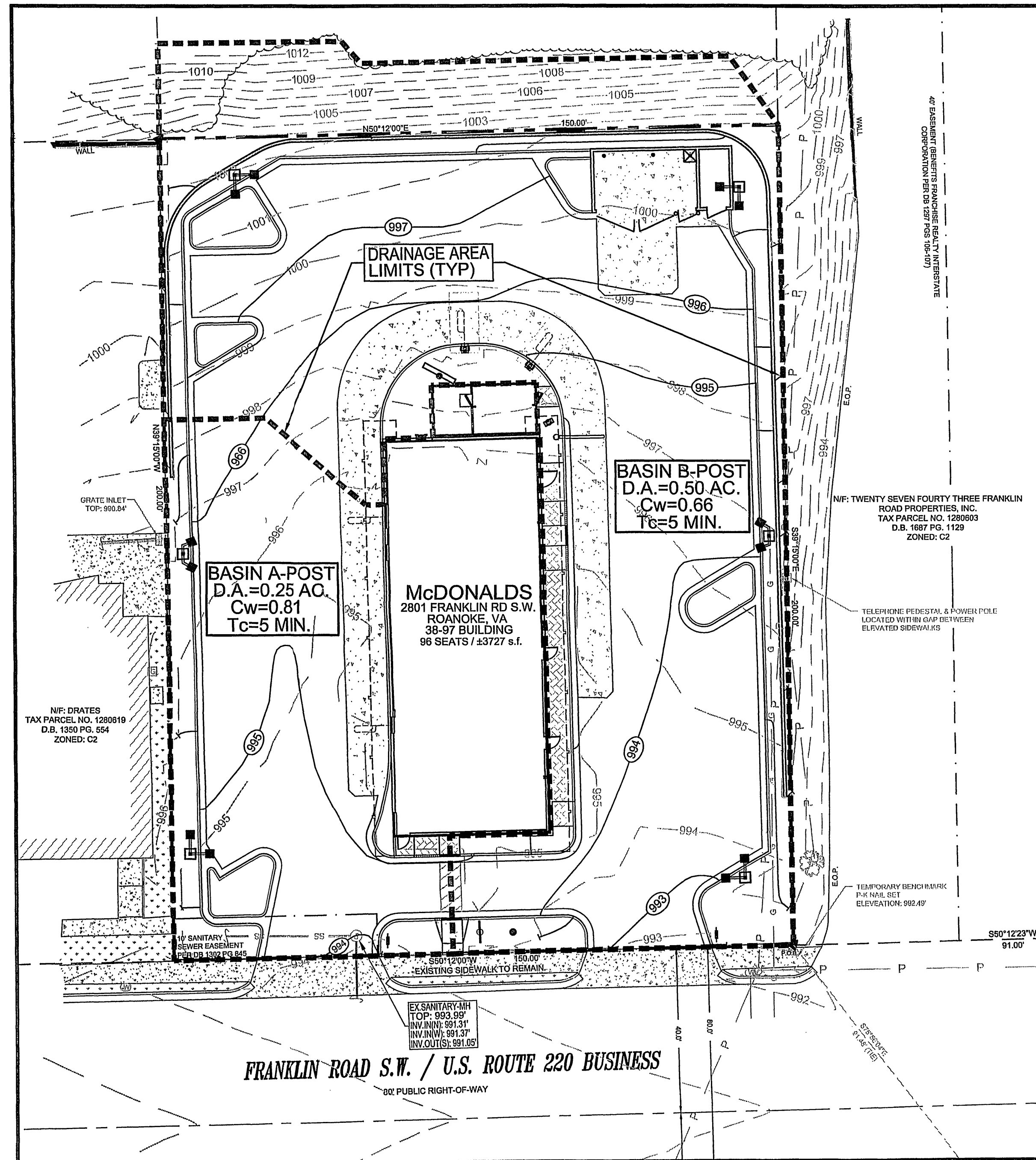

PLAN APPROVAL		SIGNATURE (2 REQUIRED)		DATE
		REGIONAL MGR.		
		CONST. MGR.		
		OPERATIONS DEPT.		
		REAL ESTATE DEPT.		
		CO-SIGN SIGNATURES		
		CONTRACTOR		
		PLAN NO.		
STATUS		DATE		BY
FINAL		08/11/05		DGS
PLAN CHECKED		-		JAL
AS-BUILT		-		-
<div style="text-align: center; font-size: 2em; font-weight: bold;">C4.3</div> <div style="text-align: center;">PRE / POST DEVELOPMENT PLAN</div>				