

N/F: HARCROS LUMBER & BUILDING SUPPLIES INC.
TAX PARCEL NO. 1280602
D.B. 1609 PG. 1
ZONED: LM

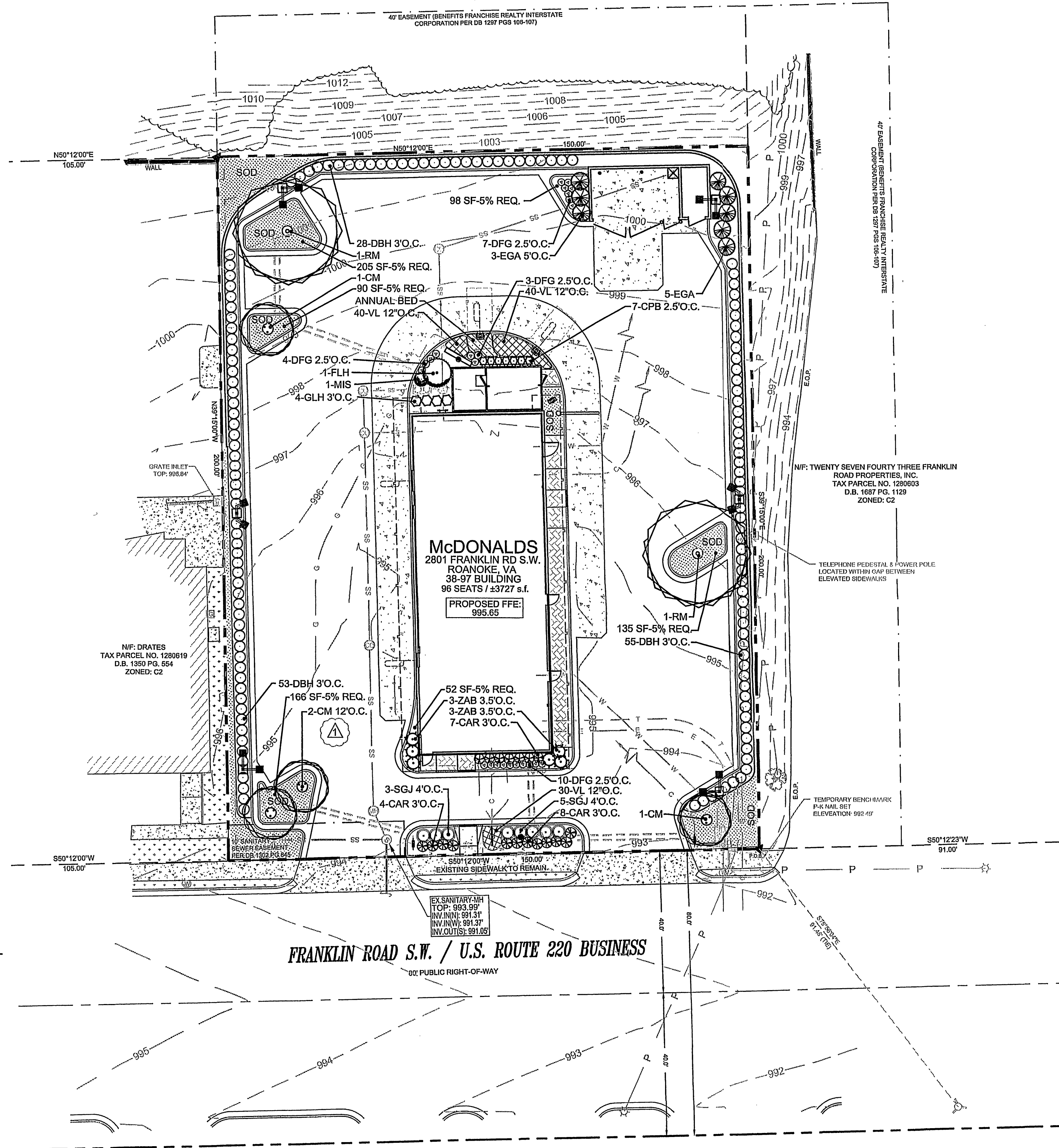
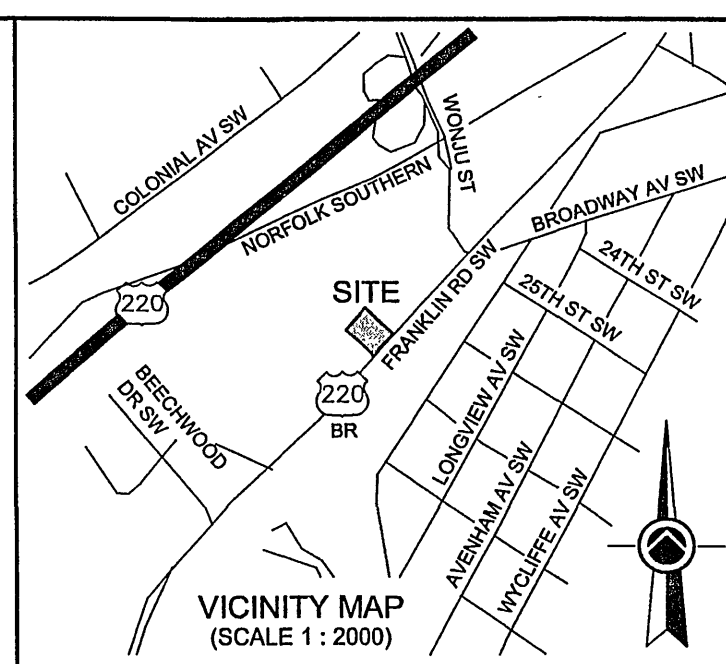

REQUIRED: AN AREA EQUAL TO 5% OF PARKING AREA MUST BE LANDSCAPED. REFER TO LANDSCAPE PLAN FOR AREAS DESIGNATED TO SATISFY THIS REQUIREMENT AS WELL AS THEIR SQUARE FOOTAGES, AS VERIFIED WITH CITY OF ROANOKE PLANNING DEPARTMENT VIA TELEPHONE.

PROPOSED PARKING AREA = 14,744.14 SF
 REQUIRED INTERNAL LANDSCAPE AREA = 14,744.14 SF X 5% = 737 SF
 AREA OF INTERNAL LANDSCAPE PROVIDED = 745 SF OR 5.1% OF PARKING AREA

| Code | Common Name | Botanical Name | Qty. | Caliper | Height | Spread | Comments |
|----------------------------------|------------------------------|--|------|-------------|----------|---------|---|
| Trees | | | | | | | |
| FLH | Fineline Holly | Ilex x 'Fineline' | 1 | ----- | 7'-8" | 3.5'-4' | BB, Specimen, Full to Ground |
| RM | October Glory Maple | Acer Rubrum 'October Glory' | 2 | 2.5-3" | 12'-14" | ----- | BB, Specimen, Main Leader |
| CR | Natchez' Crape Myrtle | Lagerstroemia indica 'Natchez' | 3 | 2" Min. Ea. | 8'-9" | ----- | BB, Specimen, Multi-stem, White Flowers |
| Shrubs | | | | | | | |
| DFG | Hamel' Dwarf Fountain Grass | Pennisetum alopecuroides 'Hamel' | 24 | ----- | 15-18" | 15-18" | Container |
| DBH | Dwarf Burford Holly | Ilex cornuta 'Burfordii nana' | 136 | ----- | 18-24" | 18-24" | Container |
| GLH | Green Luster Holly | Ilex crenata 'Green Luster' | 4 | ----- | 18-24" | 18-24" | Container |
| EAG | Emerald Green Arborvitae | Thuja occidentalis 'Emerald Green' | 8 | ----- | 4'-5" | 2-2.5" | Container |
| SGJ | Sea Green Juniper | Juniperus chinensis 'Sea Green' | 8 | ----- | 48" min. | 24-36" | Container |
| CPB | Crimson Pymy Barbbery | Berberis thunbergii 'Crimson Pymy' | 7 | ----- | 15-18" | 15-18" | Container |
| AZA | Delaware Valley White Azalea | Azalea 'Delaware Valley White' | 13 | ----- | 15-18" | 15-18" | Container, White Flowers |
| CAR | Carissa Holly | Ilex cornuta 'Carissa' | 19 | ----- | 18-24" | 18-24" | Container |
| ZAB | Zabel Laurel | Prunus laurocerasus 'Zabelliana' | 6 | ----- | 18-24" | 18-24" | Container |
| MIS | Maiden Grass | Miscanthus sinensis 'Gracillinus' | 1 | ----- | 18-24" | 18-24" | Container |
| Groundcovers / Perennials | | | | | | | |
| VL | Variegated Liriope | Liriope muscari 'Variegata' | 110 | ----- | Full | Full | Container, 3-bibs |
| Annuals | | | | | | | |
| | Annuals Spring / Fall | (Spring)-Begonias,Vinca & (Fall) Pansy Mix | 40 | S.F. | ----- | ----- | Selection & Color By Owner |

REFER TO SHEET C6.2 (PLANTING NOTES AND DETAILS) FOR ALL APPLICABLE PLANTING NOTES, SPECIAL CONDITION NOTES, THE LANDSCAPE CONSTRUCTION SEQUENCE, SOIL PREPARATION NOTES, SOD PREPARATION AND SPECIFICATIONS, PLANTING DETAILS, AND THE LANDSCAPE WORK SPECIFICATIONS.

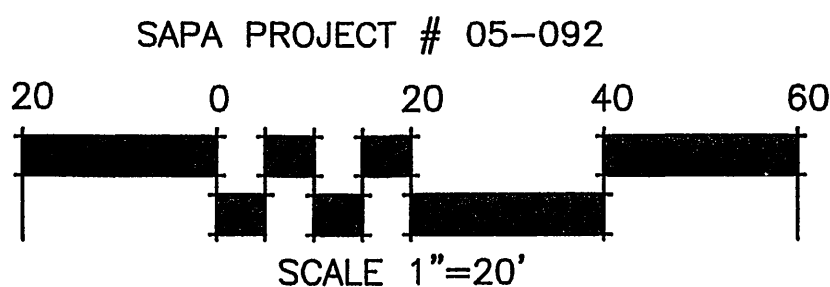

DB 1350 - PG 554

[illegible]

GENERAL NOTES

1. McDONALD'S ROAD SIGN AND BASE ARE BY THE SIGN CONTRACTOR, CONDUIT AND WIRING ARE BY THE G.C.
2. BASES, GALVANIZED ANCHOR BOLTS, CONDUIT, AND WIRING FOR ALL OTHER SIGNS ARE BY THE G.C.
3. SMART CANTON SIGNAGE SHALL BE THE RESPONSIBILITY OF THE GENERAL CONTRACTOR.
4. ALL LIGHTING FIXTURES, BASES, POLES, CONDUIT, AND WIRING ARE BY THE GENERAL CONTRACTOR.
5. BASES FOR FLAGPOLES ARE BY THE GENERAL CONTRACTOR. ANCHOR BOLTS ARE BY THE FLAGPOLE SUPPLIER.
6. PROVIDED UTILITIES ARE SHOWN IN SCHEMATIC ONLY. EXACT LOCATIONS SHALL BE DETERMINED TO ALLOW FOR PROPER CONSTRUCTION.
7. THE CONTRACTOR SHALL COORDINATE WITH ALL UTILITY COMPANIES TO DETERMINE EXACT POINT OF SERVICE AND LOCATIONS OF ALL UTILITIES. PROVIDE ALL ELECTRICAL AND PLUMBING DRAWINGS FOR UTILITY SERVICE ENTRANCE LOCATIONS, BASES, AND CIRCUITS.
8. ALL ELEVATIONS SHOWN IN REFERENCE TO THE BENCHMARK AND MUST BE VERIFIED BY THE G.C. AT GROUNDWORK.
9. ALL ELEVATIONS SHOWN IN REFERENCE TO THE BENCHMARK AND MUST BE VERIFIED BY THE G.C. AT GROUNDWORK.
10. ALL LANDSCAPE AREAS SHALL BE SPRINKLERED TO 2" BELOW TOP OF ALL WALKWAYS AND CURBS. FINISH GRASSES, LANDSCAPING, AND SPRINKLER SYSTEMS ARE THE OWNER'S RESPONSIBILITY.
11. THE CONTRACTOR SHALL BE RESPONSIBLE FOR PROVIDING ALL REPORTS AND RECOMMENDATIONS FOR THIS PARTICULAR SITE.
12. REFER TO SHEETS C-1 THRU C-6 FOR ALL APPLICABLE SITE DETAILS.
13. PROVIDE WEEDPILLS ON CURBS AT ALL LANDSCAPE SITE AREAS. CONSULT WITH M&D PROJECT MANAGER.

PAVING SPECIFICATION

REFER TO PAVING DETAILS FOR PAVING SPECIFICATIONS

NOTE: GEN. CON. TO OVERLAY EX. ASPHALT AS NECESSARY

NOTE: MCDONALD'S ENGINEER RESERVES THE RIGHT TO REQUEST A COMPACTION TEST AND/OR A CORE SAMPLE. IF TESTS PROVE CORRECT, PER ABOVE SPECIFICATION, TESTS WILL BE AT THE EXPENSE OF MCDONALD'S, OTHERWISE, G.C. WILL BE CHARGED. NECESSARY

LOT LIGHTING RECOMMENDATION

SECURITY LIGHTING ASB1000 WATT METAL HALIDE FIXTURE
30 DEGREE TILT ON 22 FOOT POLE 2 FOOT CONCRETE BASE
ASB-4-MH-DB-MT W/LAMP
GEN. CON. TO NOTE CORRECT LOCATION OF FIXTURES

NOTE: ALL LIGHTING SHALL BE GLARE SHIELDED AND NON-DIRECTIONAL TO PREVENT DIRECT ILLUMINATION BEYOND THE PROPERTY LINE.

NOTE: ELECTRICAL CONTRACTOR TO CIRCUIT LOT LIGHTING AS NOTED.

PARKING INFORMATION

| | | | | |
|---------------------------|-------------|--------|---------|------|
| TOTAL SPACES 34 | 2-HC SPACES | 8.0' X | 18.0' @ | 60 * |
| | 30 SPACES | 9.0' X | 18.0' @ | 60 * |
| | 2 SPACES | 9.0' X | 18.0' @ | 90 * |
| | - SPACES | -' X | -' @ | - * |

UTILITY INFORMATION

| | SIZE | TYPE | LOCATION |
|----------------|---|------|----------|
| SANITARY SEWER | EXISTING SANITARY SEWER MANHOLE ON SITE IN WESTERN DRIVEWAY | | |
| WATER | EXISTING WATERLINE RUNNING FROM FRANKLIN ROAD INTO SITE NEAR EAST PROPERTY LINE | | |
| STORM SEWER | N/A | | |
| ELECTRIC | EX. OVERHEAD ALONG EAST PROPERTY LINE AND UNDERGROUND SERVICE ALONG EAST PROPERTY LINE | | |
| GAS | EXISTING GASLINE ALONG EAST PROPERTY LINE | | |

SURVEY INFORMATION

PREPARED BY: *BOUNDARY AND TOPOGRAPHIC SURVEY BY:*
REGIONAL LAND SURVEYORS, INC.
8642 West Market Street Suite 100
Greensboro, North Carolina 27409
TEL.#: (336) 665-8155

PLAN SCALE: AS NOTED

STREET ADDRESS
2801 FRANKLIN ROAD S.W.

| | |
|-----------------|-------------------|
| CITY ROANOKE | STATE VIRGINIA |
|-----------------|-------------------|

COUNTY
ROANOKE

| | |
|------------------|----------------------|
| REGIONAL DWG. NO | LOCATION CODE NUMBER |
|------------------|----------------------|

[illegible]

Stimmel

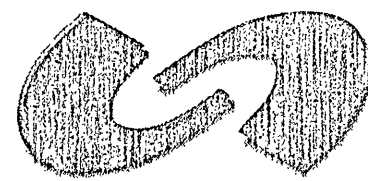

Stimmel Associates, PA

Landscape Architecture
Civil Engineering
Land Planning

601 N. Trade Street Suite 200
Winston Salem, NC 27101-2916
P: 336.723.1067 F: 336.723.1069

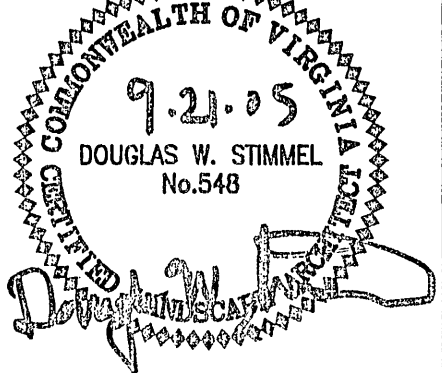

McDonald's®

THESE PLANS AND SPECIFICATIONS ARE THE PROPERTY OF MCDONALD'S CORPORATION
AND SHALL NOT BE REPRODUCED WITHOUT THEIR WRITTEN PERMISSION.

| CE | RALEIGH REGION |
|------|---|
| LESS | 3200 REECHIEAF COURT - SUITE 300 - RALEIGH N.C. 27604 |

| | | | |
|------------------------|--|----------|--------------------|
| PLAN APPROVAL | | | CO-SIGN SIGNATURES |
| SIGNATURE (2 REQUIRED) | | | |
| REGIONAL MGR. | | | |
| CONST. MGR. | | | |
| OPERATIONS DEPT. | | | |
| REAL ESTATE DEPT. | | | |
| STATUS | | DATE | BY |
| FINAL | | 08/11/05 | DGS |
| PLAN CHECKED | | - | JAL |
| AS-BUILT | | - | - |

C6.1

LANDSCAPE PLAN