

1. THE CONTRACTOR SHALL REVIEW THE EROSION & SEDIMENT CONTROL NARRATIVE FOR PHASING OF EROSION & SEDIMENT CONTROL MEASURES. THE CONTRACTOR SHALL COMPLY WITH LOCAL CODES IN OBSERVING EROSION CONTROL MEASURES BOTH ON AND OFF THE SITE. REFER TO THE VIRGINIA EROSION AND SEDIMENT CONTROL HANDBOOK FOR DETAILS AND SPECIFICATIONS OF THOSE EROSION CONTROL ITEMS FOUND ON THESE DRAWINGS.
2. THE CONTRACTOR SHALL PROVIDE ALL GRADING, GENERAL EXCAVATION, AND FINISH GRADING AS INDICATED ON THE DRAWINGS. WORK SHALL BE ACCOMPLISHED IN ACCORDANCE WITH VDOT STANDARDS AND SPECIFICATIONS. ALL FILLS AND BACKFILLS SHALL BE UNIFORMLY COMPACTED TO AT LEAST 95% OF THE STANDARD PROCTOR MAXIMUM DENSITY. THE CONTRACTOR SHALL PROVIDE POSITIVE DRAINAGE AT ALL TIMES.
3. A COPY OF THE STORMWATER POLLUTION PREVENTION PLAN, AND MAINTENANCE LOGS SHALL BE KEPT ON SITE AND AVAILABLE FOR REVIEW AS REQUESTED.
4. ALL EARTH SLOPES AND DENUDED AREAS SHALL BE SEEDED AND MULCHED AS REQUIRED FOR STABILIZATION WITHIN SEVEN (7) DAYS OF COMPLETION OF EXCAVATION OPERATIONS. REFERENCE IS DIRECTED TO THE SEEDING REQUIREMENTS.

CONSTRUCTION WILL BE SEQUENCED TO INSTALL INITIAL EROSION AND SEDIMENT CONTROL MEASURES PRIOR TO DEMOLITION.

- CONTRACTOR SHALL MAINTAIN THE CONSTRUCTION ENTRANCE PER VA ESCH STD. & SPEC 3.02.
- CONTRACTOR SHALL VERIFY OR INSTALL SILT FENCE AS SHOWN ON PLANS.
- AFTER THE INITIAL MEASURES ARE INSTALLED, THE CONTRACTOR MAY BEGIN GRADING, INSTALLATION OF STORM PIPE AND UTILITIES. INSTALL INLET PROTECTION AS NEEDED AS STORM IS INSTALLED. CONTRACTOR SHALL DIVERT DISTURBED AREAS TO NEW INLET PROTECTIONS AS THEY ARE INSTALLED TO LIMIT AREA TO CURB INLET IN FRANKLIN RD.
- ONCE INSTALLATION OF THE PROPOSED UNDERGROUND UTILITIES ARE COMPLETED, CONTRACTOR MAY BEGIN FINAL GRADING AS FINAL GRADE. SILT FENCE, NEW VA ESCH MEASURES ARE TO BE INSTALLED.
- ONCE THE SITE HAS BEEN STABILIZED, THE TEMPORARY EROSION AND SEDIMENT CONTROL MEASURES MAY BE REMOVED AND THOSE AREAS BROUGHT TO FINAL GRADE AND STABILIZED. THE CONTRACTOR SHALL COORDINATE WITH LOCAL AUTHORITY PRIOR TO REMOVING THE EROSION AND SEDIMENT CONTROL MEASURES. ALL MEASURES SHALL BE REMOVED WITHIN 30 DAYS AFTER FINAL SITE STABILIZATION OR AFTER TEMPORARY MEASURES ARE NO LONGER NEEDED, UNLESS OTHERWISE AUTHORIZED BY THE LOCAL PROGRAM AUTHORITY. ALL ESC MEASURES TO BE ALTERED OR REMOVED REQUIRE LOCAL AUTHORITY APPROVAL.
- THE SILT FENCE, INLET PROTECTION, CULVERT INLET PROTECTION, AND DIVERSION DIKES SHALL BE REMOVED FROM THE PROJECT ONCE ALL DISTURBED AREAS ARE STABILIZED AND PERMANENT VEGETATION IS ESTABLISHED. THE USE OF A FILTER DEVICE SHALL BE USED TO DEWATER SEDIMENT LADEN WATER.

PROVIDE THE FOLLOWING:

- (CE) CONSTRUCTION ENTRANCE MEETING VA ESCH STD. & SPEC. 3.02
- (SF) SILT FENCE MEETING VA ESCH STD. & SPEC. 3.05
- (IP) INLET PROTECTION MEETING VA ESCH STD. & SPEC. 3.07
- (TO) TOPSOILING MEETING VA ESCH STD. & SPEC. 3.30
- (TS) TEMPORARY SEEDING MEETING VA ESCH STD. & SPEC. 3.31
- (PS) PERMANENT SEEDING MEETING VA ESCH STD. & SPEC. 3.32
- (BM) BLANKET MATTING MEETING VA ESCH STD. & SPEC. 3.36
- (DC) DUST CONTROL MEETING VA ESCH STD. & SPEC. 3.39
- (RW3) TEMPORARY RIGHT-OF-WAY DIVERSION MEETING VA ESCH STD. & SPEC 3.11

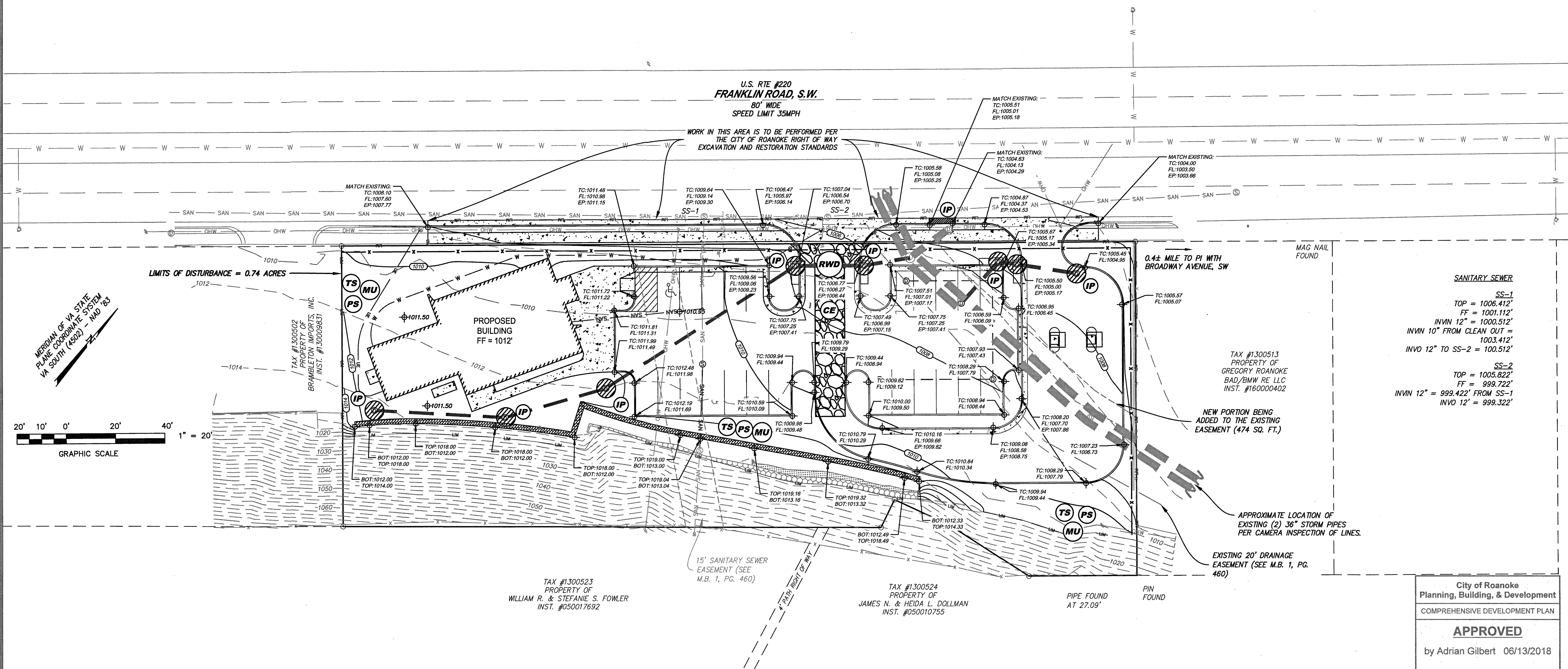

© 2006 The Authors
Journal compilation © 2006 Blackwell Publishing Ltd