

CP#1

1. CLEAR AND GRUB TREES AND VEGETATION WITHIN PROPERTY LINE ONLY AS REQUIRED FOR CONSTRUCTION. CONSULT WITH CITY PRIOR TO CUTTING DOWN ANY TREES 12" IN DIAMETER OR LARGER DISPOSE OF MATERIAL OFF THE PROJECT SITE.
2. CONTRACTOR SHALL ADJUST CONTOURS OF FILL AREA TO ALLOW DISPOSAL OF ALL EXCAVATED TANK SITE MATERIAL ON THE TANK PROPERTY.
3. TANK IS 84,000 GALLONS WITH OVERFLOW @ 1776.50, HEIGHT IS 38'-0" AND DIAMETER IS 20'-0". TOP RINGWALL EL. IS 1739.50.
4. VALVE VAULT FOR 4" VALVE SHALL BE A STANDARD PRECAST CONCRETE MANHOLE CONE SECTION WITH 24" DIAMETER FRAME AND COVER AND GRAVEL BOTTOM. TANK CONTRACTOR SHALL PROVIDE 3/4" CORPORATION STOP ON TANK SIDE OF 4" VALVE. PRESSURE TRANSDUCER SHALL BE MOUNTED BY PIPELINE CONTRACTOR ON CORPORATION STOP ON TANK SIDE OF 4" VALVE.
5. AFTER CONSTRUCTION OF NEW TANK, EXISTING WATER TANKS SHALL BE DEMOLISHED AND DISPOSED OF BY THE CONTRACTOR AT HIS EXPENSE. TANK FOUNDATIONS MAY BE LEFT IN PLACE. HOWEVER, WATERLINES TO THE TANKS SHALL BE ADEQUATELY PLUGGED/CAPPED. VALVE BOXES ON ABANDONED. WATERLINES SHALL BE REMOVED.

COORDINATE		LIST
CP#	NORTH	EAST
1002	3618276.1968	11066982.2843
		CENTER OF TANK
SURVEY CONTROL POINTS		
CP#	NORTH	EAST
1	3618337.3553	11066862.7444
27	3618501.7210	11067182.3700
		PI IRON ROD CONTROL MON./ROANOKE CITY ALUM. DISC

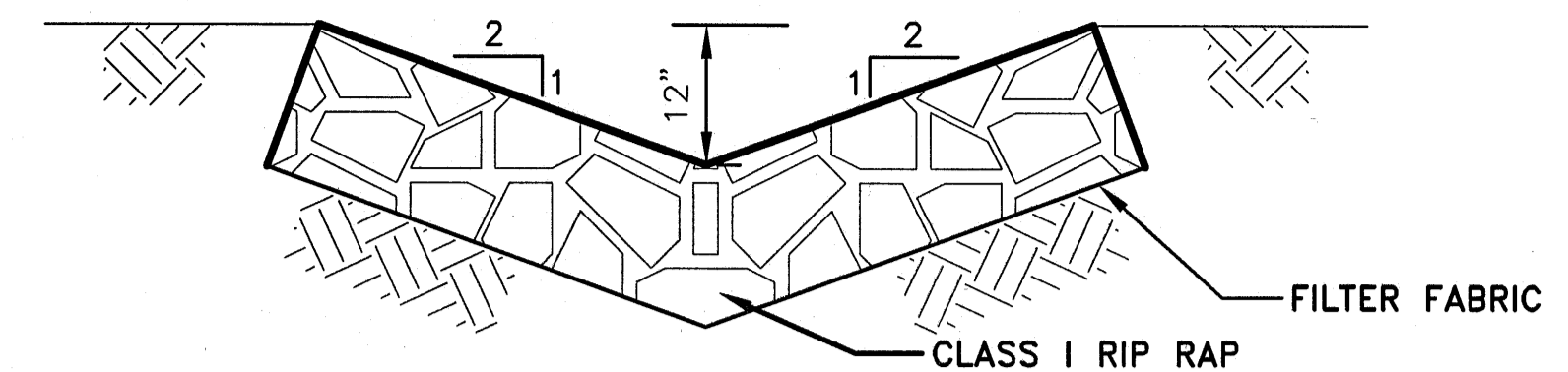
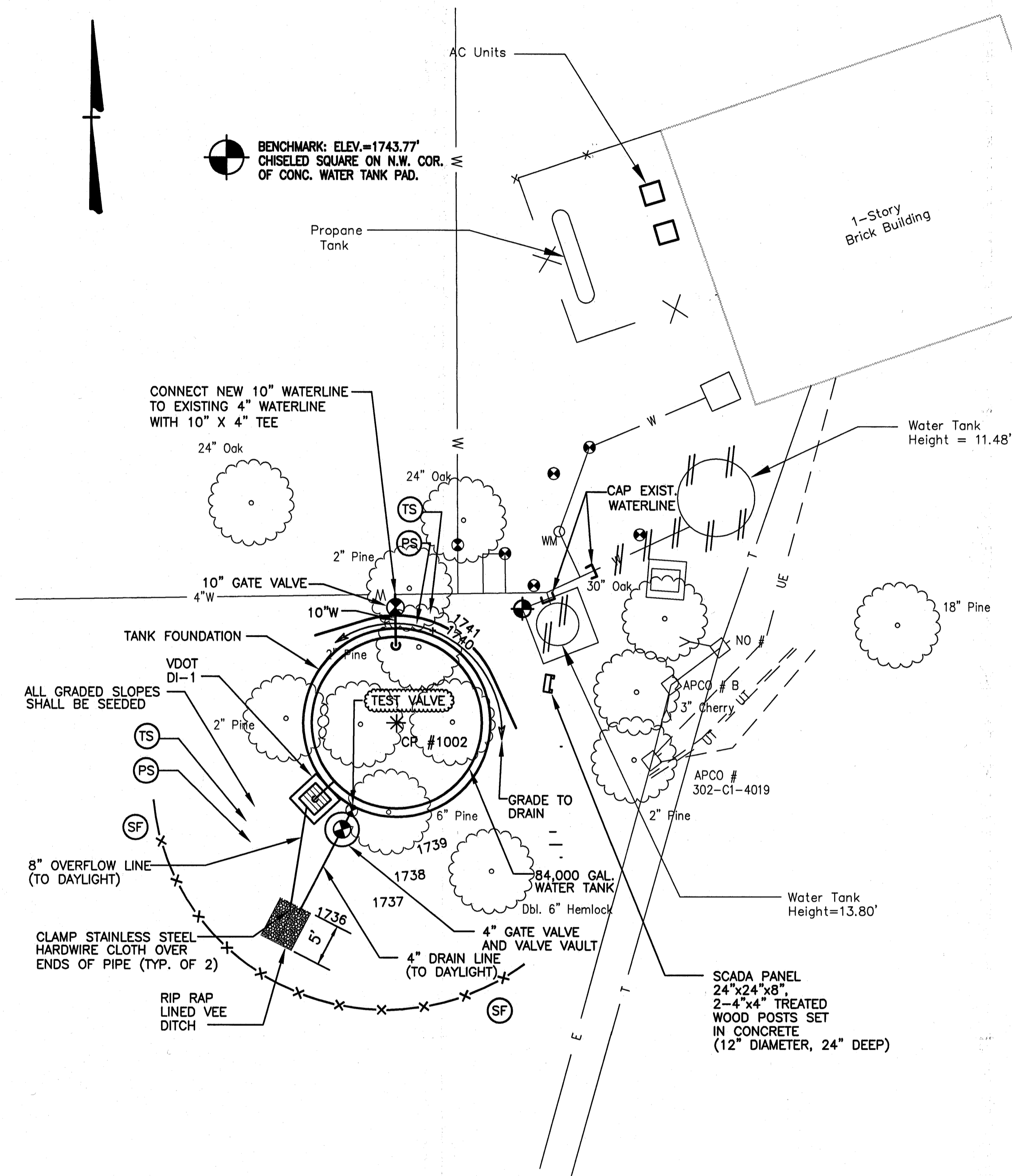

Diagram illustrating the installation of a radio modem and antenna through a wall, showing the following components and specifications:

- COLINEAR ANTENNA (FURNISHED BY SYNCHRONY)
- COAXIAL CABLE (50' FURNISHED BY SYNCHRONY)
- EXTERIOR WALL
- ENCLOSURE WITH ETHERNET RADIO MODEM (FURNISHED BY SYNCHRONY)
- 1 1/2" CONDUIT AND FITTINGS WITH MOUNTING BRACKETS @ 6' CC (40' CND.)
- SEAL OPENING IN WALL
- GROUND ROD
- PROVIDE 120V, SINGLE PHASE, WIRE AND CONDUIT FRM CONN. LOCATED WITHIN ROOM (30')

**ELECTRICAL WORK AT CRYSTAL
SPRING FILTRATION PLANT**
NO SCALE

1. CONTRACTOR SHALL INSTALL EQUIPMENT FURNISHED BY SYNCHRONY.
2. INSTALLATION SIMILAR AT NEW PUMP STATION- PROVIDE 20' MAST CONDUIT.
3. INSTALL ANTENNA ON TANK HANDRAIL AT TANK. PROVIDE CONDUIT FROM SCADA PANEL TO TOP OF TANK.

[illegible]

Issue Date: 02/17/04	Drawn By: ARB Designed By: BCC	Checked By: BCC Date: 02/17/04
-------------------------	-----------------------------------	-----------------------------------

Mattem & Craig
CONSULTING ENGINEERS • SURVEYORS

701 FIRST STREET, S.W.
ROANOKE, VIRGINIA 24016
(540) 345-9342
FAX (540) 345-7691

MILL MOUNTAIN WATER PROJECT
WATER TANK—
SITE PLAN
CITY OF ROANOKE, VIRGINIA

Vertical Scale:
N/A

Horizontal Scale:
1"= 10'

Commission Number:
2120

Sheet No.: