

EROSION CONTROL SYMBOLS:

CE 3.02 CONSTRUCTION ENTRANCE	TSD 3.15 TEMPORARY SLOPE DRAIN
CRS 3.03 CONSTRUCTION ROAD STABILIZATION	CD 3.20 ROCK CHECK DAMS
SF 3.05 SILT FENCE	SR 3.29 SURFACE ROUGHENING
IP 3.07 STORM DRAIN INLET PROTECTION	TO 3.30 TOPSOILING
CIP 3.08 CULVERT INLET PROTECTION	TS 3.31 TEMPORARY SEEDING
DD 3.09 TEMPORARY DIVERSION DIKE	PS 3.32 PERMANENT SEEDING
FD 3.10 TEMPORARY FILL DIVERSION	MU 3.35 MULCHING
DV 3.12 DIVERSION	TP 3.38 TREE PRESERVATION & PROTECTION
ST 3.13 TEMPORARY SEDIMENT TRAP	DC 3.39 DUST CONTROL

TRAFFIC CONTROL NOTES:

1. THE CONTRACTOR SHALL PROVIDE TRAFFIC CONTROL AND SAFETY MEASURES IN ACCORDANCE WITH THE WORK AREA PROTECTION MANUAL.
2. THE CONTRACTOR SHALL MAINTAIN VEHICULAR ACCESS THROUGH VALLEY STREAM DRIVE AT ALL TIMES DURING CONSTRUCTION.
3. CONTRACTOR IS RESPONSIBLE FOR PATCHING AND/OR REPLACING ASPHALT IN A MANNER ACCEPTABLE TO VDOT.

POINT TABLE			
HORIZONTAL BASED: NAD 83 (CORR96)		VERTICAL BASED: NAVD88	
NORTHING	EASTING	ELEVATION	DESCRIPTION
1757	361295.4779	11072961.0652	TNS
1761	3612913.5700	11072734.6468	TNS
1762	3613027.3308	11072435.5427	TNS
1763	3612984.4876	11072260.0541	TNS
1764	3612839.1777	11072506.2095	TNS
1765	3612889.5745	11072713.5421	TNS
1766	3613046.3067	11073162.4028	TNS
3108	3612903.4039	11072526.0055	BM CHSO
3109	3612983.2079	11072257.5905	BM CHSO
3010	3612989.3468	11073036.2778	BM CHSO

VIRGINIA STATE PLANE SOUTH ZONE
NAD-83/CORR96

- NOTES:
1. PROPERTY SHOWN HEREON WAS RECREATED FROM DEEDS AND PLATS OF RECORD AND DOES NOT CONSTITUTE AN ACTUAL BOUNDARY SURVEY.
 2. HORIZONTAL DATUM - NAD 83(CORR96)/VERTICAL DATUM - NAVD88
 3. UNDERGROUND UTILITIES SHOWN PER ABOVE GROUND FEATURES AND UNDERGROUND DESIGNATION BY MISS UTILITY. UTILITIES LOCATIONS SHOWN HEREON SHOULD BE TREATED AS APPROXIMATE AND SHOULD BE FIELD VERIFIED BEFORE EXCAVATION.
 4. PER ADJOINING OWNER, THERE IS POSSIBLY A NATURAL GAS LINE RUNNING ALONG THE SOUTH SIDE OF RAINELLE STREET. SAID GAS LINE WAS NOT DESIGNATED PER MISS UTILITY AND THEREFORE IS NOT REFLECTED IN THIS TOPOGRAPHIC SURVEY.
 5. THIS TOPOGRAPHIC SURVEY REFLECTS SITE CONDITIONS AS RECORDED BY ANDERSON & ASSOCIATES FIELD CREWS BETWEEN DECEMBER 01, 2008 AND DECEMBER 02, 2008. ANY ADDITIONAL IMPROVEMENTS DONE WITHIN SURVEYED AREA, AFTER THESE DATES, WILL NOT BE INCLUDED IN THIS SURVEY.

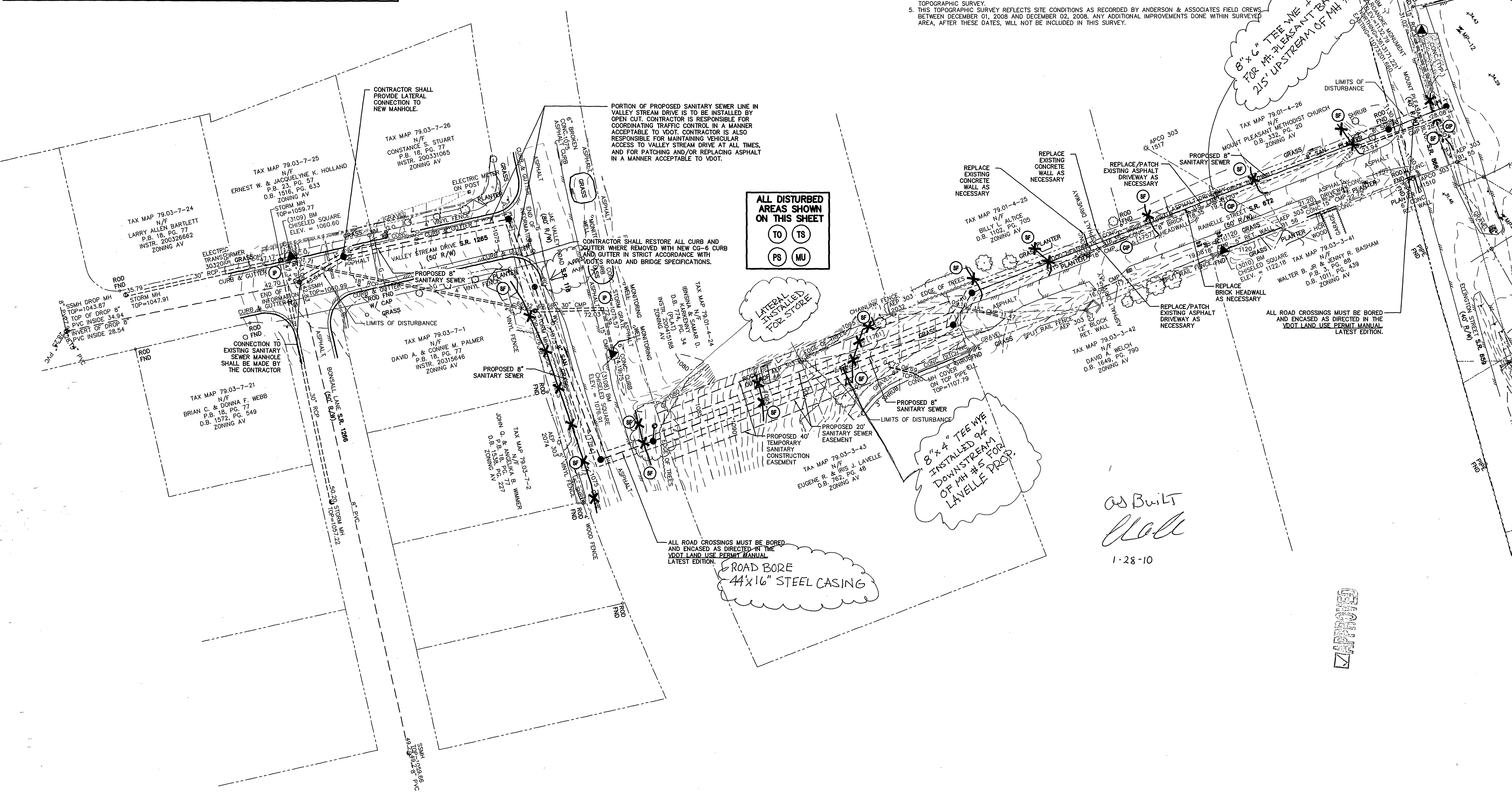

ALL DISTURBED AREAS SHOWN ON THIS SHEET

TO TS
PS MU

LATERAL INSTALLED FOR STORE

8" x 4" TEE W/ INSTALLED 94' DOWNSTREAM OF MH #5 FOR LAVELLE PROP.

ALL ROAD CROSSINGS MUST BE BORED AND ENCASED AS DIRECTED IN THE VDOT LAND USE PERMIT MANUAL, LATEST EDITION.

ROAD BORE 44" x 16" STEEL CASING

as Built
1-28-10

APPROVED

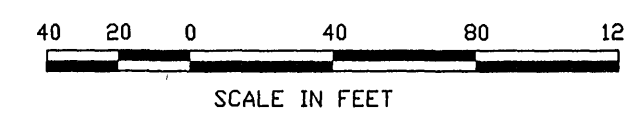

GAY AND NEEL, INC.
CIVIL ENGINEERING
LAND PLANNING
SURVEYING
328 Mountain Avenue S.W.
Roanoke, Virginia 24016
Phone: (540) 345-1110 Fax: (540) 345-5550
Email: info@gayandneel.com

ADDENDUM #1	Final Review	description
04/20/2009	MPT	by
05/27/2009	RWA	date
#1	mark	revisions
#2	mark	revisions

DATE	PROJECT	DESIGNED	DRAWN	CHECKED
APRIL 3, 2009	08142.03	MPT	MPT	RCM/TWK

RRMM ARCHITECTS, PC
28 West Church Ave
Roanoke, VA 24011
(540)344-1212 / fax (540)344-1321

COMMONWEALTH OF VIRGINIA
TREVOR M. KIMZEY
Lic. No. 036345
06/02/09
PROFESSIONAL ENGINEER

VIRGINIA DEPARTMENT OF EDUCATION 80-580

PROJECT MOUNT PLEASANT ELEMENTARY SCHOOL
ROUGH GRADING & SEWER PLANS
328 MOUNT PLEASANT BOULEVARD
ROANOKE, VA
DRAWING UTILITY PLAN

SHEET
C4-01