

PHASE 2 ESC SEQUENCE

1. AFTER THE BUILDING PADS REACH SUBGRADE, BUILDING CONSTRUCTION MAY BEGIN.
2. PERMANENT OR TEMPORARY SEEDING SHALL BE APPLIED WITHIN 7 DAYS TO ANY AREA THAT WILL REMAIN DORMANT FOR LONGER THAN 14 DAYS. PERMANENT SEEDING SHALL BE APPLIED TO ANY AREA THAT HAS REACHED FINAL GRADE OR THAT WILL REMAIN DORMANT FOR LONGER THAN 1 YEAR.
3. UTILITY CONSTRUCTION SHALL COMMENCE AT THE APPROPRIATE TIME DURING CONSTRUCTION. INLET PROTECTION SHALL BE INSTALLED ON NEW INLETS IMMEDIATELY AFTER INSTALLATION.
4. THE REMOVAL OF EXISTING STORM DRAIN AND THE INSTALLATION OF THE NEW STORM DRAIN SYSTEM SHALL BE SEQUENCED SO THAT THE NEW SYSTEM IS FUNCTIONAL AS SOON AS POSSIBLE AFTER REMOVAL OF THE EXISTING INLETS.
5. INLET PROTECTION SHALL BE REMOVED AS NECESSARY WITH REMOVAL OF THE EXISTING STORM DRAIN AND DIVERSIONS SHALL BE MODIFIED AS NECESSARY TO DIRECT STORMWATER TO THE NEW INLETS.
6. CURB AND GUTTER, PAVEMENT, AND SIDEWALKS SHALL BE INSTALLED IN THESE AREAS AT THIS TIME.
7. THE PHASE 3 CONSTRUCTION AREA SHALL INCLUDE THE NEW COURTYARD AND PLAZA AREAS AND THE ENTRANCE ROAD AND NEW ROUNDABOUT IMPROVEMENTS (SUMMER OF 2020).
8. GRADING OPERATIONS FOR THE PHASE 3 AREA SHALL COMMENCE AT THIS TIME.
9. UTILITY CONSTRUCTION SHALL COMMENCE AT THE APPROPRIATE TIME DURING CONSTRUCTION. INLET PROTECTION SHALL BE INSTALLED ON NEW INLETS IMMEDIATELY AFTER INSTALLATION.
10. CURB AND GUTTER, PAVEMENT, AND SIDEWALKS SHALL BE INSTALLED IN THESE AREAS AT THIS TIME.
11. LANDSCAPING SHALL BE INSTALLED AT THIS TIME.
12. DIVERSIONS SHALL BE REMOVED AND ALL AREAS OF THE SITE NOT RECEIVING HARDSCAPE SHALL RECEIVE PERMANENT SEEDING OR SODDING.
13. AFTER PERMANENT STABILIZATION, SILT FENCE, INLET PROTECTION, AND CONSTRUCTION ENTRANCE MAY ALL BE REMOVED.
14. G.C. SHALL NOTIFY ROANOKE COUNTY INSPECTOR AND RECEIVE APPROVAL PRIOR TO REMOVAL OF ANY ESC MEASURES.
15. LIMITS OF DISTURBANCE SHALL BE STRICTLY ADHERED TO.
16. SEE SHEET C7 FOR PHASE 1 ESC PLAN.
17. THIS CONSTRUCTION SEQUENCE IS INTENDED TO BE A GENERAL GUIDE. ALL CONSTRUCTION SEQUENCING SHALL BE CLOSELY COORDINATED WITH NORTH CROSS SCHOOL, INCLUDING ANY ACCESS OR UTILITY LIMITATIONS. THE CONSTRUCTION SEQUENCE SHALL ALSO BE COORDINATED WITH THE ROANOKE COUNTY INSPECTOR TO ENSURE THAT ADEQUATE EROSION CONTROL MEASURES ARE IN PLACE AT ALL TIMES.

ESC LEGEND

3.01	SAFETY FENCE	SAF
3.02	TEMPORARY STONE CONSTRUCTION ENTRANCE	CE
3.05	SILT FENCE	SF
3.07	STORM DRAIN INLET PROTECTION	IP
3.18	OUTLET PROTECTION	OP
3.31	TEMPORARY SEEDING	TS
3.32	PERMANENT SEEDING	PS
3.35	MULCHING	MU

- PHASE 1 CONSTRUCTION AREA (SUMMER 2019)
- PHASE 2 CONSTRUCTION AREA (2019-2020 SCHOOL YEAR)
- PHASE 3 CONSTRUCTION AREA (SUMMER 2020)

ELECTRIC ROAD
(VARIABLE WIDTH R/W)
ROUTE 419

N/F
MSK HOLDINGS, LLC
INSTRUMENT #200415506
TAX MAP #077.18-05-02.01-000

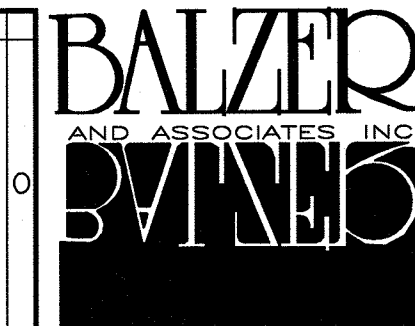
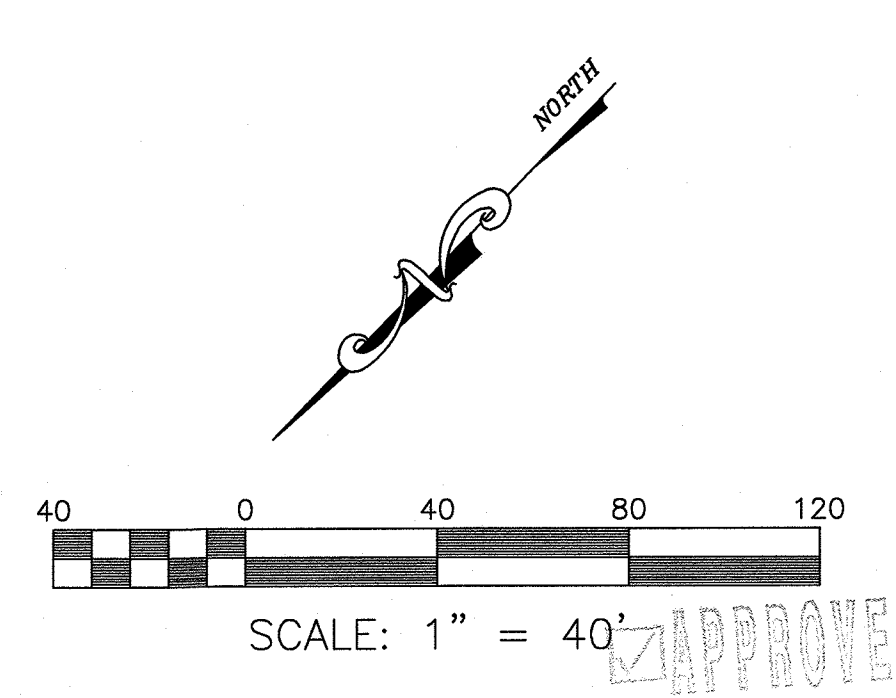
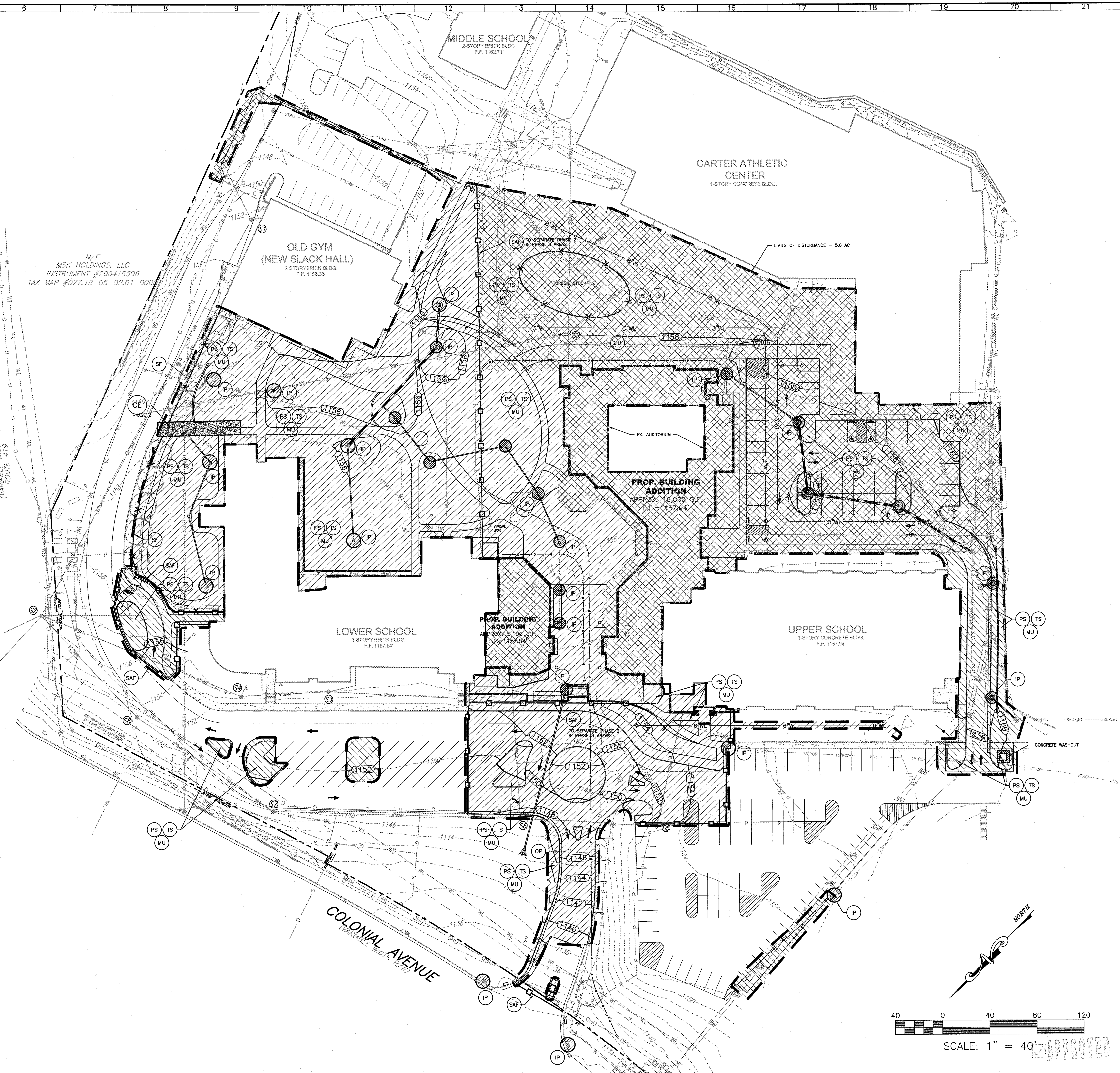

www.balzer.cc

Roanoke
New River Valley
Richmond
Staunton
Harrisonburg

RESIDENTIAL LAND DEVELOPMENT ENGINEERING
SITE DEVELOPMENT ENGINEERING
LAND USE PLANNING & ZONING
LANDSCAPE ARCHITECTURE
LAND SURVEYING
ARCHITECTURE
STRUCTURAL ENGINEERING
TRANSPORTATION ENGINEERING
ENVIRONMENTAL & SOIL SCIENCE
WETLAND DELINEATIONS & STREAM EVALUATIONS

Balzer and Associates, Inc.
1208 Corporate Circle
Roanoke, VA 24018
540-772-9580
FAX 540-772-8050

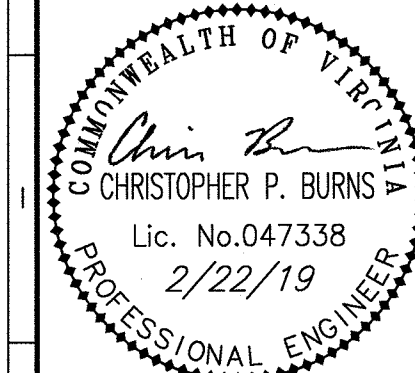

NORTH CROSS SCHOOL
4254 COLONIAL AVENUE SW
PHASE 2 E.S.C. PLAN
CAVE SPRING DISTRICT
ROANOKE COUNTY, VIRGINIA

DRAWN BY EJP
DESIGNED BY CPB
CHECKED BY CPB
DATE 12/20/2018
SCALE 1"=40'
REVISIONS:
2/6/2019
2/22/2019

SHEET NO.
C8
JOB NO. 03170003.01