



GENERAL LEGEND

| EXISTING  |                               | PROPOSED  |
|---|-------------------------------|---|
| N/A   | ABANDON IN PLACE              | ----  |
| -----1000-----  | CONTOURS                      | -----1000-----  |
| ~~~~~ x 1561.3 ~~~~~  | GROUND ELEVATION              | N/A   |
| ~~~~~   | TREE LINE                     | N/A   |
| ~~~~~   | STREAM                        | N/A   |
|  | DECIDUOUS TREE                | N/A   |
|  | CONIFEROUS TREE               | N/A   |
|  | SHRUB                         | N/A   |
| -----   | FENCE                         | N/A   |
| -----   | PROPERTY LINE/ROW             | N/A   |
| ○   | IRON ROD FOUND                | N/A   |
| ●   | IRON ROD SET                  | N/A   |
| □   | MONUMENT FOUND                | N/A   |
| ■   | MONUMENT SET                  | N/A   |
| -----   | EASEMENT                      | -----   |
| -----   | SIGN                          | N/A   |
| ⊙   | METAL POST                    | N/A   |
| ⊙   | WOOD POST                     | N/A   |
| -----   | STORM SEWER                   | N/A   |
| ⊙   | STORM MANHOLE                 | N/A   |
| ⊙   | STORM DRAINAGE INLET          | N/A   |
| ⊙   | STORM STRUCTURE KEY           | N/A   |
| -----   | SANITARY SEWER                | N/A   |
| N/A   | SANITARY SEWER REHAB          | N/A   |
| ⊙   | SANITARY SEWER CLEANOUT       | N/A   |
| ⊙   | SANITARY SEWER MANHOLE        | N/A   |
| ⊙   | SANITARY STRUCTURE KEY        | ⊙   |
| -----   | UNDERGROUND ELECTRIC          | N/A   |
| -----   | OVERHEAD POWER                | N/A   |
| ⊙   | LIGHT POLE                    | N/A   |
| ⊙   | ELECTRIC POLE                 | N/A   |
| ⊙   | ELECTRIC MANHOLE              | N/A   |
| -----   | WATER                         | N/A   |
| ⊙   | GATE VALVE                    | ⊙   |
| ⊙   | AIR RELEASE VALVE             | ⊙   |
| N/A   | REDUCER                       | ⊙   |
| ⊙   | BLOW OFF VALVE                | ⊙   |
| ⊙   | FIRE HYDRANT                  | ⊙   |
| ⊙   | WATER METER & BOX             | ⊙   |
| -----   | GENERIC COMMUNICATION         | N/A   |
| -----   | UNDERGROUND COMMUNICATION     | N/A   |
| -----   | OVERHEAD COMMUNICATIONS       | N/A   |
| -----   | CABLE TV                      | N/A   |
| ⊙   | CABLE TV MANHOLE              | N/A   |
| ⊙   | CABLE TV PEDESTAL             | N/A   |
| -----   | TELEPHONE LINE                | N/A   |
| -----   | OVERHEAD TELEPHONE            | N/A   |
| -----   | UNDERGROUND TELEPHONE         | N/A   |
| ⊙   | TELEPHONE BOX                 | N/A   |
| ⊙   | TELEPHONE MANHOLE             | N/A   |
| ⊙   | TELEPHONE PEDESTAL            | N/A   |
| ⊙   | TELEPHONE POLE                | N/A   |
| -----   | GAS LINE                      | N/A   |
| -----   | GAS DRIP                      | N/A   |
| ⊙   | GAS METER                     | N/A   |
| ⊙   | GAS MANHOLE                   | N/A   |
| ⊙   | GAS VALVE                     | N/A   |
| N/A   | ASPHALT DRIVEWAY RESTORATION  |  |
| N/A   | CONCRETE DRIVEWAY RESTORATION |  |
| N/A   | GRAVEL DRIVEWAY RESTORATION   |  |
| N/A   | PAVEMENT REMOVAL              |  |
| N/A   | DEMOLISH                      |  |

SURVEY NOTES:

- 1.) Source of Meridian: virginia State Plane, South Zone (NAD 83) based upon: static GPS sessions performed by Draper Aden Associates personnel.  
2.) Vertical datum: NAVD 88 based upon: static GPS sessions performed by Draper Aden Associates personnel.  
3.) This survey was prepared without the benefit of a title commitment or title report and all easements and encumbrances that might be disclosed in a title search may not be shown.  
4.) Utilities shown are based upon:  
\_\_\_\_ SUE Quality Level D, ASCE 38-02 -- compiled records only  
\_\_\_\_ SUE Quality Level C, ASCE 38-02 -- visible evidence in conjunction with compiled records.  
\_\_\_\_ SUE Quality Level B, ASCE 38-02 -- field designation of underground utilities performed by (Miss Utility, Ticket # A719500619.) and visible evidence in conjunction with compiled records.  
\_\_\_\_ SUE Quality Level A, ASCE 38-02 -- test pits at locations shown hereon performed by (DAA; Other) in conjunction with field designation of underground utilities performed by (DAA; Miss Utility, Ticket # \_\_\_\_\_; Other), visible evidence and compiled records.  
\_\_\_\_ No SUE was performed or requested for this survey. Utilities shown hereon are based on field observation only.  
5.) This topographic survey along Oakland Boulevard was completed under the direct and responsible charge of Loren W. Knighting from an actual Ground survey made under my supervision; that the imagery and/or original data was obtained on the weeks of July 24 and 31, 2017; and that this plot and/or map meets minimum accuracy standards unless otherwise noted.  
6.) Contour interval: 1'.  
7.) This survey was prepared for Western Virginia Water Authority, Draper Aden Associates assumes no liability for reuse or modification of this document.  
8.) Property lines shown hereon are compiled from record information.  
9.) Draper Aden Associates provides benchmarks for the construction of the improvements shown on these plans. All other existing elevations are for reference to existing conditions only. Do not use spot elevations, finish floor elevations, elevations on manholes, elevations on survey nails, survey hubs, control points (horizontal points provided) or any other points for construction other than the provided benchmarks. Failure to utilize and verify the provided benchmarks could result in damages and additional cost that are the contractor's responsibility.

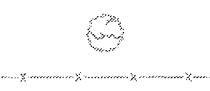
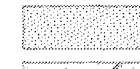
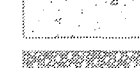
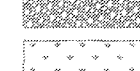
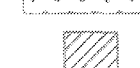
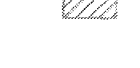
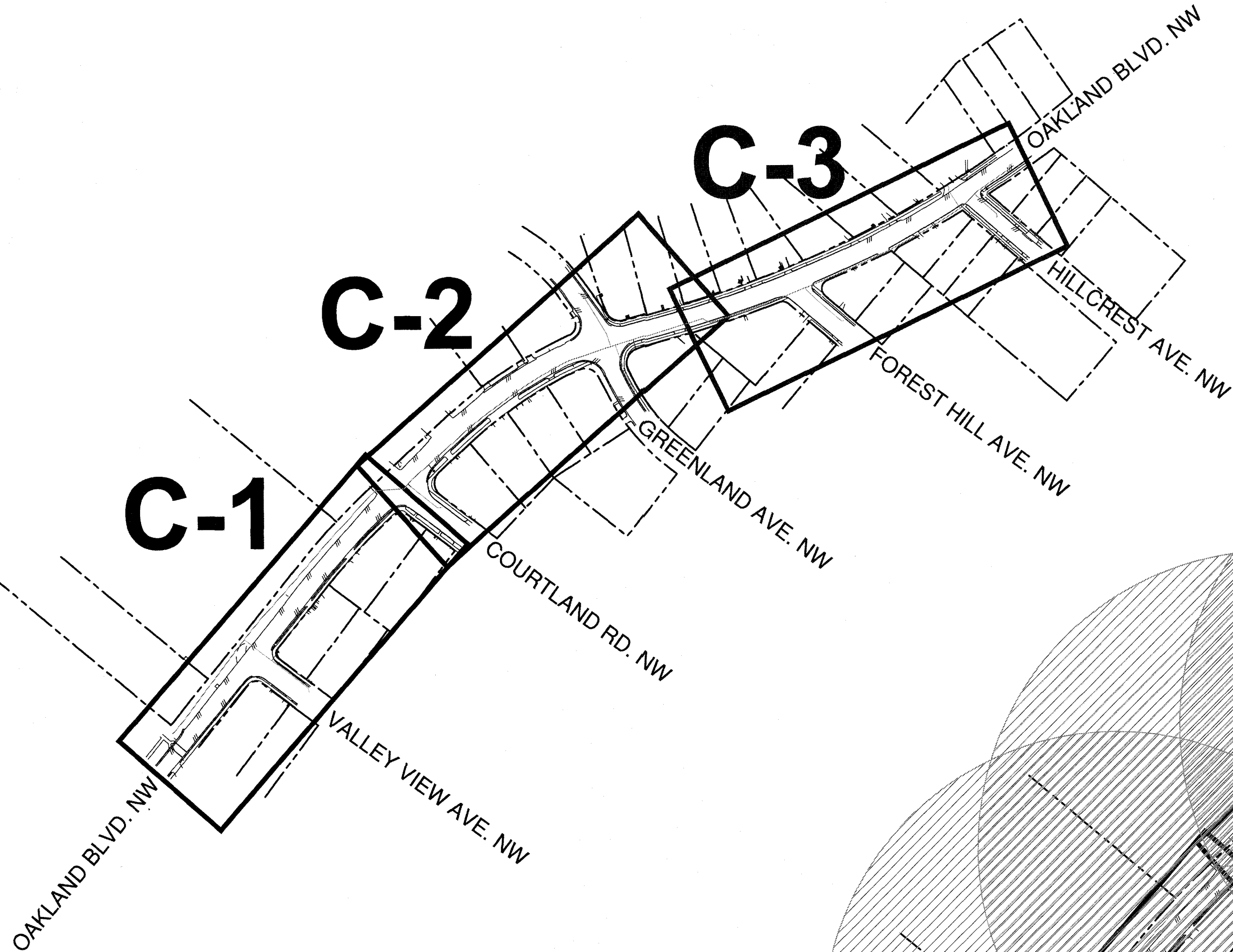

KEY SHEET INDEX

HYDRANT COVERAGE:

500 FT. - RESIDENTIAL

FIRE HYDRANT  
COVERAGE MAP

KEY SHEET & LEGEND

OAKLAND BLVD. WATER MAIN  
REPLACEMENT

ROANOKE, VIRGINIA

REVISIONS

|                 |           |
|-----------------|-----------|
| AW              | BSC       |
| ED              |           |
| SCALE:          | 1" = 150' |
| DATE:           | 2/6/2018  |
| PROJECT NUMBER: |           |

T-3

**Draper Aden Associates**  
Engineers  
Environmental Services  
2206 South Main Street  
Roanoke, VA 24060  
Phone: 540-552-0444 Fax: 540-552-0291  
www.daa.com

• Raleigh, NC  
• Richmond, VA  
• Charlottesville, VA  
• Hampton Roads, VA  
• Northern Virginia