

BENCHMARK:
CITY OF ROANOKE BRASS DISK "SPANKY", LOCATED
AT THE WESTERN CORNER OF THE INTERSECTION
OF GRANDIN RD. AND BRANDON AVE.
ELEVATION = 1046.29

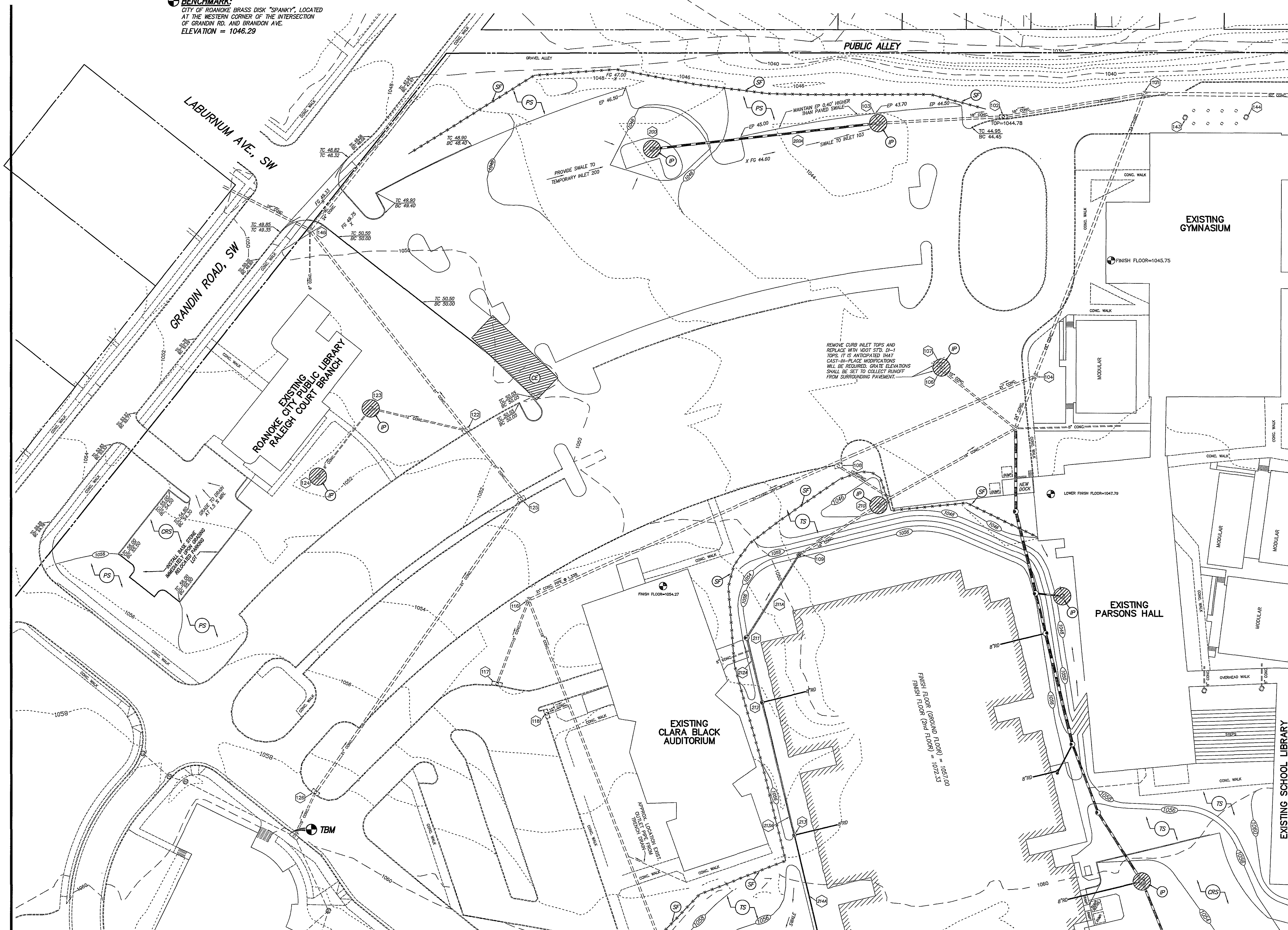

TEMPORARY BENCHMARK:
CHISELED SQUARE ON NORTHWEST CORNER OF
EXISTING CURB INLET, LOCATED IN FRONT OF
THE GOVERNOR'S SCHOOL.
ELEVATION = 1059.98

SOIL EROSION CONTROL MEASURES

- SILT FENCE BARRIER**
A SILT FENCE BARRIER SHALL BE PLACED BELOW ALL DENuded AREAS AS SHOWN ON THIS SECTION (SEE PLANS). THIS BARRIER SHALL BE INSPECTED AFTER EACH RUNOFF PRODUCING RAINFALL, AND SHALL BE CLEANED, REPAIRED, OR REPLACED AS REQUIRED.
- CONSTRUCTION ENTRANCE**
STONE CONSTRUCTION ENTRANCES SHALL BE PROVIDED OF EXISTING PAVEMENT (SEE PLANS). THESE ENTRANCES SHALL BE MAINTAINED SUCH THAT TRACKING OF MUD AND DIRT ONTO THE PAVED SURFACE IS HELD AT AN ABSOLUTE MINIMUM.
- INLET PROTECTION**
ALL NEW AND EXISTING INLET STRUCTURES SHALL RECEIVE INLET PROTECTIVE MEASURES TO MINIMIZE INFILTRATION OF SEDIMENT INTO THE STORM DRAIN SYSTEM, AND ULTIMATELY THE RECEIVING CHANNELS.
- CONSTRUCTION ROAD STABILIZATION**
UPON REACHING SUBGRADE ELEVATIONS OF THE NEW PARKING AND DRIVE AREAS, THE CONTRACTOR SHALL PROVIDE AND INSTALL A MINIMUM OF 6" OF VDOT ST. 21-B AGGREGATE TO STABILIZE TRAFFIC AREAS. ADDITIONAL STONE SHALL BE PROVIDED AS REQUIRED TO CONTROL RILL EROSION WITHIN THE AREAS TO RECEIVE BITUMINOUS PAVEMENT.
- TEMPORARY SEEDING**
TEMPORARY SEEDING SHALL BE PROVIDED ON DISTURBED AREAS AS REQUIRED BY THE TEMPORARY SEEDING SECTION OF SHEET C1-400 OF THESE PLANS.

- (TSE) TEMPORARY SEDIMENT BASIN** **(ST) TEMPORARY SEDIMENT TRAPS**
SEE THE CONSTRUCTION SELECTION SECTION OF SHEET C1-400 FOR INSTRUCTIONS ON PLACEMENT AND SERVICE LIVES OF THESE SEDIMENT TRAPPING DEVICES.

PERMANENT SEEDING
ALL DENUDED AREAS NOT TO RECEIVE HARD SURFACING SHALL BE PERMANENTLY SEEDED WITHIN SEVEN DAYS OF FINAL GRADING OPERATIONS.
ALL SLOPES STEEPER THAN 3:1 V/H SHALL RECEIVE TYPE B SEEDING MIXTURE (LOW MAINTENANCE), AS SPECIFIED WITHIN THESE PLANS.
SEE "PERMANENT SEEDING" REQUIREMENTS, SHEET C1-400 FOR COORDINATION OF SEEDING AREAS WITH FEATURES WITH THE LANDSCAPING PLANS PREPARED BY OTHERS.

(SR) SURFACE ROUGHENING
SLOPES AT 3:1 V/H OR STEEPER SHALL BE ROUGHENED BY TRACKED EQUIPMENT, IN ORDER TO PROVIDE RIDGES PERPENDICULAR TO THE FLOW OF RUNOFF; THIS MEASURE IS REQUIRED TO AID IN SEED GERMINATION AND TO REDUCE OVERSLOP LAND FLOW VELOCITIES.

(RR) RIP-RAP EROSION CONTROL STONE
AS INDICATED HEREON, THE CONTRACTOR SHALL PLACE VDOT CLASS II (AS NOTED) TYPE B RIP-RAP AND 18" MINIMUM DRAINAGE UNDERLayment. EROSION CONTROL STONE SHALL BE INSTALLED IN STRIP, ACCORDANCE WITH VDOT STD. EC-1.

SHEETS C1-120 THROUGH C1-123 ARE FOR SOIL EROSION CONTROL PURPOSES ONLY. SEE REMAINING SHEETS FOR PLACEMENT OF NEW IMPROVEMENTS.

SEE SHEET C1-400 FOR CONSTRUCTION SEQUENCING REQUIREMENTS.

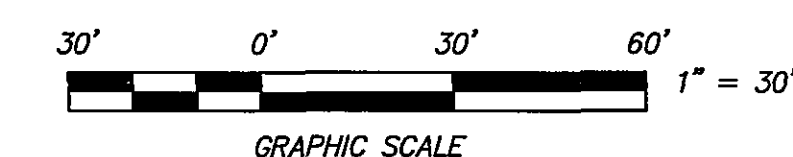

 **CWA**
CALDWELL WHITE ASSOCIATES
ENGINEERS / SURVEYORS / PLANNERS

4203 MELROSE AVENUE
P.O. BOX 6260
ROANOKE, VIRGINIA 24017-0260
(540) 366-3407
FAX: (540) 366-8702

CWA HQ: 02-0005 NR: Roanoke City Sch.

P E R K I N S
& W I L L

Architecture . Interiors . Planning
404.873-2300 fax:404.892.5823
1382 Peachtree Street Atlanta Georgia 30309
Boston . Charlotte/RTP . Chicago . Dallas
Los Angeles . Miami . Minneapolis . New York

Rife + Wood
ARCHITECTS
1326 Grandin Road Roanoke, Virginia 24015
(540) 344-6015 fax: (540) 344-5982

In association with:

Caldwell White - Civil Engineers
4203 Melrose Avenue
Roanoke, Virginia 24017
540-366-3400 (p) 540-366-8702 (f)

The Fitch Studio

1740 20th Street, NW
Washington, DC 20009
202-588-0148 (p) 202-588-0149 (f)

**Kinsey Shane & Associates - Architects and
Structural Engineers**

201 West Main Street
Salem, Virginia 24153
540-389-8655 (p) 540-389-9130 (f)

Lawrence Perry & Associates, Inc
Mechanical & Electrical Engineers

30A West Church Avenue
Roanoke, Virginia 24011
540-342-1816 (p) 540-344-3410 (f)

Faassen & Associates - Food Service
8526 Sunflower Drive
Charlotte, North Carolina

Charlotte, North Carolina
204-536-9234 (f)

vanBlaricom & Frantz - Interior Designers
112 West Kirk Avenue
Roanoke, Virginia 24015
540-344-4098 (p) 540-344-4295 (f)

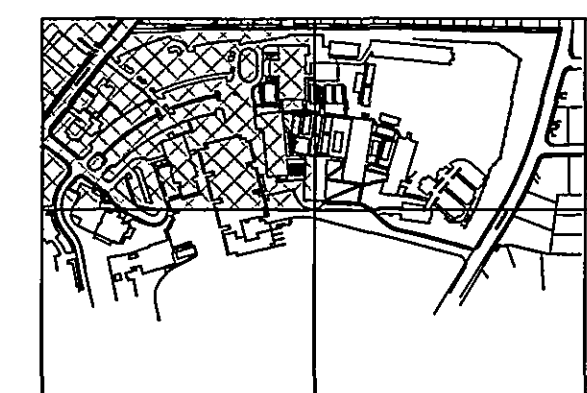

**PATRICK HENRY
HIGH SCHOOL**

PHASE I
School Site Project No. 124-39
Literary Loan No. 11187

[illegible]

ISSUED FOR CONSTRUCTION	04/02/04
-------------------------	----------

NUMBER	ISSUE	DATE
--------	-------	------

Revisions

Copyright © 2004 PERKINS & WILL

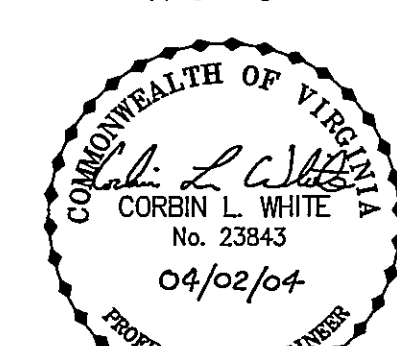

Sheet Information

Date	04/02/04
Job Number	800200.000
Scale	1" = 30'
Drawn	C.L. White
Checked	
Approved	

Title

SOIL EROSION
CONTROL PLAN -
PHASES 1A
THROUGH 1C

Sheet

C1-120