

- LIST OF MATERIALS**
- 1 12" TAPPING SLEEVE
 - 2 12" VALVES
 - 1 12"x12"x12" TEE
 - 2 12"x12"x8" TEE
 - 1600'± 12" WATER MAIN
 - 2 6" METERS

DATE STARTED	6-8-99
DATE COMP.	7-9-99
FEET MAIN	1698'
SIZE VALVE	12"
VAULT BOX	2
F.H. COMP.	
F.H. STUB ONLY	
SERV. INS. BY:	U.L.F.
MAIN INS. BY:	U.L.F.
NO. 3/4" SERV. INS.	
CITY OR CO.	
DEPT. INSP.	J.W.M.

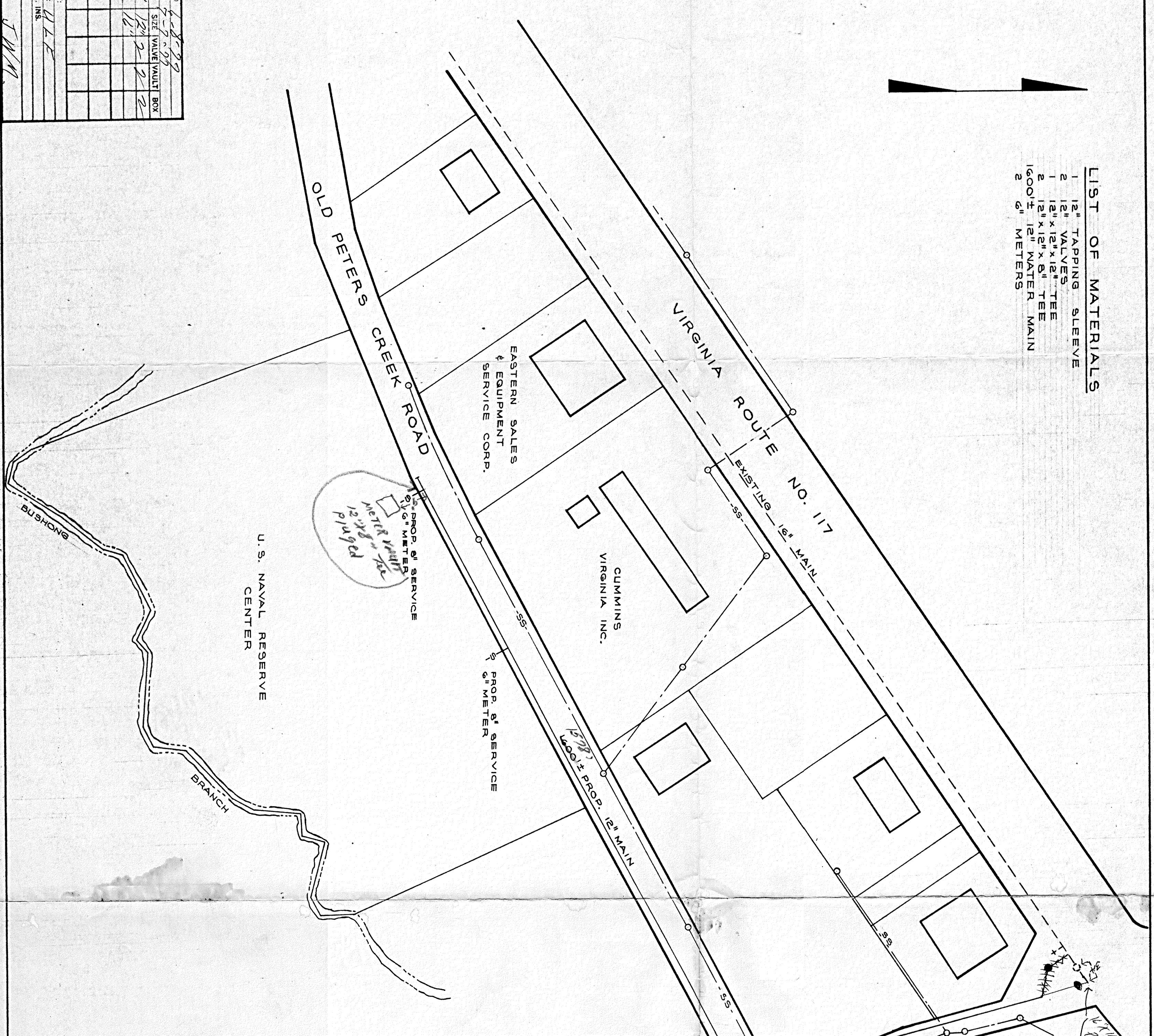

NOTE:
AT CROSSINGS OF P.S.A. LINE AND
PROPOSED WATER MAIN A MINIMUM
OF 18" CLEARANCE MUST BE
MAINTAINED AND NOTED FOR AS
BUILT DRAWINGS.

NOTE:
LOCATION OF EXISTING UTILITIES
TO BE ASCERTAINED IN FIELD
PRIOR TO CONSTRUCTION.

WATER DEPARTMENT
CITY OF ROANOKE, VA.
OLD PETERS CREEK ROAD
SCALE: 1"=100'
DRAWN BY LBV AUG. 27, 1976

8/30/76
DIRECTOR UTILITIES & OPERATIONS
8-31-76
CITY ENGINEER OF ROANOKE, VA.
9/30/76
ENGINEER OF PUBLIC WORKS
9/1/76
AGENT FOR ROANOKE PLANNING COMM.