

# PETERS CREEK SEWER ABANDONMENT

## INDEX MAP

## SHEET INDEX

THIS PROJECT IS EXEMPT FROM EROSION AND SEDIMENT CONTROL PLAN REQUIREMENTS PURSUANT ARTICLES § 62.1-44.15:51 & § 62.1-44.15:55 OF THE CODE OF VIRGINIA.

EROSION AND SEDIMENT CONTROL MEASURES:  
UNLESS OTHERWISE INDICATED, ALL VEGETATIVE AND STRUCTURAL EROSION AND SEDIMENT CONTROL PRACTICES SHALL BE CONSTRUCTED & MAINTAINED ACCORDING TO MINIMUM STANDARDS AND SPECIFICATIONS OF THE "VIRGINIA EROSION AND SEDIMENT CONTROL HANDBOOK, THIRD EDITION" (VESCH). THE MINIMUM STANDARDS OF THE VESCH SHALL BE ADHERED TO UNLESS OTHERWISE DIRECTED BY THE LOCAL PROGRAM ADMINISTRATOR.

### STRUCTURAL —

SILT FENCE—STD. 3.05: A TEMPORARY SEDIMENT BARRIER CONSTRUCTED OF POSTS, FILTER FABRIC AND IN SOME CASES WIRE SUPPORT FENCE TO INTERCEPT AND DETAIN SEDIMENT.

CULVERT INLET PROTECTION— SHALL BE INSTALLED AS SHOWN ON THE EROSION AND SEDIMENT CONTROL PLAN IN CONFORMANCE WITH STD. & SPEC. 3.08 OR WYVA AS&S. CULVERT INLET PROTECTIONS ARE PROVIDED IN ORDER TO FILTER RUNOFF BEFORE IT ENTERS A STORM DRAINAGE SYSTEM.

### VEGETATIVE —

PERMANENT SEEDING—STD. 3.32: ESTABLISHMENT OF PERENNIAL VEGETATIVE COVER BY PLANTING SEED IN AREAS WHERE PERMANENT, LONG-LIVED VEGETATIVE COVER IS NEEDED TO STABILIZE THE SOIL AND IN ROUGH GRADED AREAS WHICH WILL NOT BE BROUGHT TO FINAL GRADE FOR A YEAR OR MORE.

TEMPORARY SEEDING—STD. 3.31: ESTABLISHMENT OF TEMPORARY VEGETATIVE COVER BY SEEDING WHERE EXPOSED SOIL SURFACES WILL NOT BE AT FINAL GRADE FOR MORE THAN 14 DAYS.

### MANAGEMENT STRATEGIES:

- CONSTRUCTION SHALL BE SEQUENCED SO THAT GRADING OPERATIONS CAN BEGIN AND END AS QUICKLY AS POSSIBLE.
- SEDIMENT TRAPPING MEASURES WILL BE INSTALLED AS A FIRST STEP IN GRADING.
- THE LOCAL PROGRAM ADMINISTRATOR RESERVES THE RIGHT TO ADD TO, DELETE OR OTHERWISE CHANGE THE EROSION CONTROL MEASURES AS DEEMED NECESSARY DUE TO ACTUAL FIELD CONDITIONS BY WRITTEN NOTIFICATION TO THE CONTRACTOR.
- ALL CUT AND FILL SLOPES SHALL BE SEEDDED WITHIN SEVEN (7) DAYS OF ACHIEVING FINAL GRADE.
- ONLY AFTER INSPECTION AND APPROVAL FROM THE LOCAL PROGRAM ADMINISTRATOR MAY ITEMS BE REMOVED FOLLOWING THE STABILIZATION OF THE CONTRIBUTING AREAS.

### EROSION AND SEDIMENT CONTROL MEASURES:

- |    |                          |                           |
|----|--------------------------|---------------------------|
| SF | SILT FENCE               | VA ESCH STD. & SPEC. 3.05 |
| CP | CULVERT INLET PROTECTION | VA ESCH STD. & SPEC. 3.08 |
| PS | PERMANENT SEEDING        | VA ESCH STD & SPEC 3.32   |
| TS | TEMPORARY SEEDING        | VA ESCH STD & SPEC 3.31   |

THIS PLAN IS EXEMPT FROM LICENSE REQUIREMENTS PURSUANT ARTICLE § 54.1-402 OF THE CODE OF VIRGINIA.

THIS PLAN WAS PREPARED & DESIGNED BY:

DEREK R. JONES  
DESIGN MANAGER  
601 S. JEFFERSON STREET, ROANOKE, VA 24011

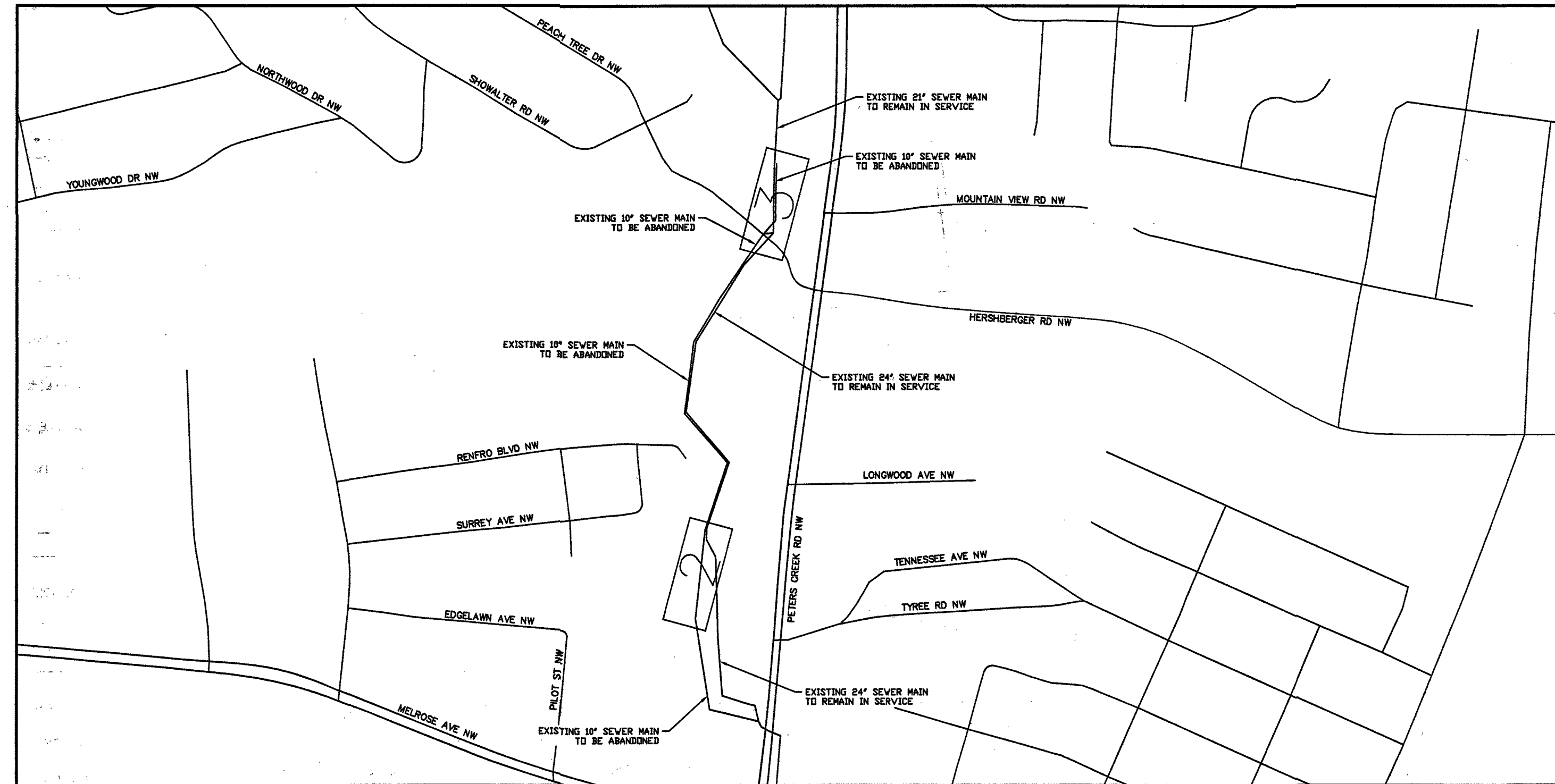

### GENERAL NOTES:

- ALL CONSTRUCTION METHODS AND MATERIALS SHALL CONFORM TO THE LATEST EDITION OF THE DESIGN AND CONSTRUCTION STANDARDS AND SPECIFICATIONS OF THE WESTERN VIRGINIA WATER AUTHORITY (WVWA) AVAILABLE AT WWW.WESTERNVAVATER.ORG OR BY CONTACTING THE AUTHORITY AT 540-853-5700. THE PROJECT SHALL ALSO COMPLY WITH THE GOVERNING JURISDICTION'S STANDARDS AND OTHER AGENCY STANDARDS (E.G., VDOT, DEQ, DCR, VDH, ETC.) WHERE APPLICABLE.
- WHILE NOT REQUIRED ON ALL WVWA PROJECTS, "WATER SERVICE AND METER REPLACEMENT" SHOULD BE DISCUSSED PRIOR TO CONSTRUCTION. THE AUTHORITY WILL INSTALL ALL NEW WATER METERS AND REMOVE ALL EXISTING WATER METERS. THE CONTRACTOR SHALL INSTALL COMPLETE NEW WATER SERVICES INCLUDING THE METER SETTER AND BOX IN CONFORMANCE WITH THE AUTHORITY'S STANDARDS. FOLLOWING METER REPLACEMENT BY THE AUTHORITY, THE CONTRACTOR SHALL DEMOLISH THE EXISTING WATER METER SETTER AND BOX. THE CONTRACTOR SHALL COORDINATE EXISTING METER REMOVAL AND NEW METER INSTALLATION DIRECTLY WITH THE AUTHORITY. THE CONTRACTOR SHALL PROVIDE AT LEAST THREE (3) BUSINESS DAYS ADVANCE NOTICE TO THE AUTHORITY PRIOR TO NEEDING METER INSTALLATIONS. THE CONTRACTOR SHALL SEQUENCE CONSTRUCTION ACTIVITY TO RECEIVE NEW METERS BEFORE CONTACTING THE AUTHORITY FOR WATER METER REPLACEMENT.
- ALL CONNECTIONS TO EXISTING WATERLINES SHALL BE PERFORMED BY THE WVWA. THE CONTRACTOR SHALL PROVIDE FULL STAINLESS STEEL TAPPING SLEEVE(S) AND VALVE(S). THE CONTRACTOR SHALL EXCAVATE TO THE EXISTING WATERLINE, SHORE THE TRENCH PER OSHA REQUIREMENTS, CLEAN THE EXISTING WATERLINE, AND INSTALL THE TAPPING SLEEVE AND VALVE PRIOR TO THE AUTHORITY PERFORMING THE TAP. THE CONTRACTOR SHALL NOTIFY THE WVWA INSPECTOR AT LEAST SEVENTY-TWO (72) HOURS PRIOR TO REQUIRING THE CONNECTION.
- ALL CONNECTIONS TO EXISTING SANITARY SEWERLINES SHALL BE PERFORMED BY THE AUTHORITY. THE CONTRACTOR SHALL EXCAVATE TO THE EXISTING SEWERLINE, SHORE THE TRENCH PER OSHA REQUIREMENTS, AND CLEAN THE EXISTING SEWERLINE PRIOR TO THE AUTHORITY PERFORMING THE TAP. THE CONTRACTOR SHALL NOTIFY THE WVWA INSPECTOR AT LEAST SEVENTY-TWO (72) HOURS PRIOR TO REQUIRING THE CONNECTION.
- THE CONTRACTOR SHALL PERFORM ALL MANHOLE CONNECTIONS. THE CORING AND BOOT INSTALLATION SHALL BE INSPECTED AND APPROVED BY AN AUTHORITY CONSTRUCTION INSPECTOR PRIOR TO ACTIVATING SEWER SERVICE. THE CONTRACTOR SHALL CONTACT THE AUTHORITY'S CONSTRUCTION INSPECTOR RESPONSIBLE FOR THE PROJECT AT LEAST ONE (1) DAY PRIOR TO INITIATING THE MANHOLE CONNECTION.
- PRIOR TO CONSTRUCTION IN THE RIGHT-OF-WAY, ALL APPLICABLE PERMIT(S) FROM THE GOVERNING JURISDICTION AND/OR AGENCY MUST BE OBTAINED AND A COPY KEPT ON THE PROJECT SITE.
- FOR PROJECTS REQUIRING TRAFFIC CONTROL IN THE CITY OF ROANOKE, NOTIFY MANAGER OF TRANSPORTATION, MARK JAMISON, AT 540-853-5471 AT LEAST TWO WEEKS IN ADVANCE OF REQUIRING TRAFFIC CONTROL. FOR A LANE CLOSURE PERMIT IN THE CITY OF ROANOKE, CONTACT THE TRAFFIC ENGINEER, HONG LIU, AT 540-853-2686. IN ROANOKE, BOTETOURT OR FRANKLIN COUNTIES, TRAFFIC CONTROL REQUIREMENTS ARE APPROVED BY VDOT, PLEASE CONTACT THE LOCAL VDOT OFFICE FOR ADDITIONAL REQUIREMENTS. TRAFFIC CONTROL SHALL BE PROVIDED IN ACCORDANCE WITH THE MOST RECENT MUTCD MANUAL AND THE VDOT WORK AREA PROTECTION MANUAL UNLESS OTHERWISE SPECIFIED BY THE CITY.
- THE CONTRACTOR SHALL NOTIFY THE WVWA ENGINEERING COORDINATOR, MARK SINK, AT 540-537-3460 AT LEAST THREE (3) DAYS PRIOR TO CONSTRUCTION.
- A PRE-CONSTRUCTION CONFERENCE SHALL BE SCHEDULED AT LEAST ONE (1) DAY PRIOR TO ANY CONSTRUCTION.
- THE CONTRACTOR SHALL HAVE A VALID MISS UTILITY TICKET PRIOR TO EXCAVATION. CONTACT MISS UTILITY AT 1-800-552-7001.
- ALL EXISTING UTILITIES MAY NOT BE SHOWN OR MAY NOT BE SHOWN IN THEIR EXACT LOCATION. CONTRACTOR SHALL LOCATE ALL UTILITIES AND DETERMINE ALL INVERTS PRIOR TO CONSTRUCTION TO ALLOW FOR ADJUSTMENTS DUE TO CONFLICTS WITH OTHER UTILITIES. THE CONTRACTOR SHALL COMPLY WITH THE VIRGINIA STATE WATER WORKS REGULATIONS, SECTION 12VAC5-590-1150, AND THE VIRGINIA STATE SEWAGE COLLECTION AND TREATMENT REGULATIONS WHERE LINES CROSS.
- AN APPROVED SET OF PLANS AND PERMITS MUST BE AVAILABLE AT THE CONSTRUCTION SITE AT ALL TIMES.
- CONSTRUCTION DEBRIS SHALL BE CONTAINERIZED IN ACCORDANCE WITH THE VIRGINIA LITTER CONTROL ACT.
- THE CONTRACTOR'S CERTIFIED RESPONSIBLE LAND DISTURBER SHALL BE RESPONSIBLE TO IMPLEMENT ALL EROSION & SEDIMENT CONTROLS REQUIRED. ALL EROSION AND SEDIMENT CONTROL MEASURES MUST BE IN ACCORDANCE WITH THE LATEST EDITION OF THE VIRGINIA EROSION AND SEDIMENT CONTROL HANDBOOK AND SHALL BE INSTALLED PRIOR TO CONSTRUCTION. THE WVWA MAY REQUIRE CHANGES TO AN APPROVED PLAN IN THE FOLLOWING CASES WHERE INSPECTION HAS REVEALED THAT THE PLAN IS INADEQUATE TO SATISFY APPLICABLE REGULATIONS.
- THE CONTRACTOR SHALL PROVIDE ADEQUATE MEANS OF CLEANING ALL VEHICLES AND EQUIPMENT PRIOR TO ENTERING PUBLIC STREETS. IT IS THE CONTRACTOR'S RESPONSIBILITY TO ENSURE THAT THE STREETS ARE KEPT IN A CLEAN, MUD- AND DUST-FREE CONDITION AT ALL TIMES.
- FIELD CHANGES SHALL BE APPROVED BY THE AUTHORITY'S ENGINEERING DIVISION PRIOR TO SUCH CONSTRUCTION. NO ADDITIONAL PAYMENTS SHALL BE MADE TO CONTRACTOR FOR WORK PERFORMED WITHOUT PRIOR APPROVAL FROM AUTHORITY'S PROJECT MANAGER.
- THE CONTRACTOR SHALL MAKE PROVISIONS TO PROVIDE ACCESS TO ALL PROPERTIES DURING CONSTRUCTION AND SHALL MAINTAIN SAFE ACCESSIBILITY TO FIRE HYDRANTS AT ALL TIMES.
- THE CONTRACTOR SHALL BE RESPONSIBLE FOR LOCATING AND UNCOVERING ALL MANHOLES AFTER PAVING. MANHOLE RIMS SHALL BE INSTALLED TO GRADE AND FLUSH WITH THE FINAL PAVEMENT.
- UNREPAIRED ROADWAYS OPENED TO TRAFFIC SHALL HAVE, AT A MINIMUM, COMPACTED AGGREGATE MATERIAL VDOT 21A OR 21B FLUSH WITH THE ADJACENT ROADWAY SURFACE AND SHALL BE INSPECTED AND REPAIRED ON A DAILY BASIS. SOME AREAS MAY REQUIRE A TEMPORARY PATCH UNTIL FINAL PAVING CAN BE COMPLETED.
- THE CONTRACTOR SHALL NOT EXCAVATE MORE TRENCH LENGTH THAN CAN BE RESTORED WITHIN THE SAME WORK DAY. ALL TRENCHES SHALL BE BACKFILLED OR PLATED AT THE END OF EACH WORK DAY OR WHEN THE CONTRACTOR IS NOT ON SITE.
- THE CONTRACTOR SHALL SUPPLY THE AUTHORITY WITH CORRECT AS-BUILT PLANS BEFORE SUBSTANTIAL COMPLETION WILL BE GRANTED.
- HORIZONTAL & VERTICAL BENDS SHOWN IN THE PLAN ARE APPROXIMATE. CONTRACTOR TO BE AWARE THAT ALL HORIZONTAL AND/OR VERTICAL BEND FITTINGS MAY NOT BE SHOWN IN THE PLANS.

1 COVER SHEET	
2-3 PLAN & PROFILE	
LEGEND (EXISTING)	
WATER/FORCEMAIN	STORM
VALVE	DROP INLET
AIR RELEASE	LARGE CURB INLET
BLOW-OFF/ FLUSHING ASSEMBLY	SMALL CURB INLET
SINGLE METER BOX	MANHOLE
DOUBLE METER BOX	
FIRE HYDRANT	
WELL	
SEWER	OTHER
MANHOLE	POWER POLE
CLEAN OUT	POWER POLE WITH GUY WIRE
GAS VALVE	LAMP POST
UTILITY PEDESTAL	TRAFFIC POLE
MAILBOX	SIGN

Contractor	CIP 2
Construction Start Date	8-22-19
Completion Date	12-5-19
Sewer Gravity Main(s)	
Manufacturer	DIAMOND
Diameter	8" SDR 35
Pipe Class	SDR 35
Material	PLASTIC
Comments	
Sewer Gravity Lateral(s)	
Manufacturer	DIAMOND
Diameter	6"
Pipe Class	SDR 26
Material	PLASTIC
Comments	
Sewer Manhole(s)	
Manufacturer	HARCO
Material	PLASTIC
Ring & Cover Manuf.	
Cover Type	
Comments	WE USED C/O'S, INSTEAD OF M/H'S

WESTERN VIRGINIA WATER AUTHORITY		ENGINEERING SERVICES 601 S JEFFERSON ST, SUITE 300 ROANOKE, VA 24011 540-853-5700	
PETERS CREEK SEWER ABANDONMENT		COVER	
By	Date	Description	Rev
TB	8-22-19	START	
TB	12-5-19	COMPLETE	
		CIP 2 - TAP & BENCH ADJUSTS	
Designed: DRJ			
Drawn: AJC			
Checked: NSS, AJC			
Approved: TEC			
Date: AUGUST 2019			
Project: SCIP-239			
1			
Sheet 1 of 3			