

16218comp-15-ec02.plt

w:\drawings\2016\16218\eng\16218comp.dwg

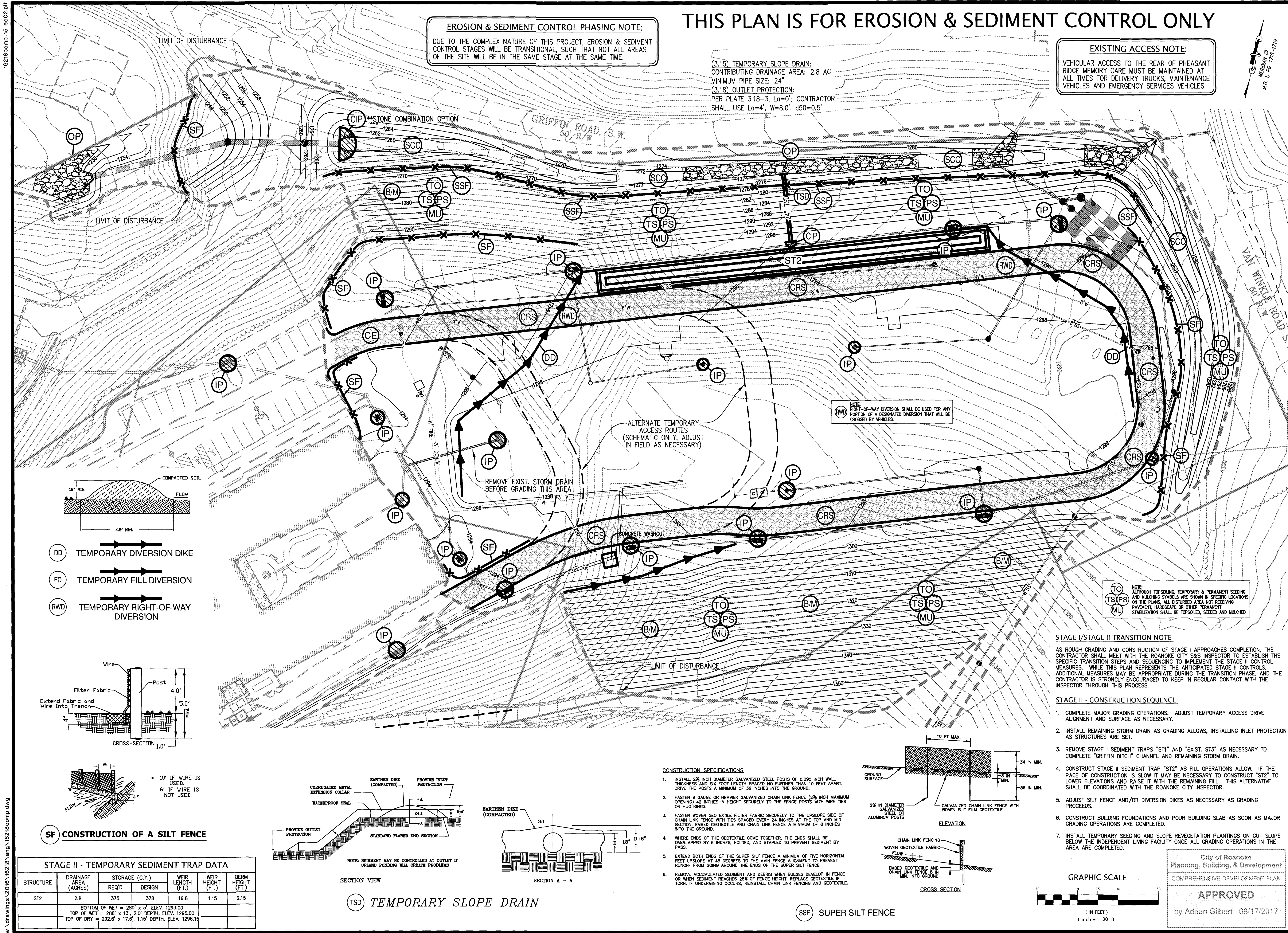

LUMSDEN ASSOCIATES, P.C.
ENGINEERS/SURVEYORS-PLANNERS
ROANOKE, VIRGINIA

PHONE: (540) 774-4411
FAX: (540) 772-9445
E-MAIL: MAIL@LUMSDENPC.COM

4664 BRAMBLETON AVENUE
P.O. BOX 20669
ROANOKE, VIRGINIA 24018

COMMONWEALTH OF VIRGINIA
HOWARD P. BOGGS
Lic. No. 000920
6/23/17
LANDSCAPE ARCHITECT

COMPREHENSIVE DEVELOPMENT PLAN FOR
PHEASANT RIDGE ASSISTED LIVING
PREPARED FOR
SMITH/PACKETT MED-COM, L.L.C.
SITUATED AT 4414 PHEASANT RIDGE ROAD, SW
CITY OF ROANOKE, VIRGINIA

DATE: June 23, 2017
SCALE: 1" = 30'
COMMISSION NO.: 16-218
SHEET 15 OF 19