

CONSTRUCTION SEQUENCING NOTES:

1. THE STORM WATER POLLUTION PREVENTION PLAN (SWPPP) SHALL BE PROVIDED ON-SITE AND ALL REGULATIONS, INSPECTIONS, AND PROCEDURES FOLLOWED FOR THE ENTIRE DURATION OF THE PROJECT. SEE SWPPP DOCUMENT FOR SITE SPECIFIC REQUIREMENTS AND INSPECTIONS.
2. THE CONSTRUCTION ENTRANCE SHALL BE INSTALLED AS A FIRST STEP AT THE PROPOSED ENTRANCE LOCATION. THE CONSTRUCTION ENTRANCE SHALL BE MAINTAINED THROUGHOUT THE DURATION OF THE PROJECT. G.C. SHALL PAY SPECIAL ATTENTION TO ENSURE SEDIMENT LADEN RUNOFF IS NOT DIRECTED TOWARDS THE ADJACENT PUBLIC RIGHT OF WAY AND THERE SHALL BE NO MUD 'TRACKING' FROM THE SITE INTO THE PUBLIC RIGHT OF WAY.
3. G.C. SHALL UTILIZE THE EXISTING ENTRANCE FROM CAMPBELL AVENUE DURING INITIAL CONSTRUCTION OPERATIONS FOR ACCESS. ASPHALT/GRAVEL BASE SHALL BE MAINTAINED DURING THIS TIME AND UTILIZED FOR ACCESS UNTIL SUCH TIME THAT THE BUILDING CONSTRUCTION BEGINS. NO GRADING SHALL OCCUR AT THIS TIME. ONCE GRADING OPERATION BEGINS, ALL ACCESS SHALL BE FROM THE NORFOLK AVENUE CONSTRUCTION ENTRANCE ACCESS POINT.
4. SILT FENCE TO BE INSTALLED AS SHOWN PRIOR TO ANY LAND DISTURBANCE. THE SILT FENCE SHALL BE MAINTAINED THROUGHOUT THE DURATION OF THE PROJECT. SILT FENCE SHALL BE CHECKED AFTER EACH MEASURABLE RAIN EVENT AS REQUIRED BY THE EROSION AND SEDIMENT CONTROL HANDBOOK. THE R.L.D. ASSIGNED TO THE PROJECT SHALL ENSURE ALL REGULATIONS ARE FOLLOWED AND DOCUMENTED THROUGHOUT THE ENTIRE PROJECT TO PREVENT THE EXCESSIVE BUILD-UP OF SEDIMENT. ALL BUILT UP SEDIMENT SHALL BE REMOVED AND PROPERTY DISPOSED OFF.
5. SAFETY FENCE INSTALLED AROUND SITE AS CONSTRUCTION PROGRESSES AND APPLICABLE TO MEET ALL OSHA REQUIREMENTS.
6. INLET PROTECTION SHALL BE APPLIED TO THE APPLICABLE INLETS. THE EXISTING INLET ON NORFOLK AVENUE SHALL BE SEDIMENT PROTECTION DURING THE CONSTRUCTION PROJECT UNTIL SUCH TIME THAT THE SITE IS STABILIZED AND THE CITY OF ROANOKE HAS APPROVED THE REMOVAL OF THE INLET PROTECTION.

ALL PROPOSED INLETS SHALL BE PROTECTED FROM SEDIMENT AS SOON AS INSTALLATION OF EACH STRUCTURE IS COMPLETE TO ENSURE SEDIMENT DOES NOT GET TRANSPORTED THROUGH THE CONNECTED PIPE SYSTEMS.
7. DEMOLITION OPERATIONS SHALL OCCUR AT THIS TIME FOR THE EXISTING PAVEMENTS AND UTILITIES.
8. MAJOR GRADING OPERATIONS SHALL COMMENCE ONCE THE SILT FENCE AND SAFETY FENCE HAVE BEEN INSTALLED. THIS INCLUDES THE GRADING OF THE PARKING LOT, BUILDING PAD, AND ALL OTHER ASSOCIATED GRADING OPERATIONS ON-SITE.
9. BUILDING CONSTRUCTION MAY BEGIN AT THIS TIME.
10. THE CONCRETE WASH OUT SHALL BE UTILIZED IN ACCORDANCE WITH D.E.Q. REGULATIONS DURING CONCRETE OPERATIONS ON SITE.
11. SAFETY FENCE SHALL BE INSTALLED AT THE TOP OF THE RETAINING WALL AND TRANSITIONED AS THE WALL IS CONSTRUCTED.
12. UTILITY INSTALLATION SHALL OCCUR AT THIS TIME INCLUDING STORM SEWER, SANITARY SEWER, WATERLINE, ELECTRIC, GAS, AND COMMUNICATIONS.
13. PAVEMENT, LANDSCAPING ETC. SHALL BE INSTALLED AT THIS TIME.
14. PERMANENT SEEDING AND MULCHING SHALL BE APPLIED AT THIS TIME TO ALL AREAS AT FINAL GRADE. BLANKET MATTING SHALL BE APPLIED TO ANY SLOPES 3:1 OR GREATER.
15. AFTER FINAL SITE STABILIZATION AND ROANOKE CITY APPROVAL, SILT FENCE, INLET PROTECTION, AND THE CONSTRUCTION ENTRANCE CAN BE REMOVED.

*NOTE: ROANOKE CITY INSPECTION AND APPROVAL IS REQUIRED PRIOR TO THE REMOVAL OF EROSION AND SEDIMENT CONTROL MEASURES.
16. G.C. SHALL ENSURE THAT THE LIMITS OF DISTURBANCE ARE STRICTLY ADHERED TO DURING THE PROJECT.
17. NO DEVIATIONS TO THE PLANS SHALL TAKE PLACE UNLESS PRIOR APPROVAL FROM THE OWNER, PROJECT ENGINEER, AND THE APPROPRIATE REVIEW AGENCIES.

E&SC MEASURES

3.01	SAFETY FENCE	SAF
3.02	TEMPORARY STONE CONSTRUCTION ENTRANCE	CE
3.05	SILT FENCE	SF
3.07	STORM DRAIN INLET PROTECTION	IP
3.31	TEMPORARY SEEDING	TS
3.32	PERMANENT SEEDING	PS
3.35	MULCHING	MU
3.36	SOIL STABILIZATION BLANKETS & MATTING	B/M

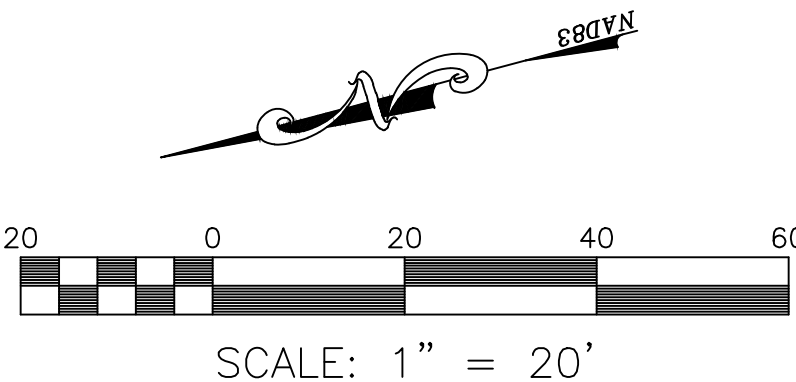
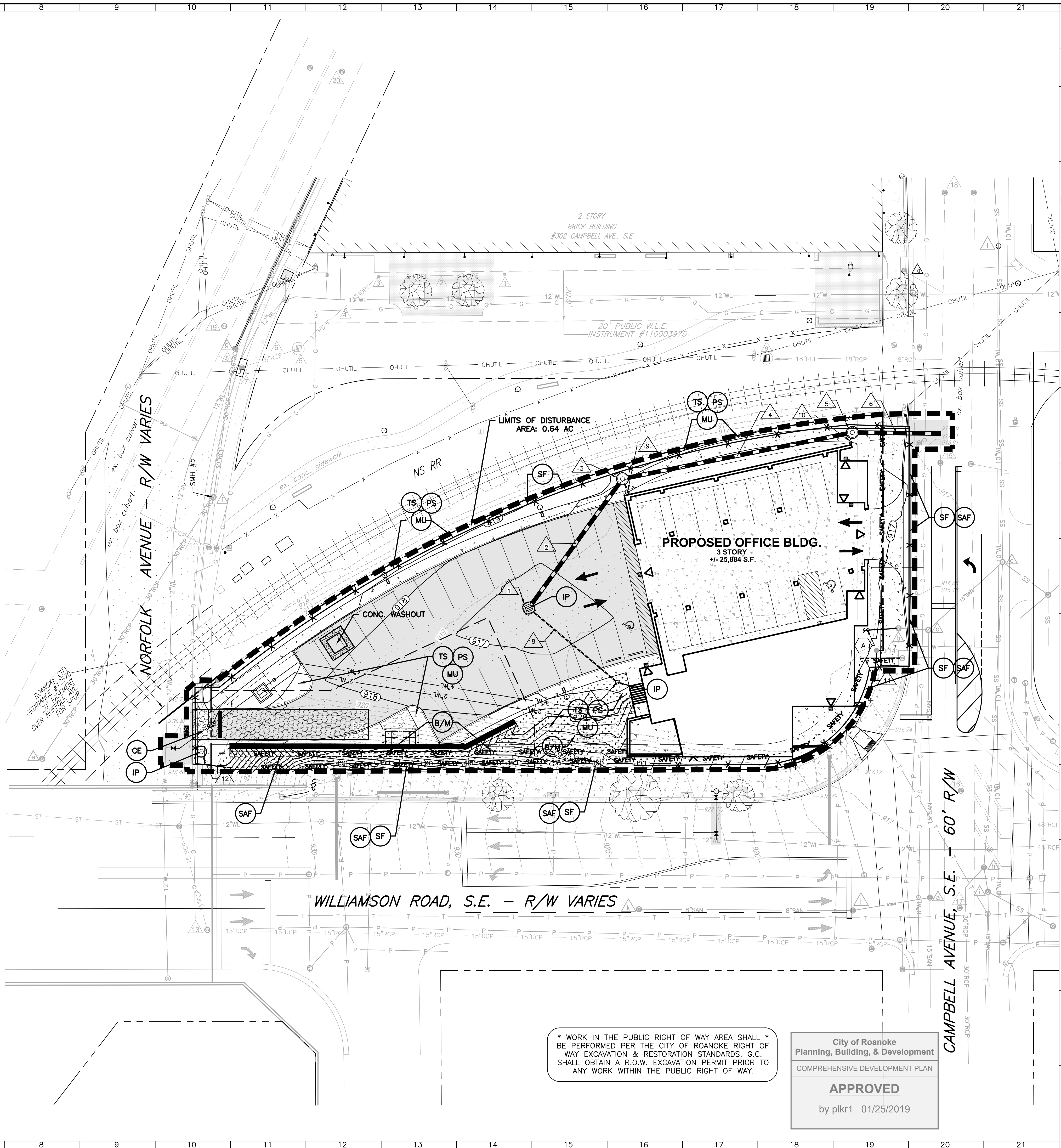

* WORK IN THE PUBLIC RIGHT OF WAY AREA SHALL *
BE PERFORMED PER THE CITY OF ROANOKE RIGHT OF
WAY EXCAVATION & RESTORATION STANDARDS. G.C.
SHALL OBTAIN A R.O.W. EXCAVATION PERMIT PRIOR TO
ANY WORK WITHIN THE PUBLIC RIGHT OF WAY.

City of Roanoke
Planning, Building, & Development
COMPREHENSIVE DEVELOPMENT PLAN
APPROVED
by plkr1 01/25/2019

BALZER
AND ASSOCIATES, INC.
www.balzer.cc

Roanoke
New River Valley
Richmond
Staunton
Harrisonburg

RESIDENTIAL LAND DEVELOPMENT ENGINEERING
SITE DEVELOPMENT ENGINEERING
LAND USE PLANNING & ZONING
LANDSCAPE ARCHITECTURE
LAND SURVEYING
ARCHITECTURE
STRUCTURAL ENGINEERING
TRANSPORTATION ENGINEERING
ENVIRONMENTAL & SOIL SCIENCE
WETLAND DELINEATIONS & STREAM EVALUATIONS

Balzer and Associates, Inc.
1208 Corporate Circle
Roanoke, VA 24018
540-772-9580
FAX 540-772-8050

COMMONWEALTH OF VIRGINIA
Christopher P. Burns
Lic. No. 047338
12/16/18
PROFESSIONAL ENGINEER

PINNACLE BANK CORPORATE
202 CAMPBELL AVE SOUTHEAST
EROSION & SEDIMENT CONTROL PLAN

CITY OF ROANOKE, VIRGINIA

DRAWN BY CLL
DESIGNED BY BTC
CHECKED BY BTC
DATE 10/24/2018
SCALE 1"=20'

REVISIONS:
11/16/2018
12/16/2018

SHEET NO.
C6
JOB NO. 03180055.00