

BOUNDARY COORDINATES
BLOCK #1, SECTION #4

ORIGIN OF COORDINATES ASSUMED		
COR.	NORTHING	EASTING
1	10560.82022	6714.66644
2	10538.88679	6653.47882
3	10498.65872	6561.92718
4	10457.63327	6470.73007
5	10352.85702	6359.23595
6	10227.75176	6203.19534
7	10131.84398	5983.19148
8	10012.39412	5911.98925
9	10425.62669	5685.29028
10	10656.97645	6193.33257
11	10721.48625	6301.64726
12	10843.11002	6462.63299
13	10867.68225	6502.61348
14	10620.50561	6702.07062

TOTAL AREA = 8.169 Acres

BOUNDARY COORDINATES
BLOCK #2, SECTION #4

ORIGIN OF COORDINATES ASSUMED		
COR.	NORTHING	EASTING
15	10469.58517	5661.17471
16	10884.04004	5433.80518
17	10866.98672	5531.64853
18	10898.83467	5629.85781
19	10949.75826	5651.51205
20	10948.60264	5673.78798
21	10965.84434	5730.31616
22	10969.15682	5754.37040
23	10950.16658	5870.99678
24	10855.21157	6020.49686
25	10844.93844	6173.15158
26	10730.40904	6225.67793
27	10702.48053	6172.61115

TOTAL AREA = 4.975 Acres

KNOW ALL MEN BY THESE PRESENTS, TO WIT:

THAT FFE DEVELOPMENT CORPORATION IS THE FEE SIMPLE OWNER AND PROPRIETOR OF THE LAND SHOWN HEREON TO BE SUBDIVIDED, BOUNDED BY OUTSIDE CORNERS 1 THROUGH 14 TO 1, INCLUSIVE AND 15 THROUGH 27 TO 15, INCLUSIVE, WHICH COMPRISES A PORTION OF THE LAND CONVEYED TO SAID OWNER BY DEED FROM ALFRED W. POWELL, JR. AND BARBARA B. POWELL DATED 27 JUNE 1989, RECORDED IN THE CLERK'S OFFICE OF THE CIRCUIT COURT OF ROANOKE COUNTY, VIRGINIA, IN DEED BOOK 1308, PAGE 1193, AND ALSO LOT 9, SECTION 3, FAIRWAY FOREST ESTATES AS RECORDED IN PLAT BOOK 11 PAGE 183. ALL OF SAID PROPERTY IS SUBJECT TO THE LIEN OF A CERTAIN DEED OF TRUST TO EMILY W. RIFE AND DENNIS W. YOUNG, TRUSTEES, SECURING CRESTAR BANK, BENEFICIARY, DATED 26 JULY 1989, RECORDED IN THE AFORESAID CLERK'S OFFICE IN DEED BOOK 1308, PAGE 1209.

THE SAID OWNER CERTIFIES THAT HE HAS SUBDIVIDED THIS LAND, AS SHOWN HEREON, ENTIRELY WITH HIS OWN FREE WILL AND CONSENT AND PURSUANT TO AND IN COMPLIANCE WITH THE VIRGINIA CODE OF 1950, AS AMENDED TO DATE AND FURTHER PURSUANT TO AND IN COMPLIANCE WITH THE COUNTY OF ROANOKE LAND SUBDIVISION ORDINANCES.

THE SAID OWNER DOES BY VIRTUE OF THE RECORDATION OF THIS PLAT, GRANT TO THE COUNTY OF ROANOKE ALL OF THE EASEMENTS AS SHOWN HEREON, WHICH ARE HEREBY DEDICATED FOR PUBLIC USE.

IN WITNESS THEREOF IS PLACED THE SIGNATURE OF THE AFORESAID OWNER, ON THIS 29th DAY OF October, 1991.

FFE DEVELOPMENT CORPORATION

BY: R. William Reid
R. WILLIAM REID, PRESIDENT

CRESTAR BANK

BY: Emily W. Rife
EMILY W. RIFE, VICE PRESIDENT

BY: Emily W. Rife
EMILY W. RIFE, SOLE ACTING TRUSTEE

NOTES:

1. THIS PLAT IS BASED ON A CURRENT FIELD SURVEY.
2. THIS PLAT WAS PREPARED WITHOUT THE BENEFIT OF A CURRENT TITLE REPORT AND THERE MAY EXIST ENCUMBRANCES WHICH EFFECT THE PROPERTY NOT SHOWN HEREON.
3. THIS PROPERTY IS NOT LOCATED WITHIN THE LIMITS OF A 100 YEAR FLOOD BOUNDARY AS DESIGNATED BY FEMA. THIS OPINION IS BASED ON AN INSPECTION OF THE FLOOD INSURANCE RATE MAP AND HAS NOT BEEN VERIFIED BY ACTUAL FIELD ELEVATIONS.
4. IRON PINS SET AT ALL CORNERS, UNLESS OTHERWISE NOTED.
5. APPROVAL HEREOF BY THE ROANOKE COUNTY SUBDIVISION AGENT IS FOR PURPOSES OF ENSURING COMPLIANCE WITH THE ROANOKE COUNTY SUBDIVISION ORDINANCE. PRIVATE MATTERS, SUCH AS COMPLIANCE WITH RESTRICTIVE COVENANTS OR OTHER TITLE REQUIREMENTS, APPLICABLE TO THE PROPERTIES SHOWN HEREON, ARE NOT REVIEWED OR APPROVED WITH REGARD TO THIS SUBDIVISION OR RE-SUBDIVISION.

APPROVED:

Donald C. May
AGENT, ROANOKE COUNTY
PLANNING COMMISSION

19 November 1991
DATE

IN THE CLERK'S OFFICE OF THE CIRCUIT COURT OF ROANOKE COUNTY, VIRGINIA, THIS PLAT WITH THE CERTIFICATE OF ACKNOWLEDGEMENT THERETO ANNEXED IS ADMITTED TO RECORD ON Nov. 7, 1992, AT 16:09 O'CLOCK P.M.

TESTEE: STEVEN A. MCGRAW CLERK

Barley L. Sawyer
DEPUTY CLERK

STATE OF VIRGINIA
AT LARGE

I, Donna M. Marshall, A NOTARY PUBLIC IN AND FOR THE AFORESAID STATE DO HEREBY CERTIFY THAT R. WILLIAM REID, PRESIDENT, FEE DEVELOPMENT CORPORATION, WHOSE NAME AS SUCH IS SIGNED TO THE FOREGOING WRITING DATED Oct 25, 1991, HAS PERSONALLY APPEARED BEFORE ME IN MY AFORESAID STATE AND ACKNOWLEDGED THE SAME ON Oct 25, 1991.

MY COMMISSION EXPIRES 6/30/94

Donna M. Marshall
NOTARY PUBLIC

STATE OF VIRGINIA
AT LARGE

I, SARA V. PRILLAMAN, A NOTARY PUBLIC IN AND FOR THE AFORESAID STATE DO HEREBY CERTIFY THAT EMILY W. RIFE, SOLE ACTING TRUSTEE AND VICE PRESIDENT OF CRESTAR BANK, HAVE PERSONALLY APPEARED BEFORE ME IN MY AFORESAID STATE AND ACKNOWLEDGED THE SAME THE SAME ON October 29, 1991.

MY COMMISSION EXPIRES JANUARY 31, 1995

Sara V. Prillaman
NOTARY PUBLIC

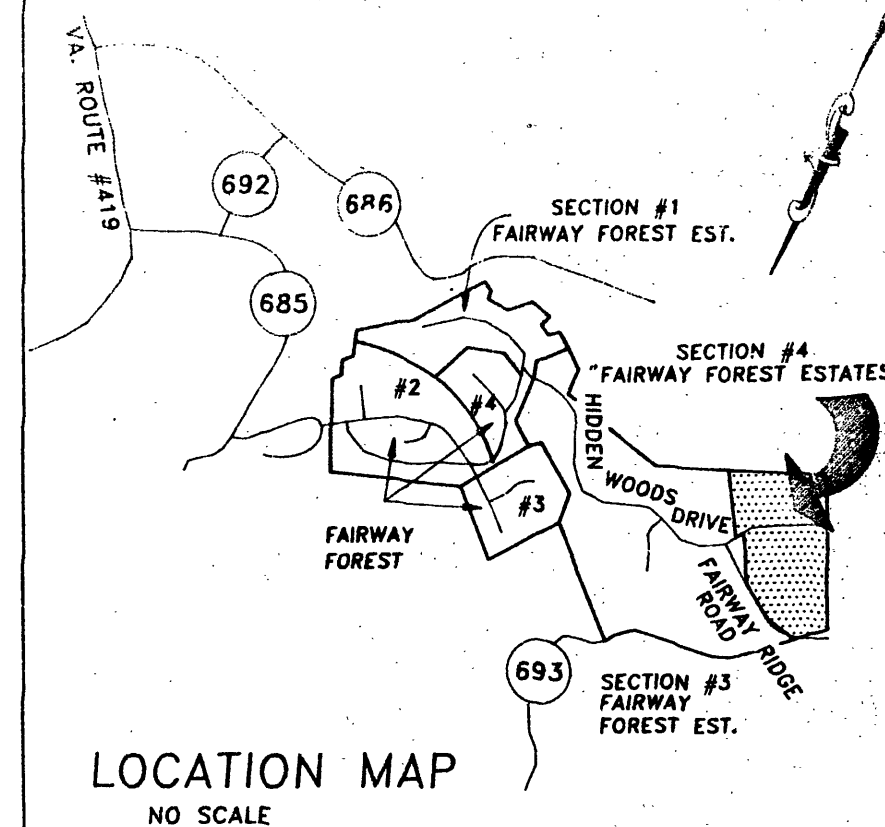

PLAT SHOWING
SECTION No. 4
"FAIRWAY FOREST ESTATES"

ORIGINAL TAX #66.04-3-98 AND 66.04-3-99

AND NEW

LOT 9A

BLOCK 1, SECTION No. 3, BEING
ORIGINAL LOT 9, BLOCK 1, SECTION No. 3

"FAIRWAY FOREST ESTATES" (P.B. 11, PG. 183)

TAX #66.04-3-28

PROPERTY OF

FFE DEVELOPMENT CORPORATION

SITUATED IN

WINDSOR HILLS MAGISTERIAL DISTRICT
ROANOKE COUNTY, VIRGINIA

SCALE: 1" = 100' DATE: 23 OCTOBER, 1991

LUMSDEN ASSOCIATES, P.C.
ENGINEERS - SURVEYORS - PLANNERS
ROANOKE, VIRGINIA

COMM. #88-052